

LAKE SURVEY MAP

WISCONSIN CONSERVATION DEPARTMENT
BIOLOGY DIVISION
LAKE AND STREAM IMPROVEMENT SECTION

LAKE SHAY
SECTION 17
TOWNSHIP 32 N
RANGE 15 E
TOWN OF DOTY
COUNTY OCONTO

FORM FI-117

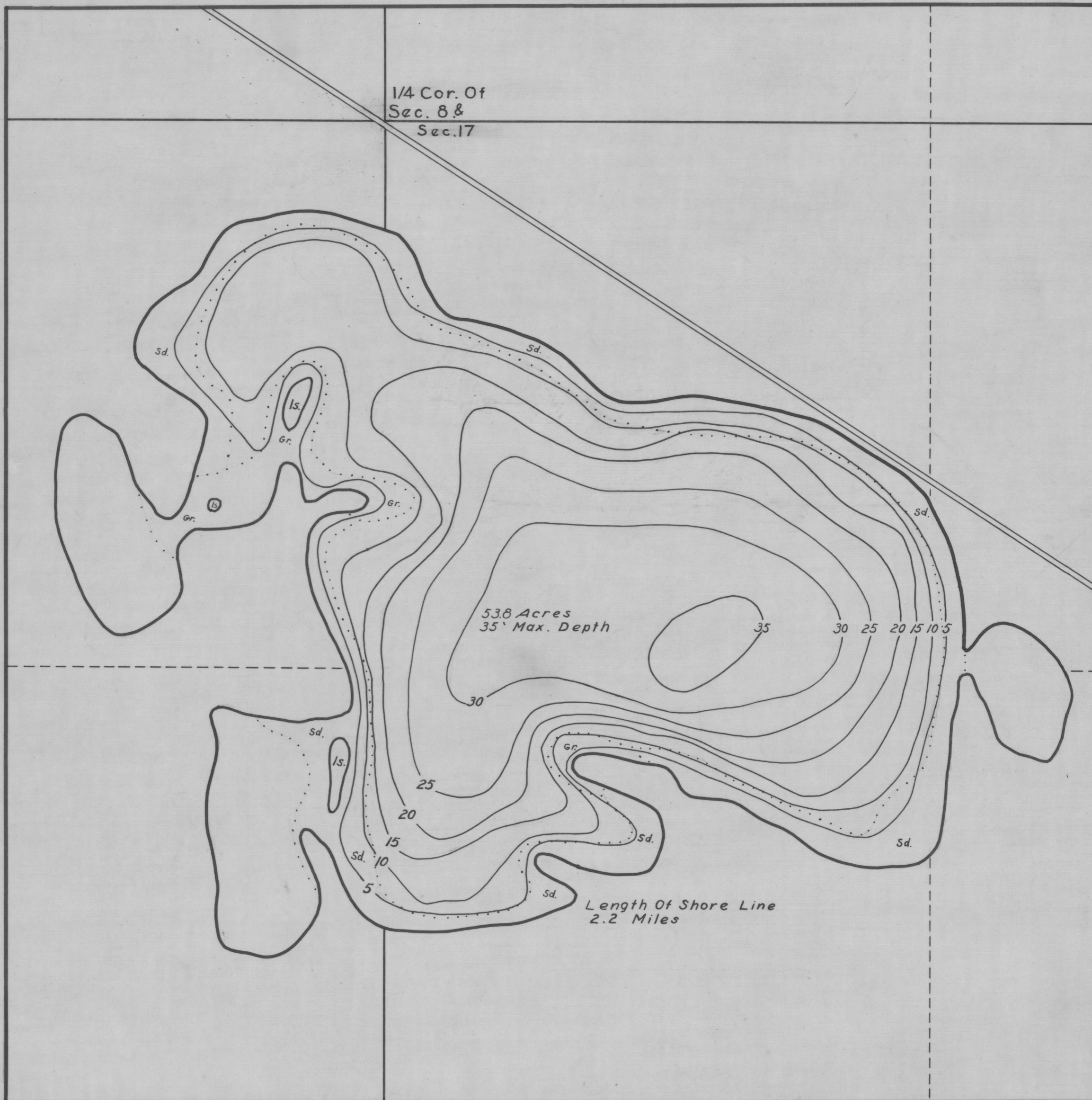

DATE July 7, 1939
COMPILED BY _____
TRACED BY R.F.F.
SOURCE OF INFORMATION
U.S. Forest Service Lake And Stream Survey
SOUNDINGS At 5' Intervals
U.S. Forest Service Lake And Stream Survey
DATES OF MAP REVISION _____
WORK AGENCY WPA

SCALE: 1" = 220 ft.

LAKE IMPROVEMENT RECORD

TYPE	DATE			
⊗ BRUSH REFUGES	_____	_____	_____	_____
~ SAPLING TANGLES	_____	_____	_____	_____
□ SPAWNING BOXES	_____	_____	_____	_____
* MINNOW SPAWNERS	_____	_____	_____	_____
TOTAL	_____	_____	_____	_____

LEGEND

- ⊗ WEED BEDS
- ~ ROCKY SHOALS
- Sd. SAND
- Cl. CLAY
- Gr. GRAVEL
- Mk. MUCK
- DWELLING
- ABANDONED DWELLING
- ⊠ RESORT

1" = 220'

LAKE SURVEY MAP

WISCONSIN CONSERVATION DEPARTMENT
 BIOLOGY DIVISION
 LAKE AND STREAM IMPROVEMENT SECTION

LAKE SHAY
 SECTION 17
 TOWNSHIP 32
 RANGE 15
 TOWN OF DOTY
 COUNTY OCONTO

1/4 Cor. Of
 Sec. 8 &
 Sec. 17

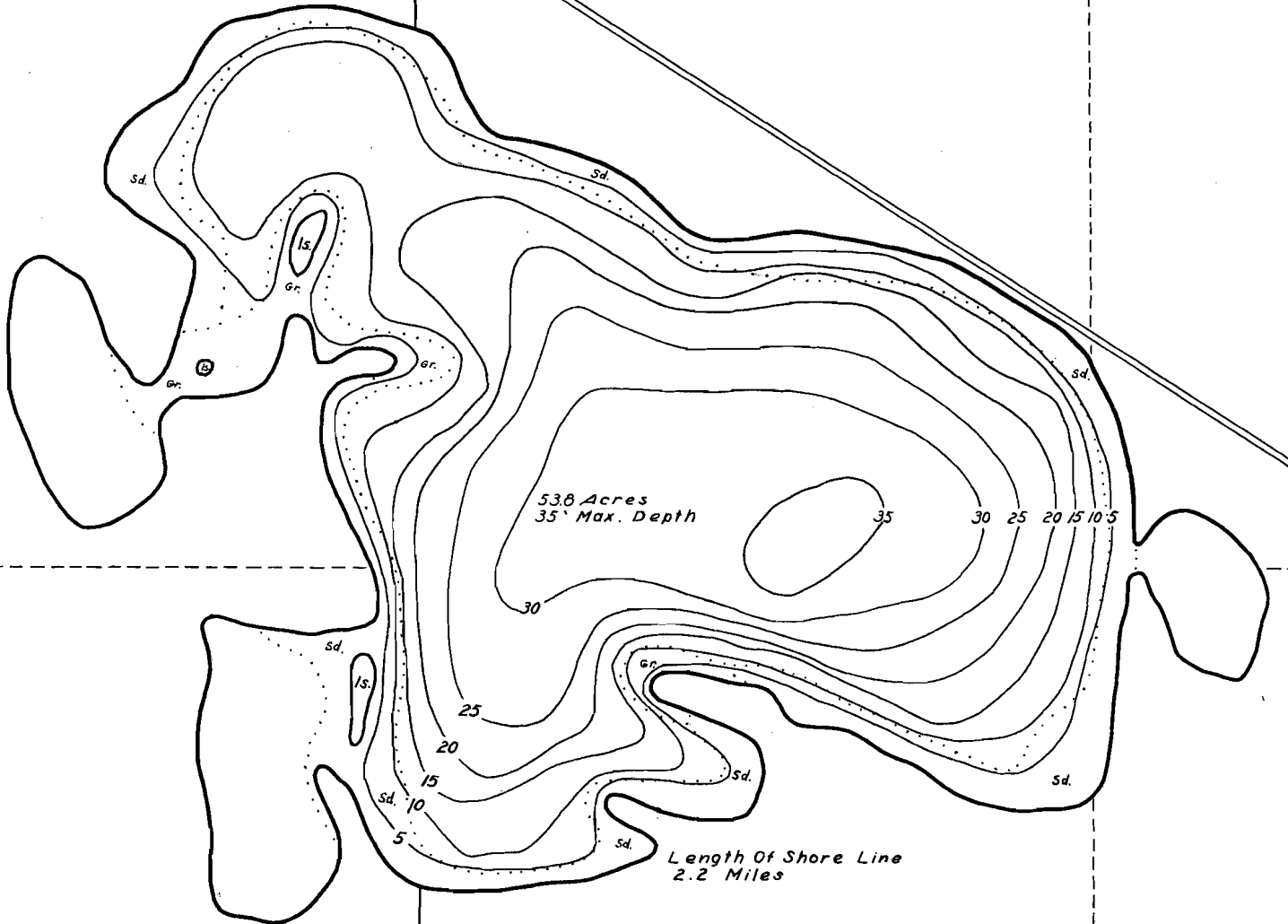

MADE BY July 7, 1939
 FILED BY _____
 CHECKED BY R.F.F.
 SOURCE OF INFORMATION
Forest Service Lake And Stream Survey
 SPACINGS At 5' Intervals
Forest Service Lake And Stream Survey
 DATES OF MAP REVISION _____
 FIELD AGENCY _____

SCALE: 1" = 220 ft.

LAKE IMPROVEMENT RECORD

TYPE	DATE			
⊗ BRUSH REFUGES	_____	_____	_____	_____
~ SAPLING TANGLES	_____	_____	_____	_____
□ SPAWNING BOXES	_____	_____	_____	_____
* MINNOW SPAWNERS	_____	_____	_____	_____
TOTAL	_____	_____	_____	_____

- LEGEND
- ⊗ WEED BEDS
 - ~ ROCKY SHOALS
 - Sd. SAND
 - Cl. CLAY
 - Gr. GRAVEL
 - Mk. MUCK
 - DWELLING
 - ABANDONED DWELLING
 - ⊠ RESORT

LAKE SURVEY MAP

LAKE SHAY
 SECTION 17
 TOWNSHIP 32 N
 RANGE 15 E
 TOWN OF DOTY
 COUNTY OCONTO

ISIN CONSERVATION DEPARTMENT
 BIOLOGY DIVISION
 WIND STREAM IMPROVEMENT SECTION

1/4 Cor. Of
 Sec. 8 &
 Sec. 17

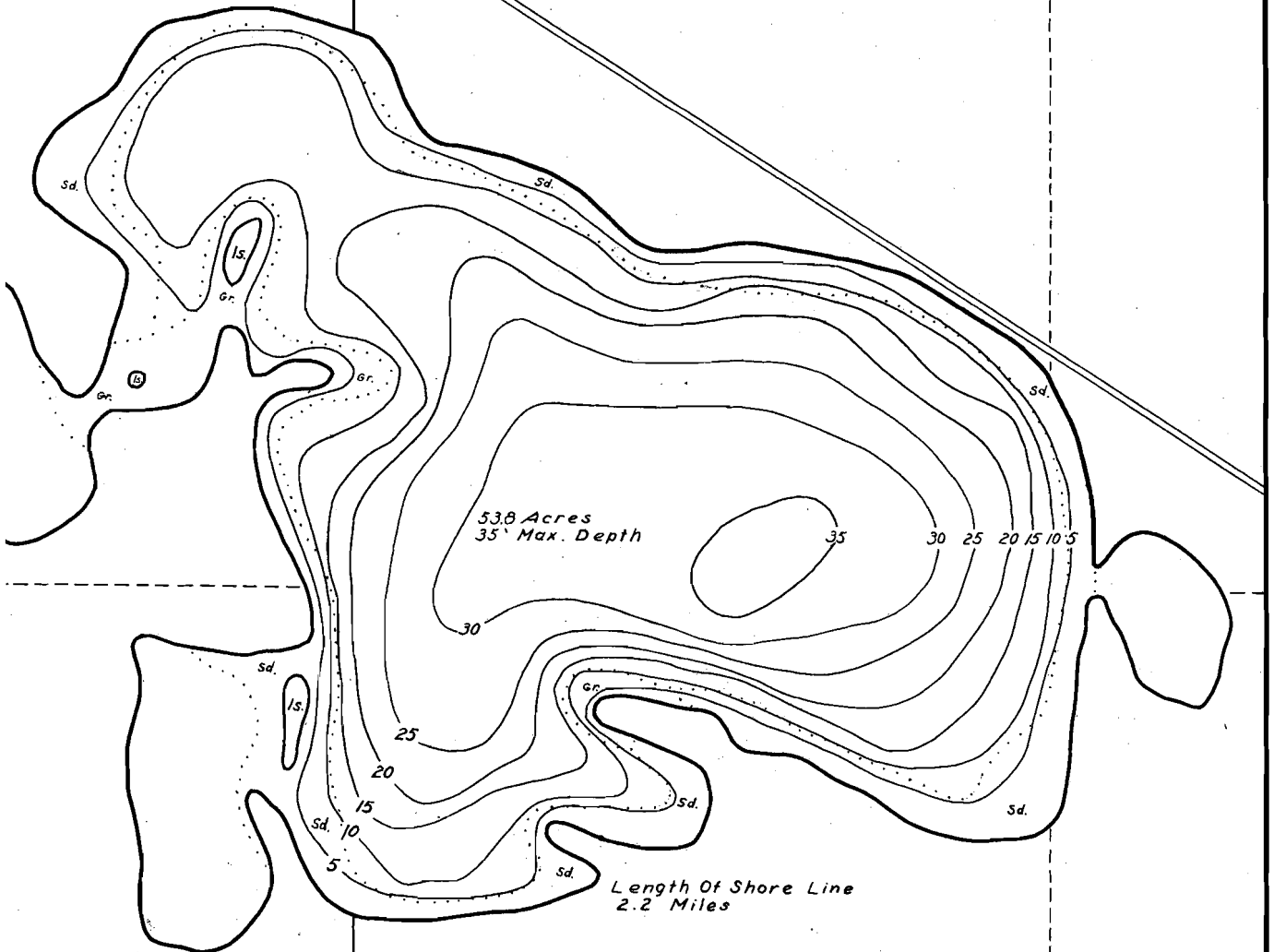

July 7, 1939

BY R.F.F.
 INFORMATION
 Service Lake And
 Survey
 At 5' Intervals
 Service Lake And
 Survey
 MAP REVISION
 BY

SCALE: 1" = 220ft.

LAKE IMPROVEMENT RECORD

TYPE	DATE			
⊕ BRUSH REFUGES				
~ SAPLING TANGLES				
□ SPAWNING BOXES				
* MINNOW SPAWNERS				
TOTAL				

LEGEND

- ⊙ WEED BEDS
- ⊗ ROCKY SHOALS
- Sd. SAND
- Cl. CLAY
- Gr. GRAVEL
- Mk. MUCK
- DWELLING
- ABANDONED DWELLING
- ⊠ RESORT

Source: Wisconsin Department of Natural Resources 608-266-2621
Shay Lake – Oconto County, Wisconsin DNR Lake Map
Date - Jul 1939 - Historical Lake Map - Not for Navigation
A Public Document - Please Identify the Source when using it.