

LAKE SURVEY MAP

B.M.'X' 2" square cut on E. corner of cement support of dam.
Assumed elevation 100.00'
Water level 99.29'

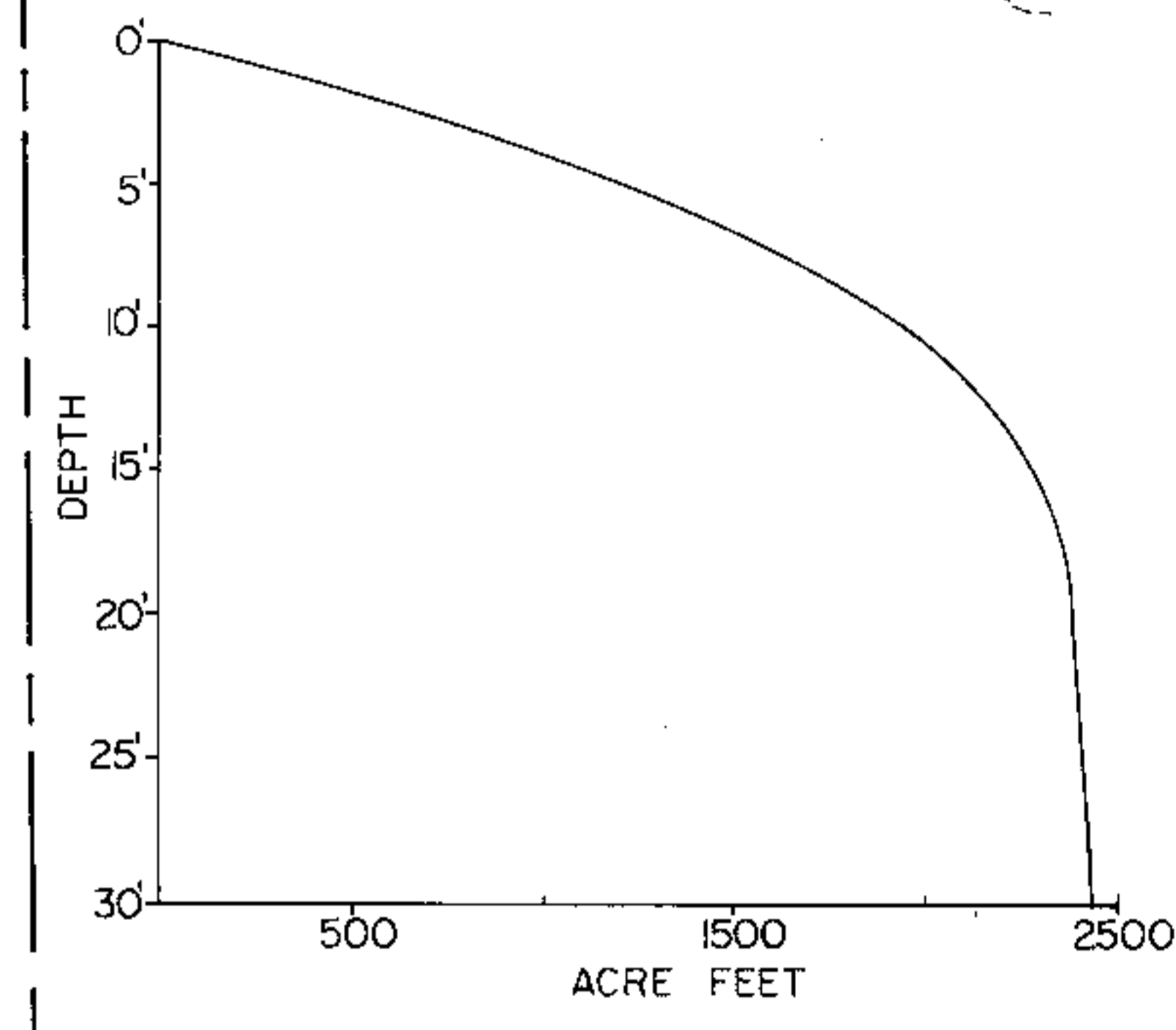
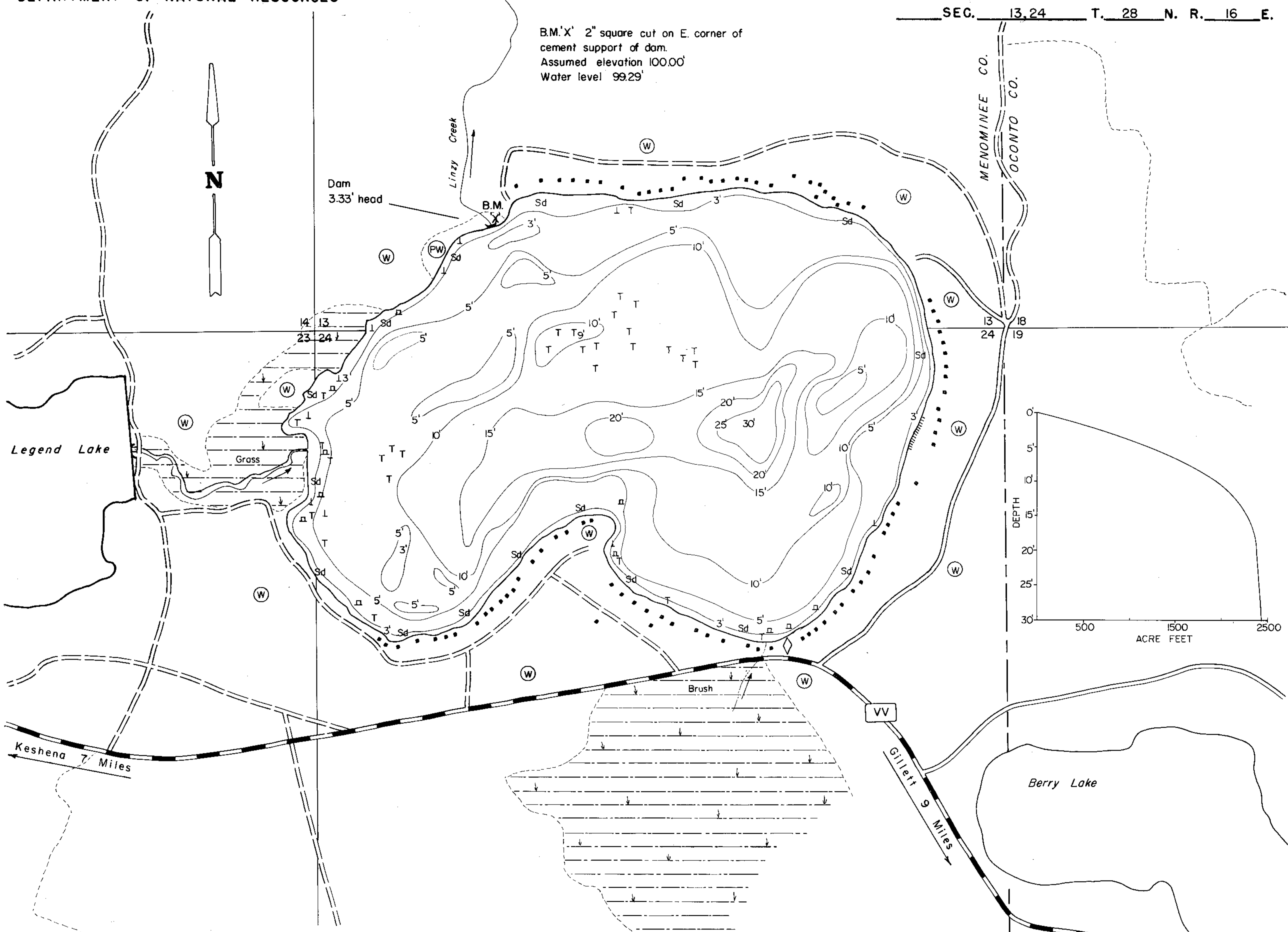

EQUIPMENT RECORDING SONAR MAPPED JULY 1969
MONTH YEAR

- | TOPOGRAPHIC SYMBOLS | | LAKE BOTTOM SYMBOLS | |
|-----------------------|-------------------------------|---------------------|-----------------------------|
| (B) Brush | () Steep slope | P. Peat | B Boulders |
| (PW) Partially wooded | (---) Indefinite shoreline | Mk. Muck | ⊙ Stumps & Snags |
| (W) Wooded | () Marsh | C. Clay | ⊙ Rock danger to navigation |
| (C) Cleared | (o) Spring | M. Marl | T Submergent vegetation |
| (P) Pastured | (---) Intermittent stream | Sd. Sand | ⊥ Emergent vegetation |
| (A) Agricultural | (---) Permanent inlet | St. Silt | ⊥ Floating vegetation |
| B.M. Bench Mark | (---) Permanent outlet | Gr. Gravel | ⊥ Brush shelters |
| ■ Dwelling | (---) Dam | R. Rubble | |
| □ Resort | (---) D.N.R. State owned land | Bc Bedrock | |
| □ Camp | | | |



◆ Access ◆ Access with Parking ◆ Boat Livery
Drawn by: C. Holt
Field work by: J. Smith

SPECIES OF FISH	ABUNDANCE		
	Abundant	Common	Present
Muskie			
N. Pike		X	
Walleye			X
L. M. Bass		X	
S. M. Bass			X
Panfish	X		
Trout			

WATER AREA 2644 ACRES
UNDER 3 FT. 6.3 %
OVER 20 FT. 3.5 %
MAX. DEPTH 30 FEET.
TOTAL ALK. 78 P.P.M.
VOLUME 2431.6 ACRE FT.
SHORELINE 2.74 MILES

Source: Wisconsin Department of Natural Resources 608-266-2621
Moskawquit Lake – Menominee County, Wisconsin DNR Lake Map
Date – Jul 1969 - Historical Lake Map - Not for Navigation
A Public Document - Please Identify the Source when using it.