

LAKE SURVEY MAP

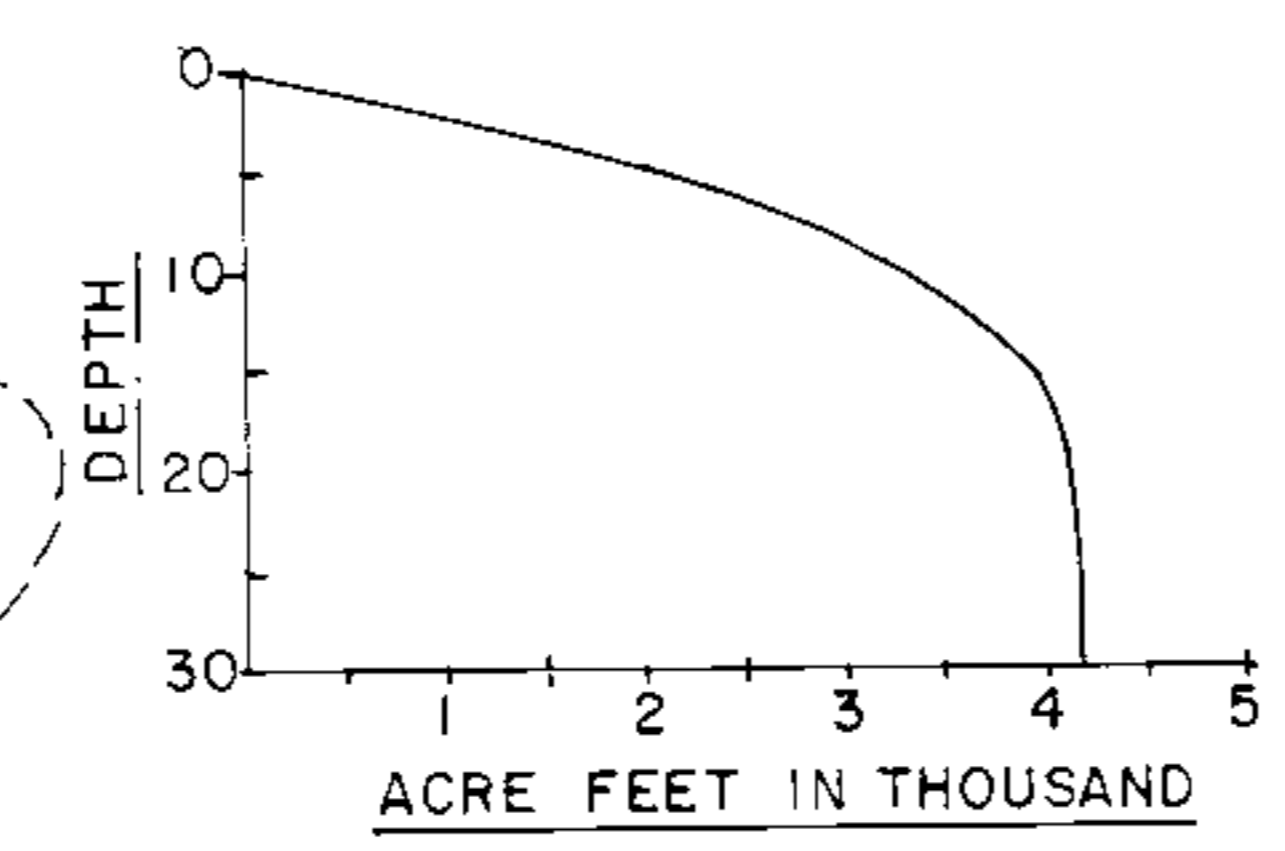
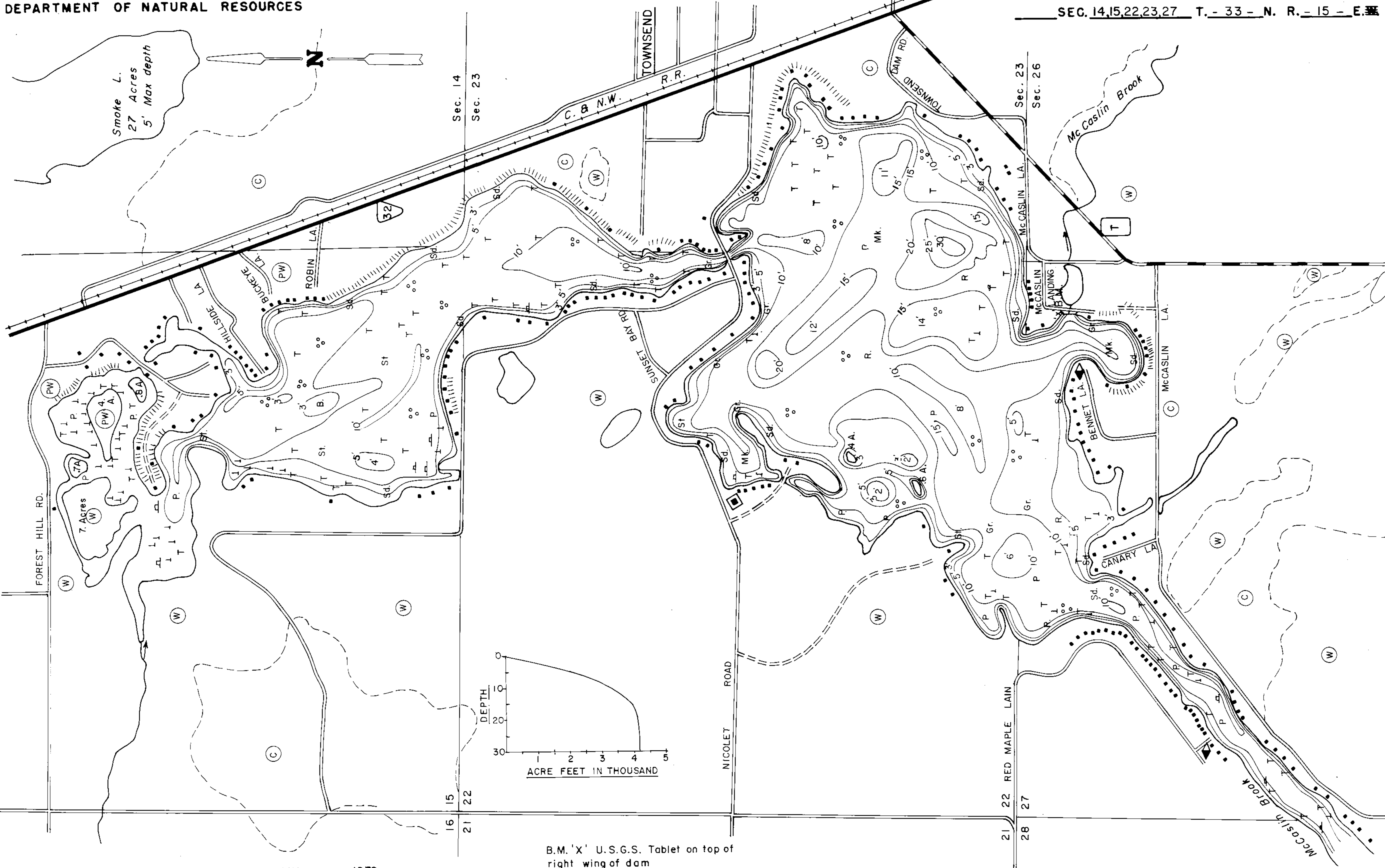

B.M. 'X' U.S.G.S. Tablet on top of right wing of dam
Assumed Elevation 100.00'
Water Level 96.00'

EQUIPMENT RECORDING SONAR MAPPED		MAY 1979	
TOPOGRAPHIC SYMBOLS		MONTH	YEAR
		LAKE	BOTTOM
(B) Brush	Steep slope	P. Peat	B Boulders
(PW) Partially wooded	~ Indefinite shoreline	Mk. Muck	o Stumps & Snags
(W) Wooded	~ Marsh	C. Clay	o Rock danger to navigation
(C) Cleared	~ Spring	M. Marl	T Submergent vegetation
(P) Pastured	~ Intermittent stream	Sd. Sand	l Emergent vegetation
(A) Agricultural	~ Permanent inlet	St. Silt	~ Floating vegetation
B.M. Bench Mark	~ Permanent outlet	Gr. Gravel	~ Brush shelters
■ Dwelling	~ Dam	R. Rubble	
■ Resort	~ D.N.R. State owned land	Br. Bedrock	
■ Camp			

600' 0' 600' 1,200' 1,800' 2,400'
SCALE
◆ Access ◆ Access with Parking ◆ Boat Livery
Drawn by: E. Eaton
Field work by: J. O'Brien, J. Tomasko

SPECIES OF FISH	ABUNDANCE		
	Abundant	Common	Present
Muskie			X
N. Pike		X	X
Walleye		X	X
L.M. Bass		X	
S.M. Bass		X	
Panfish	X		
Trout			

WATER AREA 476 ACRES
UNDER 3 FT. 15 %
OVER 20 FT. 2 %
MAX. DEPTH 30 FEET.
TOTAL ALK. 52 P.P.M.
VOLUME 4,157 ACRE FT.
MAIN SHORELINE 10.49 MI.
ISLAND SHORELINE 1.14 MI.

Source: Wisconsin Department of Natural Resources 608-266-2621
Townsend Flowage – Oconto County, Wisconsin DNR Lake Map
Date - May 1979 - Historical Lake Map - Not for Navigation
A Public Document - Please Identify the Source when using it.