

LAKE SURVEY MAP

WISCONSIN CONSERVATION DEPARTMENT
BIOLOGY DIVISION
LAKE AND STREAM IMPROVEMENT SECTION

LAKE FRENCH
SECTION 13-18
TOWNSHIP 32 N.
RANGE 15-16 E.
TOWN OF Doty-Riverview
COUNTY Oconto

FORMFI-117

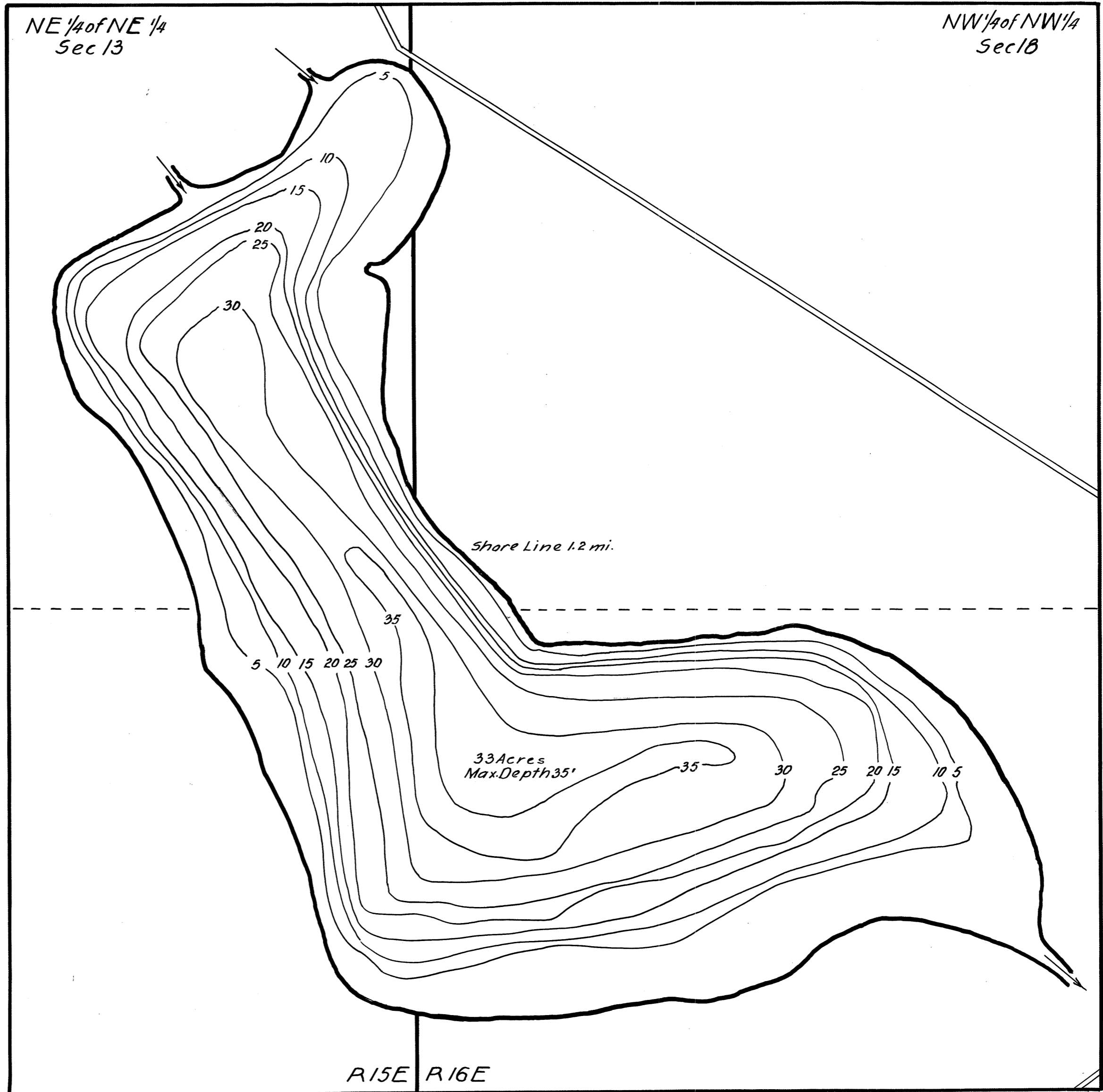

DATE July 24-1939
COMPILED BY _____
TRACED BY H.G.O. (W.P.A.)
SOURCE OF INFORMATION
U.S. Forest Service Map
Lake & Stream Survey
SOUNDINGS Contour Interval 5'
U.S. Forest Service
DATES OF MAP REVISION _____
WORK AGENCY _____

SCALE 1 inch = 165 feet

LAKE IMPROVEMENT RECORD

TYPE	DATE	_____	_____	_____
⊙ BRUSH REFUGES	_____	_____	_____	_____
⊞ SAPLING TANGLES	_____	_____	_____	_____
□ SPAWNING BOXES	_____	_____	_____	_____
* MINNOW SPAWNERS	_____	_____	_____	_____
TOTAL _____				

LEGEND

- ⊞ WEED BEDS
- ⊞ ROCKY SHOALS
- Sd SAND
- Cl CLAY
- Gr GRAVEL
- Mk MUCK
- DWELLING
- ABANDONED DWELLING
- ▣ RESORT

Source: Wisconsin Department of Natural Resources 608-266-2621
French Lake – Oconto County, Wisconsin DNR Lake Map
Date - Jul 1939 - Historical Lake Map - Not for Navigation
A Public Document - Please Identify the Source when using it.