

LAKE SURVEY MAP

WISCONSIN CONSERVATION DEPARTMENT
BIOLOGY DIVISION
LAKE AND STREAM IMPROVEMENT SECTION

LAKE DEAD MAN'S
SECTION 22
TOWNSHIP 32 N
RANGE 15 E
TOWN OF DOTY
COUNTY OCONTO

FORM F1-117

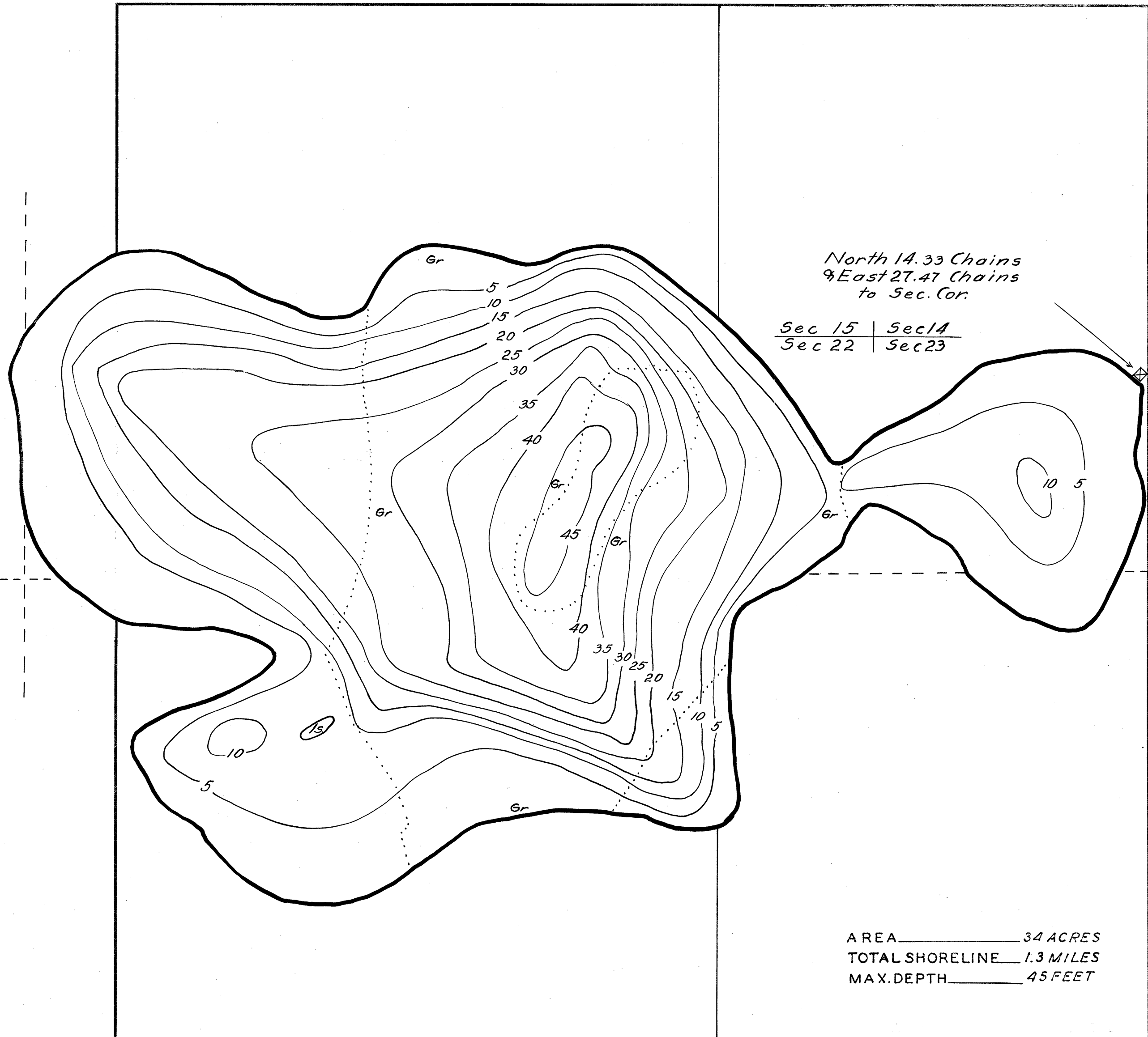

DATE September 30, 1938
COMPILED BY _____
TRACED BY H. G. O.
SOURCE OF INFORMATION
U.S. Forest Service Map
Lake & Stream Survey
SOUNDINGS U.S. Forest Service
DATES OF MAP REVISION _____
WORK AGENCY _____

LAKE IMPROVEMENT RECORD

TYPE	DATE		
⊗ BRUSH REFUGES	_____	_____	_____
⌘ SAPLING TANGLES	_____	_____	_____
□ SPAWNING BOXES	_____	_____	_____
* MINNOW SPAWNERS	_____	_____	_____
TOTAL	_____	_____	_____

SCALE 1" = 165'

LEGEND	
	WEED BEDS
	ROCKY SHOALS
<u>Sd</u>	SAND
<u>Cl</u>	CLAY
<u>Gr</u>	GRAVEL
<u>Mk</u>	MUCK
■	DWELLING
□	ABANDONED DWELLING
▣	RESORT

Source: Wisconsin Department of Natural Resources 608-266-2621
Dead Man's Lake – Oconto County, Wisconsin DNR Lake Map
Date - Sep 1938 - Historical Lake Map - Not for Navigation
A Public Document - Please Identify the Source when using it.