

EQUIPMENT Recording Sonar MAPPED August 1975

TOPOGRAPHIC SYMBOLS		LAKE BOTTOM SYMBOLS	
(B) Brush	Steep slope	P. Peat	B Boulders
(PW) Partially wooded	----- Indefinite shoreline	Mk. Muck	O Stumps & Snags
(W) Wooded	Marsh	C. Clay	⚡ Rock danger to navigation
(C) Cleared	o Spring	M. Marl	T Submergent vegetation
(P) Pastured	----- Intermittent stream	Sd. Sand	↑ Emergent vegetation
(A) Agricultural	===== Permanent inlet	St. Silt	⚓ Floating vegetation
B.M. Bench Mark	===== Permanent outlet	Gr. Gravel	↙ Brush shelters
■ Dwelling	⌒ Dam	R. Rubble	
□ Resort	D.N.R. State owned land	Br. Bedrock	
⊠ Camp			



◆ Access    ◆ Access with Parking    ◆ Boat Livery  
 Drawn by: W. Berwig  
 Field work by: D. Boese — R. Thrun

SPECIES OF FISH	Abundance		
	Abundant	Common	Present
Muskie			
N. Pike		X	
Walleye		X	
L.M. Bass		X	
S.M. Bass	X		
Panfish	X		
Trout			

WATER AREA 157.68 ACRES  
 UNDER 3 FT. 33 %  
 OVER 20 FT. 5 %  
 MAX. DEPTH 37 FEET.  
 TOTAL ALK. 80 P.P.M.  
 VOLUME 135498 ACRE FT.  
 MAIN SHORELINE 8.9 MI.  
 ISLAND SHORELINE .6 MI.

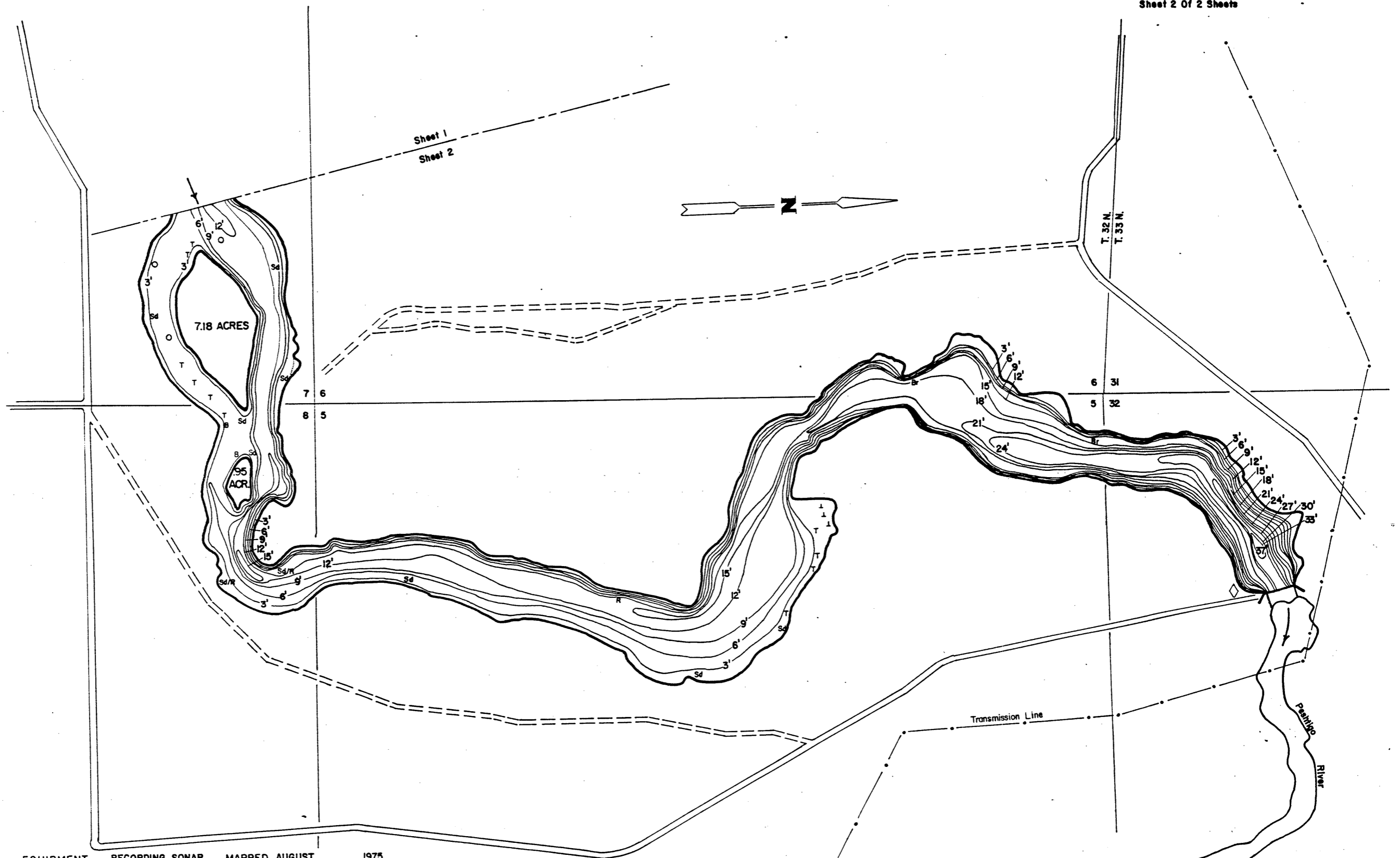

EQUIPMENT	RECORDING SONAR	MAPPED	AUGUST	1975
TOPOGRAPHIC SYMBOLS		MONTH	YEAR	LAKE BOTTOM SYMBOLS
(B) Brush		Steep slope	P. Peat	B Boulders
(PW) Partially wooded		Indefinite shoreline	Mk. Muck	O Stumps & Snags
(W) Wooded		Marsh	C. Clay	⊗ Rock danger to navigation
(C) Cleared		Spring	M. Marl	T Submergent vegetation
(P) Pastured		Intermittent stream	Sd. Sand	⊥ Emergent vegetation
(A) Agricultural		Permanent inlet	Sl. Silt	△ Floating vegetation
B.M. Bench Mark		Permanent outlet	Gr. Gravel	⚡ Brush shelters
■ Dwelling		Dam	R. Rubble	
□ Resort		D.N.R. State owned land	Bc. Bedrock	
□ Camp				

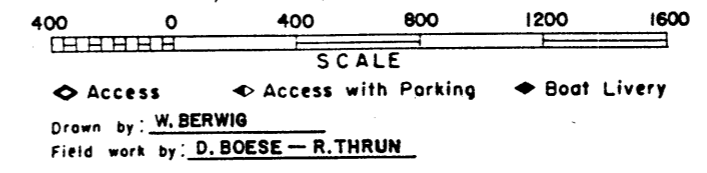

Drawn by: W. BERWIG  
Field work by: D. BOESE - R. THRUN

SPECIES OF FISH	Abundance		
	Abundant	Common	Present
Muskie			
N. Pike		X	
Walleye		X	
L.M. Bass		X	
S.M. Bass	X		
Panfish	X		
Trout			

WATER AREA 157.68 ACRES  
 UNDER 3 FT. 33 %  
 OVER 20 FT. 5 %  
 MAX. DEPTH 37 FEET.  
 TOTAL ALK. 80 P.P.M.  
 VOLUME 1354.98 ACRE FT.  
 MAIN SHORELINE 8.9 MI.  
 ISLAND SHORELINE .6 MI.

Source: Wisconsin Department of Natural Resources 608-266-2621  
Johnson Falls Flowage – Marinette County, Wisconsin DNR Lake Map  
Date – August 1975 - Historical Lake Map - Not for Navigation  
A Public Document - Please Identify the Source when using it.