

LAKE SURVEY MAP

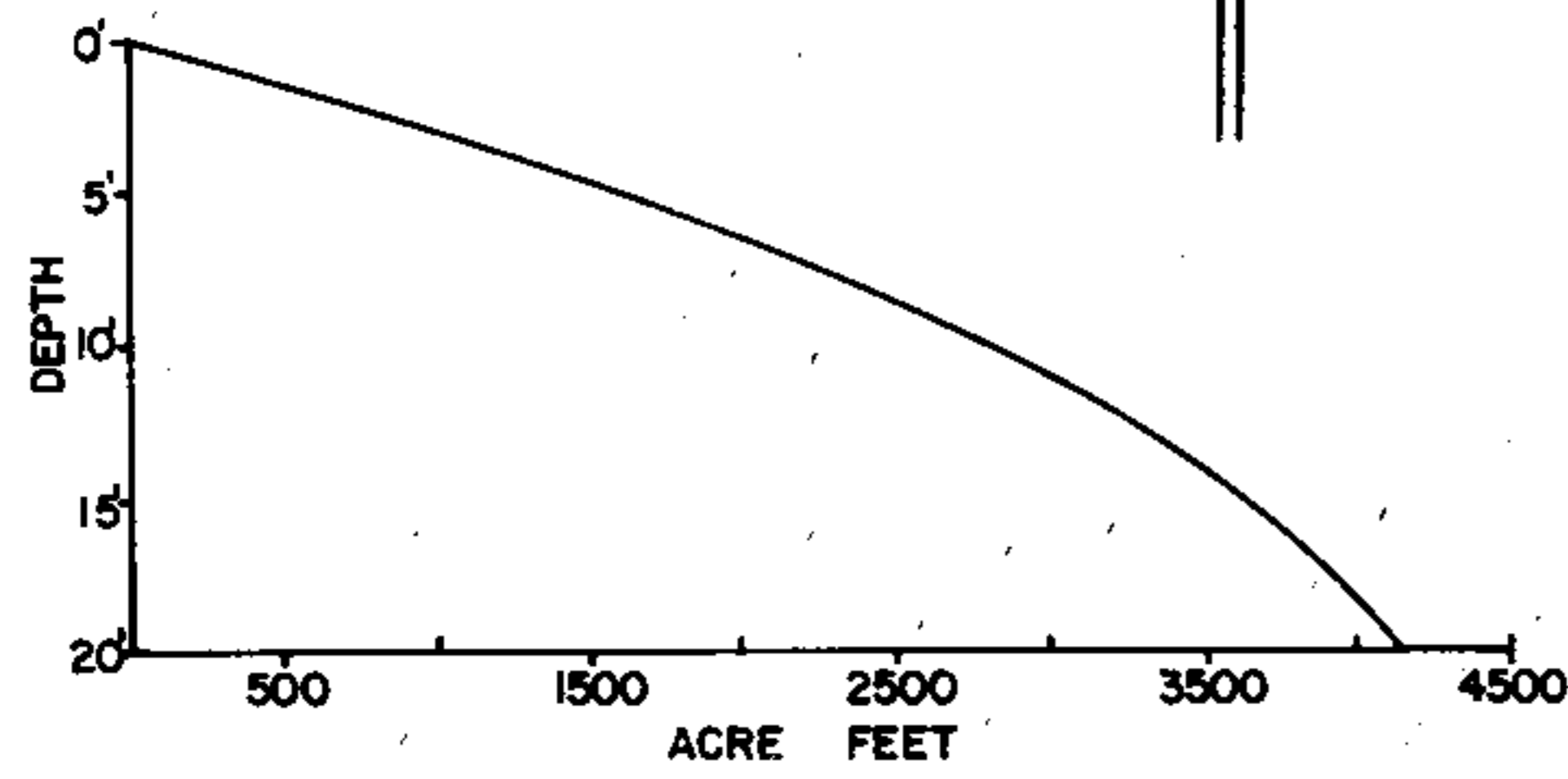
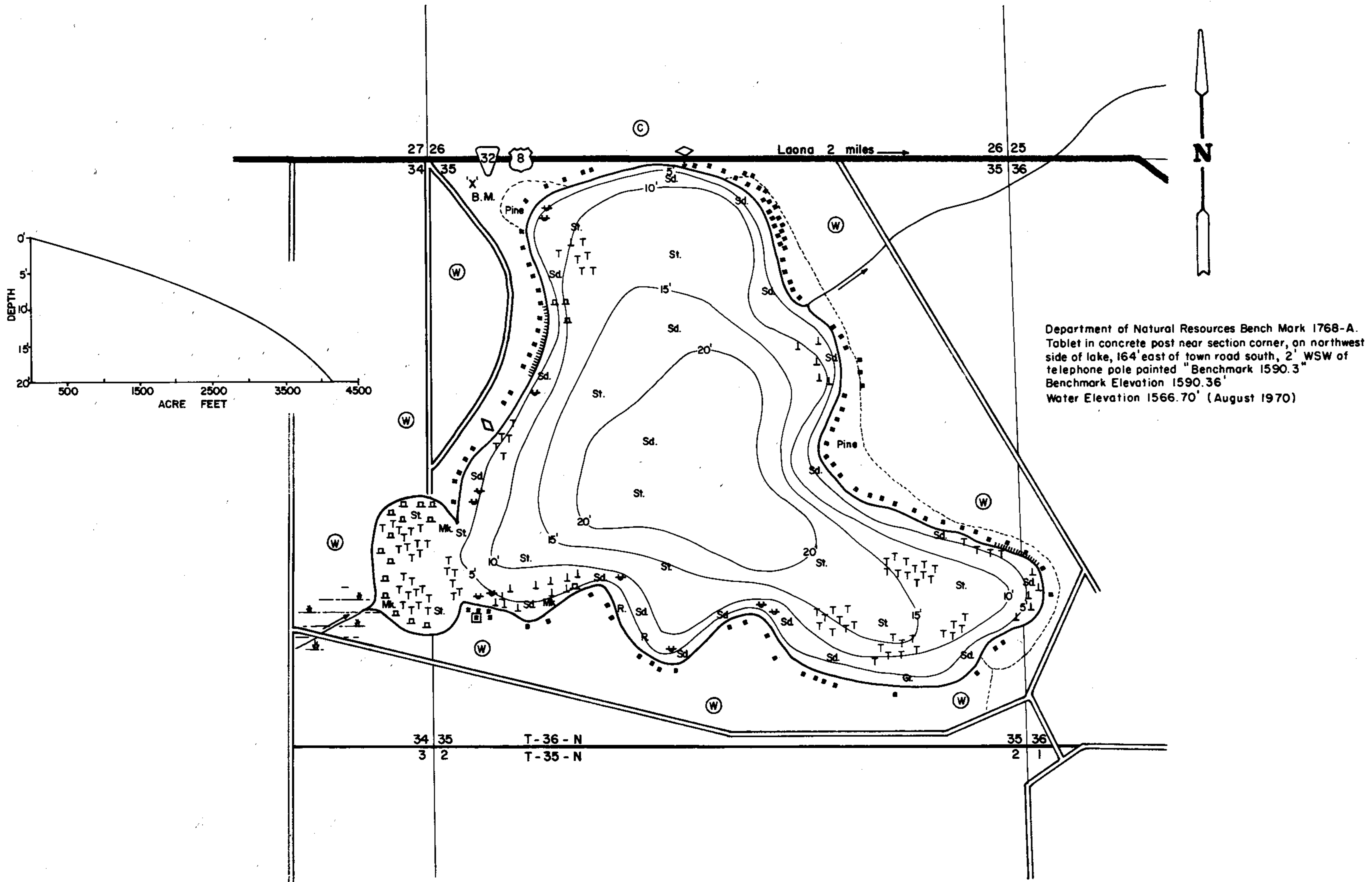

Department of Natural Resources Bench Mark 1768-A. Tablet in concrete post near section corner, on northwest side of lake, 164' east of town road south, 2' WSW of telephone pole painted "Benchmark 1590.3" Benchmark Elevation 1590.3' Water Elevation 1566.70' (August 1970)

EQUIPMENT SOUNDINGS THRU ICE MAPPED  
 UPDATED JUNE 1967  
 JULY 1938  
 MONTH YEAR  
 LAKE BOTTOM SYMBOLS

- |                            |                            |
|----------------------------|----------------------------|
| <b>TOPOGRAPHIC SYMBOLS</b> | <b>LAKE BOTTOM SYMBOLS</b> |
| Brush                      | P. Peat                    |
| Partially wooded           | Mk. Muck                   |
| Wooded                     | C. Clay                    |
| Cleared                    | M. Marl                    |
| Pastured                   | Sd. Sand                   |
| Agricultural               | St. Silt                   |
| B.M. Bench Mark            | Gr. Gravel                 |
| Dwelling                   | R. Rubble                  |
| Resort                     | Bc. Bedrock                |
| Camp                       | B Boulders                 |
| Steep slope                | Stumps & Snags             |
| Indefinite shoreline       | Rock danger to navigation  |
| Marsh                      | T Submergent vegetation    |
| Spring                     | ↓ Emergent vegetation      |
| Intermittent stream        | ↑ Floating vegetation      |
| Permanent inlet            | ↖ Brush shelters           |
| Permanent outlet           |                            |
| Dam                        |                            |
| D.N.R. State owned land    |                            |

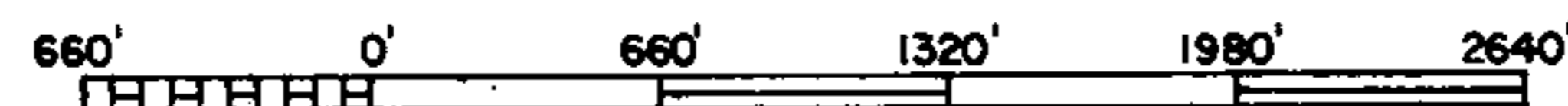

SCALE  
 Access Access with Parking Boat Livery  
 Drawn by: C. Holt  
 Field work by: P. Michelson

SPECIES OF FISH	Abundance	
	Abundant	Common
Muskie	X	
N. Pike		X
Walleye		X
L.M. Bass	X	
S.M. Bass	X	
Panfish	X	
Trout		

WATER AREA 334.4 ACRES  
 UNDER 3 FT. 9.6 %  
 OVER 20 FT. 17.7 %  
 MAX. DEPTH 20 FEET.  
 TOTAL ALK. 21 P.P.M.  
 VOLUME 4141.0 ACRE FT.  
 SHORELINE 3.8 MILES

Source: Wisconsin Department of Natural Resources 608-266-2621  
Silver Lake – Forest County, Wisconsin DNR Lake Map  
Date – Jun 1967 - Historical Lake Map - Not for Navigation  
A Public Document - Please Identify the Source when using it.