

WISCONSIN CONSERVATION DEPARTMENT
 BIOLOGY DIVISION
 LAKE AND STREAM IMPROVEMENT SECTION

LAKE TIMMS (LINDA)
 SECTION 16 17
 TOWNSHIP 37 N
 RANGE 21 E
 TOWN OF NIAGARA
 COUNTY MARINETTE

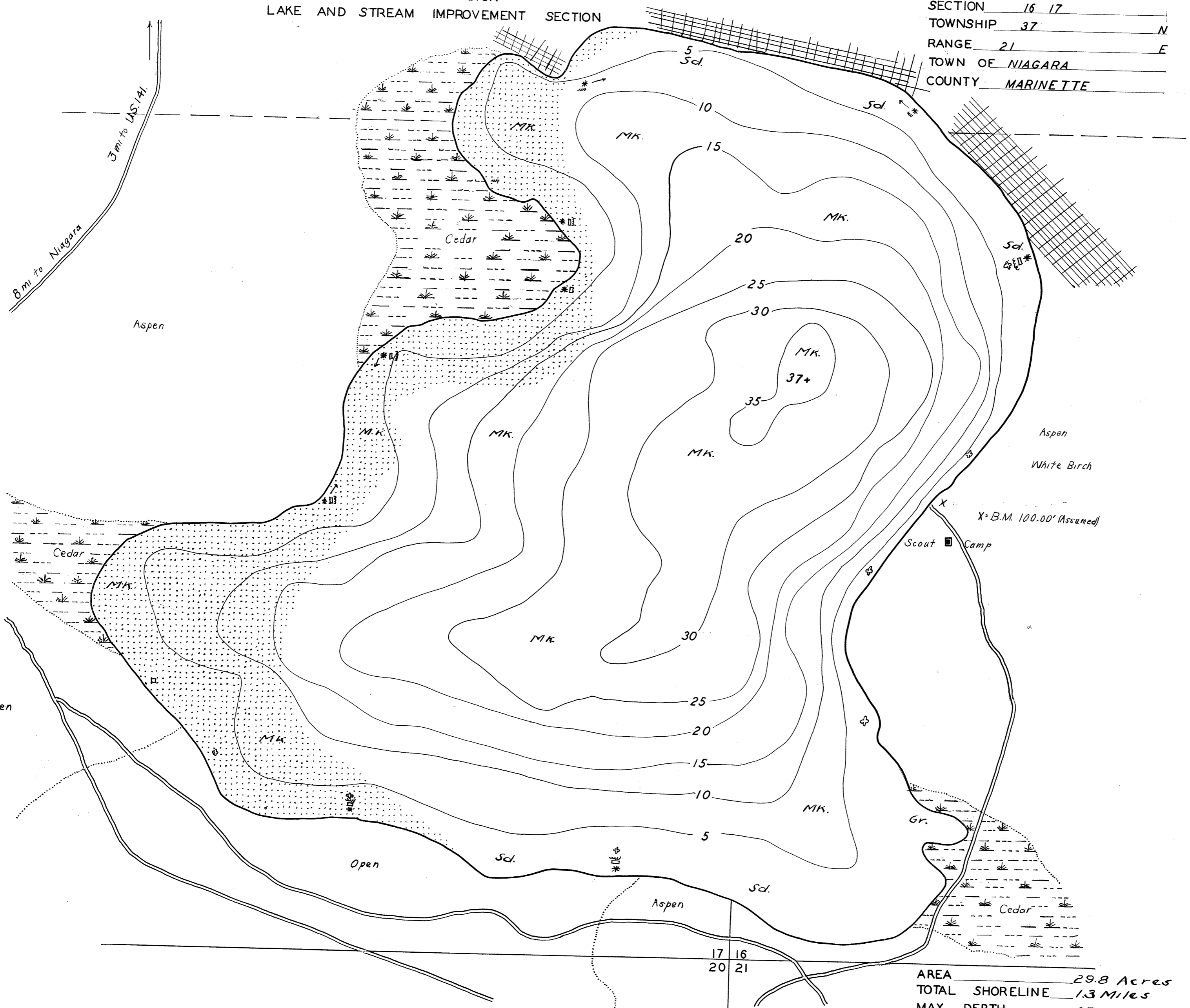

AREA 29.8 Acres
 TOTAL SHORELINE 1.3 Miles
 MAX DEPTH 37 FT.
 SCALE 1" = 120'

DATE FEB. 27, 1941
 COMPILED BY F. COUEY
 TRACED BY P.P.B. C.C.C.
 SOURCE OF INFORMATION
C.C.C. CAMP 90-S DUNBAR, WIS.
LAKE SURVEY PROJECT 198
A. PHOTO. FL. 15 B-30-51
 SOUNDINGS
80 FT INTERVALS
 DATES OF MAP REVISION _____
 WORK AGENCY C.C.C.

LAKE IMPROVEMENT RECORD

TYPE	DATE	1936-37		
BRUSH REFUGES		7		
SAPLING TANGLES		50		
SPAWNING BOXES		40		
MINNOW SPAWNERS		250		
TOTAL		347		

- LEGEND
- ⊙ WEED BEDS
 - ⊙ ROCKY SHOALS
 - Sd SAND
 - Cl CLAY
 - Gr GRAVEL
 - Mk MUCK
 - DWELLING
 - ABANDONED DWELLING
 - ⊠ RESORT

Source: Wisconsin Department of Natural Resources 608-266-2621
Timms Lake – Marinette County, Wisconsin DNR Lake Map
Date – February 1941 - Historical Lake Map - Not for Navigation
A Public Document - Please Identify the Source when using it.