

LAKE SURVEY MAP

SEIDEL LAKE FLORENCE COUNTY
SEC. 10, 15 T. 39- N. R. 17- E.

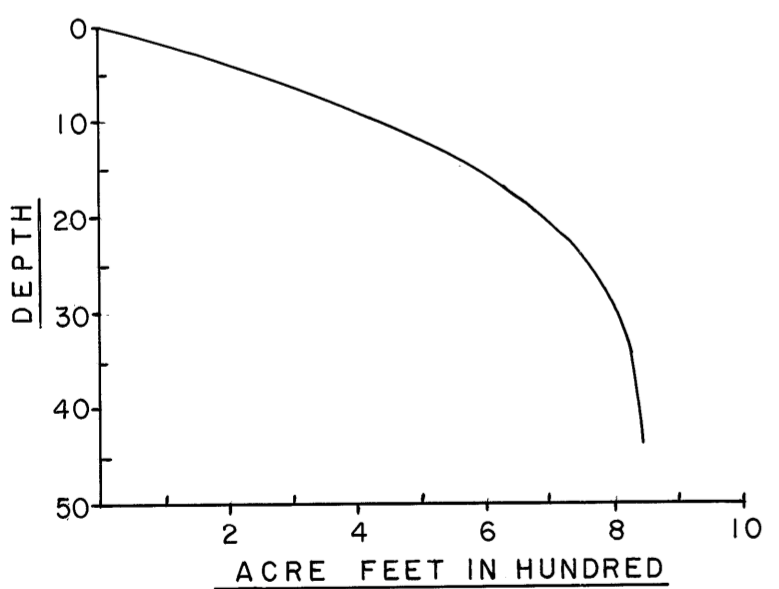
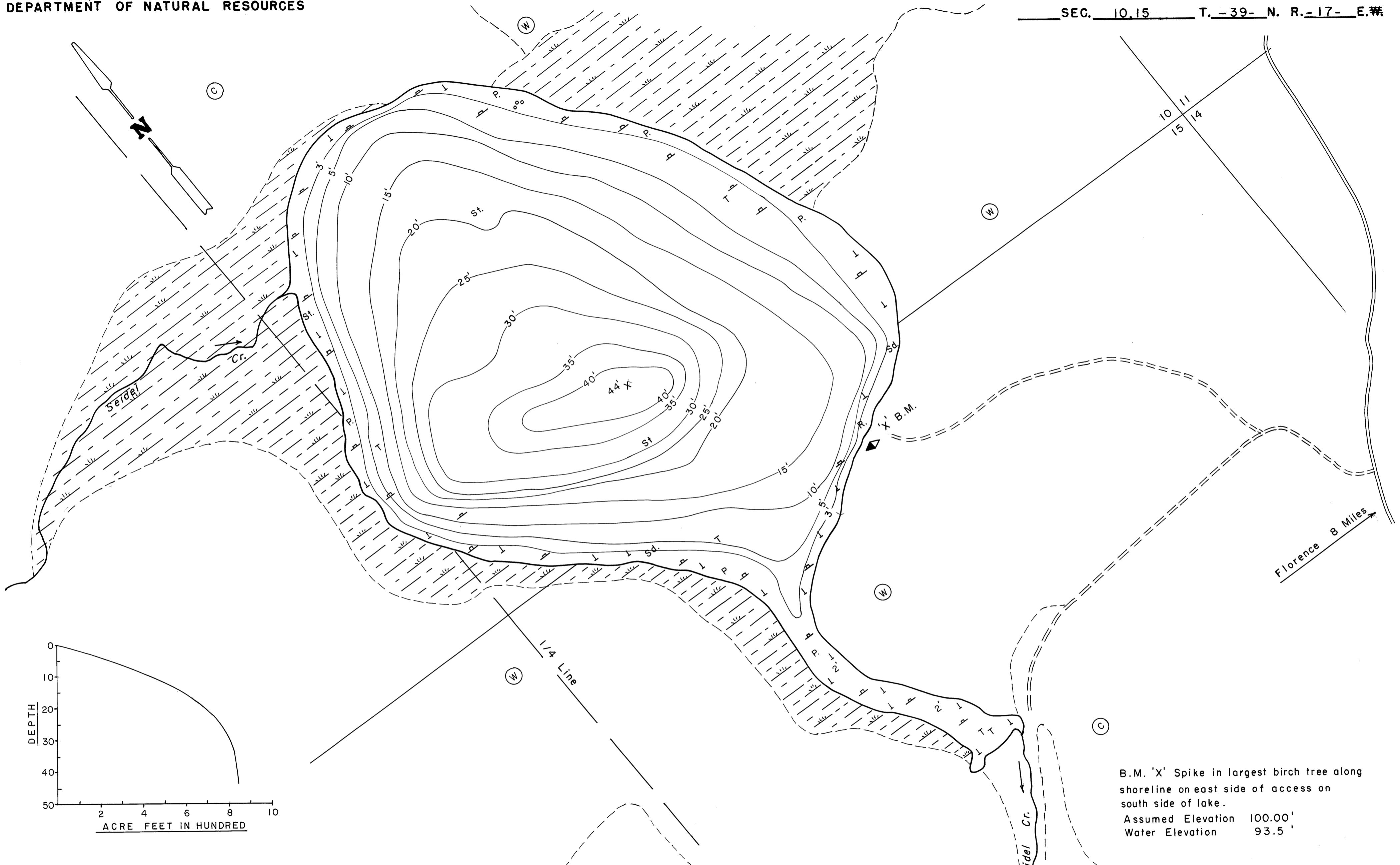

B.M. 'X' Spike in largest birch tree along shoreline on east side of access on south side of lake.
Assumed Elevation 100.00'
Water Elevation 93.5'

EQUIPMENT RECORDING SONAR MAPPED		JUNE 1975	
		MONTH	YEAR
TOPOGRAPHIC SYMBOLS		LAKE BOTTOM SYMBOLS	
(B) Brush	Steep slope	P. Peat	B Boulders
(PW) Partially wooded	- - - Indefinite shoreline	Mk. Muck	⊙ Stumps & Snags
(W) Wooded	Marsh	C. Clay	⊛ Rock danger to navigation
(C) Cleared	Spring	M. Marl	T Submergent vegetation
(P) Pastured	Intermittent stream	Sd. Sand	⊥ Emergent vegetation
(A) Agricultural	Permanent inlet	St. Silt	⊥ Floating vegetation
B.M. Bench Mark	Permanent outlet	Gr. Gravel	⊥ Brush shelters
■ Dwelling	Dam	R. Rubble	
▣ Resort	D.N.R. State owned land	Br. Bedrock	
▢ Camp			

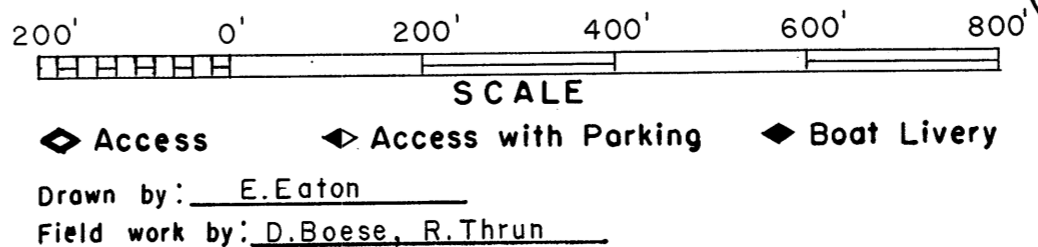

SPECIES OF FISH	Abundant Common Present		
	Abundant	Common	Present
Muskie			
N. Pike		X	
Walleye			
L.M. Bass	X		
S.M. Bass			
Panfish	X		
Trout			

WATER AREA 54.5 ACRES
 UNDER 3 FT. 13 %
 OVER 20 FT. 31 %
 MAX. DEPTH 44 FEET.
 TOTAL ALK. 51 P.P.M.
 VOLUME 843.4 ACRE FT.
 MAIN SHORELINE 1.44 MI.
 ISLAND SHORELINE MI.

Source: Wisconsin Department of Natural Resources 608-266-2621
Seidel Lake - Florence County, Wisconsin DNR Lake Map
Date: June 1975 - Historical Lake Map - Not for Navigation
A Public Document - Please Identify the Source when using it.