

# LAKE SURVEY MAP

LAKE WAPOSE  
 SECTION 25-26  
 TOWNSHIP 40 N  
 RANGE 14 E  
 TOWN OF ALVIN  
 COUNTY FOREST

FORM FI-117

WISCONSIN CONSERVATION DEPARTMENT  
 BIOLOGY DIVISION  
 LAKE AND STREAM IMPROVEMENT SECTION

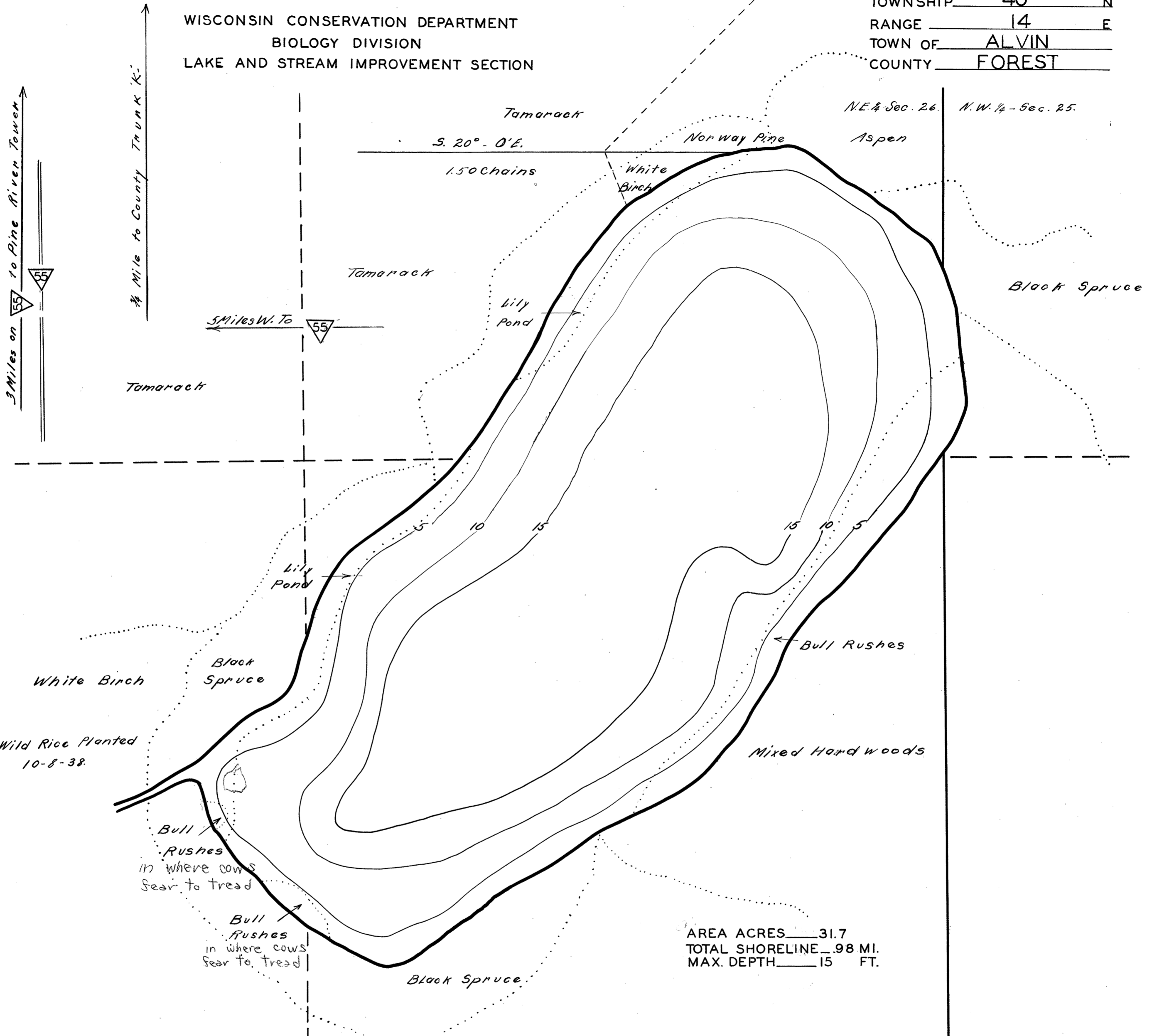

3 Miles on to Pine River Town

1/4 Mile to County Thunk 'K'

5 Miles W. To

S. 20° - 0'E.  
150 Chains

NE 1/4 - Sec. 26    NW 1/4 - Sec. 25

AREA ACRES 31.7  
 TOTAL SHORELINE .98 MI.  
 MAX. DEPTH 15 FT.

DATE OCT 16 1941  
 TRACED BY \_\_\_\_\_  
 COMPILED BY A.M.B. (W.P.A.)  
 SOURCE OF INFORMATION \_\_\_\_\_  
 U.S. FOREST LAKE & STREAM SURVEY  
 \_\_\_\_\_  
 \_\_\_\_\_  
 SOUNDINGS \_\_\_\_\_  
 \_\_\_\_\_  
 \_\_\_\_\_  
 DATES OF MAP REVISION \_\_\_\_\_  
 \_\_\_\_\_  
 \_\_\_\_\_  
 WORK AGENCY \_\_\_\_\_

TYPE	DATE	DATE	DATE	DATE
BRUSH REFUGES	_____	_____	_____	_____
SAPLING TANGLES	_____	_____	_____	_____
SPAWNING BOXES	_____	_____	_____	_____
MINNOW SPAWNERS	_____	_____	_____	_____
TOTAL	_____	_____	_____	_____

SCALE 1 INCH EQUALS 165 FT.

- LEGEND
- WEED BEDS
  - ROCKY SHOALS
  - SD. SAND
  - CL. CLAY
  - GR. GRAVEL
  - MK. MUCK
  - DWELLING
  - ABANDONED DWELLING
  - RESORT

Checked  
 W.P.S.  
 E.M.K.  
 Nov. 6, 1941

Source: Wisconsin Department of Natural Resources 608-266-2621  
Wapose Lake - Forest County, Wisconsin DNR Lake Map  
Date Oct 1941- Historical Lake Map - Not for Navigation  
A Public Document - Please Identify the Source when using it.