

EQUIPMENT ECHO SOUNDING
 REVISED JUNE 1967
 MAPPED NOV 1954
 MO. YR.

- TOPOGRAPHIC SYMBOLS
- (B) Brush
 - (W) Partially wooded
 - (W) Wooded
 - (C) Cleared
 - (P) Pastured
 - (A) Agricultural
 - B.M. Bench Mark
 - Dwelling
 - Resort
 - ||||| Steep slope
 - ~ Indefinite shoreline
 - Marsh
 - Spring
 - Intermittent stream
 - Permanent inlet
 - Permanent outlet
 - Dam

- LAKE BOTTOM SYMBOLS
- P. Peat
 - Mk. Muck
 - C. Clay
 - M. Mari
 - Sd. Sand
 - St. Silt
 - Gr. Gravel
 - R. Rubble
 - Br. Bedrock
 - T Submergent vegetation
 - ∟ Emergent vegetation
 - ≡ Floating vegetation
 - % Stumps & Snags

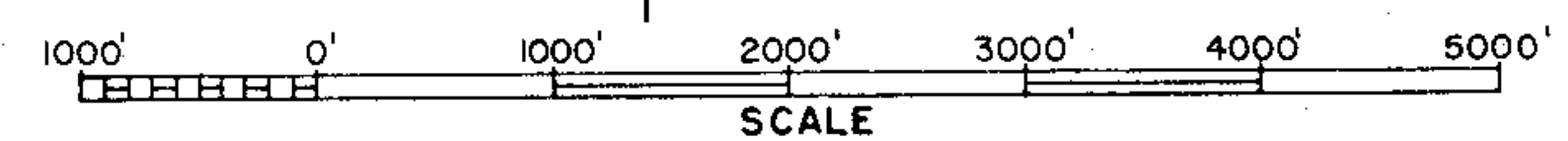

◇ Access ◇ Access with Parking ◆ Boat Livery
 Field work by: H. Schwenn, R. Spielman Drawn by: C. Holt

SPECIES OF FISH		
	Abundant	Common
Muskie		
N. Pike		X
Walleye		X
L.M. Bass	X	
S.M. Bass	X	
Panfish	X	
Trout		X

AREA 5262.4 ACRES
 UNDER 3FT. 1 %
 OVER 20FT. 77 %
 VOLUME 320,984.0 ACRE FT.
 TOTAL ALK. 171 P.P.M.
 SHORELINE 20.2 MILES
 MAX. DEPTH 135 FEET

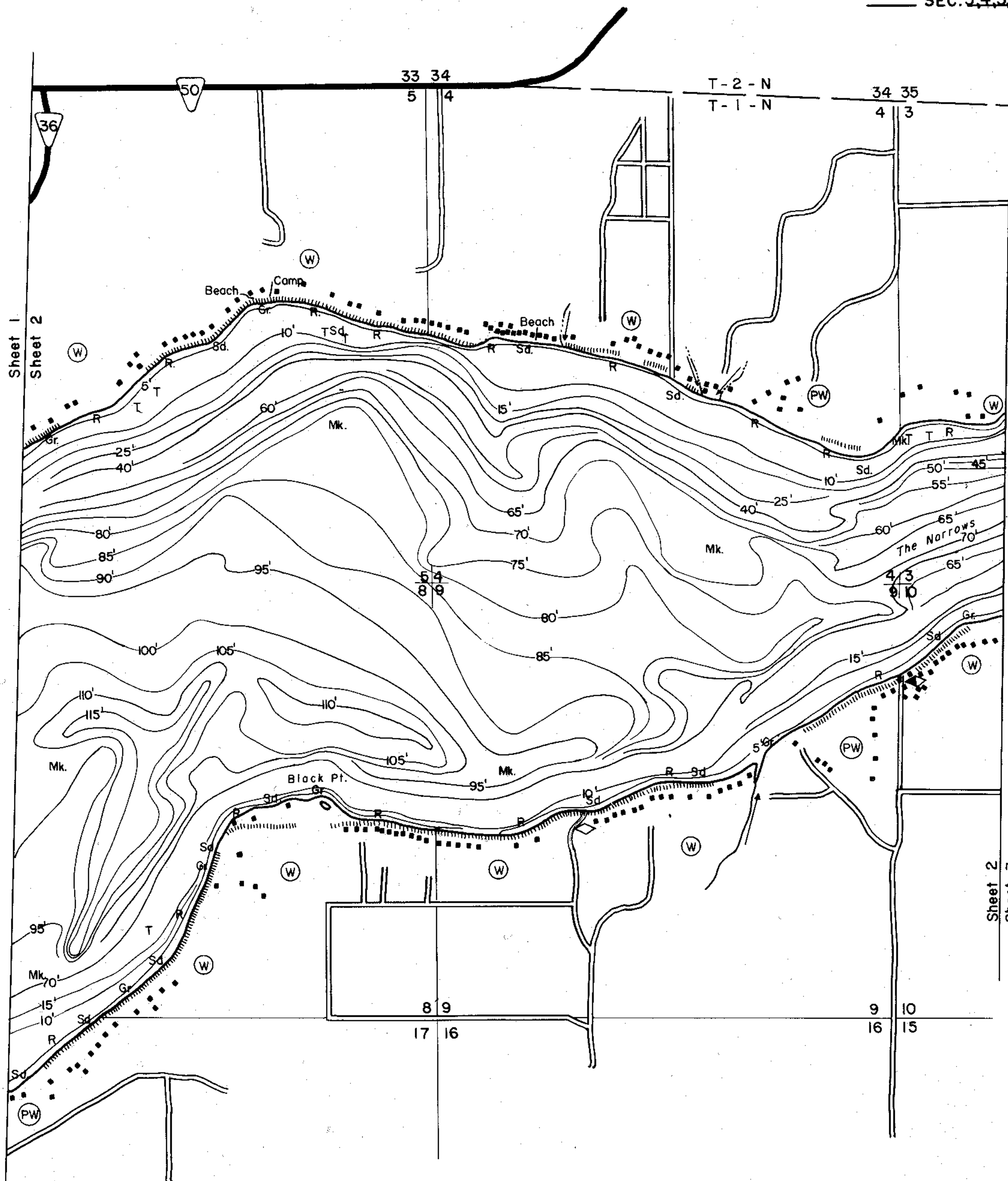

REVISOR MAPPED JUNE NOV 1967 1954
MO. YR.

EQUIPMENT ECHO SOUNDER

- TOPOGRAPHIC SYMBOLS
- (B) Brush
 - (PW) Partially wooded
 - (W) Wooded
 - (C) Cleared
 - (P) Pastured
 - (A) Agricultural
 - B.M. Bench Mark
 - Dwelling
 - Resort
 - ||||| Steep slope
 - - - Indefinite shoreline
 - Marsh
 - o Spring
 - Intermittent stream
 - Permanent inlet
 - Permanent outlet
 - Dam

- LAKE BOTTOM SYMBOLS
- P. Peat
 - Mk. Muck
 - C. Clay
 - M. Marl
 - Sd. Sand
 - St. Silt
 - Gr. Gravel
 - R. Rubble
 - Br. Bedrock
 - T Submergent vegetation
 - Emergent vegetation
 - Floating vegetation
 - Stumps & Snags

WATER ELEV. 95.94

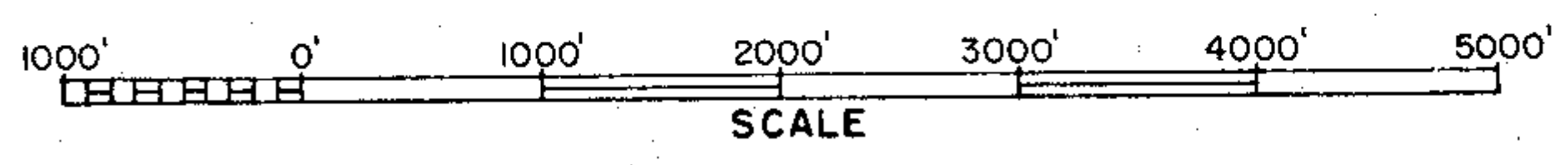

Access Access with Parking Boat Livery
Field work by: H. Schwenn, R. Spielmon Drawn by: C. Holt

SPECIES OF FISH	Abundance	
	Abundant	Rare
Muskie		
N. Pike		X
Walleye		X
L. M. Bass	X	
S. M. Bass	X	
Panfish	X	
Trout		X

AREA 5262.4 ACRES
UNDER 3 FT. 1%
OVER 20 FT. 77%
VOLUME 320,984.0 ACRE FT.
TOTAL ALK. 171 P.P.M.
SHORELINE 20.2 MILES
MAX. DEPTH 135 FEET

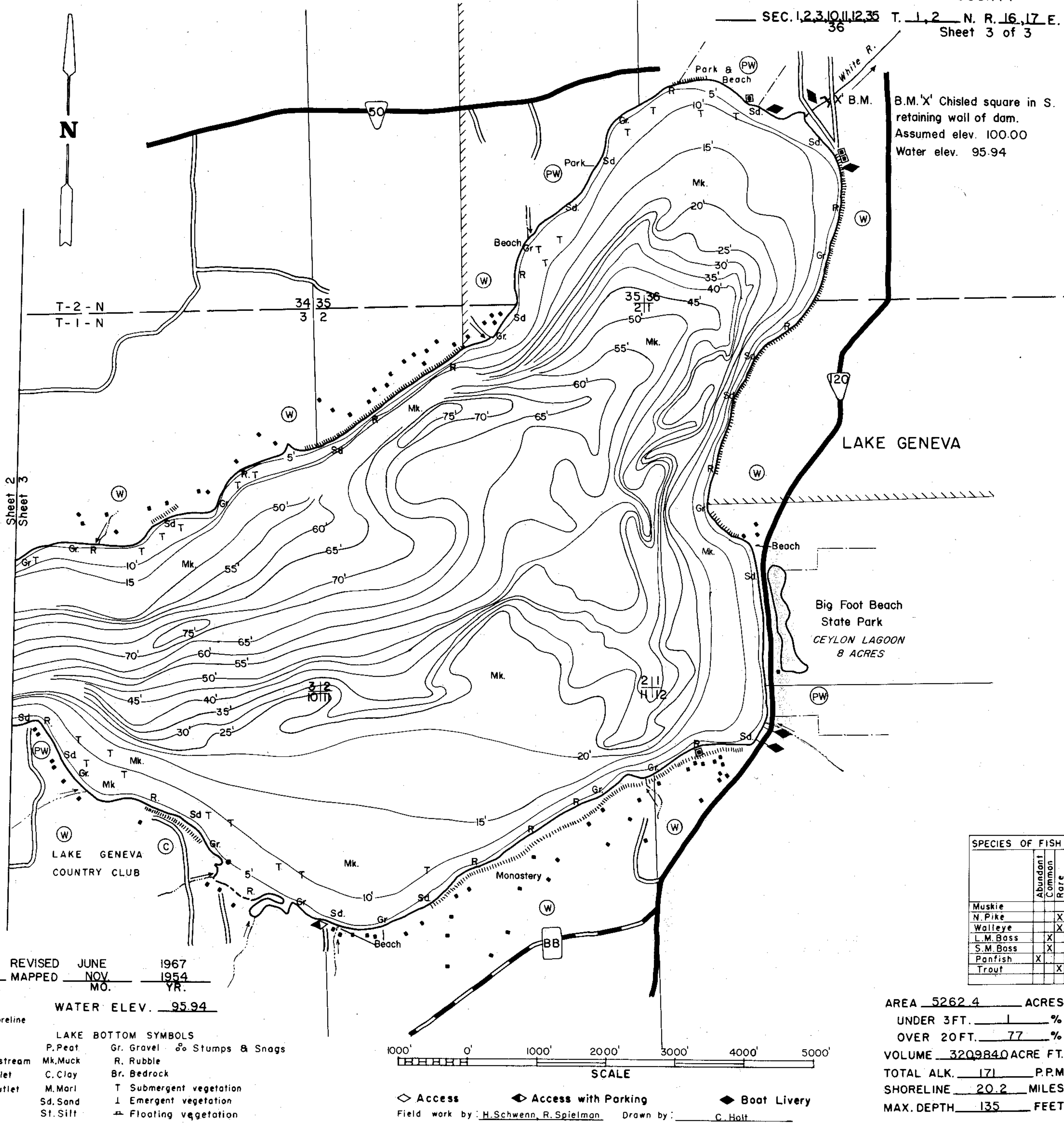

B.M. 'X' Chisled square in S. retaining wall of dam.
Assumed elev. 100.00
Water elev. 95.94

Sheet 2
Sheet 3

T-2-N
T-1-N

34 35
3 2

LAKE GENEVA

Big Foot Beach
State Park
CEYLON LAGOON
8 ACRES

LAKE GENEVA
COUNTRY CLUB

Monastery

EQUIPMENT ECHO SOUNDER REVISIED JUNE 1967
MAPPED NOV 1954
MO. YR.

WATER ELEV. 95.94

- TOPOGRAPHIC SYMBOLS
- (B) Brush
 - (PW) Partially wooded
 - (W) Wooded
 - (C) Cleared
 - (P) Pastured
 - (A) Agricultural
 - B.M. Bench Mark
 - Dwelling
 - Resort
 - ||||| Steep slope
 - - - Indefinite shoreline
 - Marsh
 - o Spring
 - Intermittent stream
 - Permanent inlet
 - Permanent outlet
 - Dam

- LAKE BOTTOM SYMBOLS
- P. Peat
 - Mk. Muck
 - C. Clay
 - M. Marl
 - Sd. Sand
 - St. Silt
 - Gr. Gravel
 - R. Rubble
 - Br. Bedrock
 - Stumps & Snags
 - T Submergent vegetation
 - E Emergent vegetation
 - F Floating vegetation

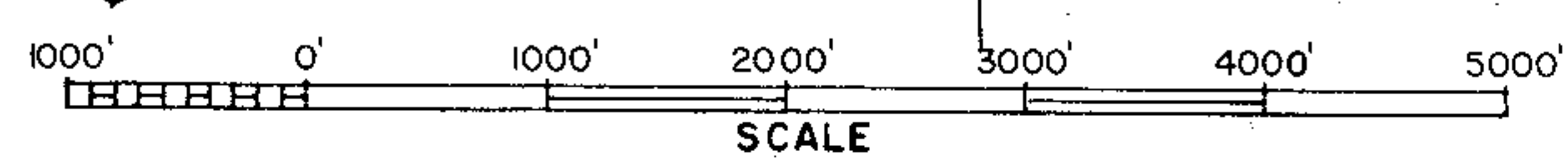

- ◇ Access
 - ◊ Access with Parking
 - ◆ Boat Livery
- Field work by: H. Schwenn, R. Spielman Drawn by: C. Holt

SPECIES OF FISH		
	Abundant	Rare
Muskie		
N. Pike		X
Walleye		X
L.M. Bass	X	
S.M. Bass	X	
Panfish	X	
Trout		X

AREA 5262.4 ACRES
UNDER 3FT. 1 %
OVER 20FT. 77 %
VOLUME 320984.0 ACRE FT.
TOTAL ALK. 171 P.P.M.
SHORELINE 20.2 MILES
MAX. DEPTH 135 FEET

Source: Wisconsin Department of Natural Resources 608-266-2621
Geneva Lake – Walworth County, Wisconsin DNR Lake Map
Date – Jun 1967 - Historical Lake Map - Not for Navigation
A Public Document - Please Identify the Source when using it.