

(W)

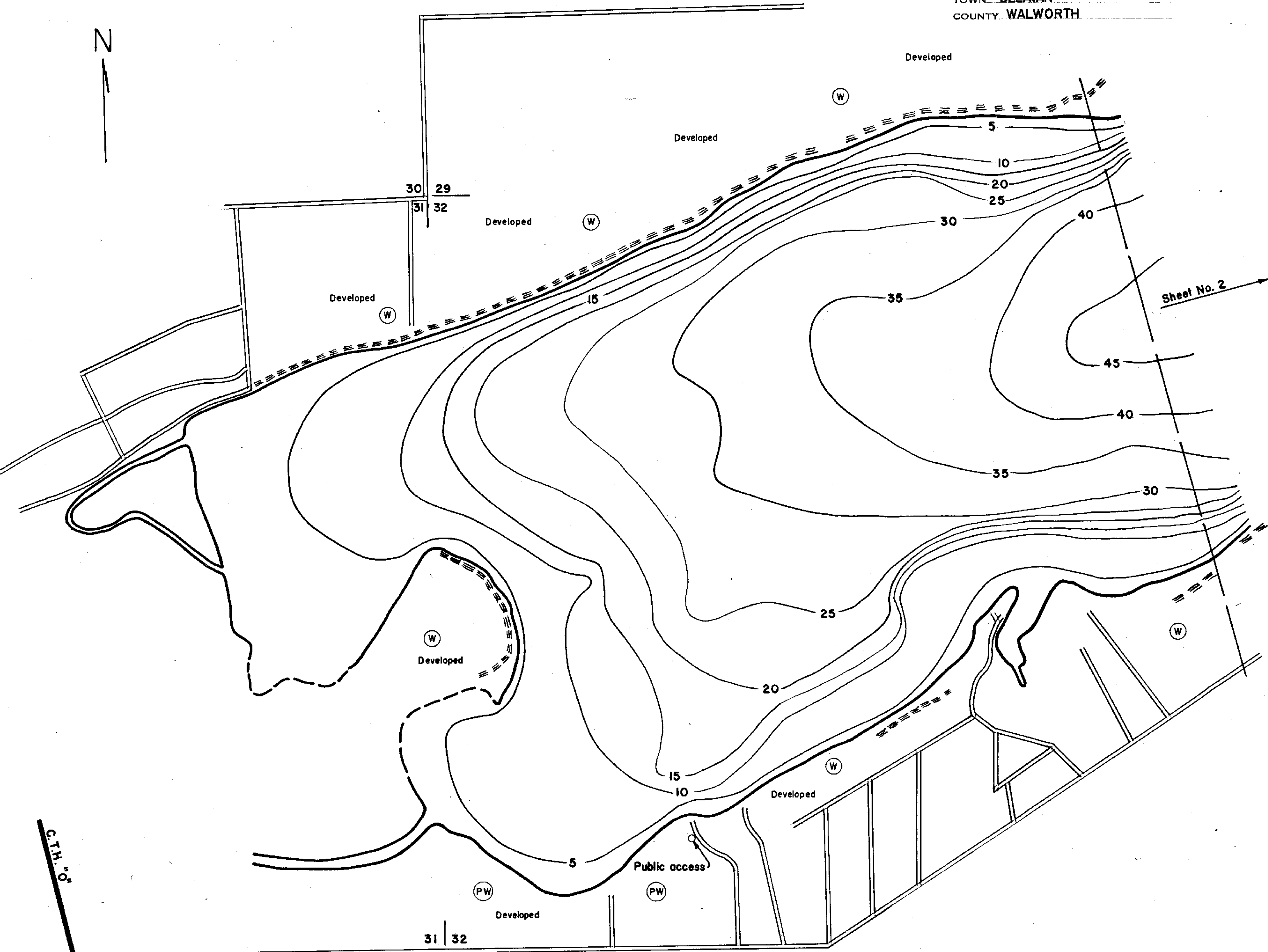

DATE 11/22/54
SOURCE OF INFORMATION W.C.D.
Contours at 5' intervals
SOUNDINGS Echo sounder

AREA 1,774.8 Acres (Total)
TOTAL SHORELINE 12.82 Miles
MAX. DEPTH 52 Feet
SCALE: 1"=500'

LAKE DELAVAN (Sheet 2 of 3)
SECTION 27-28-29-32-33
TOWNSHIP 2-N
RANGE 16-E
TOWN DELAVAN
COUNTY WALWORTH

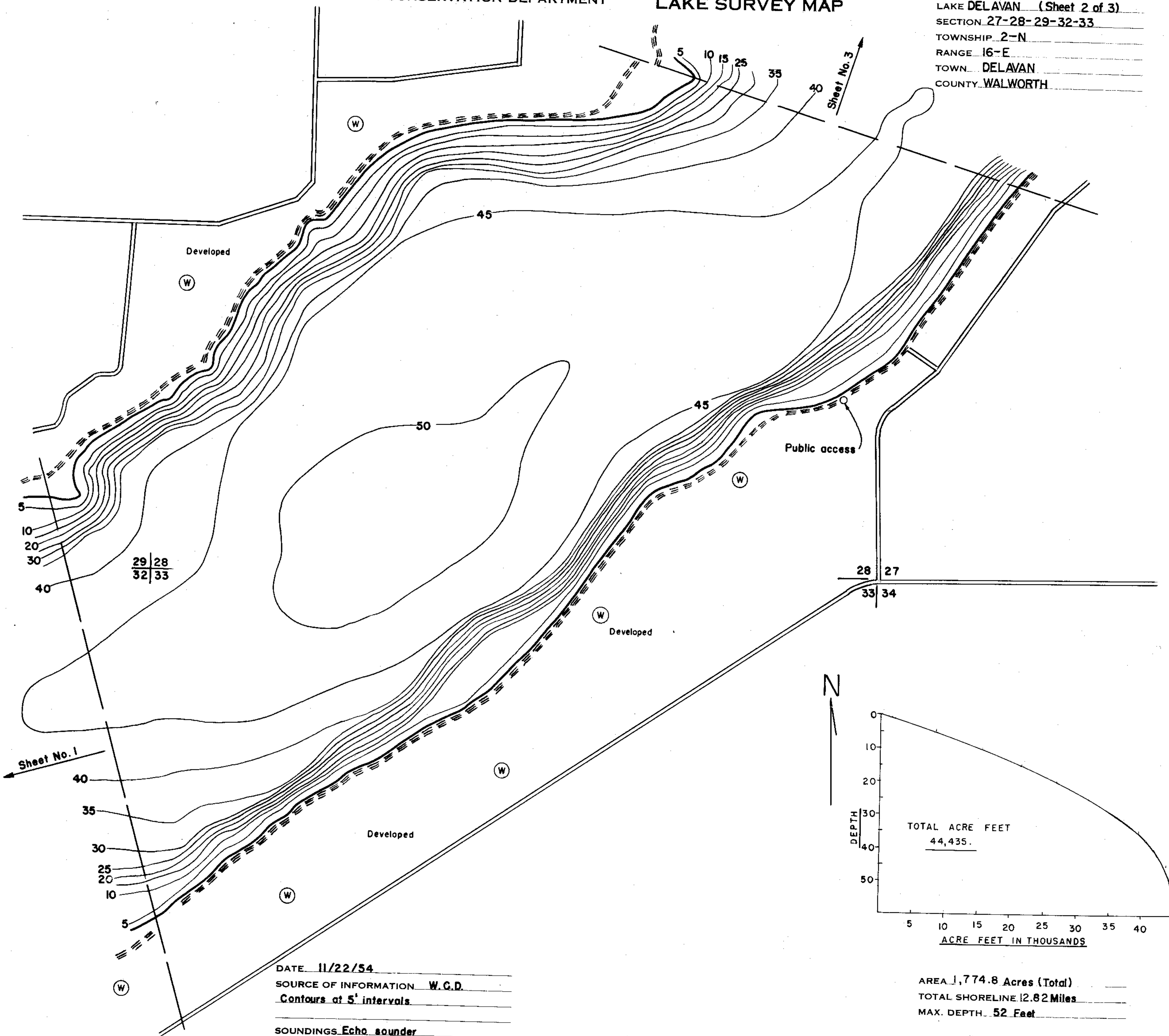

Sheet No. 1

Sheet No. 3

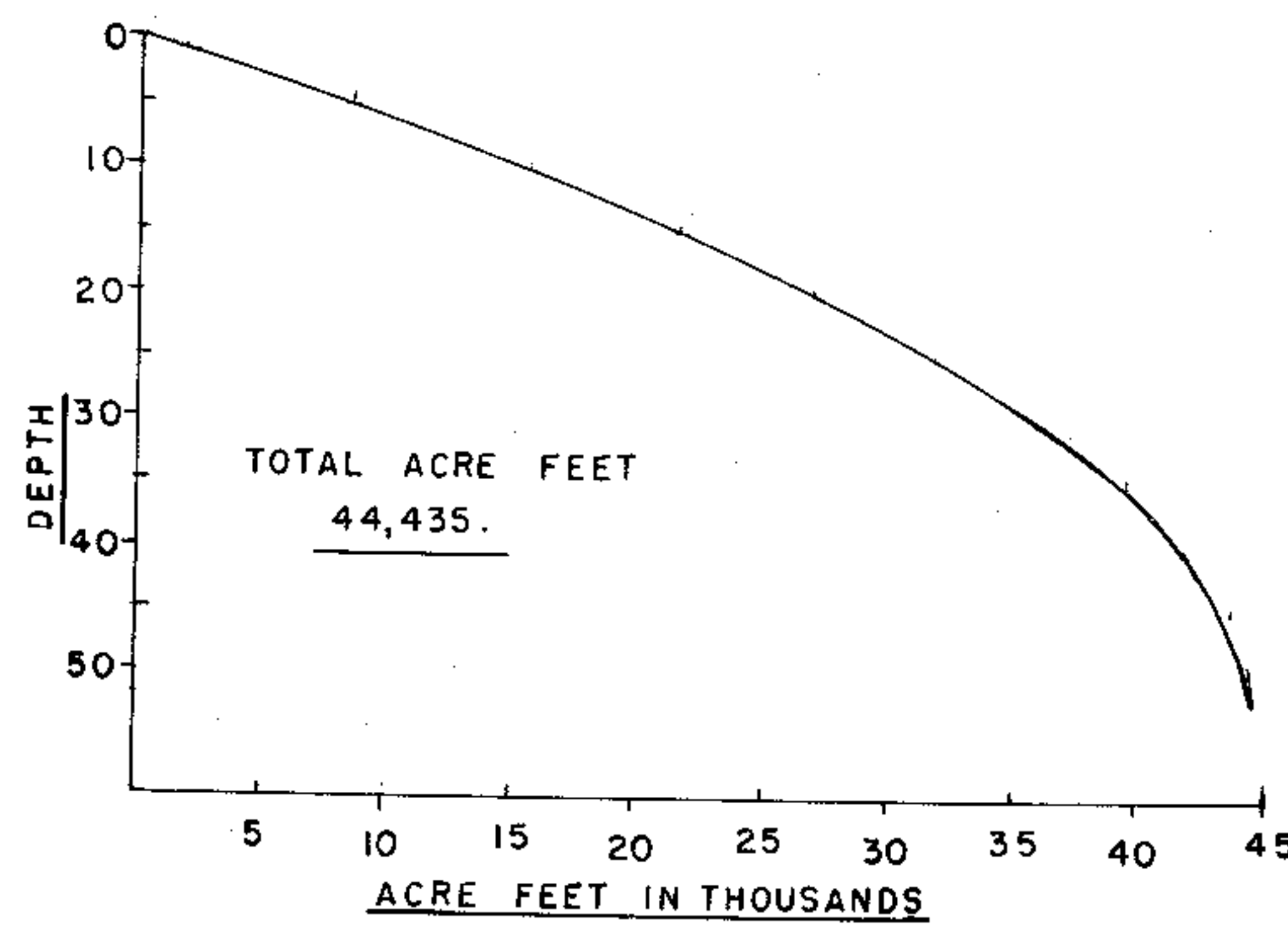

DATE 11/22/54
 SOURCE OF INFORMATION W.C.D.
Contours at 5' intervals
 SOUNDINGS Echo sounder

AREA 1,774.8 Acres (Total)
 TOTAL SHORELINE 12.82 Miles
 MAX. DEPTH 52 Feet
 SCALE: 1" = 500'

LAKE DELAVAN (Sheet 3 of 3)
SECTION 21-22-27-28
TOWNSHIP 2-N
RANGE 16-E
TOWN DELAVAN
COUNTY WALWORTH

Developed

Developed

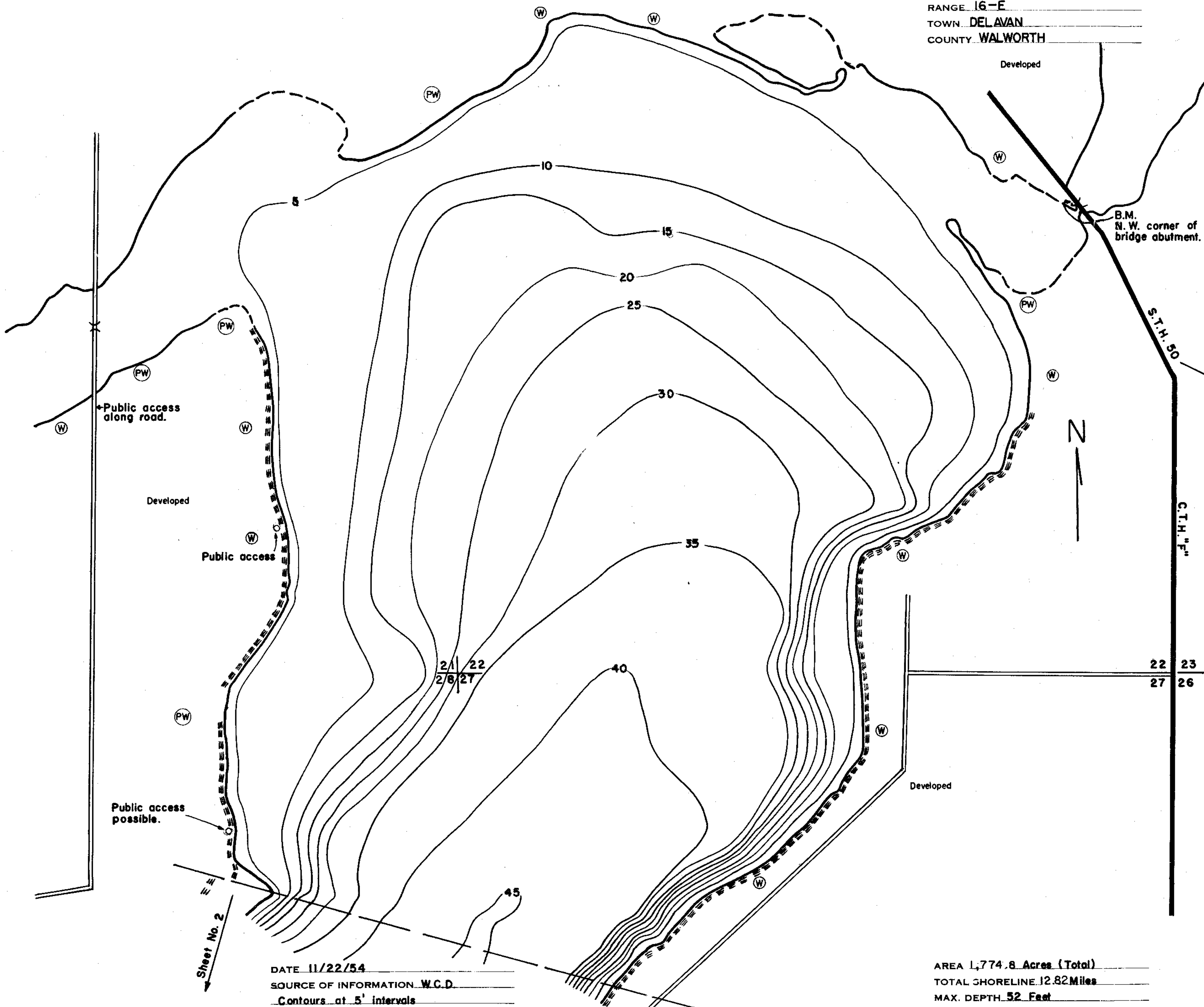

Public access along road.

Public access

Public access possible.

B.M. N.W. corner of bridge abutment.

S.T.H. 50

C.T.H. 100

22 23
27 26

Sheet No. 2

DATE 11/22/54
SOURCE OF INFORMATION W.C.D.
Contours at 5' intervals
SOUNDINGS Echo sounder

AREA 1,774.8 Acres (Total)
TOTAL SHORELINE 12.82 Miles
MAX. DEPTH 52 Feet

SCALE: 1" = 500'

Source: Wisconsin Department of Natural Resources 608-266-2621
Delavan Lake – Walworth County, Wisconsin DNR Lake Map
Date – Nov 1954 - Historical Lake Map - Not for Navigation
A Public Document - Please Identify the Source when using it.