

LAKE SURVEY MAP

LAKE NORTH LAKE FORM FI-117  
 SECTION 16-17-20-21  
 TOWNSHIP 8 N  
 RANGE 18 E  
 TOWN OF NORTH LAKE  
 COUNTY WAUKESHA

WISCONSIN CONSERVATION DEPARTMENT  
 BIOLOGY DIVISION  
 LAKE AND STREAM IMPROVEMENT SECTION

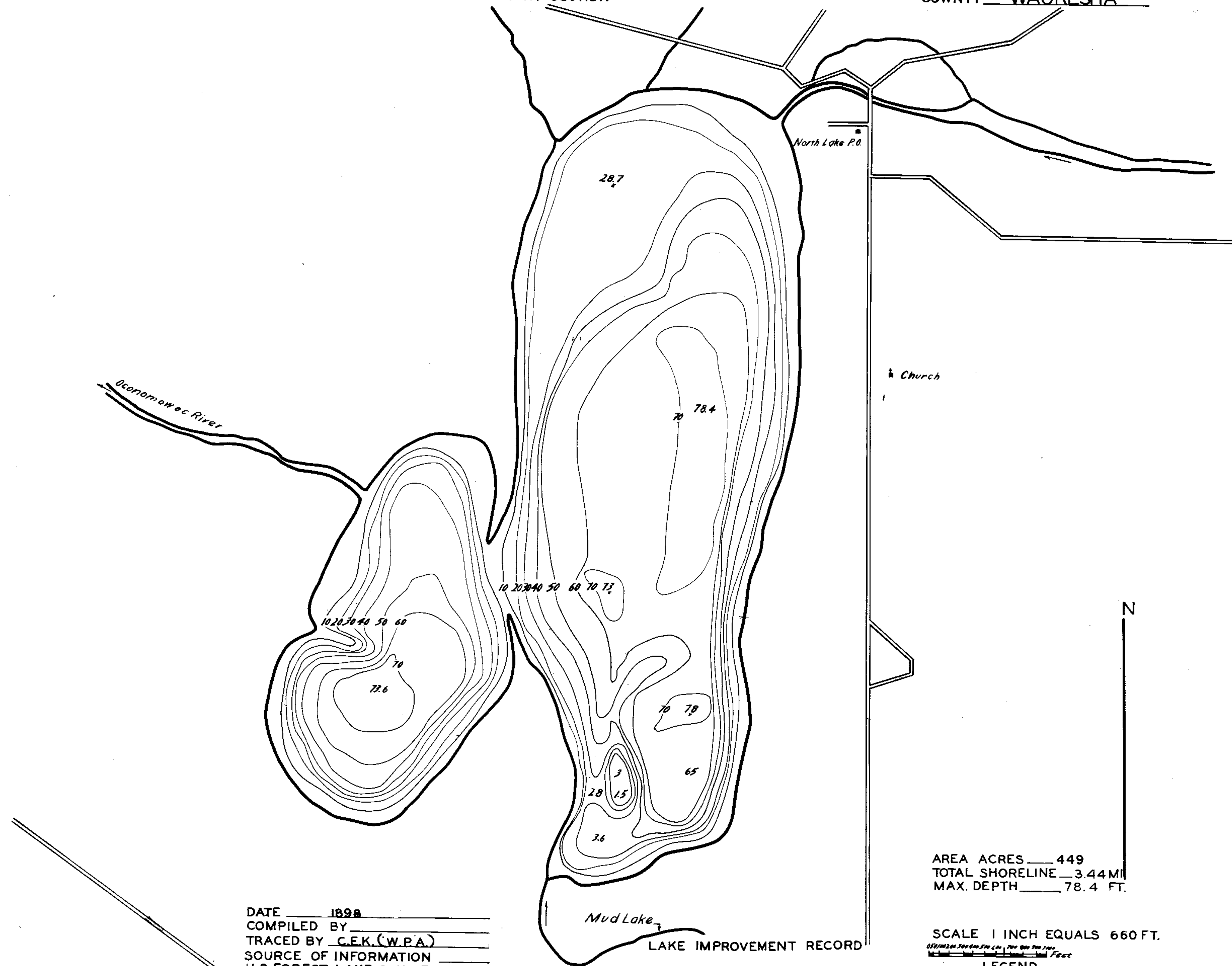

AREA ACRES 449  
 TOTAL SHORELINE 3.44 MI  
 MAX. DEPTH 78.4 FT.

SCALE 1 INCH EQUALS 660 FT.  
0 100 200 300 400 500 600 700 800 900 1000 Feet

- LEGEND
- WEED BEDS
  - ROCKY SHOALS
  - SD. SAND
  - CL. CLAY
  - GR. GRAVEL
  - MK. MUCK
  - DWELLING
  - ABANDONE DWELLING
  - RESORT

DATE 1898  
 COMPILED BY \_\_\_\_\_  
 TRACED BY C.E.K. (W.P.A.)  
 SOURCE OF INFORMATION \_\_\_\_\_  
 U.S. FOREST LAKE & STREAM SURVEY  
 SOUNDINGS \_\_\_\_\_  
 DATES OF MAP REVISION \_\_\_\_\_  
 OCT. 21 1941  
 WORK AGENCY \_\_\_\_\_

LAKE IMPROVEMENT RECORD

Source: Wisconsin Department of Natural Resources 608-266-2621

North Lake – Waukesha County, Wisconsin DNR Lake Map

Date – 1898 - Historical Lake Map - Not for Navigation

A Public Document - Please Identify the Source when using it.