

LAKE SURVEY MAP

LAKE ALVA
 SECTION 10-11
 TOWNSHIP 37 N
 RANGE 7 E
 TOWN OF TOMAHAWK LAKE
 COUNTY ONEIDA

FORM FH-17

WISCONSIN CONSERVATION DEPARTMENT
 BIOLOGY DIVISION
 LAKE AND STREAM IMPROVEMENT SECTION



AREA 202.6 AC
 TOTAL SHORELINE 3.6 Mi.
 MAX DEPTH 43 Ft.

DATE Mar 27 1941
 COMPILED BY _____
 TRACED BY RA-NLM (WPA)
 SOURCE OF INFORMATION
WPA Lake Survey Project
Jan 1941
 SOUNDINGS At 16.5 Ft Intervals
 DATES OF MAP REVISION _____
 WORK AGENCY W. P. A.

LAKE IMPROVEMENT RECORD

TYPE	DATE	1937	1938	1939	1940	1941
⊕ BRUSH REFUGES		19				
~ SAPLING TANGLES		95				
□ SPAWNING BOXES						
* MINNOW SPAWNERS		152				
TOTAL		266				

SCALE 1 inch Equals 330 Ft.

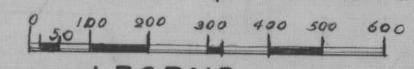

LEGEND

- ⊕ WEED BEDS
- ~ ROCKY SHOALS
- Sd SAND
- Cl. CLAY
- Gr GRAVEL
- Mk MUCK
- DWELLING
- ABANDONED DWELLING
- ▣ RESORT

LAKE SURVEY MAP

LAKE ALVA
 SECTION 10-11
 TOWNSHIP 37 N
 RANGE 7 E
 TOWN OF TOMAHAWK LAKE
 COUNTY ONEIDA

FORM FH17

ENT
 ECTION

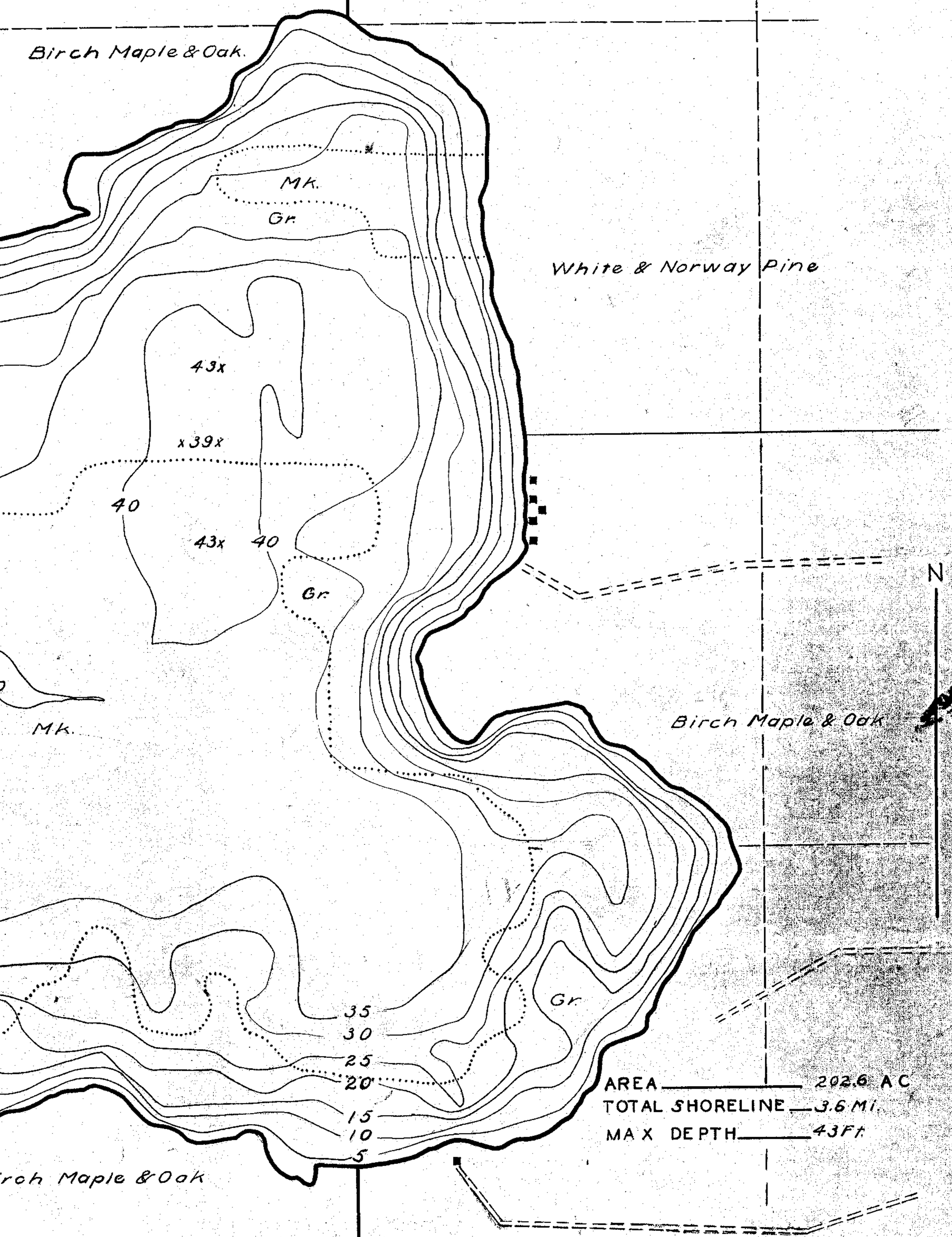

AREA 202.6 AC
 TOTAL SHORELINE 3.6 MI.
 MAX DEPTH 43 FT.

SCALE 1 inch Equals 330 Ft.



LAKE IMPROVEMENT RECORD

TYPE	DATE			
BRUSH REFUGES	<u>1937</u>			
SAPLING TANGLES	<u>19</u>			
SPAWNING BOXES	<u>95</u>			
MINNOW SPAWNERS	<u>152</u>			
TOTAL	<u>266</u>			

LEGEND

- WEED BEDS
- ROCKY SHOALS
- Sd.* SAND
- Cl.* CLAY
- Gr.* GRAVEL
- Mk.* MUCK
- DWELLING
- ABANDONED DWELLING
- RESORT

WISCONSIN CONSERVATION DEPARTMENT
BIOLOGY DIVISION
LAKE AND STREAM IMPROVEMENT SECTION

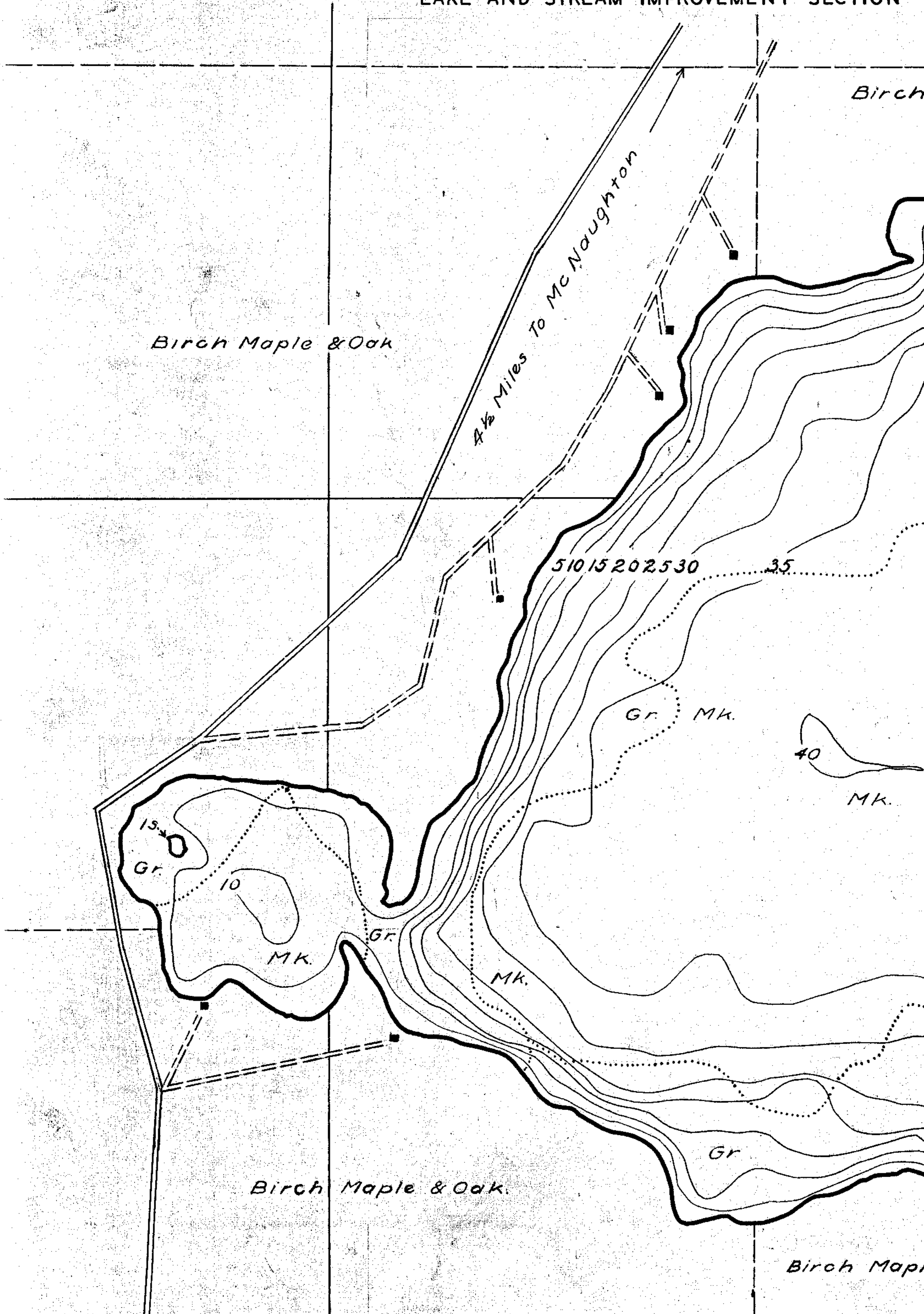

DATE Mar 27 1941
 COMPILED BY _____
 TRACED BY RA-NLM (WPA)
 SOURCE OF INFORMATION _____
WPA Lake Survey Project
Jan 1941
 SOUNDINGS At 16.5 Ft Intervals

DATES OF MAP REVISION _____

WORK AGENCY W. P. A.

- TYPE
- ⊕ BRUSH REFU
 - ~ SAPLING TA
 - SPAWNING
 - * MINNOW SPA

Source: Wisconsin Department of Natural Resources 608-266-2621
Alva Lake – Oneida County, Wisconsin DNR Lake Map
Date – Mar 1941 - Historical Lake Map - Not for Navigation
A Public Document - Please Identify the Source when using it.