

LAKE SURVEY MAP

WISCONSIN CONSERVATION DEPARTMENT
BIOLOGY DIVISION

LAKE CURTIS LAKE
SECTION 8
TOWNSHIP 39 N
RANGE 6 E
TOWN OF MINOCQUA
COUNTY ONEIDA

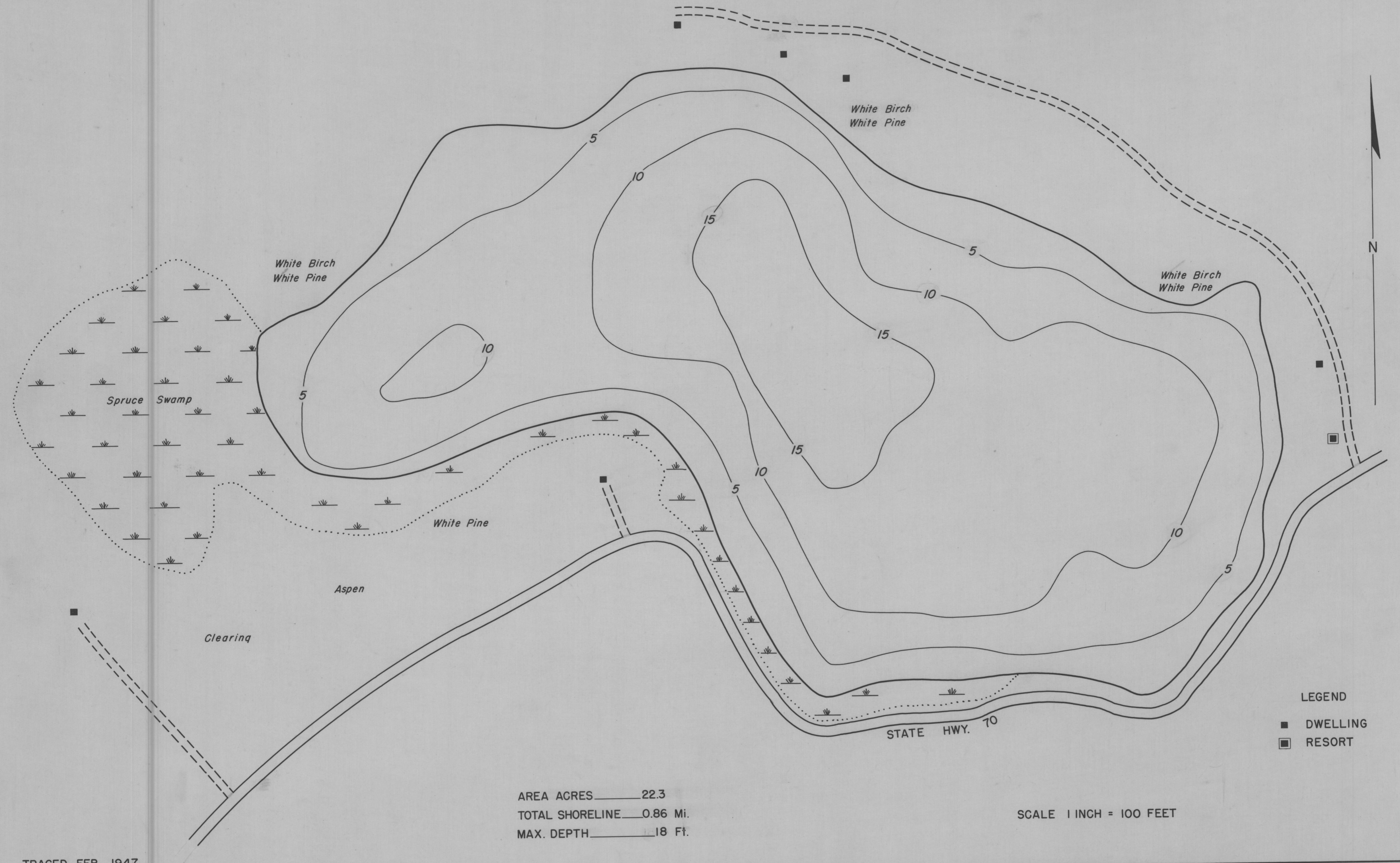

LEGEND

- DWELLING
- RESORT

AREA ACRES 22.3
TOTAL SHORELINE 0.86 Mi.
MAX. DEPTH 18 Ft.

SCALE 1 INCH = 100 FEET

TRACED FEB. 1947

SURVEY MAP

LAKE CURTIS LAKE
SECTION 8
TOWNSHIP 39 N
RANGE 6 E
TOWN OF MINOCQUA
COUNTY ONEIDA

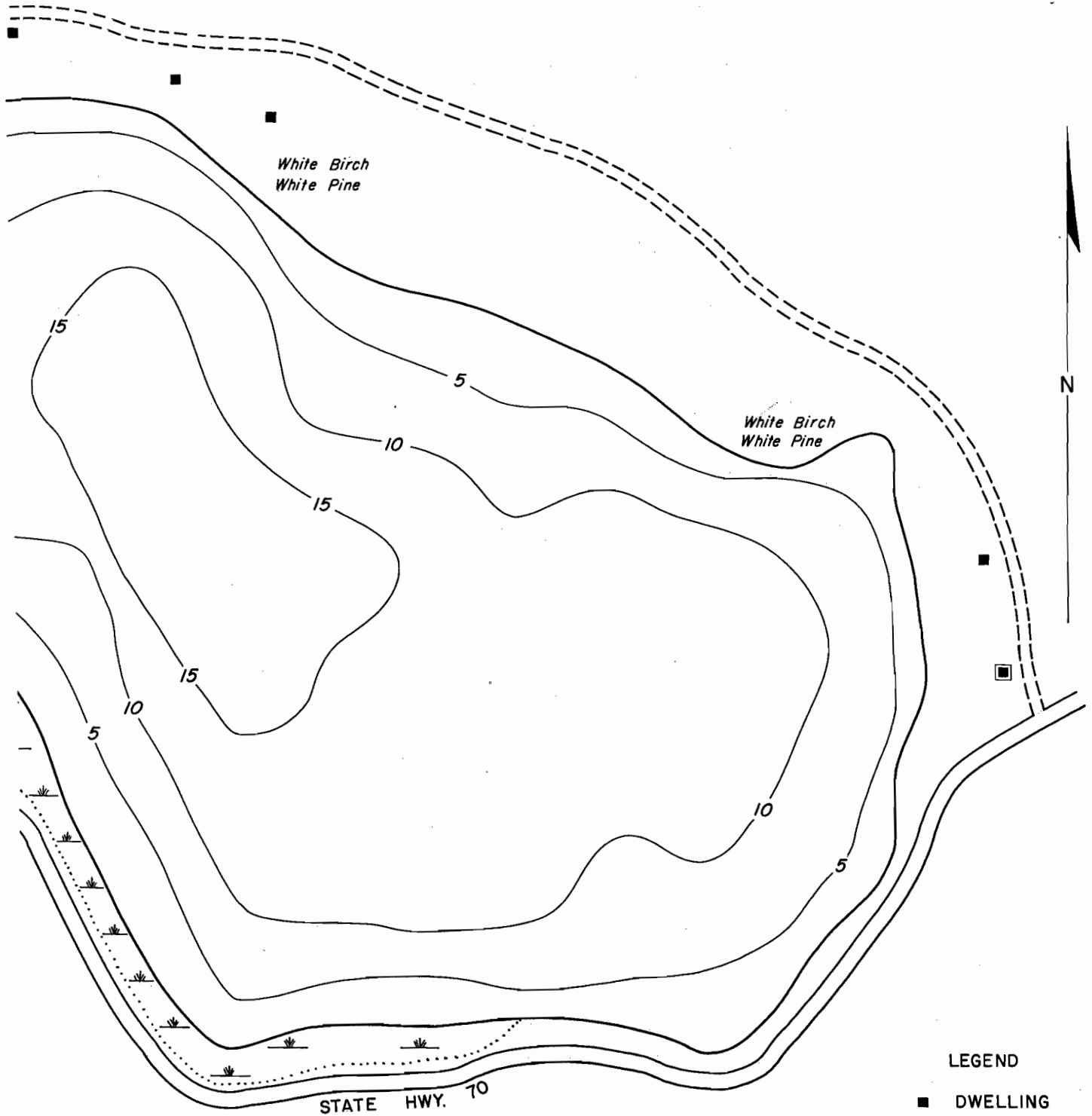

SCALE 1 INCH = 100 FEET

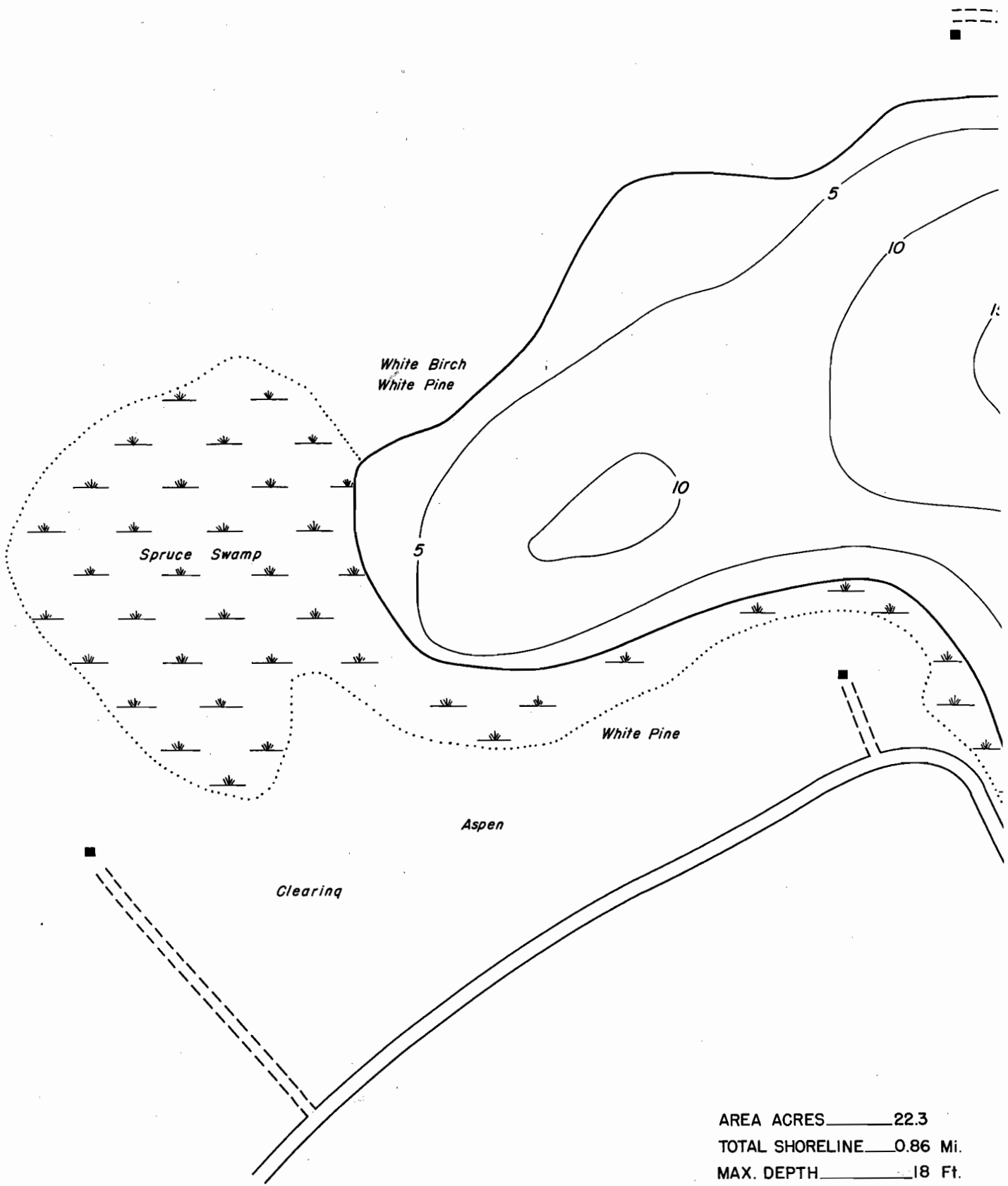

AREA ACRES _____ 22.3
TOTAL SHORELINE _____ 0.86 Mi.
MAX. DEPTH _____ 18 Ft.

Source: Wisconsin Department of Natural Resources 608-266-2621
Curtis Lake – Oneida County, Wisconsin DNR Lake Map
Date – Feb 1947 - Historical Lake Map - Not for Navigation
A Public Document - Please Identify the Source when using it.