

North Two Lake
146.2 Acres
47 Ft. Deep

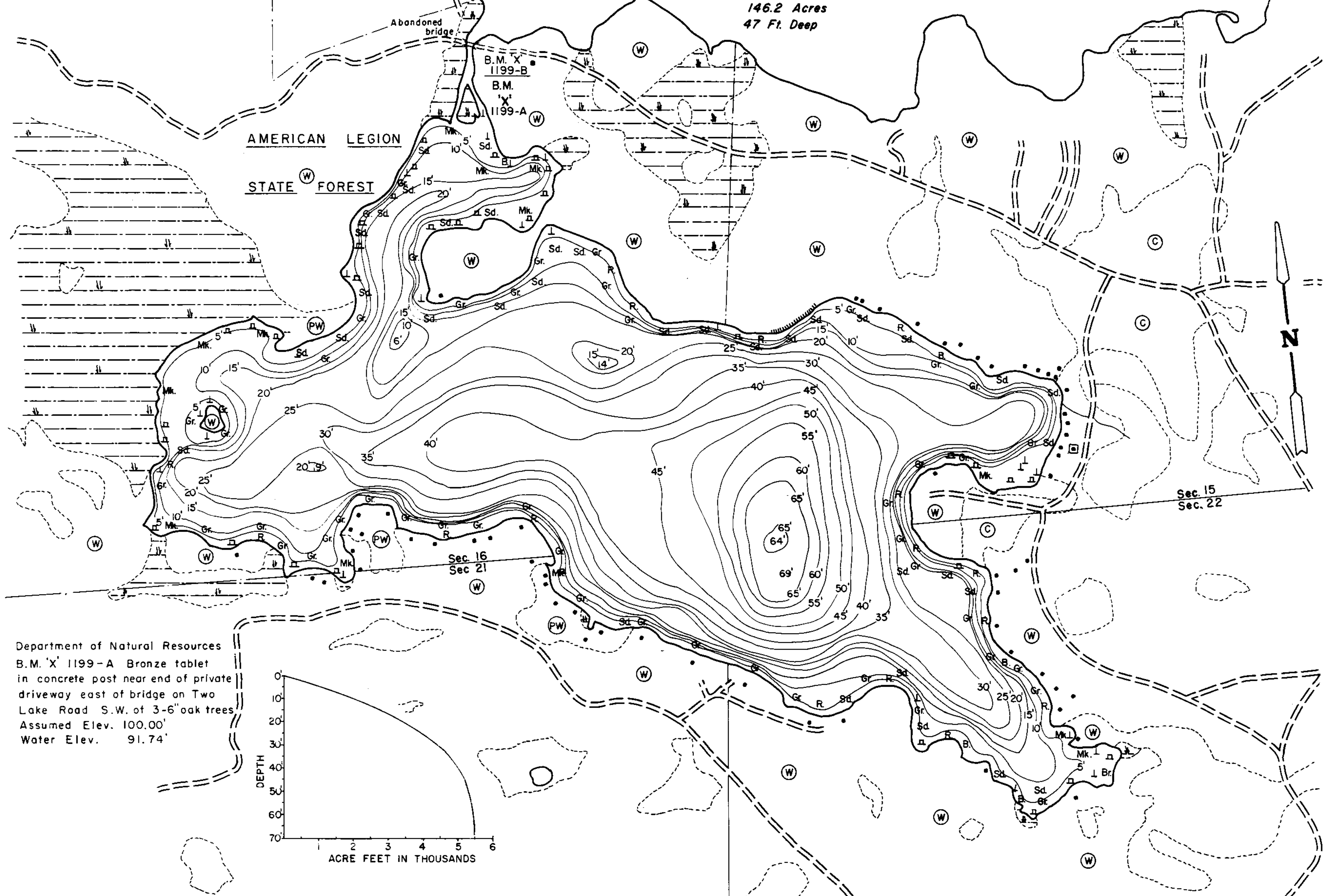

Department of Natural Resources
B.M. 'X' 1199-A Bronze tablet
in concrete post near end of private
driveway east of bridge on Two
Lake Road S.W. of 3-6" oak trees
Assumed Elev. 100.00'
Water Elev. 91.74'

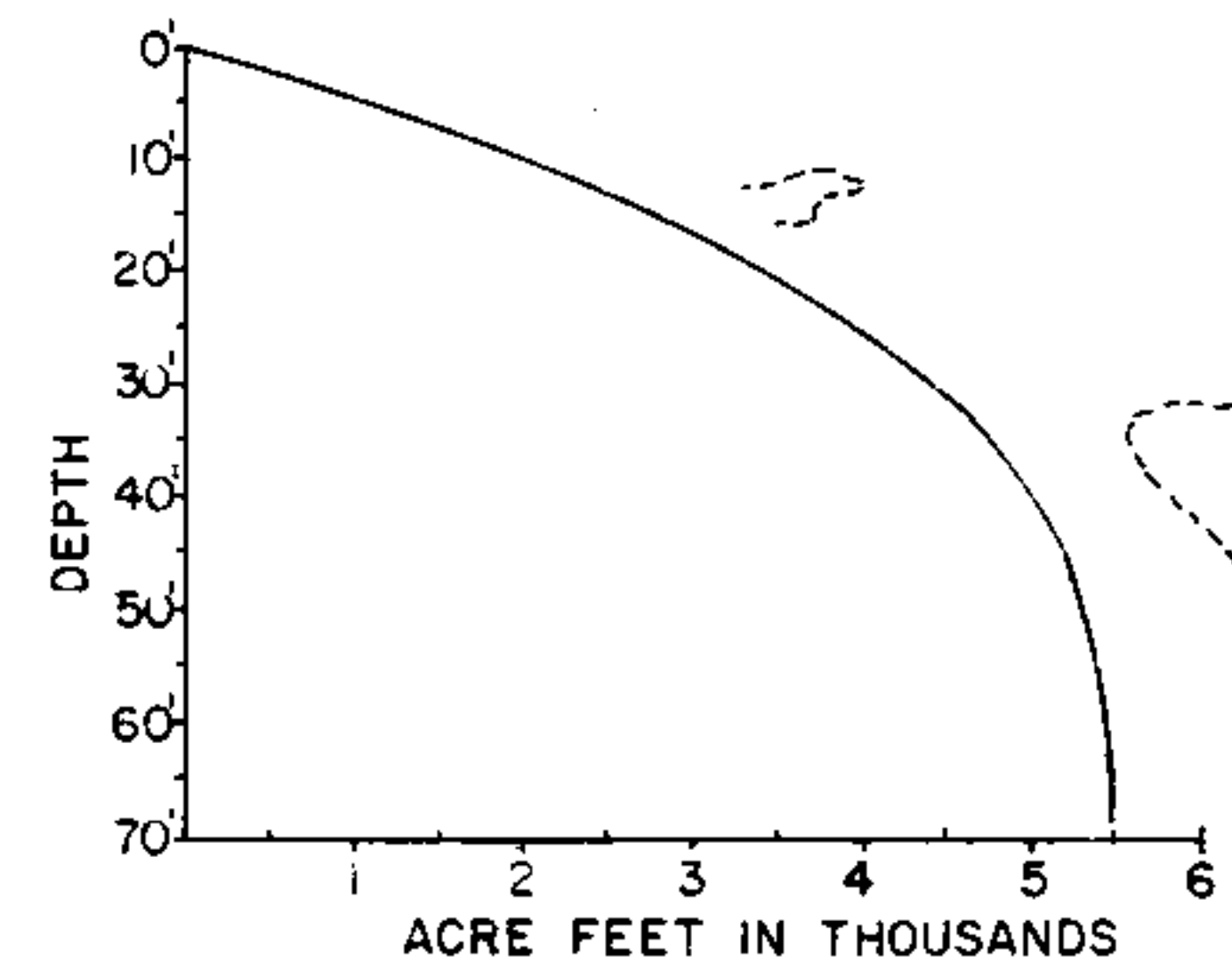

EQUIPMENT RECORDING SONAR MAPPED JUNE 1967

- | TOPOGRAPHIC SYMBOLS | | LAKE BOTTOM SYMBOLS | |
|-----------------------|----------------------------|---------------------|-----------------------------|
| (B) Brush | Steep slope | P. Peat | B Boulders |
| (PW) Partially wooded | ----- Indefinite shoreline | Mk. Muck | ⊙ Stumps & Snags |
| (W) Wooded | ⊞ Marsh | C. Clay | ⊙ Rock danger to navigation |
| (C) Cleared | ⊙ Spring | M. Marl | T Submergent vegetation |
| (P) Pastured | ~ Intermittent stream | Sd. Sand | ⊥ Emergent vegetation |
| (A) Agricultural | ==== Permanent inlet | St. Silt | ⊥ Floating vegetation |
| B.M. Bench Mark | ==== Permanent outlet | Gr. Gravel | ⊥ Brush shelters |
| ■ Dwelling | ⊥ Dam | R. Rubble | |
| ⊞ Resort | ⊞ D.N.R. State owned land | Bc. Bedrock | |
| ⊞ Camp | | | |



Access Access with Parking Boat Livery
Drawn by: C. Holt
Field work by: P. Michelson, J. Smith

SPECIES OF FISH	ABUNDANCE		
	Abundant	Common	Present
Muskie			X
N. Pike			X
Walleye	X		
L.M. Bass			X
S.M. Bass			X
Panfish	X		
Trout			

WATER AREA 213.7 ACRES
UNDER 3 FT. 7.0 %
OVER 20 FT. 61.0 %
MAX. DEPTH 69 FEET.
TOTAL ALK. 17 P.P.M.
VOLUME 5497.9 ACRE FT.
SHORELINE 4.4 MILES
SHORELINE 4.3 MILES WITHOUT ISLAND

Source: Wisconsin Department of Natural Resources 608-266-2621
South Two Lake – Oneida County, Wisconsin - DNR Lake Map
Date – Jun 1967 - Historical Lake Map - Not for Navigation
A Public Document - Please Identify the Source when using it.