

LAKE SURVEY MAP

TRILBY LAKE
VILAS COUNTY
SEC. 11, 12, 13, 14 T. 40 N. R. 6 E.

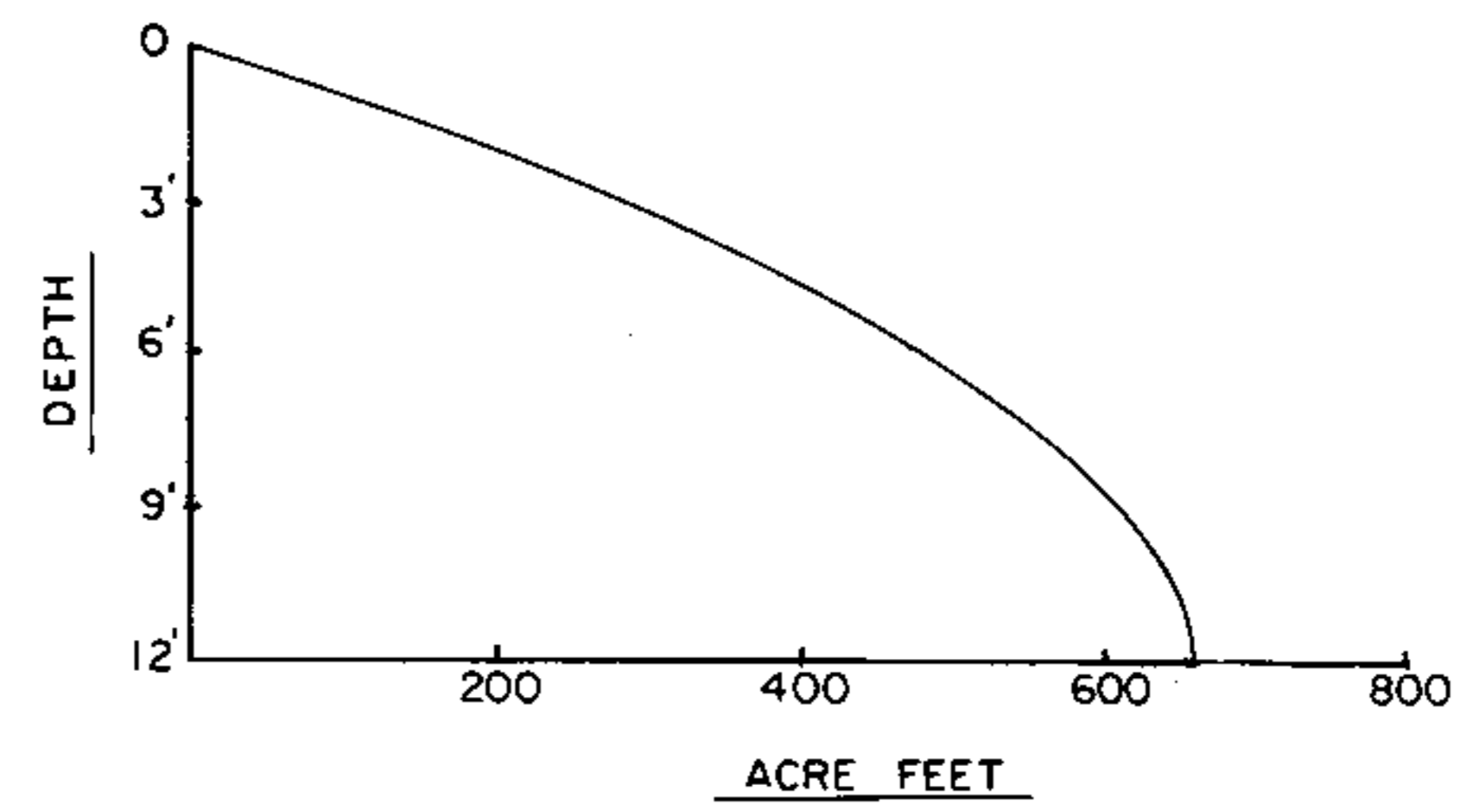
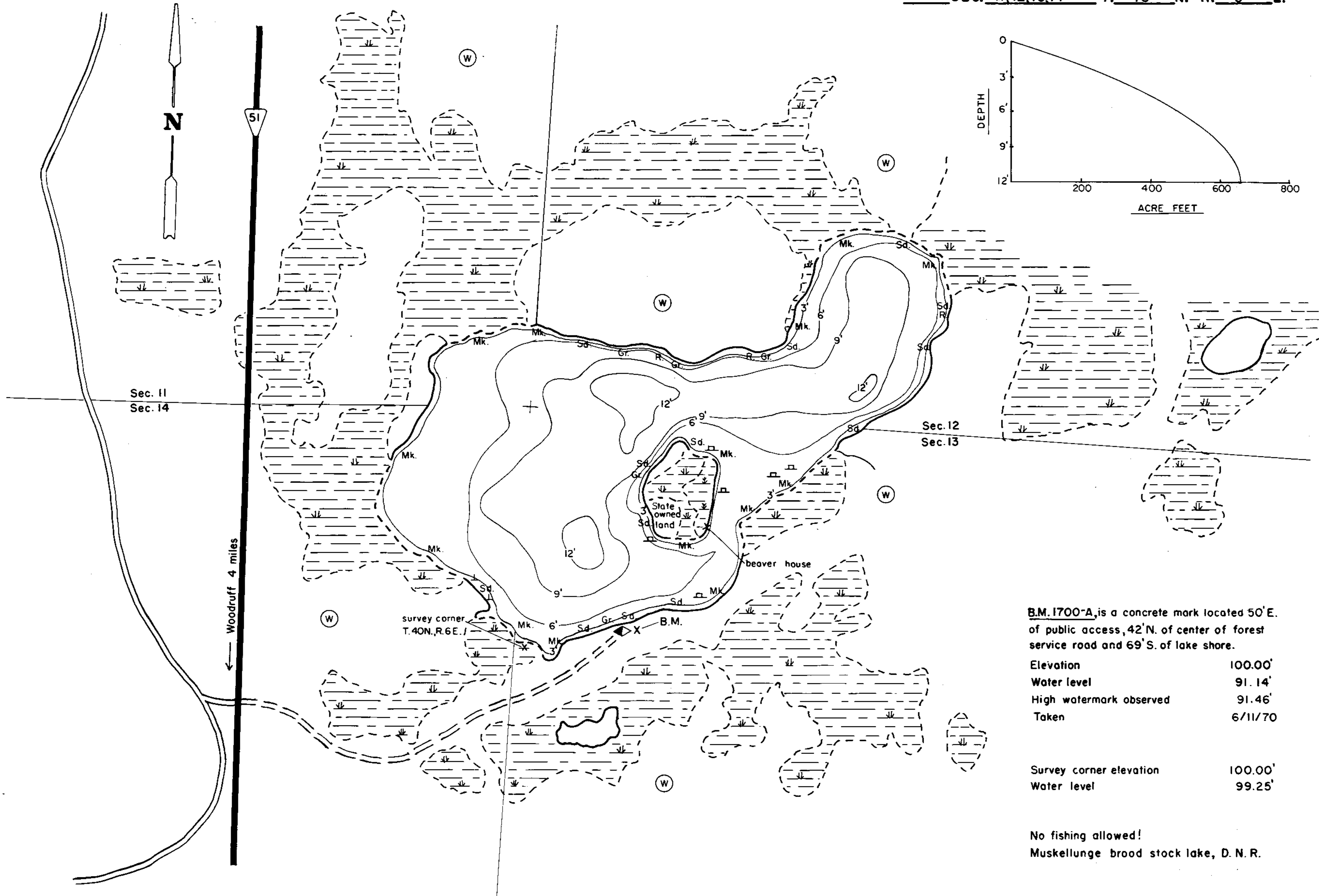

B.M. 1700-A, is a concrete mark located 50' E. of public access, 42' N. of center of forest service road and 69' S. of lake shore.

Elevation	100.00'
Water level	91.14'
High watermark observed	91.46'
Taken	6/11/70
Survey corner elevation	100.00'
Water level	99.25'

No fishing allowed!
Muskellunge brood stock lake, D.N.R.

EQUIPMENT RECORDING		SONAR MAPPED		JUNE 1970	
TOPOGRAPHIC SYMBOLS		MONTH	YEAR	LAKE BOTTOM SYMBOLS	
(B) Brush	Steep slope	P. Peat	B Boulders	Mk. Muck	⊙ Stumps & Snags
(PW) Partially wooded	Indefinite shoreline	C. Clay	⊙ Rock danger to navigation	M. Marl	T Submergent vegetation
(W) Wooded	Marsh	Sd. Sand	⊥ Emergent vegetation	St. Silt	⊥ Floating vegetation
(C) Cleared	Spring	Gr. Gravel	⊕ Brush shelters	R. Rubble	
(P) Pastured	Intermittent stream	Bc. Bedrock			
(A) Agricultural	Permanent inlet				
B.M. Bench Mark	Permanent outlet				
■ Dwelling	Dam				
■ Resort	D.N.R. State owned land				
⊙ Camp					



Access Access with Parking Boat Livery
 Drawn by: T. Ginder
 Field work by: J. Smith & R. Crocker

SPECIES OF FISH	Abundance		
	Abundant	Common	Present
Muskie		X	
N. Pike		X	
Walleye			X
L.M. Bass			X
S.M. Bass			X
Panfish	X		
Trout			

WATER AREA	91.71	ACRES
UNDER 3 FT.	8	%
OVER 20 FT.	0	%
MAX. DEPTH	12	FEET.
TOTAL ALK.	3	P.P.M.
VOLUME	657.72	ACRE FT.
SHORELINE	1.70	MILES
WITH ISLAND	2.07	MILES

Source: Wisconsin Department of Natural Resources 608-266-2621
Trilby Lake - Vilas County, Wisconsin DNR Lake Map
Date – Jun 1970 - Historical Lake Map - Not for Navigation
A Public Document - Please Identify the Source when using it.