

LAKE SURVEY MAP

LAKE SPRINGVILLE-POND
 SECTION S.1/2-15
 TOWNSHIP 23 N
 RANGE 8 E
 TOWN OF PLOVER
 COUNTY PORTAGE

FORM F-11

WISCONSIN CONSERVATION DEPARTMENT
 BIOLOGY DIVISION
 LAKE AND STREAM IMPROVEMENT SECTION

N.W. 1/4 SEC. 15

N.E. 1/4 SEC. 15

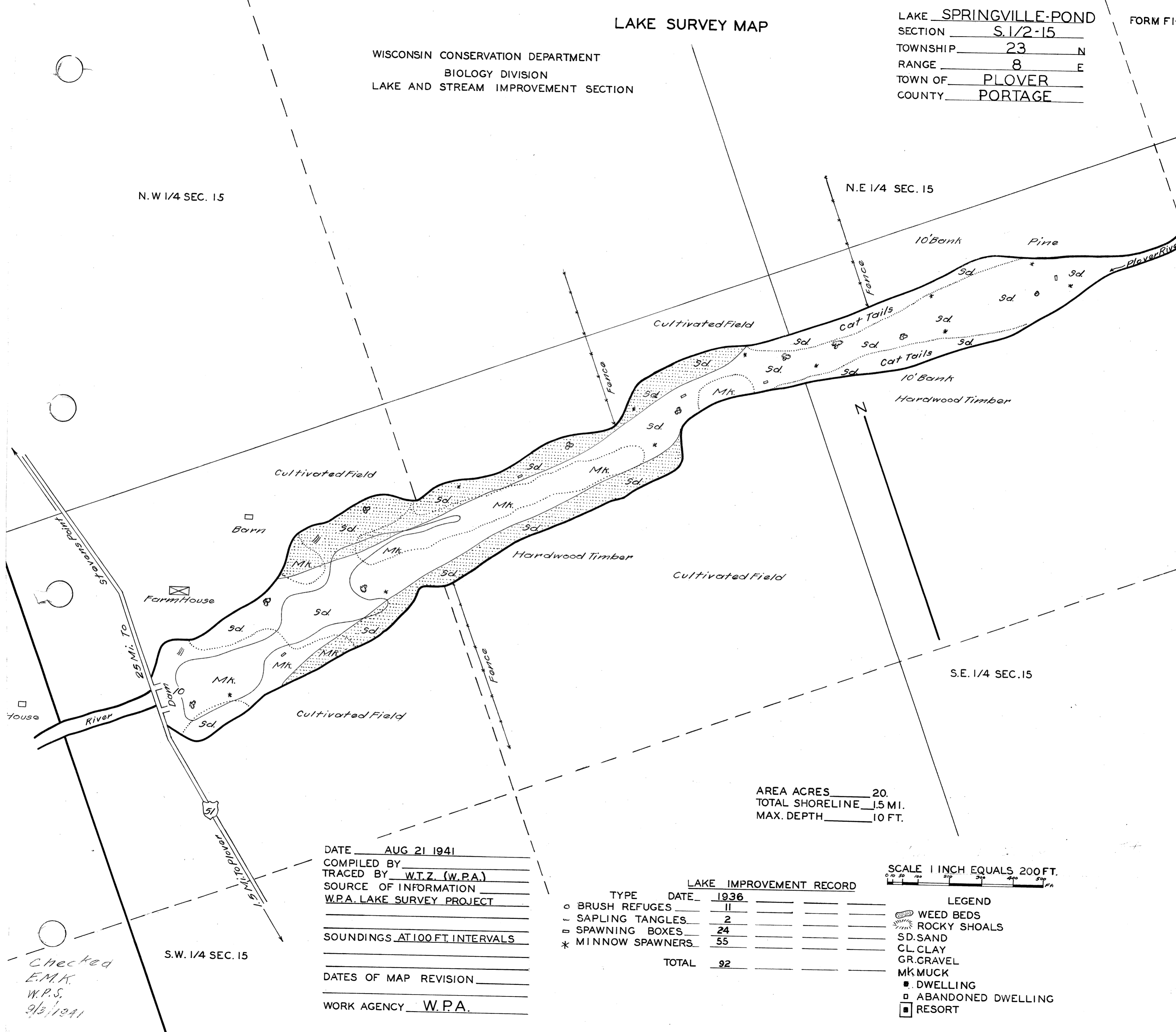

AREA ACRES 20.
 TOTAL SHORELINE 1.5 MI.
 MAX. DEPTH 10 FT.

DATE AUG 21 1941
 COMPILED BY _____
 TRACED BY W.T.Z. (W.P.A.)
 SOURCE OF INFORMATION _____
W.P.A. LAKE SURVEY PROJECT

 SOUNDINGS AT 100 FT. INTERVALS

 DATES OF MAP REVISION _____

 WORK AGENCY W.P.A.

LAKE IMPROVEMENT RECORD

TYPE	DATE	1936		
○ BRUSH REFUGES		11		
~ SAPLING TANGLES		2		
□ SPAWNING BOXES		24		
* MINNOW SPAWNERS		55		
TOTAL		92		

SCALE 1 INCH EQUALS 200 FT.

- LEGEND
- WEED BEDS
 - ROCKY SHOALS
 - SD. SAND
 - CL. CLAY
 - GR. GRAVEL
 - MK. MUCK
 - DWELLING
 - ABANDONED DWELLING
 - RESORT

Checked
 E.M.K.
 W.P.S.
 9/3/1941

Source: Wisconsin Department of Natural Resources 608-266-2621
Springville Pond – Portage County, Wisconsin DNR Lake Map
Date – Aug 1941 - Historical Lake Map - Not for Navigation
A Public Document - Please Identify the Source when using it.