

B.M. - 46-C is a square cut in top of upstream end of left concrete tainter gate pier.
Elevation 1164.71'
Water elevation 1160.50'
Taken 8/73

EQUIPMENT RECORDING SONAR MAPPED		OCT 1973	
TOPOGRAPHIC SYMBOLS		LAKE BOTTOM SYMBOLS	
(B) Brush	Steep slope	P. Peat	B Boulders
(PW) Partially wooded	~ Indefinite shoreline	Mk. Muck	o Stumps & Snags
(W) Wooded	~ Marsh	C. Clay	⊙ Rock danger to navigation
(C) Cleared	~ Spring	M. Marl	T Submergent vegetation
(P) Pastured	~ Intermittent stream	Sd. Sand	⊥ Emergent vegetation
(A) Agricultural	~ Permanent inlet	St. Silt	~ Floating vegetation
B.M. Bench Mark	~ Permanent outlet	Gr. Gravel	⊕ Brush shelters
■ Dwelling	~ Dam	R. Rubble	
□ Resort	D.N.R. State owned land	Br. Bedrock	
□ Camp			

500' 0' 500' 1000' 1500' 2000'
SCALE
◆ Access ◆ Access with Parking ◆ Boat Livery
Drawn by: C. Holt
Field work by: A. Barlow, J. Smith

SPECIES OF FISH	ABUNDANCE	
	Abundant	Common
Muskie		X
N. Pike		X
Walleye		X
L.M. Bass		X
S.M. Bass		X
Panfish	X	
Trout		

WATER AREA 1918.0 ACRES
UNDER 3 FT. 23 %
OVER 20 FT. 8 %
MAX. DEPTH 30 FEET.
TOTAL ALK. 34 P.P.M.
VOLUME 13,916 ACRE FT.
MAIN SHORELINE 30.58 MI.
ISLAND SHORELINE 43.32 MI.



EQUIPMENT RECORDING SONAR MAPPED OCT 1973
MONTH YEAR
LAKE BOTTOM SYMBOLS

- | TOPOGRAPHIC SYMBOLS | | LAKE BOTTOM SYMBOLS | |
|-----------------------|-------------------------|---------------------|-----------------------------|
| (B) Brush | Steep slope | P. Peat | B Boulders |
| (PW) Partially wooded | — Indefinite shoreline | Mk. Muck | ⊙ Stumps & Snags |
| (W) Wooded | ⊙ Marsh | C. Clay | ⊙ Rock danger to navigation |
| (C) Cleared | ⊙ Spring | M. Marl | T Submergent vegetation |
| (P) Pastured | — Intermittent stream | Sd. Sand | ⊥ Emergent vegetation |
| (A) Agricultural | — Permanent inlet | Sl. Silt | ⊖ Floating vegetation |
| B.M. Bench Mark | — Permanent outlet | Gr. Gravel | ⊙ Brush shelters |
| (D) Dwelling | ⊖ Dam | R. Rubble | |
| (R) Resort | D.N.R. State owned land | Br. Bedrock | |
| (C) Camp | | | |

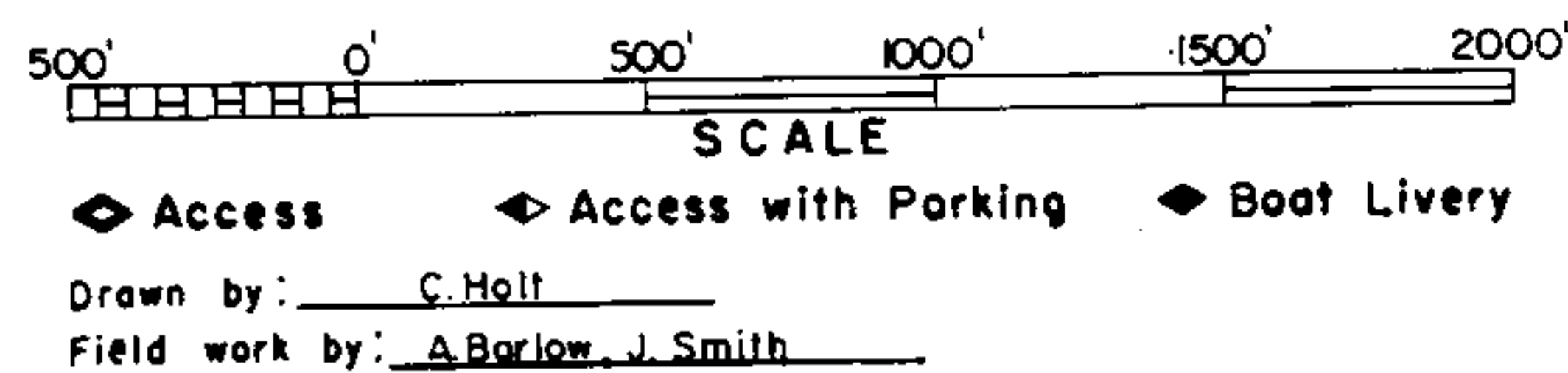

SPECIES OF FISH	ABUNDANCE		
	Abundant	Common	Present
Muskie			x
N. Pike		x	
Walleye		x	
L.M. Bass		x	
S.M. Bass		x	
Panfish	x		
Trout			

WATER AREA 1918.0 ACRES
UNDER 3 FT. 23 %
OVER 20 FT. 8 %
MAX. DEPTH 30 FEET.
TOTAL ALK. 34 P.P.M.
VOLUME 13,916 ACRE FT.
MAIN SHORELINE 30.58 MI.
ISLAND SHORELINE 43.32 MI.

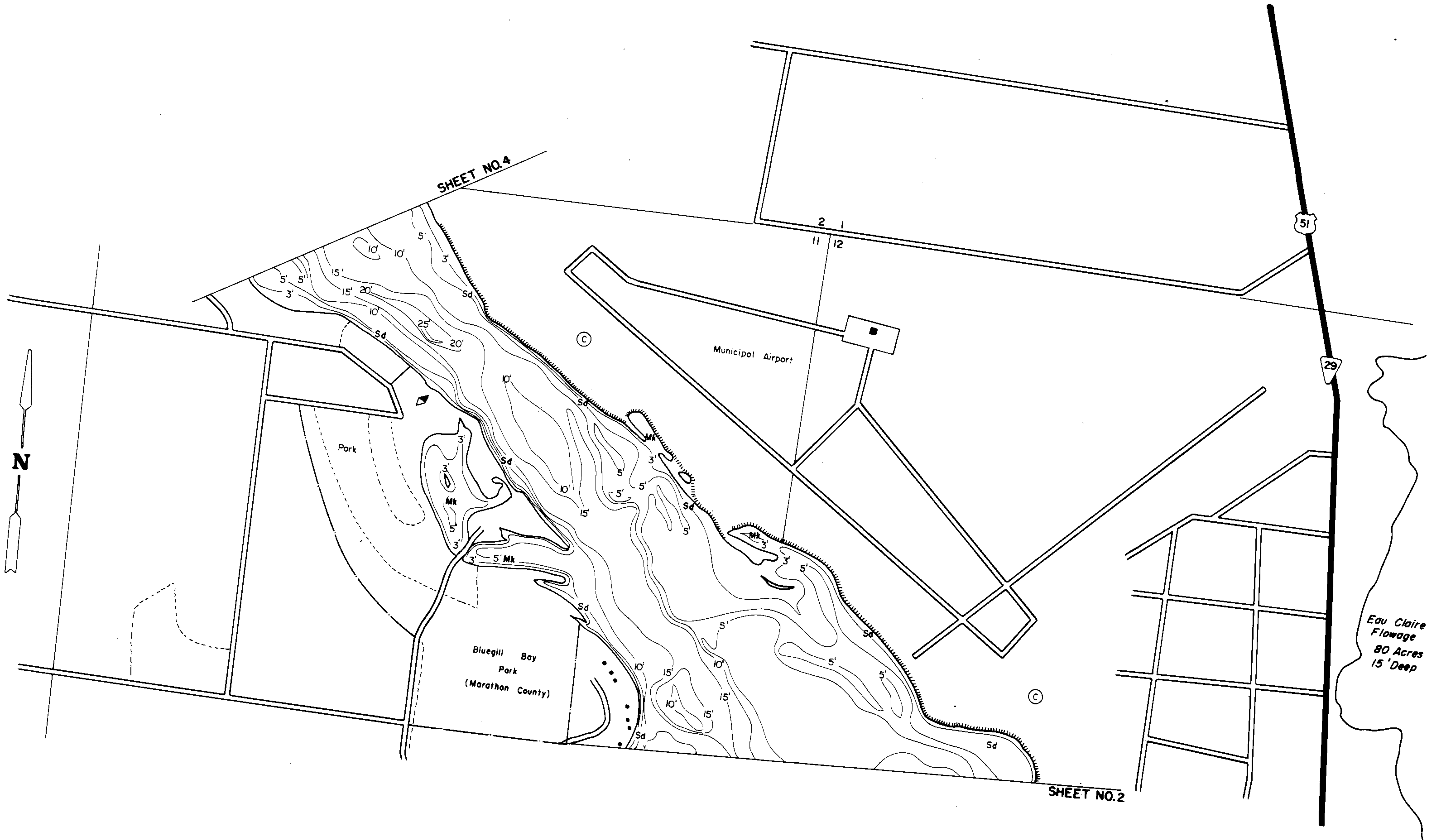

EQUIPMENT RECORDING SONAR MAPPED OCT 1973
MONTH YEAR

TOPOGRAPHIC SYMBOLS		LAKE BOTTOM SYMBOLS	
(B) Brush	Steep slope	P. Peat	B Boulders
(PW) Partially wooded	Indefinite shoreline	Mk. Muck	Stumps & Snags
(W) Wooded	Marsh	C. Clay	Rock danger to navigation
(C) Cleared	Spring	M. Marl	T Submergent vegetation
(P) Pastured	Intermittent stream	Sd. Sand	Emergent vegetation
(A) Agricultural	Permanent inlet	St. Silt	Floating vegetation
B.M. Bench Mark	Permanent outlet	Gr. Gravel	Brush shelters
■ Dwelling	Dam	R. Rubble	
■ Resort	D.N.R. State owned land	Bc. Bedrock	
■ Camp			



Access Access with Parking Boat Livery
 Drawn by: C. Holt
 Field work by: A. Barlow, J. Smith

SPECIES OF FISH	ABUNDANCE		
	Abundant	Common	Present
Muskie			X
N. Pike		X	
Walleye		X	
L.M. Bass		X	
S.M. Bass		X	
Panfish	X		
Trout			

WATER AREA 1918.0 ACRES
 UNDER 3 FT. 23 %
 OVER 20 FT. 8 %
 MAX. DEPTH 30 FEET.
 TOTAL ALK. 34 P.P.M.
 VOLUME 13,916 ACRE FT.
 MAIN SHORELINE 30.58 MI.
 ISLAND SHORELINE 43.32 MI.

LAKE SURVEY MAP

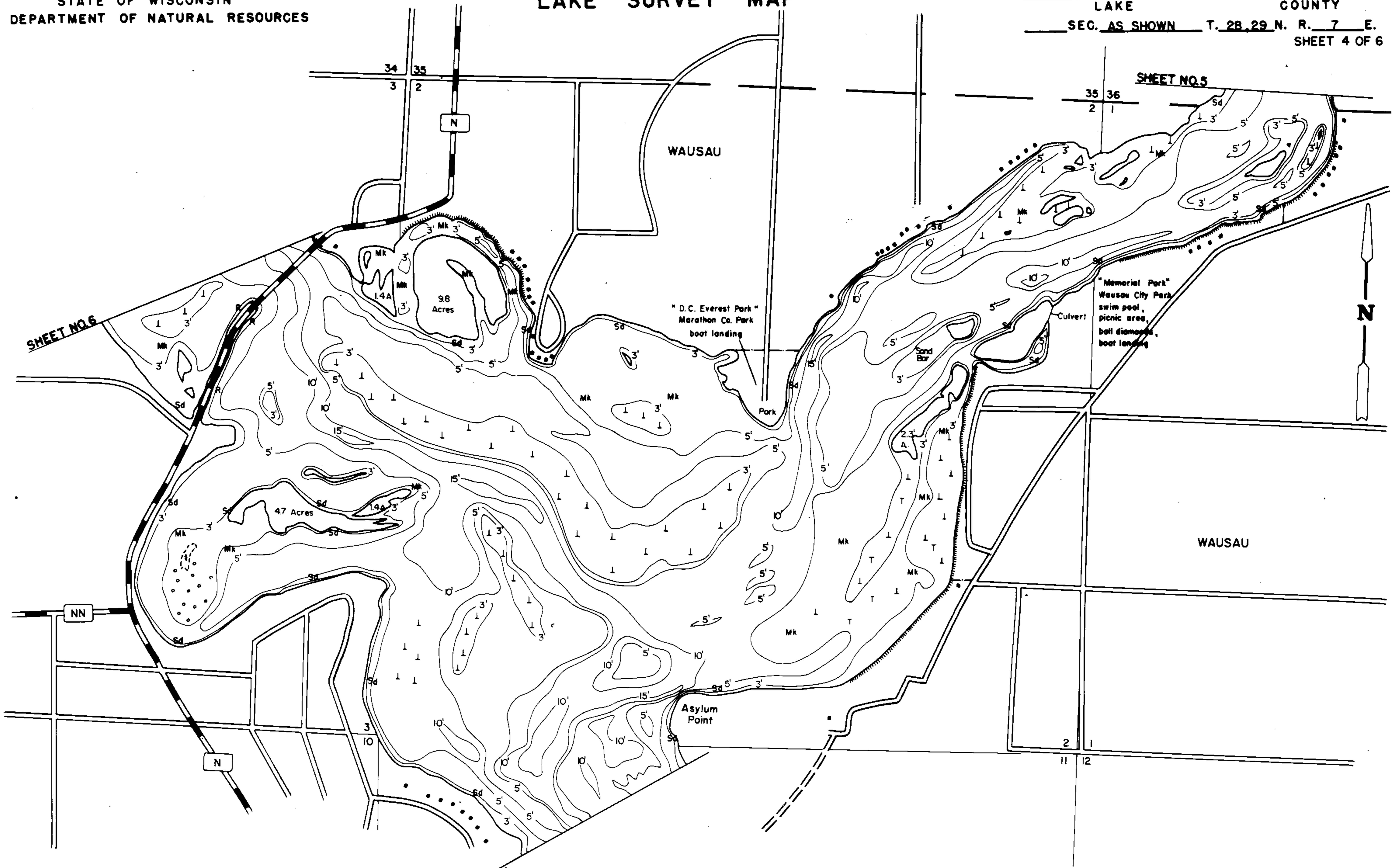

EQUIPMENT RECORDING SONAR MAPPED OCT 1973
MONTH YEAR
LAKE BOTTOM SYMBOLS

TOPOGRAPHIC SYMBOLS		LAKE BOTTOM SYMBOLS	
(B) Brush	Steep slope	P. Peat	B Boulders
(PW) Partially wooded	----- Indefinite shoreline	Mk. Muck	⊙ Stumps & Snags
(W) Wooded	⊞ Marsh	C. Clay	⊙ Rock danger to navigation
(C) Cleared	⊞ Spring	M. Marl	T Submergent vegetation
(P) Pastured	----- Intermittent stream	Sd. Sand	⊥ Emergent vegetation
(A) Agricultural	===== Permanent inlet	St. Silt	⊞ Floating vegetation
B.M. Bench Mark	===== Permanent outlet	Gr. Gravel	⊞ Brush shelters
■ Dwelling	⊞ Dam	R. Rubble	
⊞ Resort	D.N.R. State owned land	Br. Bedrock	
⊞ Camp			

SPECIES OF FISH	Abundance	
	Abundant	Common
Muskie		X
N. Pike	X	
Walleye		X
L. M. Bass		X
S. M. Bass		X
Panfish	X	
Trout		

WATER AREA 1918.0 ACRES
 UNDER 3 FT. 23 %
 OVER 20 FT. 8 %
 MAX. DEPTH 30 FEET.
 TOTAL ALK. 34 P.P.M.
 VOLUME 13,916 ACRE FT.
 MAIN SHORELINE 30.58 MI.
 ISLAND SHORELINE 43.32 MI.



Access Access with Parking Boat Livery

Drawn by: C. Holt
Field work by: A. Barlow, J. Smith

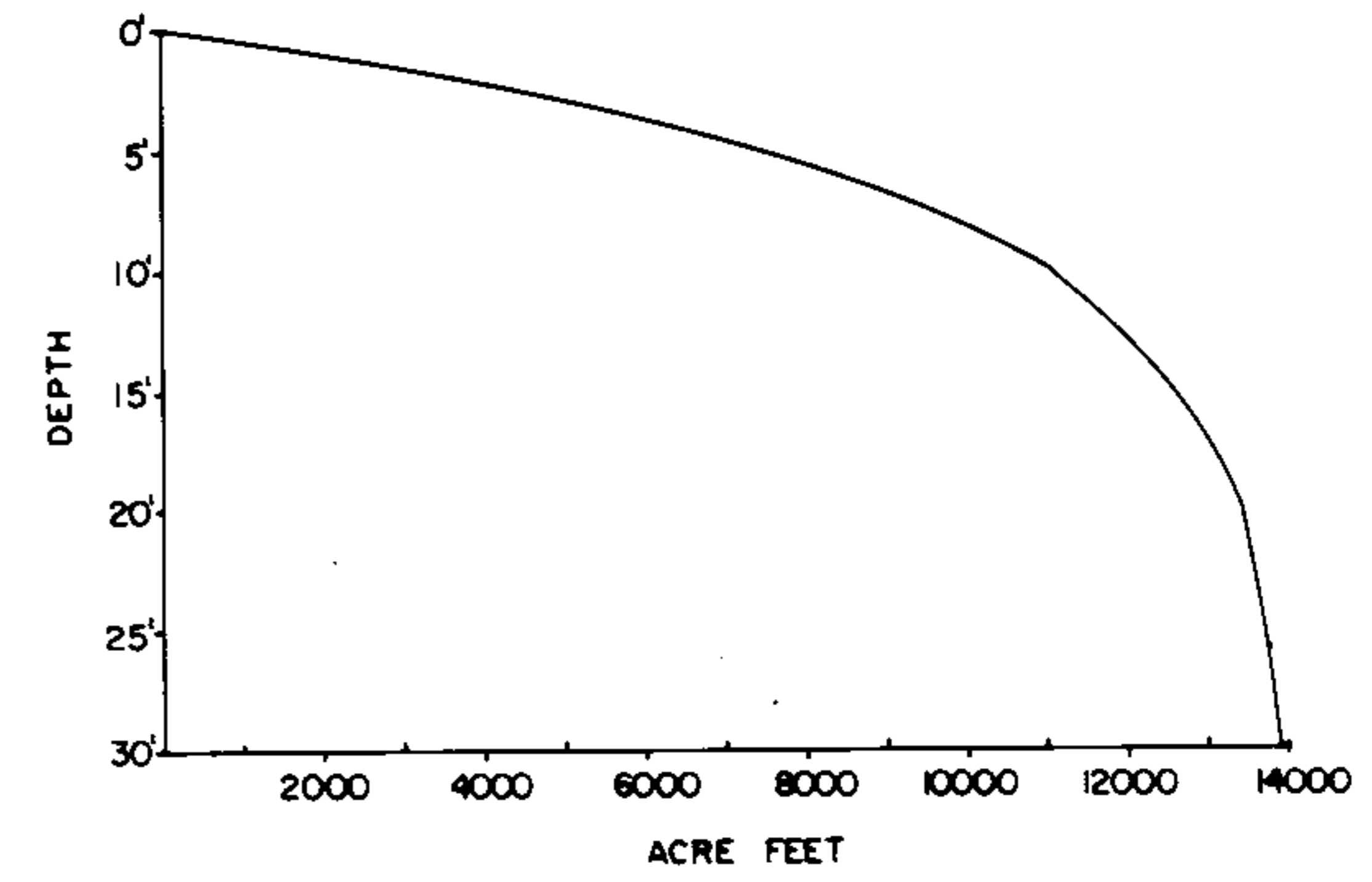
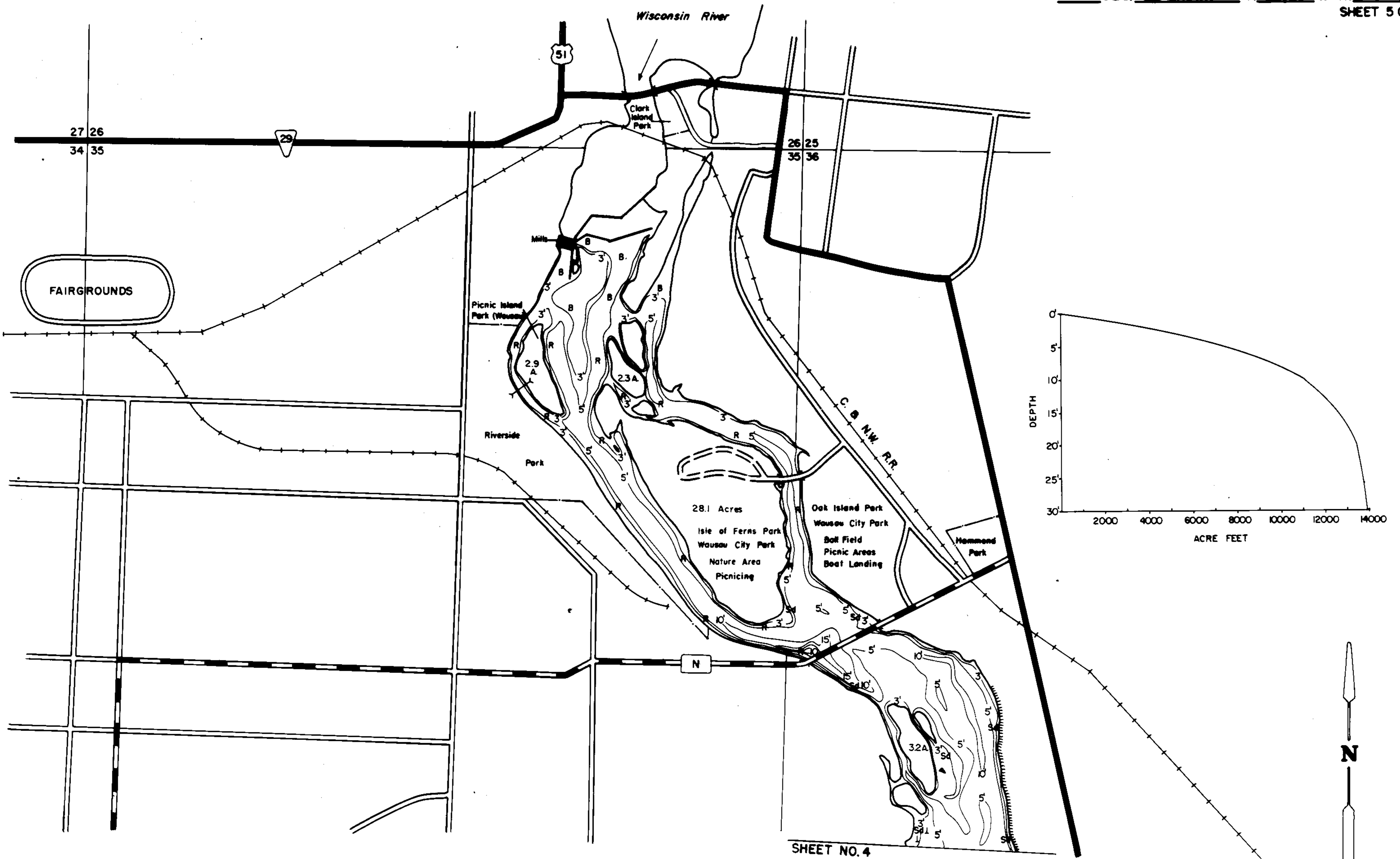

EQUIPMENT RECORDING SONAR MAPPED OCT 1973
MONTH YEAR
LAKE BOTTOM SYMBOLS

TOPOGRAPHIC SYMBOLS		LAKE BOTTOM SYMBOLS
(B) Brush	Steep slope	P. Peat
(PW) Partially wooded	~ Indefinite shoreline	Mk. Muck
(W) Wooded	Marsh	C. Clay
(C) Cleared	Spring	M. Marl
(P) Pastured	Intermittent stream	Sd. Sand
(A) Agricultural	Permanent inlet	St. Silt
B.M. Bench Mark	Permanent outlet	Gr. Gravel
■ Dwelling	Dam	R. Rubble
□ Resort	D.N.R. State owned land	Br. Bedrock
□ Camp		B Boulders
		⚬ Stumps & Snags
		⚬ Rock danger to navigation
		T Submergent vegetation
		I Emergent vegetation
		⚬ Floating vegetation
		⚬ Brush shelters

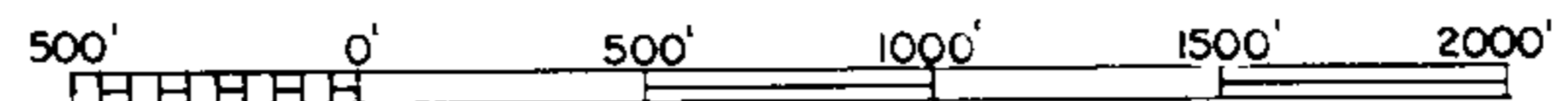

◆ Access ◆ Access with Parking ◆ Boat Livery
 Drawn by: C. Holt
 Field work by: A. Barlow, J. Smith

SPECIES OF FISH	Abundance		
	Abundant	Common	Present
Muskie			X
N. Pike		X	
Walleye			X
L. M. Bass			X
S. M. Bass			X
Panfish	X		
Trout			

WATER AREA 1918.0 ACRES
 UNDER 3 FT. 23 %
 OVER 20 FT. 8 %
 MAX. DEPTH 30 FEET.
 TOTAL ALK. 34 P.P.M.
 VOLUME 13,916 ACRE FT.
 MAIN SHORELINE 30.58 MI.
 ISLAND SHORELINE 43.32 MI.

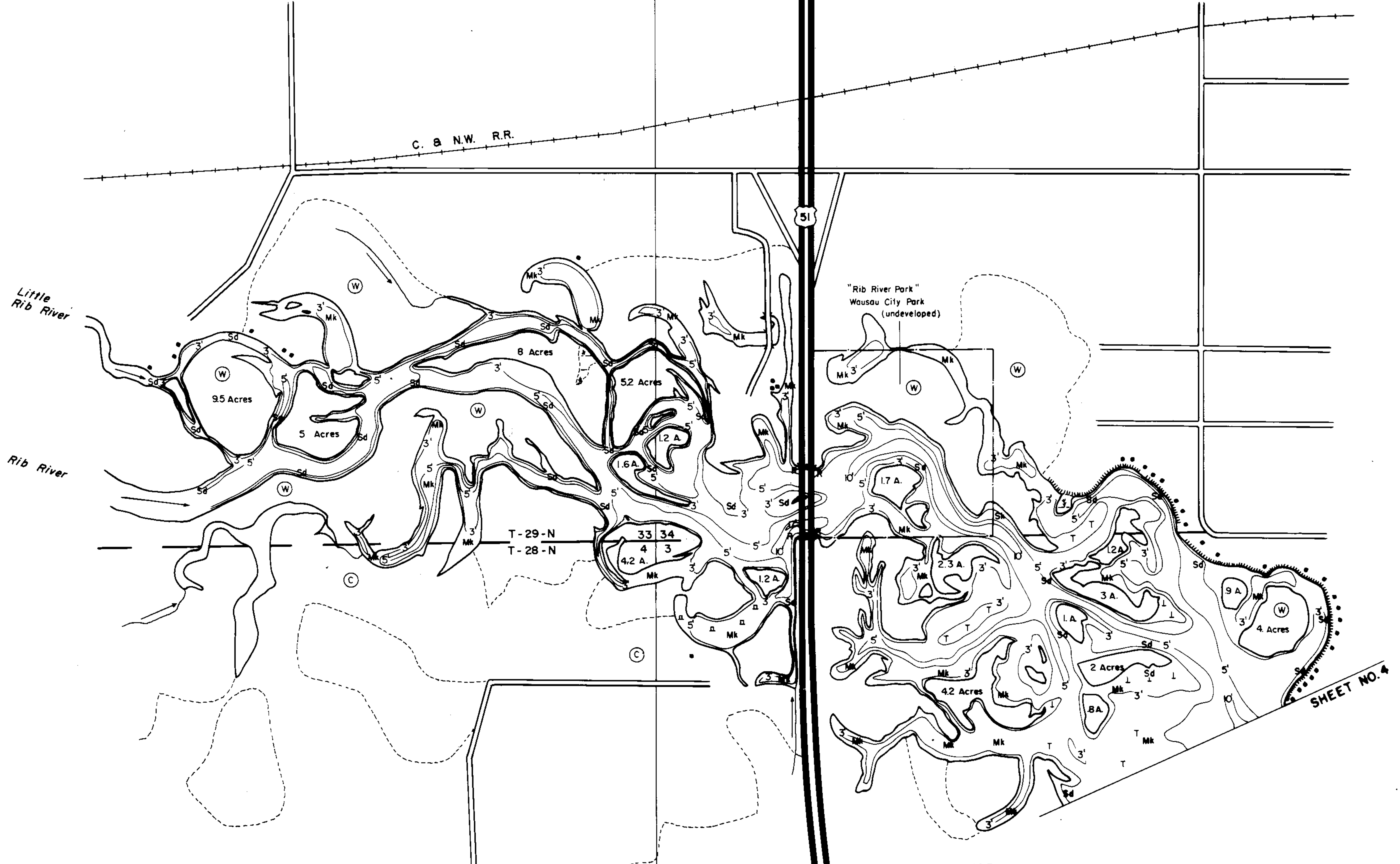

EQUIPMENT RECORDING SONAR MAPPED OCT 1973
MONTH YEAR
LAKE BOTTOM SYMBOLS

- | | | |
|----------------------------|----------------------------|-----------------------------|
| TOPOGRAPHIC SYMBOLS | LAKE BOTTOM SYMBOLS | LAKE BOTTOM SYMBOLS |
| (B) Brush | Steep slope | P. Peat |
| (PW) Partially wooded | ----- Indefinite shoreline | Mk. Muck |
| (W) Wooded | ----- Marsh | C. Clay |
| (C) Cleared | o Spring | M. Marl |
| (P) Pastured | ----- Intermittent stream | Sd. Sand |
| (A) Agricultural | ----- Permanent inlet | St. Silt |
| B.M. Bench Mark | ----- Permanent outlet | Gr. Gravel |
| ■ Dwelling | ∩ Dam | R. Rubble |
| □ Resort | D.N.R. State owned land | Br. Bedrock |
| □ Camp | | B Boulders |
| | | ♣ Stumps & Snags |
| | | ⊙ Rock danger to navigation |
| | | T Submergent vegetation |
| | | ∟ Emergent vegetation |
| | | ∆ Floating vegetation |
| | | ↘ Brush shelters |



Access Access with Parking Boat Livery
 Drawn by: C. Holt
 Field work by: A. Barlow, J. Smith

SPECIES OF FISH	ABUNDANCE	
	Abundant	Common Present
Muskie		X
N. Pike	X	X
Walleye		X
L. M. Bass	X	X
S. M. Bass	X	X
Panfish	X	
Trout		

WATER AREA 1918.0 ACRES
 UNDER 3 FT. 23 %
 OVER 20 FT. 8 %
 MAX. DEPTH 30 FEET.
 TOTAL ALK. 34 P.P.M.
 VOLUME 13,916 ACRE FT.
 MAIN SHORELINE 30.58 MI.
 ISLAND SHORELINE 43.32 MI.

SHEET NO. 4

Source: Wisconsin Department of Natural Resources 608-266-2621
Wausau Lake – Marathon County, Wisconsin DNR Lake Map
Date – Oct 1973 - Historical Lake Map - Not for Navigation
A Public Document - Please Identify the Source when using it.