

LAKE SURVEY MAP

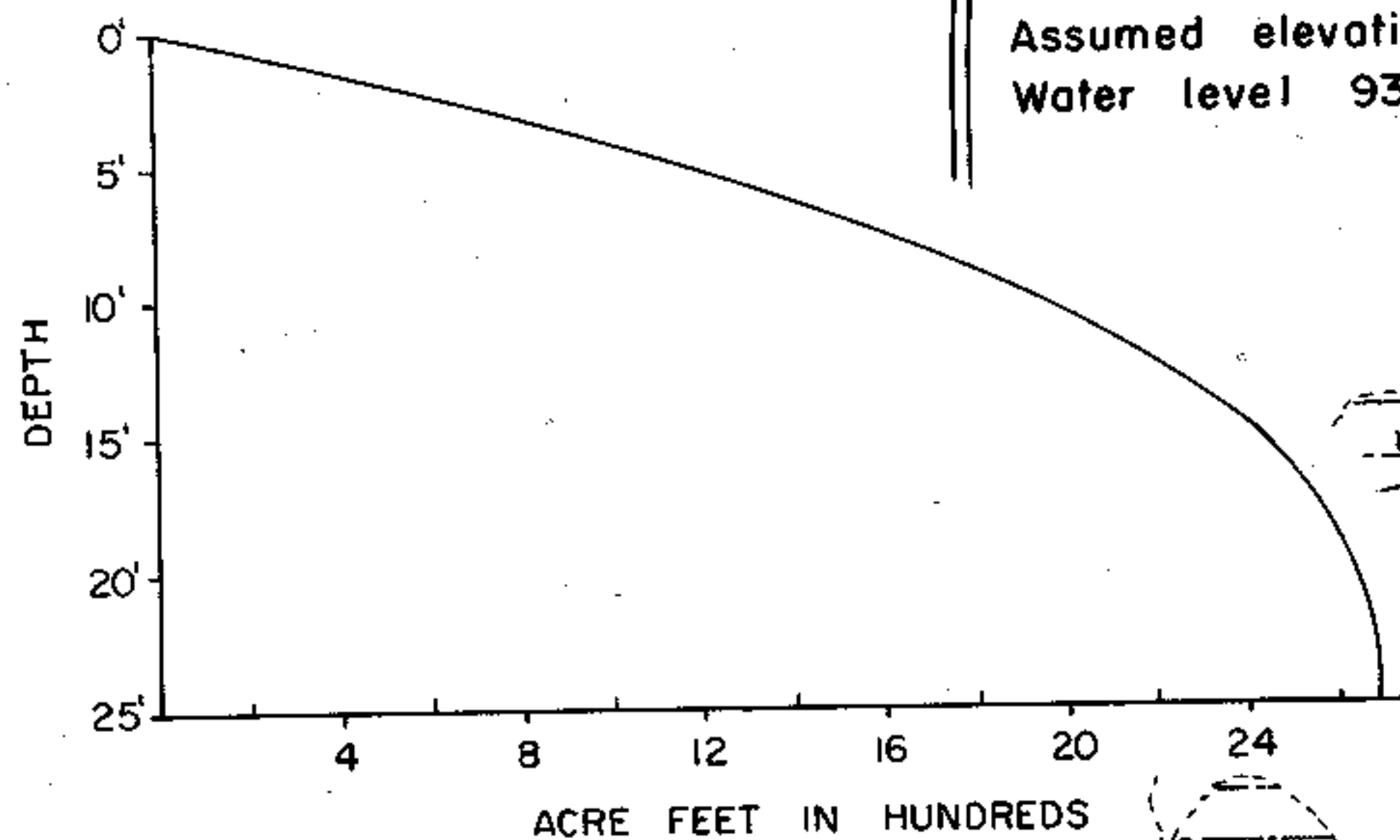
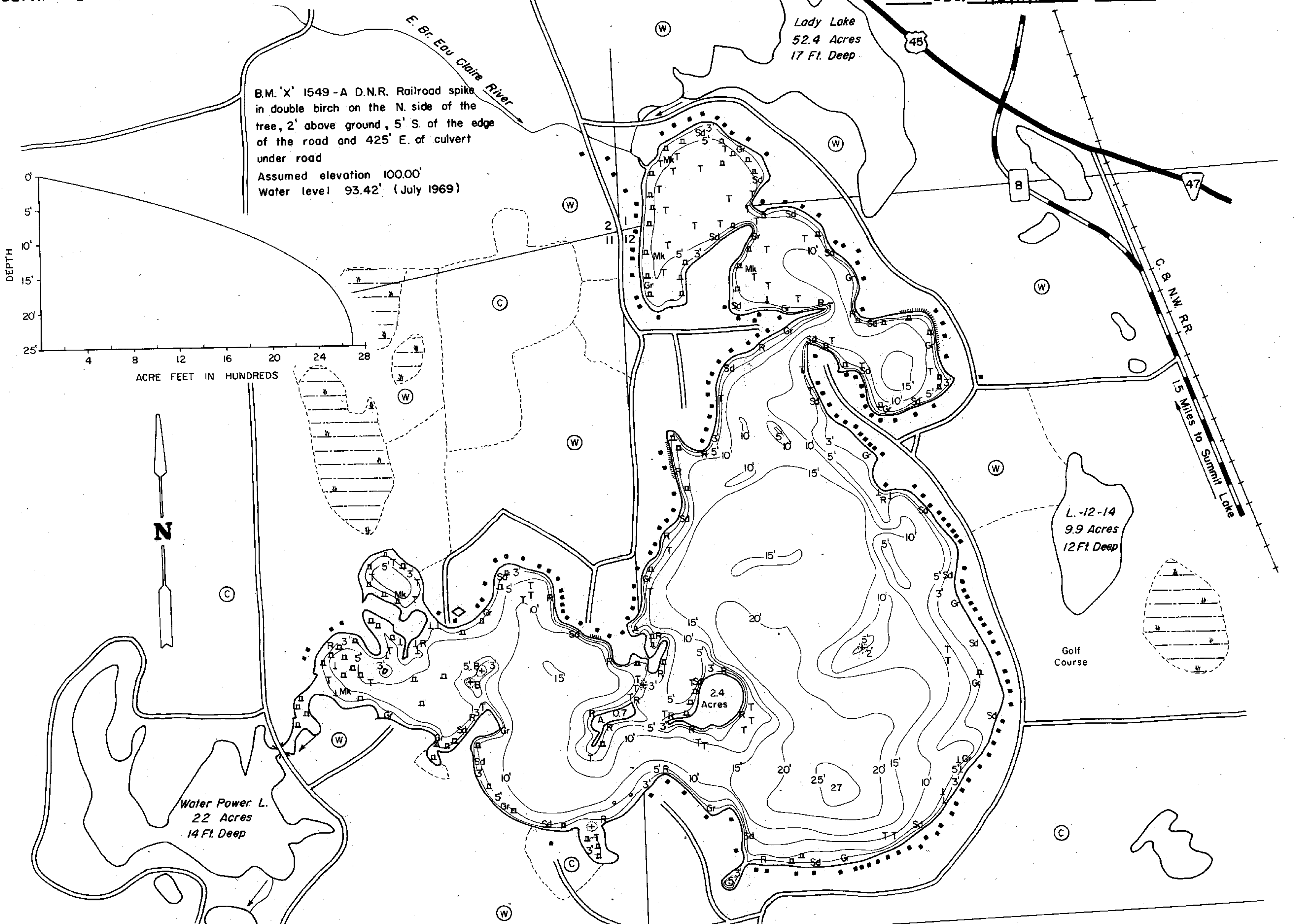

EQUIPMENT RECORDING SONAR MAPPED JULY 1972
 MONTH YEAR
 LAKE BOTTOM SYMBOLS

- TOPOGRAPHIC SYMBOLS**
- (B) Brush
 - (PW) Partially wooded
 - (W) Wooded
 - (C) Cleared
 - (P) Pastured
 - (A) Agricultural
 - B.M. Bench Mark
 - Dwelling
 - Resort
 - Camp
 - ||||| Steep slope
 - ~ Indefinite shoreline
 - Marsh
 - Spring
 - Intermittent stream
 - Permanent inlet
 - Permanent outlet
 - Dam
 - D.N.R. State owned land

- P. Peat
- Mk. Muck
- C. Clay
- M. Marl
- Sd. Sand
- St. Silt
- Gr. Gravel
- R. Rubble
- Bc. Bedrock
- B Boulders
- Stumps & Snags
- Rock danger to navigation
- T Submergent vegetation
- Emergent vegetation
- Floating vegetation
- Brush shelters



◆ Access ◆ Access with Parking ◆ Boat Livery
 Drawn by: C. Holt
 Field work by: W. Evans, J. Smith

SPECIES OF FISH	Abundant		Common		Present	
	X		X		X	
Muskie						
N. Pike			X		X	
Walleye			X		X	
L.M. Bass			X			
S.M. Bass						
Panfish	X					
Trout						

WATER AREA 257.8 ACRES
 UNDER 3 FT. 12.5 %
 OVER 20 FT. 7 %
 MAX. DEPTH 25 FEET.
 TOTAL ALK. 5 P.P.M.
 VOLUME 2685.5 ACRE FT.
 SHORELINE 6.11 MILES
 SHORELINE 6.61 MILES WITH IS.

Source: Wisconsin Department of Natural Resources 608-266-2621
Greater Bass Lake – Langlade County, Wisconsin DNR Lake Map
Date Jul 1972 - Historical Lake Map - Not for Navigation
A Public Document - Please Identify the Source when using it.