

WISCONSIN CONSERVATION DEPARTMENT  
 BIOLOGY DIVISION  
 LAKE AND STREAM IMPROVEMENT SECTION

LAKE SURVEY MAP 35 36  
 2 1

LAKE SUMMIT  
 SECTION 2-35  
 TOWNSHIP 33-34 N  
 RANGE 10 E  
 TOWN OF UPHAM  
 COUNTY LANGLADE

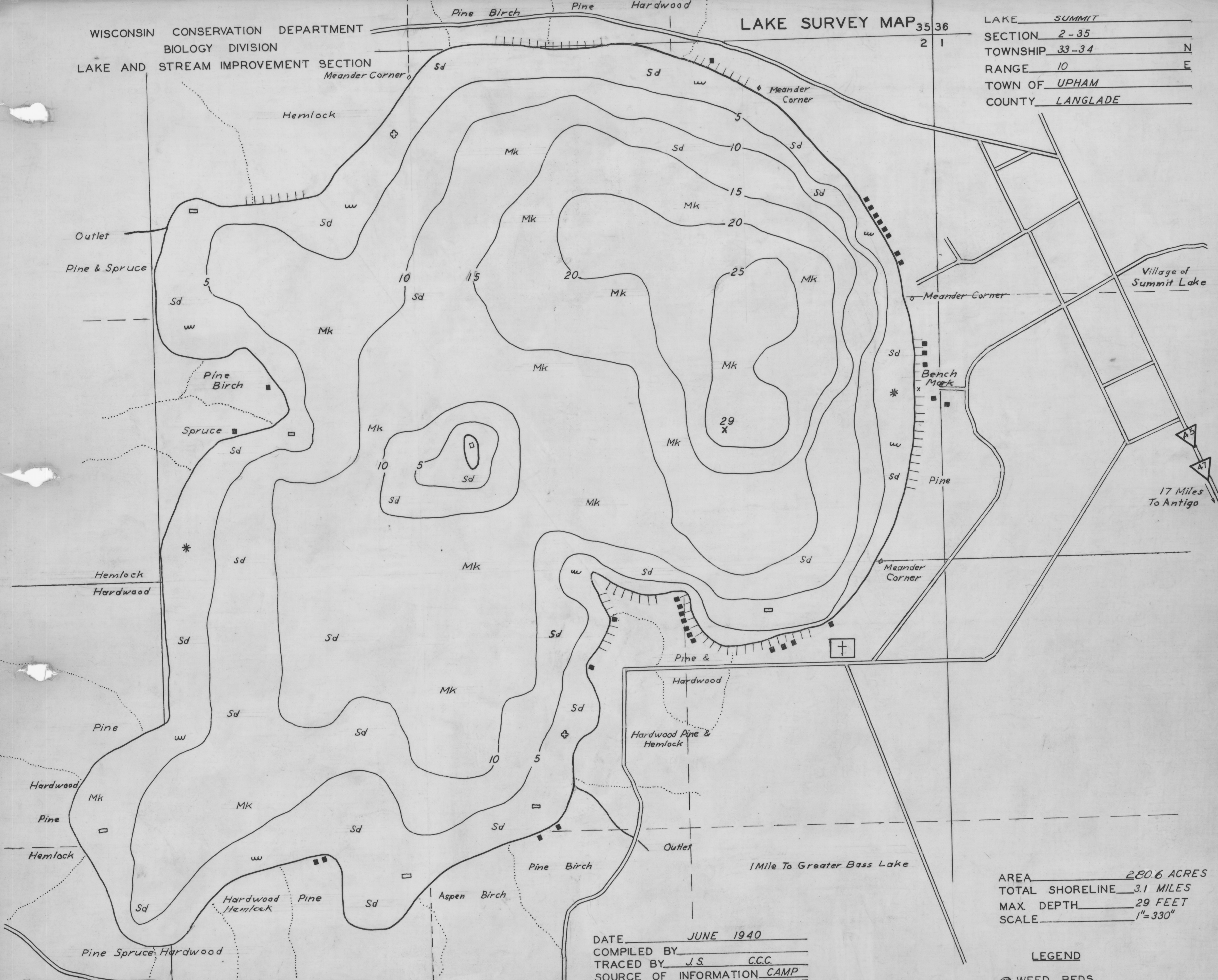

AREA 280.6 ACRES  
 TOTAL SHORELINE 3.1 MILES  
 MAX. DEPTH 29 FEET  
 SCALE 1"=330"

LEGEND

- ⊕ WEED BEDS
- \* ROCKY SHOALS
- Sd SAND
- Cl CLAY
- Gr GRAVEL
- Mk MUCK
- DWELLING
- ABANDONED DWELLING
- ▣ RESORT

LAKE IMPROVEMENT RECORD

TYPE	DATE	35/36		
⊕ BRUSH REFUGES		10		
w SAPLING TANGLES		37		
□ SPAWNING BOXES		27		
* MINNOW SPAWNERS		10		
TOTAL		84		

CHECKED BY  
 WRS-EMM  
 7-18-41

DATE JUNE 1940  
 COMPILED BY J.S. C.C.C.  
 TRACED BY J.S. C.C.C.  
 SOURCE OF INFORMATION CAMP ELCHO LAKE SURVEY PROJECT  
 SOUNDINGS 250 FOOT INTERVALS  
 DATES OF MAP REVISION \_\_\_\_\_  
 WORK AGENCY C.C.C.



# LAKE SURVEY MAP 35 36 2 1

LAKE SUMMIT  
 SECTION 2-35  
 TOWNSHIP 33-34 N  
 RANGE 10 E  
 TOWN OF UPHAM  
 COUNTY LANGLADE

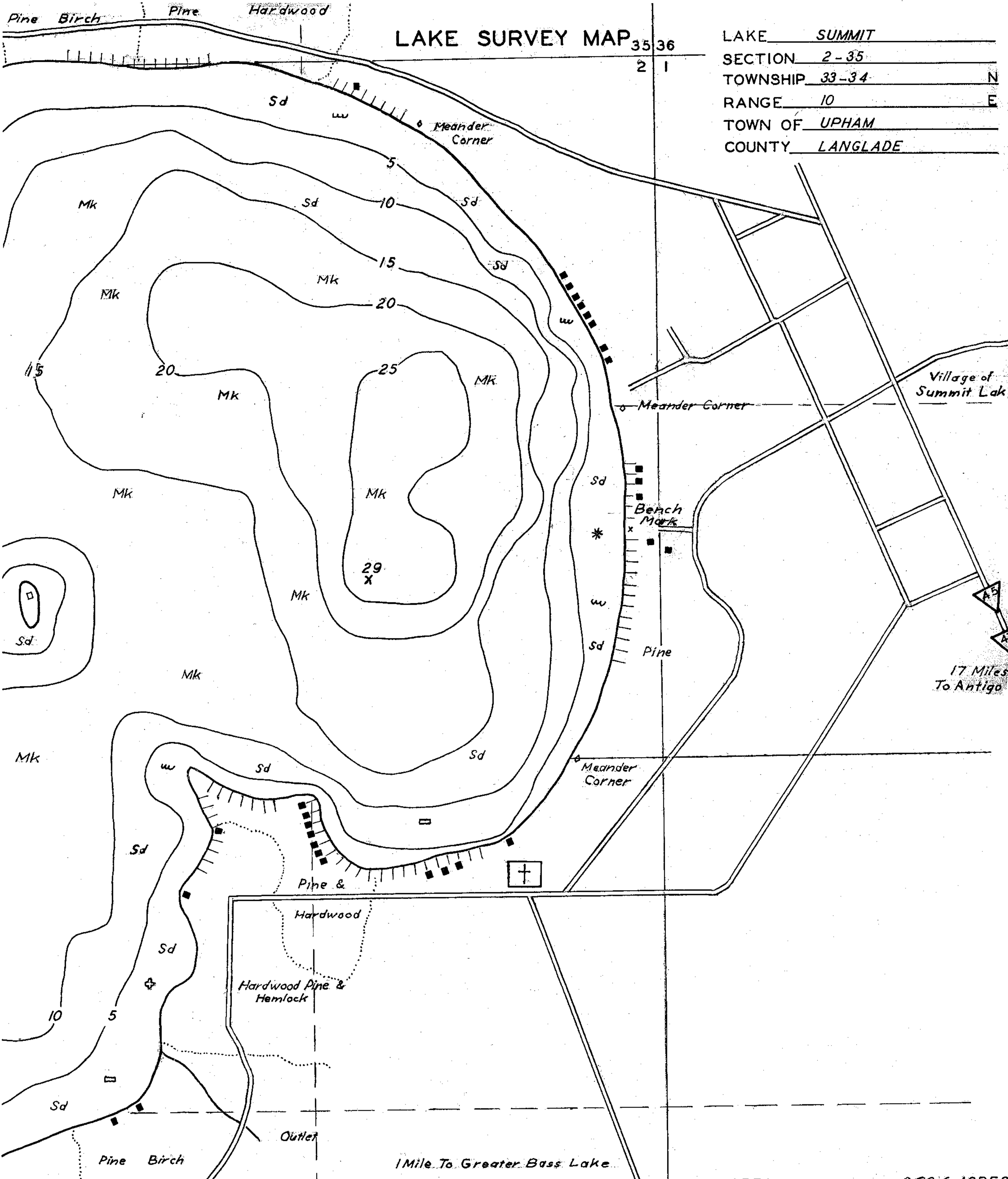

AREA 280.6 ACRES  
 TOTAL SHORELINE 3.1 MILES  
 MAX. DEPTH 29 FEET  
 SCALE 1"=330"

DATE JUNE 1940  
 COMPILED BY \_\_\_\_\_  
 TRACED BY J.S. C.C.C.  
 SOURCE OF INFORMATION CAMP ELCHO LAKE SURVEY PROJECT  
 \_\_\_\_\_  
 \_\_\_\_\_  
 SOUNDINGS 250 FOOT INTERVALS  
 \_\_\_\_\_  
 \_\_\_\_\_  
 DATES OF MAP REVISION \_\_\_\_\_  
 \_\_\_\_\_  
 WORK AGENCY C.C.C.

### LEGEND

- ⊗ WEED BEDS
- \* ROCKY SHOALS
- Sd SAND
- Cl CLAY
- Gr GRAVEL
- Mk MUCK
- DWELLING
- ABANDOND DWELLING
- ▣ RESORT

REV. BY  
 E.M.K.  
 4/1

WISCONSIN CONSERVATION DEPARTMENT  
 BIOLOGY DIVISION  
 LAKE AND STREAM IMPROVEMENT SECTION

LA

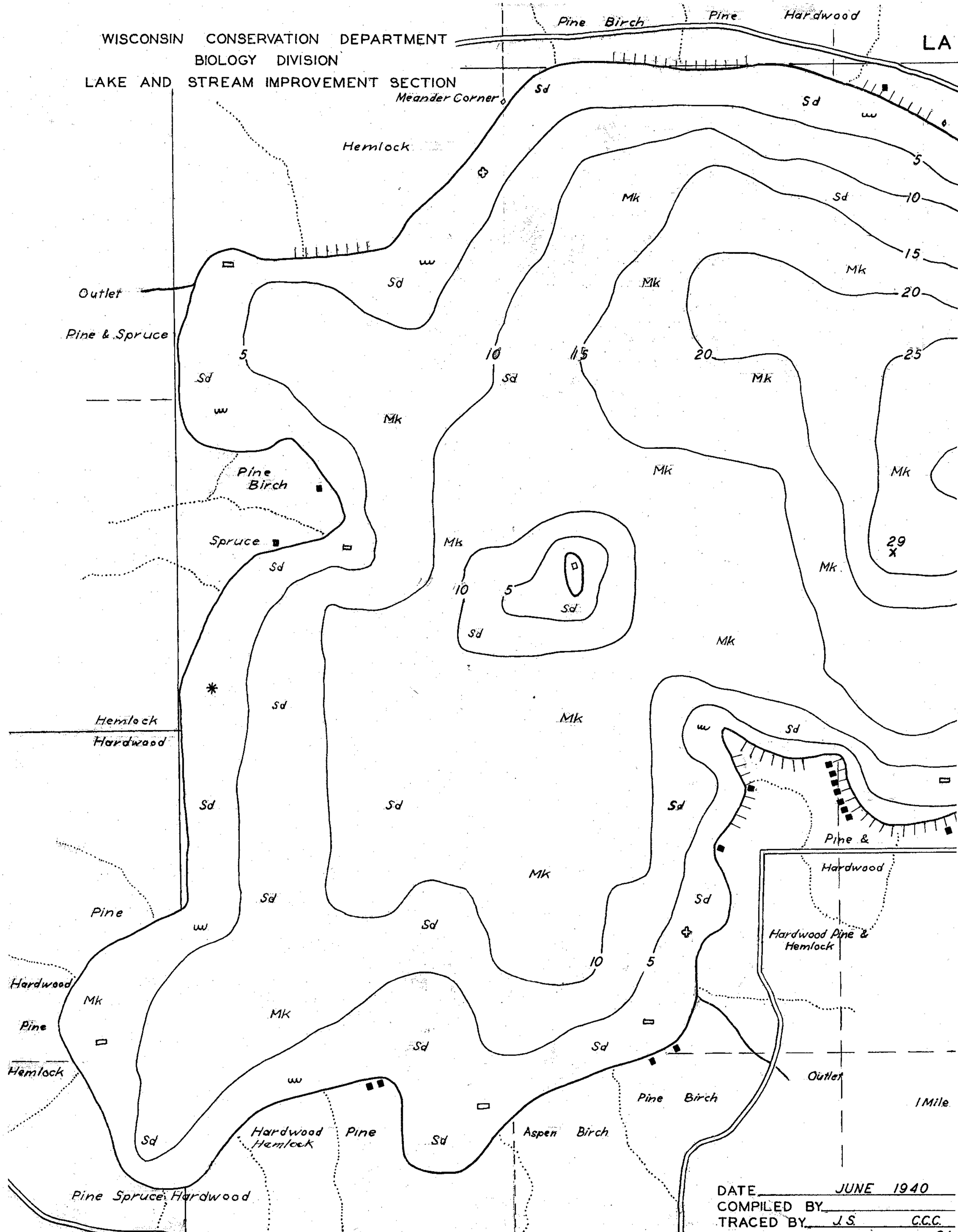

LAKE IMPROVEMENT RECORD

TYPE	DATE	35/36		
⊕ BRUSH REFUGES		10		
ω SAPLING TANGLES		37		
□ SPAWNING BOXES		27		
* MINNOW SPAWNERS		10		
TOTAL		84		

CHECKED BY  
 WRS - EMK  
 7-78-41

DATE JUNE 1940  
 COMPILED BY \_\_\_\_\_  
 TRACED BY J.S. C.C.C.  
 SOURCE OF INFORMATION CA/ ELCHO LAKE SURVEY PROJ  
 SOUNDINGS 250 FOOT INTER  
 DATES OF MAP REVISION \_\_\_\_\_  
 WORK AGENCY C.C.C.

Source: Wisconsin Department of Natural Resources 608-266-2621  
Summit Lake – Langlade County, Wisconsin DNR Lake Map  
Date Jun 1940 - Historical Lake Map - Not for Navigation  
A Public Document - Please Identify the Source when using it.