

LAKE SURVEY MAP

Department of Natural Resources
B.M. X 1211-A tablet set in concrete post
270'S. & 50'E. of public boat landing,
30' N.E. of fence corner post, 5' W.
of row of tamaracks. S. side of lake.
Assumed elevation 100.00'
Water level 96.17'

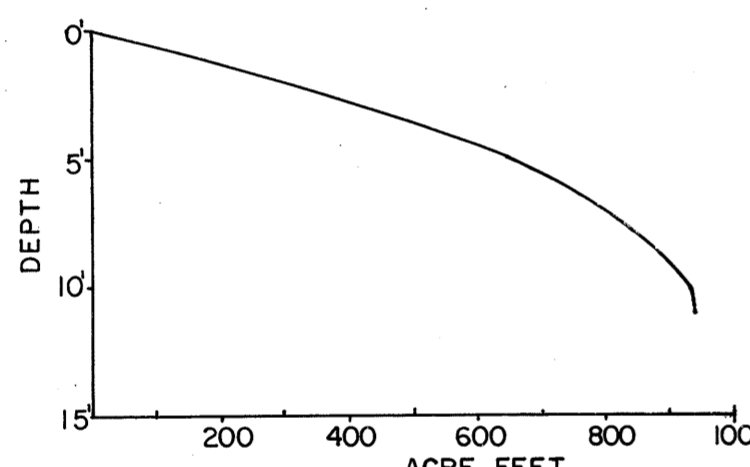
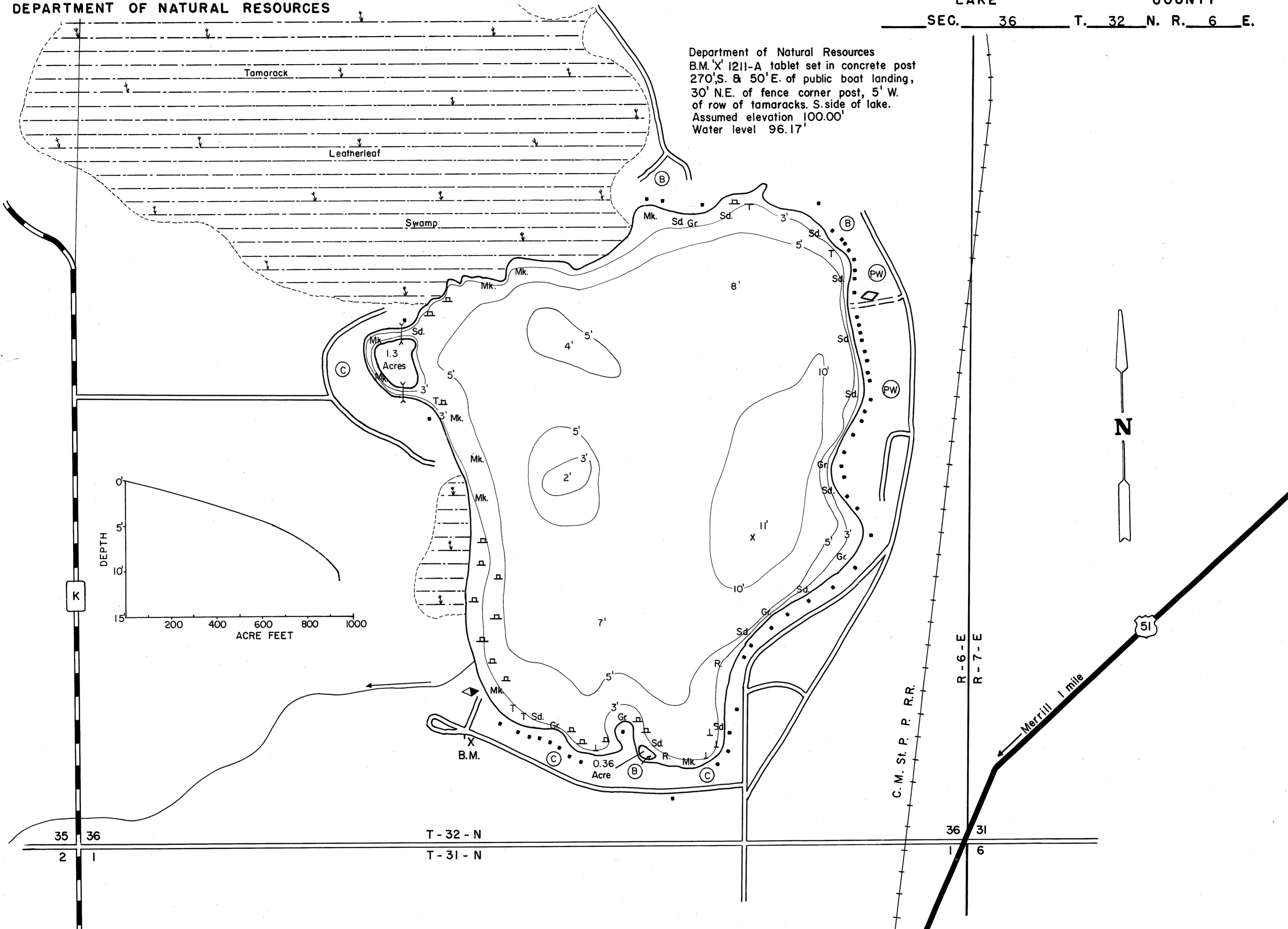

EQUIPMENT RECORDING SONAR MAPPED MAY 1968

- TOPOGRAPHIC SYMBOLS
- (B) Brush
 - (PW) Partially wooded
 - (W) Wooded
 - (C) Cleared
 - (P) Pastured
 - (A) Agricultural
 - B.M. Bench Mark
 - Dwelling
 - Resort
 - Camp

- LAKE BOTTOM SYMBOLS
- ||||| Steep slope
 - - - Indefinite shoreline
 - Marsh
 - Spring
 - Intermittent stream
 - Permanent inlet
 - Permanent outlet
 - Dam
 - D.N.R. State owned land
 - P. Peat
 - Mk. Muck
 - C. Clay
 - M. Marl
 - Sd. Sand
 - St. Silt
 - Gr. Gravel
 - R. Rubble
 - Br. Bedrock
 - B Boulders
 - Stumps & Snags
 - Rock danger to navigation
 - T Submergent vegetation
 - Emergent vegetation
 - Floating vegetation
 - Brush shelters



◆ Access ◆ Access with Parking ◆ Boat Livery

Drawn by: C. Holt
Field work by: P. Michelson, J. Smith

SPECIES OF FISH	Abundance	
	Abundant	Common
Muskie		
N. Pike	X	
Walleye		X
L.M. Bass	X	
S.M. Bass		
Panfish	X	
Trout		

WATER AREA 146 ACRES
 UNDER 3 FT. 9 %
 OVER 20 FT. 0 %
 MAX. DEPTH 11 FEET.
 TOTAL ALK. 4 P.P.M.
 VOLUME 939.7 ACRE FT.
 SHORELINE 2.1 MILES
 SHORELINE 2.3 Mile With Is.

Source: Wisconsin Department of Natural Resources 608-266-2621
Pesobic Lake(Pesabic Lake) - Lincoln County, Wisconsin DNR Lake Map
Date - May 1968 - Historical Lake Map - Not for Navigation
A Public Document - Please Identify the Source when using it.