

WISCONSIN CONSERVATION DEPARTMENT
 BIOLOGY DIVISION
 LAKE AND STREAM IMPROVEMENT SECTION

LAKE SURVEY MAP

LAKE _____ ROAD _____
 SECTION 11, 13, 14
 TOWNSHIP 34 N
 RANGE 6 E
 TOWN OF BRADLEY
 COUNTY LINCOLN

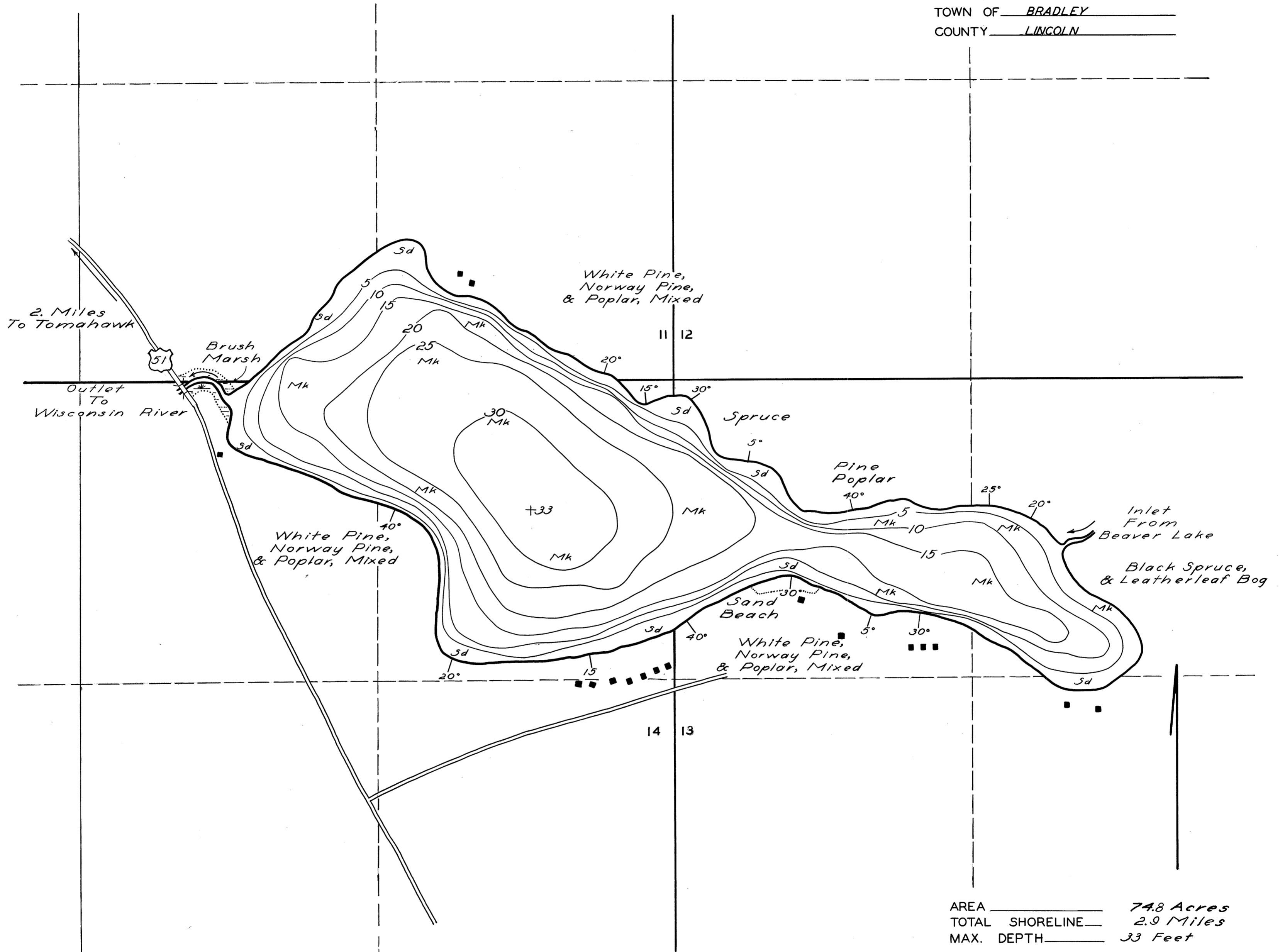

AREA _____ 74.8 Acres
 TOTAL SHORELINE _____ 2.9 Miles
 MAX. DEPTH _____ 33 Feet

SCALE 1" = 330'

DATE January 1940
 COMPILED BY E.M.B. C.C.C.
 TRACED BY T.J.R. C.C.C.
 SOURCE OF INFORMATION _____
C.C.C. Lake Survey Project
Camp Tomahawk
 SOUNDINGS 200' Intervals
C.C.C. Camp Tomahawk
 DATES OF MAP REVISION _____
March 1940
 WORK AGENCY C.C.C.

LAKE IMPROVEMENT RECORD

TYPE	DATE			
⊕ BRUSH REFUGES				
⊞ SAPLING TANGLES				
□ SPAWNING BOXES				
* MINNOW SPAWNERS				
TOTAL				

- LEGEND
- ⊕ WEED BEDS
 - ⊞ ROCKY SHOALS
 - Sd SAND
 - Cl CLAY
 - Gr GRAVEL
 - Mk MUCK
 - DWELLING
 - ABANDONED DWELLING
 - RESORT

Checked BY
 W.P.S.
 4-22-41.

Source: Wisconsin Department of Natural Resources 608-266-2621
Road Lake - Lincoln County, Wisconsin DNR Lake Map
Date - Jan 1940 - Historical Lake Map - Not for Navigation
A Public Document - Please Identify the Source when using it.