

NOTE:
Compiled in cooperation with the
Wisconsin Valley Improvement Company

Mohawksin Lake
1,909.6 Acres
25' Max. depth

B.M. 'X' 687-C is a square cut in
top of concrete platform of dam
Elevation 1442.84 M.S.L. datum
Full water elev. 1437.57 M.S.L. "

NOTE:
Concrete dam with steel gates
14' head.

EQUIPMENT RECORDING SONAR MAPPED		JULY 1982	
TOPOGRAPHIC SYMBOLS		LAKE BOTTOM SYMBOLS	
(B) Brush	Steep slope	P. Peat	B. Boulders
(PW) Partially wooded	- - - Indefinite shoreline	Mk. Muck	o Stumps & Snags
(W) Wooded	Marsh	C. Clay	Rock danger to navigation
(C) Cleared	Spring	M. Marl	T Submergent vegetation
(P) Pastured	Intermittent stream	Sd. Sand	I Emergent vegetation
(A) Agricultural	Permanent inlet	St. Silt	F Floating vegetation
B.M. Bench Mark	Permanent outlet	Gr. Gravel	Brush shelters
Dwelling	Dam	R. Rubble	
Resort	D.N.R. State owned land	Bc. Bedrock	
Camp			

SPECIES OF FISH	Abundance		
	Abundant	Common	Present
Muskie			X
N. Pike	X		
Walleye	X		
L.M. Bass	X		
S.M. Bass	X		
Panfish	X		
Trout			

ISLAND AREA 60.68 ACRES
WATER AREA 1,663.50 ACRES
UNDER 3 FT. 10 %
OVER 20 FT. 0.7 %
MAX. DEPTH 25 FEET.
TOTAL ALK. 28 P.P.M.
VOLUME 15,290.89 ACRE FT.
MAIN SHORELINE 42.274 MI.
ISLAND SHORELINE 8.027 MI.



Access Access with Parking Boat Livery

Drawn by: E. Eaton
Field work by: J. Smith, K. Arnold

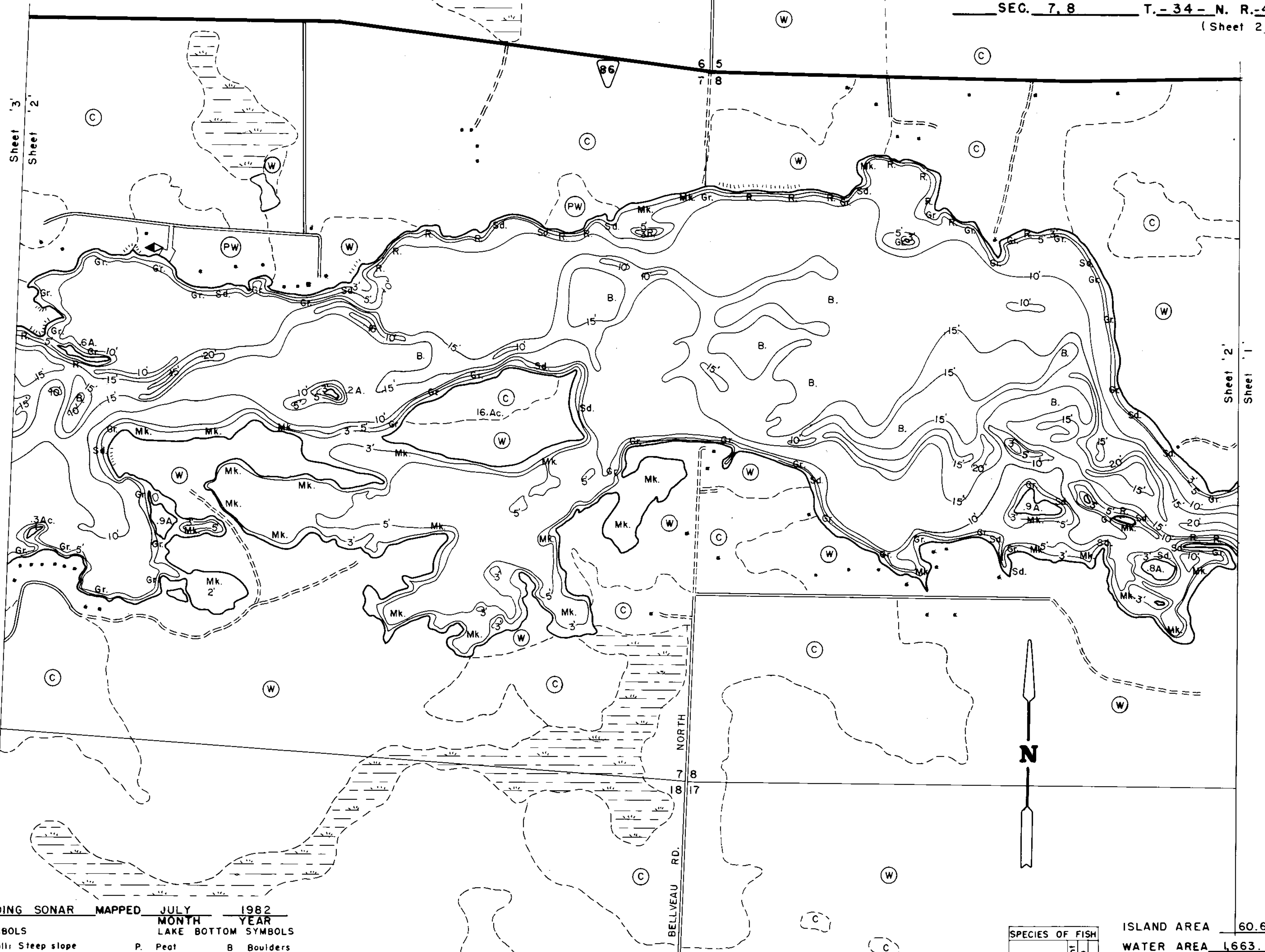

EQUIPMENT RECORDING SONAR MAPPED JULY 1982

TOPOGRAPHIC SYMBOLS		LAKE BOTTOM SYMBOLS	
MONTH		YEAR	
JULY		1982	
(B) Brush	Steep slope	P. Peat	B Boulders
(PW) Partially wooded	----- Indefinite shoreline	Mk. Muck	⊙ Stumps & Snags
(W) Wooded	Marsh	C. Clay	⊙ Rock danger to navigation
(C) Cleared	o Spring	M. Marl	T Submergent vegetation
(P) Pastured	--- Intermittent stream	Sd. Sand	⊥ Emergent vegetation
(A) Agricultural	==== Permanent inlet	St. Silt	⊥ Floating vegetation
B.M. Bench Mark	==== Permanent outlet	Gr. Gravel	⊥ Brush shelters
■ Dwelling	⊥ Dam	R. Rubble	
⊠ Resort	D.N.R. State owned land	Br. Bedrock	
⊠ Camp			



Access Access with Parking Boat Livery

Drawn by: E. Eaton
Field work by: J. Smith, K. Arnold

SPECIES OF FISH	Abundance		
	Abundant	Common	Present
Muskie			X
N. Pike		X	
Walleye		X	
L.M. Bass		X	
S.M. Bass			
Panfish	X		
Trout			

ISLAND AREA 60.68 ACRES
WATER AREA 1,663.50 ACRES
UNDER 3 FT. 10 %
OVER 20 FT. 0.7 %
MAX. DEPTH 25 FEET.
TOTAL ALK. 28 P.P.M.
VOLUME 15,290.89 ACRE FT.
MAIN SHORELINE 42.274 MI.
ISLAND SHORELINE 8.027 MI.

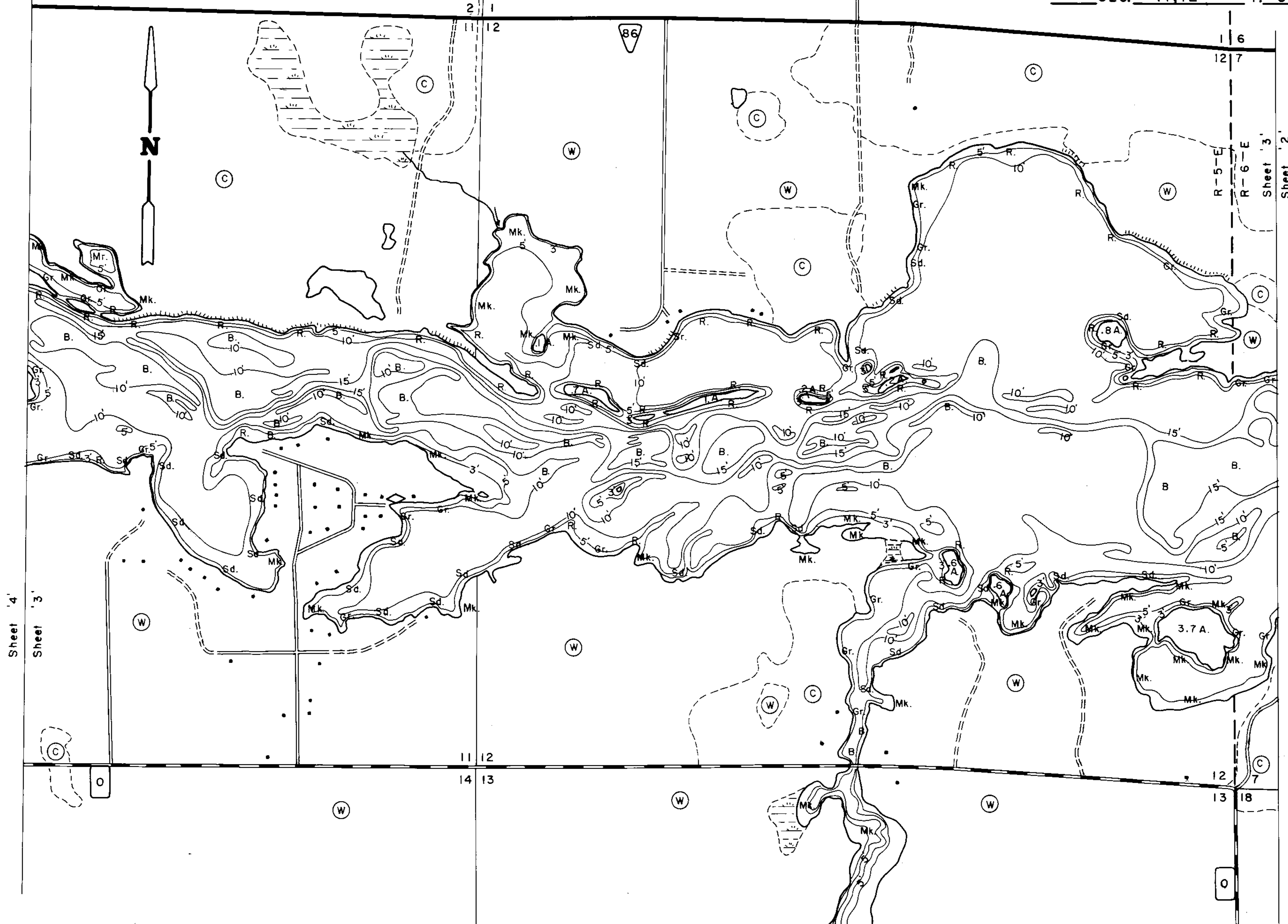

EQUIPMENT RECORDING SONAR MAPPED JULY 1982
MONTH YEAR

TOPOGRAPHIC SYMBOLS		LAKE BOTTOM SYMBOLS	
(B) Brush	Steep slope	P. Peat	B Boulders
(PW) Partially wooded	--- Indefinite shoreline	Mk. Muck	⚬ Stumps & Snags
(W) Wooded	--- Marsh	C. Clay	⚬ Rock danger to navigation
(C) Cleared	--- Spring	M. Marl	T Submergent vegetation
(P) Pastured	--- Intermittent stream	Sd. Sand	⚬ Emergent vegetation
(A) Agricultural	--- Permanent inlet	Sl. Silt	⚬ Floating vegetation
B.M. Bench Mark	--- Permanent outlet	Gr. Gravel	⚬ Brush shelters
■ Dwelling	--- Dam	R. Rubble	
■ Resort	--- D.N.R. State owned land	Bc. Bedrock	
■ Camp			

SPECIES OF FISH	Abundance	
	Abundant	Common
Muskie		X
N. Pike	X	X
Walleye	X	X
L.M. Bass	X	X
S.M. Bass	X	X
Panfish	X	X
Trout		

ISLAND AREA 60.68 ACRES
WATER AREA 1,663.50 ACRES
UNDER 3 FT. 10 %
OVER 20 FT. 0.7 %
MAX. DEPTH 25 FEET.
TOTAL ALK. 28 P.P.M.
VOLUME 15,290.89 ACRE FT.
MAIN SHORELINE 42,274 MI.
ISLAND SHORELINE 8.027 MI.

500' 0' 500' 1,000' 1,500' 2,000'
SCALE
◆ Access ◆ Access with Parking ◆ Boat Livery
Drawn by: E. Eaton
Field work by: J. Smith, K. Arnold

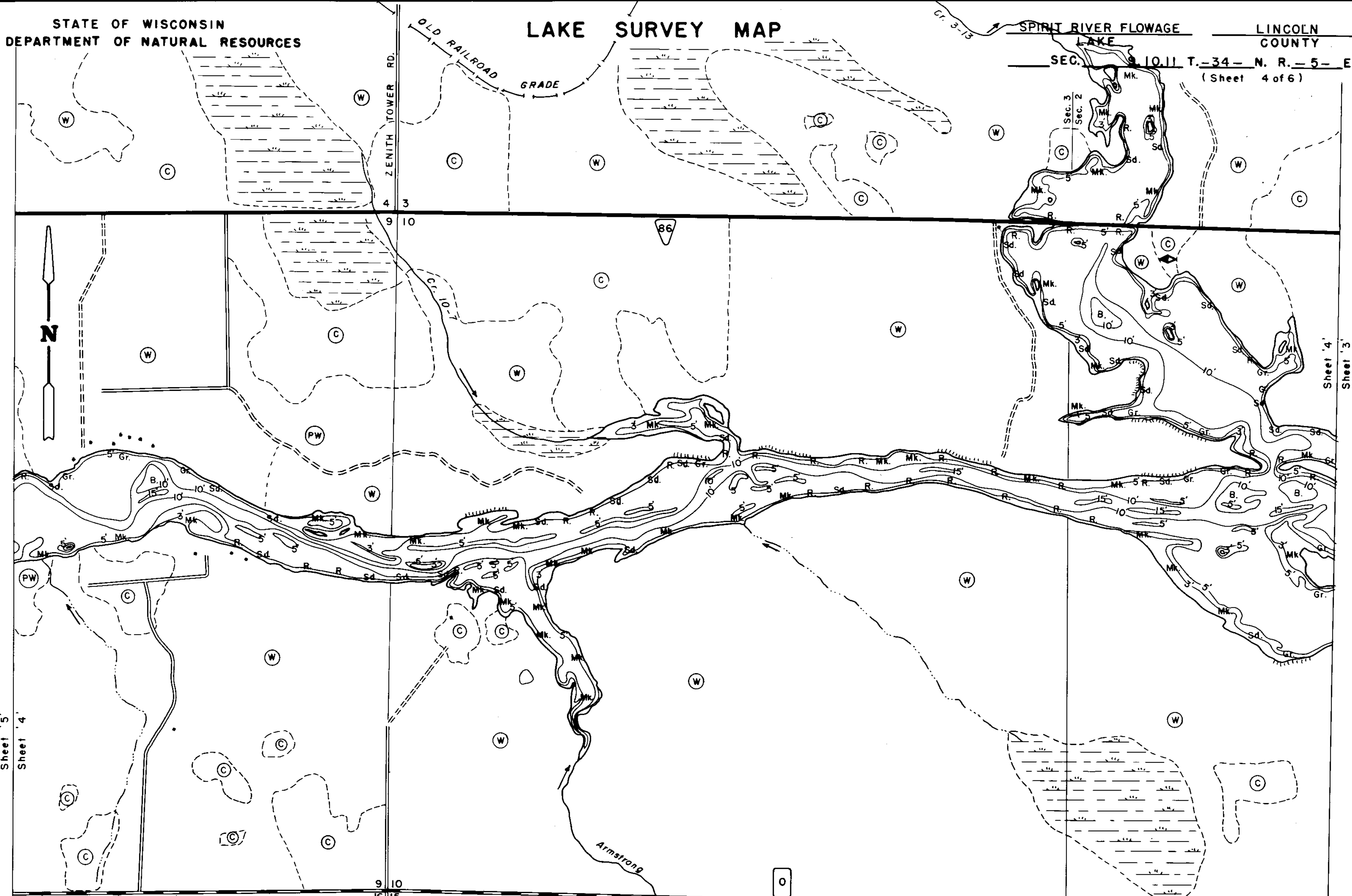

EQUIPMENT RECORDING SONAR MAPPED JULY 1982

- | TOPOGRAPHIC SYMBOLS | | LAKE BOTTOM SYMBOLS | |
|-----------------------|----------------------------|---------------------|-----------------------------|
| (B) Brush | Steep slope | P. Peat | B Boulders |
| (PW) Partially wooded | - - - Indefinite shoreline | Mk. Muck | ⊙ Stumps & Snags |
| (W) Wooded | ⊞ Marsh | C. Clay | ⊙ Rock danger to navigation |
| (C) Cleared | ⊞ Spring | M. Marl | T Submergent vegetation |
| (P) Pastured | ⊞ Intermittent stream | Sd. Sand | ⊞ Emergent vegetation |
| (A) Agricultural | ⊞ Permanent inlet | St. Silt | ⊞ Floating vegetation |
| B.M. Bench Mark | ⊞ Permanent outlet | Gr. Gravel | ⊞ Brush shelters |
| ■ Dwelling | ⊞ Dam | R. Rubble | |
| □ Resort | D.N.R. State owned land | Br. Bedrock | |
| □ Camp | | | |

SPECIES OF FISH	Abundance		
	Abundant	Common	Present
Muskie			X
N. Pike			X
Walleye		X	
L. M. Bass		X	
S. M. Bass		X	
Panfish		X	
Trout			

ISLAND AREA 60.68 ACRES
 WATER AREA 1,663.50 ACRES
 UNDER 3 FT. 10 %
 OVER 20 FT. 0.7 %
 MAX. DEPTH 25 FEET.
 TOTAL ALK. 28 P.P.M.
 VOLUME 15,290.89 ACRE FT.
 MAIN SHORELINE 42,274 MI.
 ISLAND SHORELINE 8,027 MI.



Access Access with Parking Boat Livery

Drawn by: E. Eaton
 Field work by: J. Smith, K. Arnold

Sheet '5'
Sheet '4'

Sheet '4'
Sheet '3'

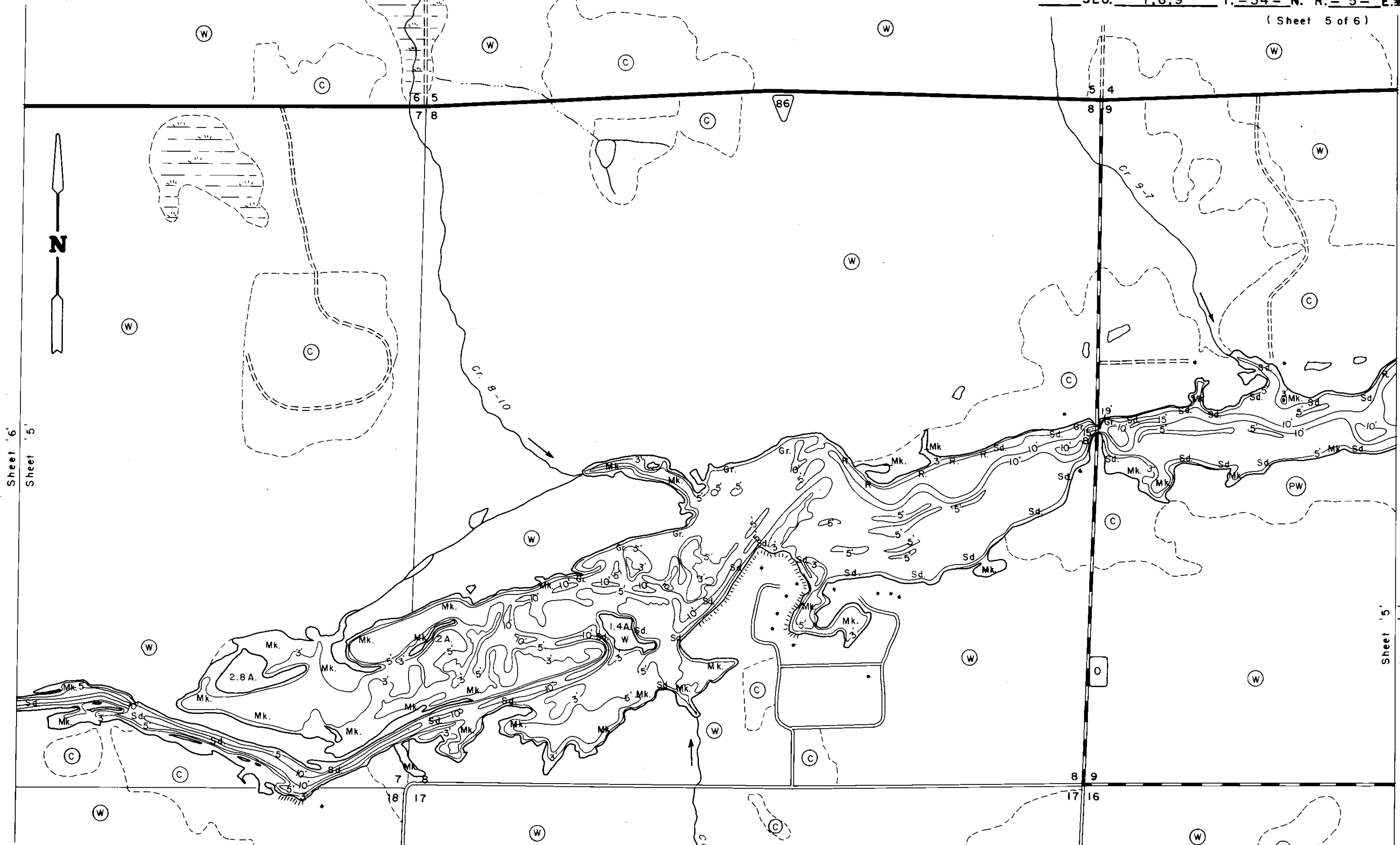

EQUIPMENT RECORDING SONAR MAPPED JULY 1982
MONTH YEAR

- | TOPOGRAPHIC SYMBOLS | | LAKE BOTTOM SYMBOLS | |
|-----------------------|----------------------------|---------------------|-----------------------------|
| (B) Brush | Steep slope | P. Peat | B Boulders |
| (PW) Partially wooded | - - - Indefinite shoreline | Mk. Muck | •• Stumps & Snags |
| (W) Wooded | Marsh | C. Clay | ⊛ Rock danger to navigation |
| (C) Cleared | Spring | M. Marl | T Submergent vegetation |
| (P) Pastured | Intermittent stream | Sd. Sand | ⊥ Emergent vegetation |
| (A) Agricultural | Permanent inlet | St. Silt | ⊥ Floating vegetation |
| B.M. Bench Mark | Permanent outlet | Gr. Gravel | ⊥ Brush shelters |
| ■ Dwelling | Dam | R. Rubble | |
| □ Resort | D.N.R. State owned land | Br. Bedrock | |
| □ Camp | | | |



Access Access with Parking Boat Livery

Drawn by: E. Eaton
Field work by: J. Smith, K. Arnold

SPECIES OF FISH	Abundant Common Present		
	Abundant	Common	Present
Muskie			X
N. Pike		X	
Walleye		X	
L. M. Bass		X	
S. M. Bass		X	
Panfish		X	
Trout			

ISLAND AREA 60.68 ACRES
WATER AREA 1,663.50 ACRES
UNDER 3 FT. 10 %
OVER 20 FT. 0.7 %
MAX. DEPTH 25 FEET.
TOTAL ALK. 28 P.P.M.
VOLUME 15,290.89 ACRE FT.
MAIN SHORELINE 42,274 MI.
ISLAND SHORELINE 8,027 MI.

Spirit Falls 2 Miles

LAKE SURVEY MAP

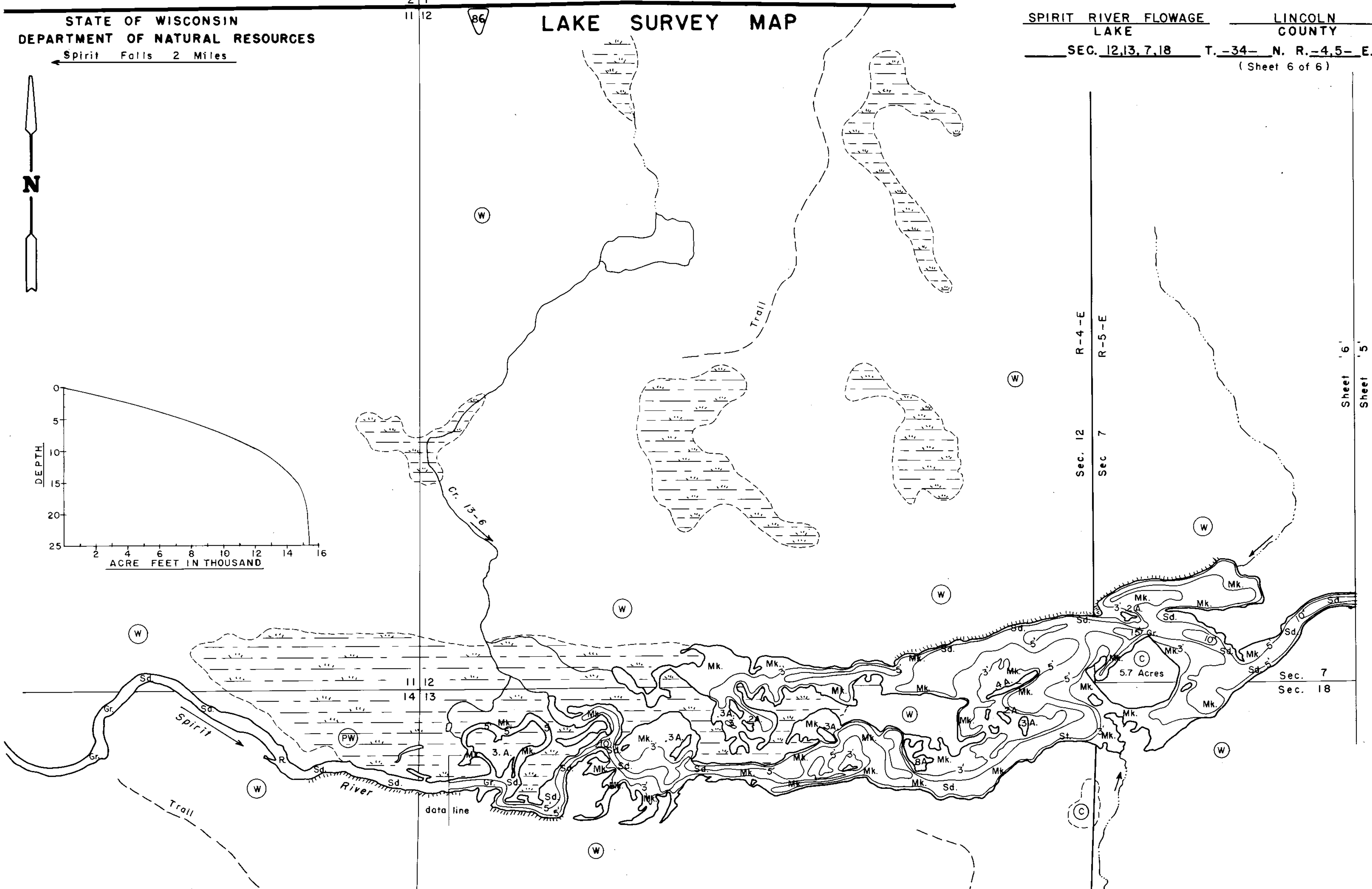
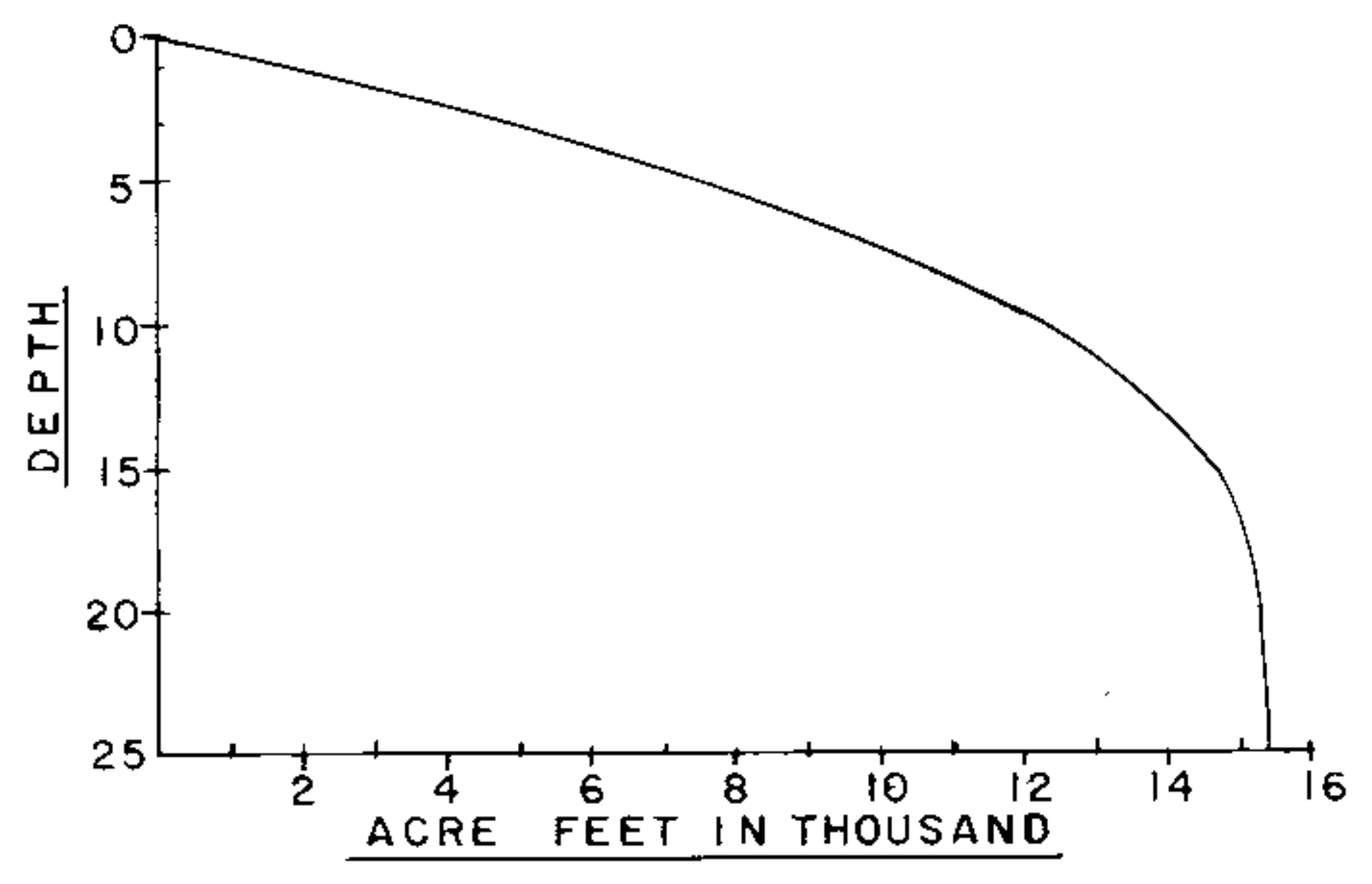

EQUIPMENT RECORDING SONAR MAPPED JULY 1982

TOPOGRAPHIC SYMBOLS		LAKE BOTTOM SYMBOLS	
(B) Brush	Steep slope	P. Peat	B Boulders
(PW) Partially wooded	- - - Indefinite shoreline	Mk. Muck	o Stumps & Snags
(W) Wooded	Marsh	C. Clay	o Rock danger to navigation
(C) Cleared	o Spring	M. Marl	T Submergent vegetation
(P) Pastured	- - - Intermittent stream	Sd. Sand	I Emergent vegetation
(A) Agricultural	==== Permanent inlet	St. Silt	o Floating vegetation
B.M. Bench Mark	==== Permanent outlet	Gr. Gravel	o Brush shelters
■ Dwelling	∩ Dam	R. Rubble	
■ Resort	∩ D.N.R. State owned land	Br. Bedrock	
■ Camp			



Drawn by: E. Eaton
Field work by: J. Smith, K. Arnold

SPECIES OF FISH	Abundance		
	Abundant	Common	Present
Muskie			X
N. Pike		X	
Walleye		X	
L. M. Bass		X	
S. M. Bass			
Panfish	X		
Trout			

ISLAND AREA 60.68 ACRES
WATER AREA 1,663.50 ACRES
UNDER 3 FT. 10 %
OVER 20 FT. 0.7 %
MAX. DEPTH 25 FEET.
TOTAL ALK. 28 P.P.M.
VOLUME 15,290.89 ACRE FT.
MAIN SHORELINE 42.274 MI.
ISLAND SHORELINE 8.027 MI.

Sheet '6'
Sheet '5'

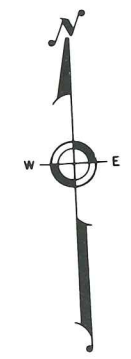
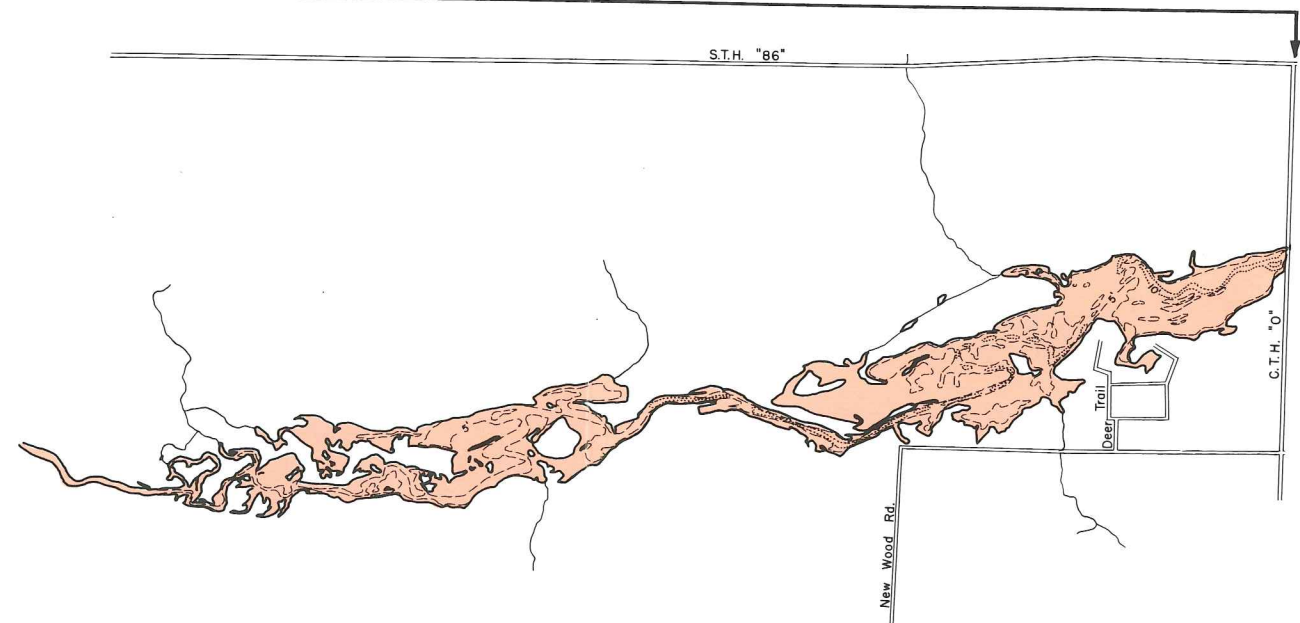
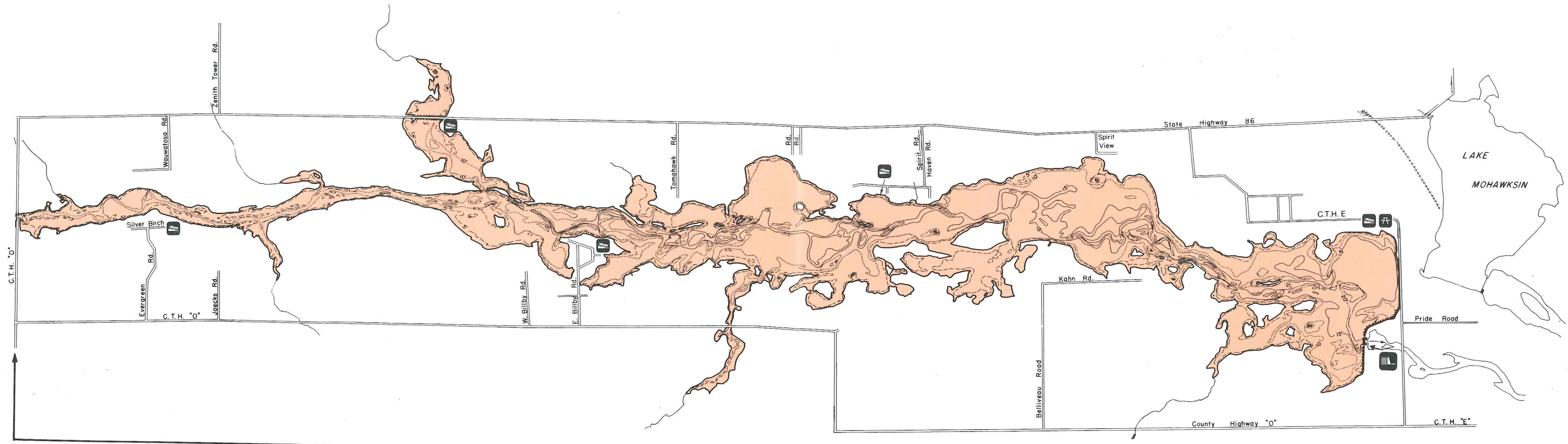

Map provided courtesy of
Wisconsin Valley Improvement Company
No reproduction or overprinting permitted.

SPIRIT RESERVOIR

LEGEND

- PUBLIC BOAT LANDING
- PICNIC AREA
- ROADS
- DAM
- EARTHEN DIKE

5' — — — WATER DEPTH
 10' - - - - CONTOURS AT
 15' — — — MAXIMUM
 20' - - - - ELEVATION

CANOE PORTAGE AT DAM



SPIRIT RESERVOIR

This map is presented by Wisconsin Valley Improvement Company (WVIC) as your guide to 1,698 acres of fishing and boating surrounded by 45 miles of shoreline.

The Spirit Reservoir was developed in 1922, the second of five reservoirs constructed by WVIC in its 21 reservoir system along the Wisconsin River. The Spirit was created in northwestern Lincoln County, just south of Tomahawk, by locating a dam on the Spirit River one mile upstream from its confluence with the Wisconsin.

Being a reservoir which plays a role in controlling runoff and Wisconsin River flow, the water levels in the Spirit typically vary about six inches a week. The Spirit River drainage area can produce "flashy" runoff rates, so water levels can change quickly. Drawdowns of one to two feet a week and refills of two to three feet a day can occur, and usually do at least once a year. The reservoir has unrestricted storage and release capabilities which help control high flows and increase low flows on the downstream Wisconsin River—its primary function in the WVIC system.

WVIC provides a public boat landing along Highway 86. This one and others around the reservoir provide access to the good fishing and scenic beauty of the Spirit. We are pleased the Spirit provides local residents and visitors with recreational opportunities while also serving the communities and industries in the river valley.

WVIC hopes this map and its information adds to your enjoyment and use of the Spirit Reservoir. We welcome your comments and suggestions for enhancing this fine recreational resource.

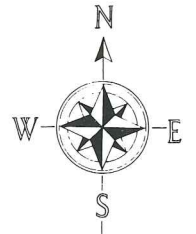
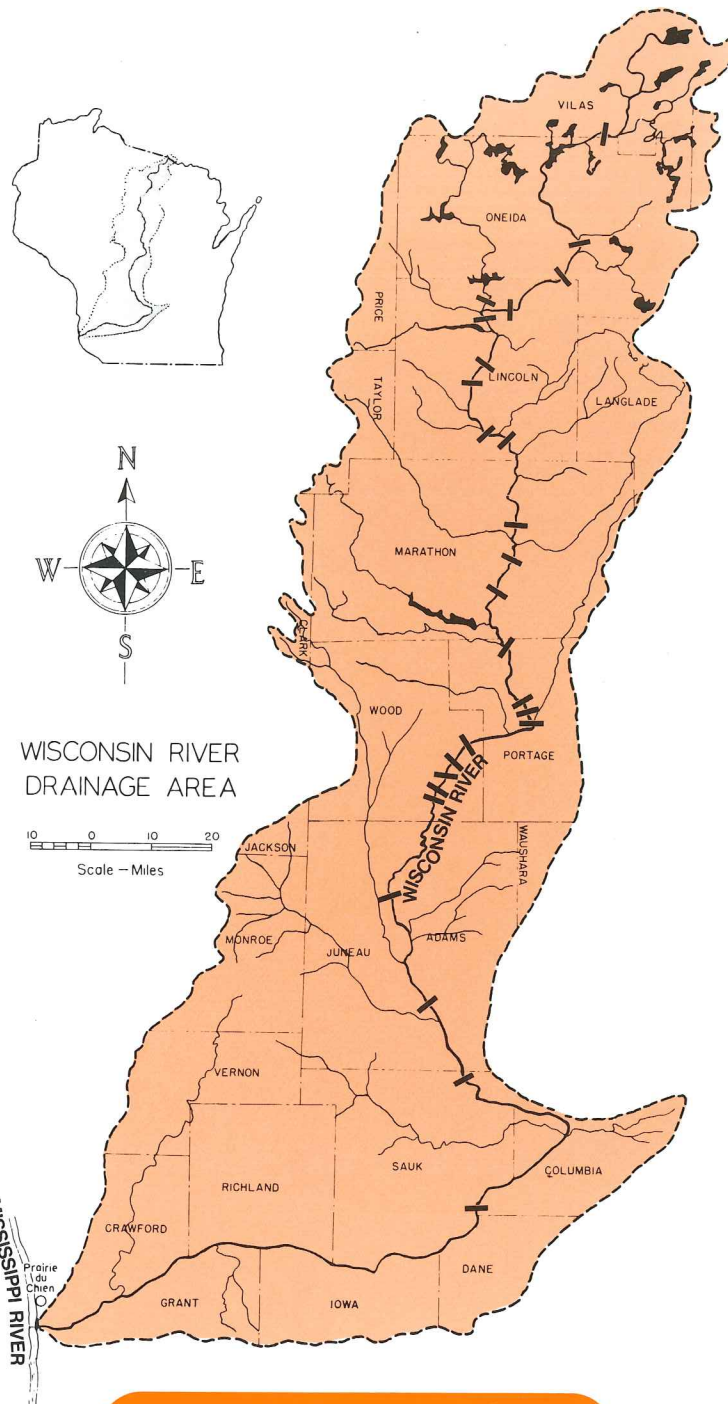

WISCONSIN RIVER DRAINAGE AREA

Scale - Miles

HYDRO-ELECTRIC DAMS
STORAGE RESERVOIRS
RESERVOIR DRAINAGE AREA: 1,931 SQ. MI.
TOTAL DRAINAGE AREA: 12,000 SQ. MI.

Reservoirs are vital to conservation of Wisconsin's greatest renewable natural resource, water.

Wisconsin Valley Improvement Company is unique among water resource organizations in America and is dedicated to constant improvement of our natural environment through stream flow regulation and flood control.

A resourceful use of water means our children and theirs can enjoy the beauty that is ours today.



2301 No. Third St., Wausau, WI 54403
(715) 848-2976
www.wvic.com

SPIRIT RESERVOIR



Source: Wisconsin Department of Natural Resources 608-266-2621
Spirit River Flowage - Lincoln County, Wisconsin DNR Lake Map
Date – Jul 1982 - Historical Lake Map - Not for Navigation
A Public Document - Please Identify the Source when using it.