

Sheet 1  
Sheet 2

EQUIPMENT RECORDING SONAR MAPPED AUG 1971

- | TOPOGRAPHIC SYMBOLS   |                         | LAKE BOTTOM SYMBOLS |                             |
|-----------------------|-------------------------|---------------------|-----------------------------|
| (B) Brush             | Steep slope             | P. Peat             | B Boulders                  |
| (PW) Partially wooded | ~ Indefinite shoreline  | MK. Muck            | ⊙ Stumps & Snags            |
| (W) Wooded            | ~ Marsh                 | C. Clay             | ⊙ Rock danger to navigation |
| (C) Cleared           | ~ Spring                | M. Marl             | T Submergent vegetation     |
| (P) Pastured          | ~ Intermittent stream   | Sd. Sand            | L Emergent vegetation       |
| (A) Agricultural      | ~ Permanent inlet       | St. Silt            | F Floating vegetation       |
| B.M. Bench Mark       | ~ Permanent outlet      | Gr. Gravel          | ⊕ Brush shelters            |
| ■ Dwelling            | ~ Dam                   | R. Rubble           |                             |
| □ Resort              | D.N.R. State owned land | Br. Bedrock         |                             |
| □ Camp                |                         |                     |                             |



Access Access with Parking Boat Livery

Drawn by: C. Halt  
Field work by: J. Smith

SPECIES OF FISH	Abundant Common Present		
	Abundant	Common	Present
Muskie			X
N. Pike	X		
Walleye	X	X	
L. M. Bass			X
S. M. Bass			X
Panfish	X		
Trout			

WATER AREA 404.4 ACRES  
UNDER 3 FT. 20 %  
OVER 20 FT. 0 %  
MAX. DEPTH 20 FEET.  
TOTAL ALK. 39 P.P.M.  
VOLUME 1794 ACRE FT.  
MAIN SHORELINE 13.4 MI.  
ISLAND SHORELINE 3.76 MI.

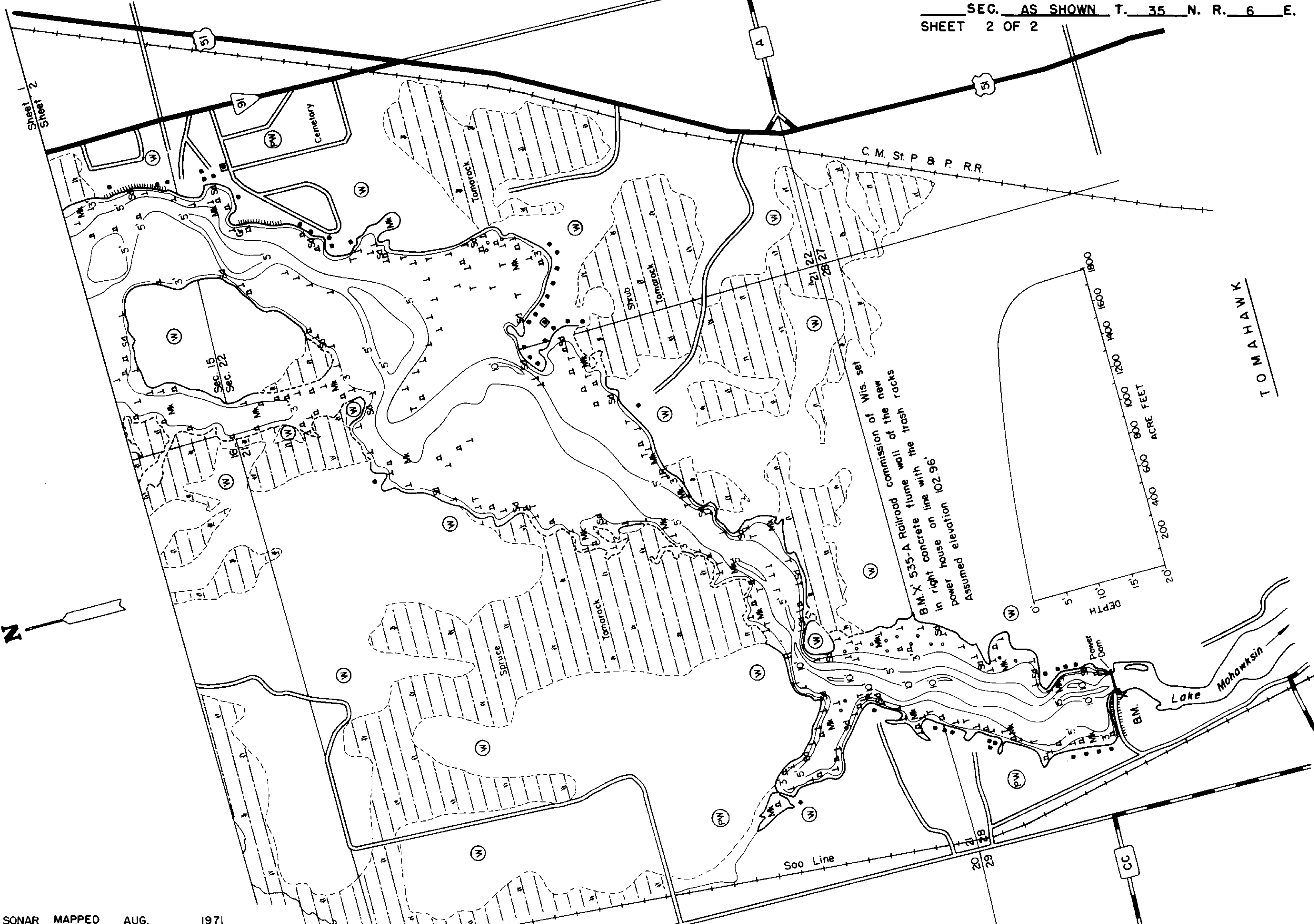

EQUIPMENT RECORDING SONAR MAPPED AUG 1971  
MONTH YEAR

- | TOPOGRAPHIC SYMBOLS   |                            | LAKE BOTTOM SYMBOLS |                             |
|-----------------------|----------------------------|---------------------|-----------------------------|
| (B) Brush             | Steep slope                | P. Peat             | B Boulders                  |
| (PW) Partially wooded | - - - Indefinite shoreline | Mk. Muck            | o Stumps & Snags            |
| (W) Wooded            | Marsh                      | C. Clay             | o Rock danger to navigation |
| (C) Cleared           | o Spring                   | M. Marl             | T Submergent vegetation     |
| (P) Pastured          | --- Intermittent stream    | Sd. Sand            | I Emergent vegetation       |
| (A) Agricultural      | Permanent inlet            | St. Silt            | d Floating vegetation       |
| B.M. Bench Mark       | Permanent outlet           | Gr. Gravel          | o Brush shelters            |
| ■ Dwelling            | ∩ Dam                      | R. Rubble           |                             |
| □ Resort              | D.N.R. State owned land    | Br. Bedrock         |                             |
| □ Camp                |                            |                     |                             |

SPECIES OF FISH	Abundant Common Present		
	Abundant	Common	Present
Muskie			X
N. Pike	X		
Walleye		X	
L.M. Bass			X
S.M. Bass			X
Panfish	X		
Trout			

WATER AREA 404.4 ACRES  
 UNDER 3 FT. 20 %  
 OVER 20 FT. 0 %  
 MAX. DEPTH 20 FEET.  
 TOTAL ALK. 39 P.P.M.  
 VOLUME 1794 ACRE FT.  
 MAIN SHORELINE 13.4 MI.  
 ISLAND SHORELINE 3.76 MI.

600' 0' 600' 1200' 1800' 2400'  
 SCALE  
 ♦ Access    ♦ Access with Parking    ♦ Boat Livery  
 Drawn by: C. Hall  
 Field work by: J. Smith

Source: Wisconsin Department of Natural Resources 608-266-2621  
Jersey City Flowage - Lincoln County, Wisconsin DNR Lake Map  
Date – Aug 1971 - Historical Lake Map - Not for Navigation  
A Public Document - Please Identify the Source when using it.