

LAKE SURVEY MAP

LAKE MUSKIE FORM FI-117
 SECTION 32 5
 TOWNSHIP 37-38 N
 RANGE 7-8 E
 TOWN OF CASSIAN LAKE-TOMAHAWK
 COUNTY ONEIDA

WISCONSIN CONSERVATION DEPARTMENT
 BIOLOGY DIVISION
 LAKE AND STREAM IMPROVEMENT SECTION

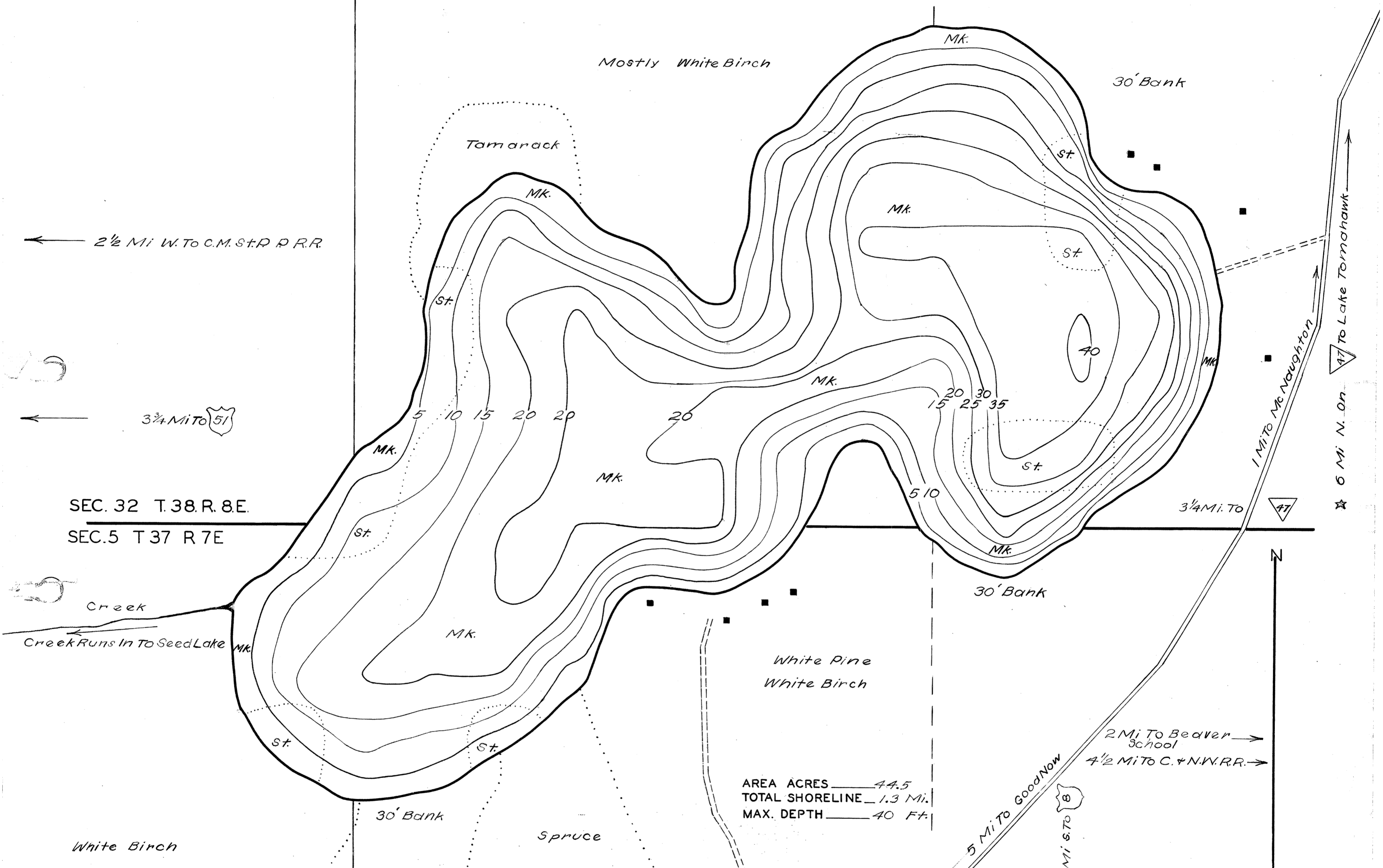

AREA ACRES 44.5
 TOTAL SHORELINE 1.3 Mi.
 MAX. DEPTH 40 Ft.

DATE April 21 1941
 COMPILED BY _____
 TRACED BY W. Z. CWPA
 SOURCE OF INFORMATION _____
W.P.A. Lake Survey Project
Feb 1941
 SOUNDINGS At 165' Intervals
 DATES OF MAP REVISION _____
 WORK AGENCY W. P. A.

LAKE IMPROVEMENT RECORD

TYPE	DATE			
BRUSH REFUGES				
SAPLING TANGLES				
SPAWNING BOXES				
MINNOW SPAWNERS				
TOTAL				

SCALE 1 inch Equals 165 Ft.
 100 200 300 400 500 600

- LEGEND
- WEED BEDS
 - ROCKY SHOALS
 - SAND
 - CLAY
 - GRAVEL
 - MUCK
 - DWELLING
 - ABANDONED DWELLING
 - RESORT
 - SILT

← 2 1/2 Mi W. To C.M. St. P. R.R.

← 3 3/4 Mi To 51

SEC. 32 T. 38. R. 8. E.
 SEC. 5 T. 37 R. 7 E.

Creek
 ← Creek Runs In To Seed Lake

3 1/4 Mi. To

1 Mi To Mc Naughton

6 Mi N. On

2 Mi To Beaver School
 4 1/2 Mi To C. & N.W. R.R. →

5 Mi To Good Now
 7 Mi S. To 8

Source: Wisconsin Department of Natural Resources 608-266-2621
Muskie Lake T38N R7E S35– Oneida County, Wisconsin DNR Lake Map
Date – Apr 1941 - Historical Lake Map - Not for Navigation
A Public Document - Please Identify the Source when using it.