

B.M. 'X' 1798 is a brass cap stamped D.N.R. set in a concrete post located 42' South of C.T.H. "CC", 35' North of water, and 2' East of fence at public boat landing near Tomahawk Lodge Resort.
Assumed Elevation = 100.00'
Water level = 94.58'

(Sheet 2 of 2)
(Sheet 1 of 2)

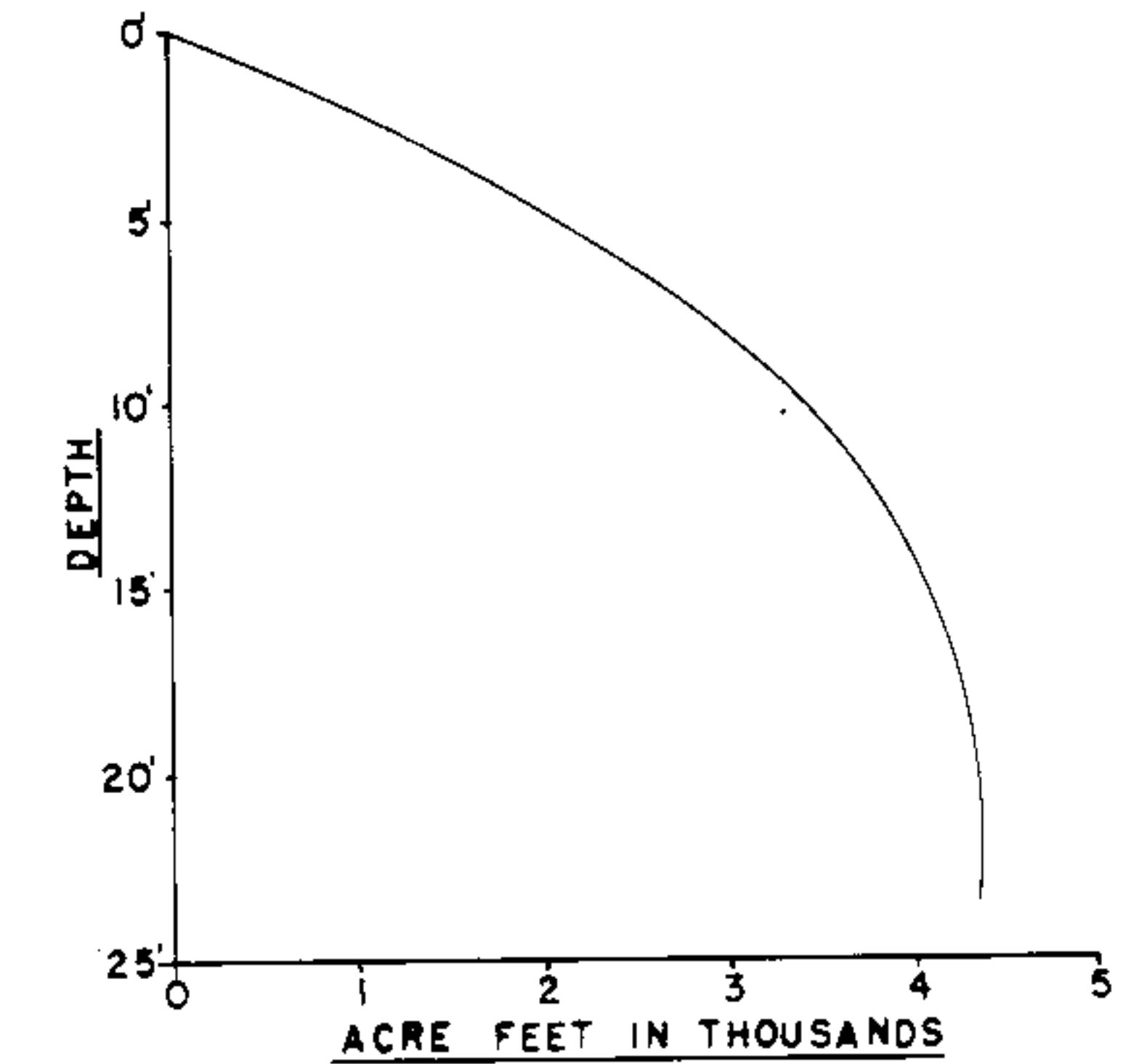
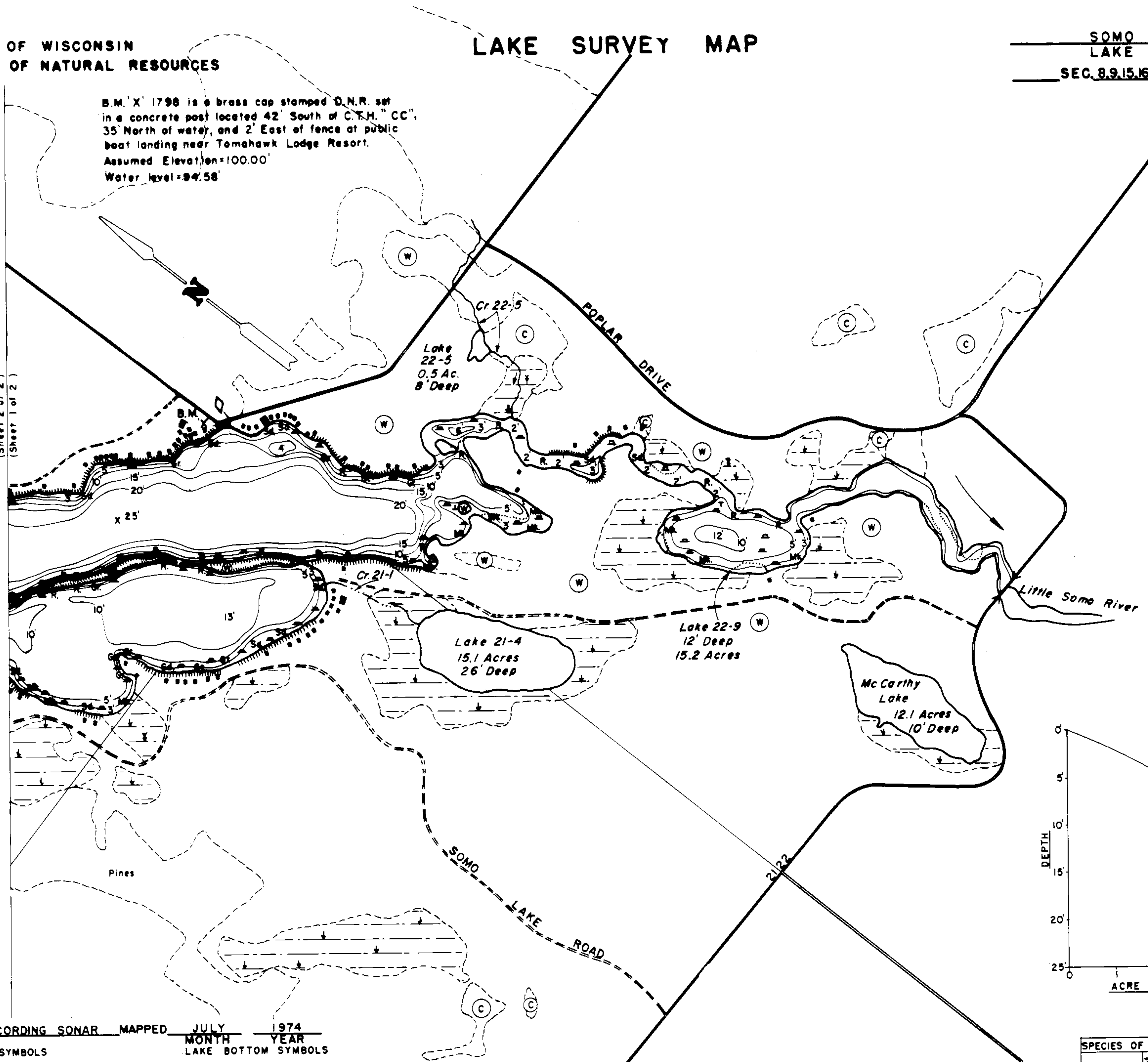

EQUIPMENT RECORDING SONAR MAPPED JULY 1974
MONTH YEAR

- | TOPOGRAPHIC SYMBOLS | | LAKE BOTTOM SYMBOLS | |
|---------------------|-------------------------------|---------------------|-----------------------------|
| (B) Brush | Steep slope | P. Peat | B Boulders |
| (PW) Partly wooded | ----- Indefinite shoreline | Mk. Muck | o Stumps & Snags |
| (W) Wooded | ----- Marsh | C. Clay | ⊗ Rock danger to navigation |
| (C) Cleared | o Spring | M. Marl | T Submergent vegetation |
| (P) Pastured | ----- Intermittent stream | Sd. Sand | ⊥ Emergent vegetation |
| (A) Agricultural | ----- Permanent inlet | St. Silt | ⊥ Floating vegetation |
| B.M. Bench Mark | ----- Permanent outlet | Gr. Gravel | ⊥ Brush shelters |
| ■ Dwelling | ⊥ Dam | R. Rubble | |
| □ Resort | ----- D.N.R. State owned land | Br. Bedrock | |
| □ Camp | | | |



◆ Access ◆ Access with Parking ◆ Boat Livery
Drawn by: G. Thussen
Field work by: J. Smith, K. Kaplan

SPECIES OF FISH	Abundance		
	Abundant	Common	Present
Muskie			X
N. Pike		X	X
Walleye		X	X
L. M. Bass		X	X
S. M. Bass		X	X
Panfish	X		
Trout			

WATER AREA 472.3 ACRES
UNDER 3 FT. 11.07 %
OVER 20 FT. 0.45 %
MAX. DEPTH 25 FEET.
TOTAL ALK. 19 P.P.M.
VOLUME 4334.60 ACRE FT.
MAIN SHORELINE 11.86 MI.
ISLAND SHORELINE 2.3 MI.

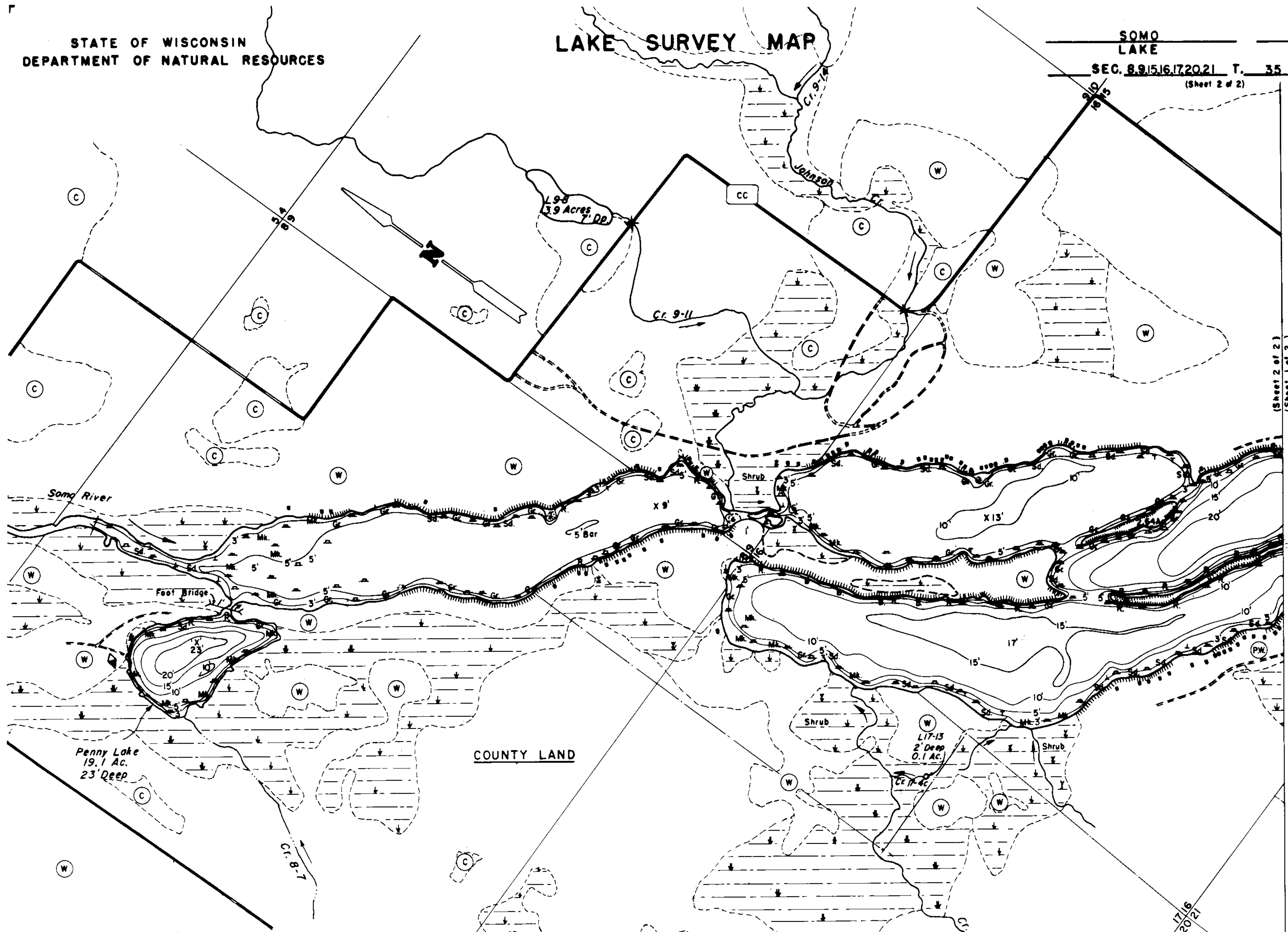

EQUIPMENT RECORDING SONAR MAPPED		JULY 1974	
		MONTH	YEAR
		LAKE	BOTTOM
TOPOGRAPHIC SYMBOLS			
(B) Brush	Steep slope	P. Peat	B Boulders
(PW) Partially wooded	----- Indefinite shoreline	Mk. Muck	⚡ Stumps & Snags
(W) Wooded	⊞ Marsh	C. Clay	⚡ Rock danger to navigation
(C) Cleared	○ Spring	M. Marl	T Submergent vegetation
(P) Pastured	~ Intermittent stream	Sd. Sand	⚡ Emergent vegetation
(A) Agricultural	== Permanent inlet	St. Silt	⚡ Floating vegetation
B.M. Bench Mark	== Permanent outlet	Gr. Gravel	⚡ Brush shelters
■ Dwelling	⚡ Dam	R. Rubble	
■ Resort	D.N.R. State owned land	Br. Bedrock	
■ Camp			

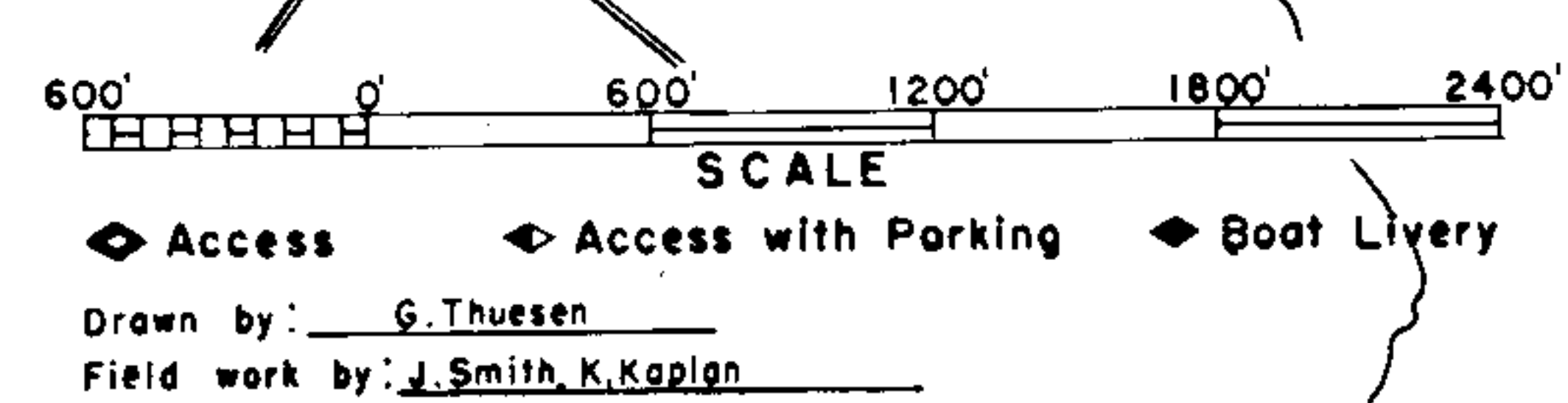

SPECIES OF FISH	ABUNDANCE		
	Abundant	Common	Present
Muskie			X
N. Pike		X	X
Wolleye		X	X
L.M. Bass		X	X
S.M. Bass		X	X
Panfish	X		
Trout			

WATER AREA	472.3	ACRES
UNDER 3 FT.	11.07	%
OVER 20 FT.	0.45	%
MAX. DEPTH	25	FEET.
TOTAL ALK.	19	P.P.M.
VOLUME	4334.6	ACRE FT.
MAIN SHORELINE	11.86	MI.
ISLAND SHORELINE	2.3	MI.

Source: Wisconsin Department of Natural Resources 608-266-2621
Somo Lake – Lincoln - Oneida Counties, Wisconsin DNR Lake Map
Date – Jul 1974 - Historical Lake Map - Not for Navigation
A Public Document - Please Identify the Source when using it.