

LAKE SURVEY MAP

WISCONSIN CONSERVATION DEPARTMENT
BIOLOGY DIVISION
LAKE AND STREAM IMPROVEMENT SECTION

LAKE SHEPARD
SECTION 28-27
TOWNSHIP 37 N
RANGE 9 E
TOWN OF PINE LAKE
COUNTY ONEIDA

FORM FI-117

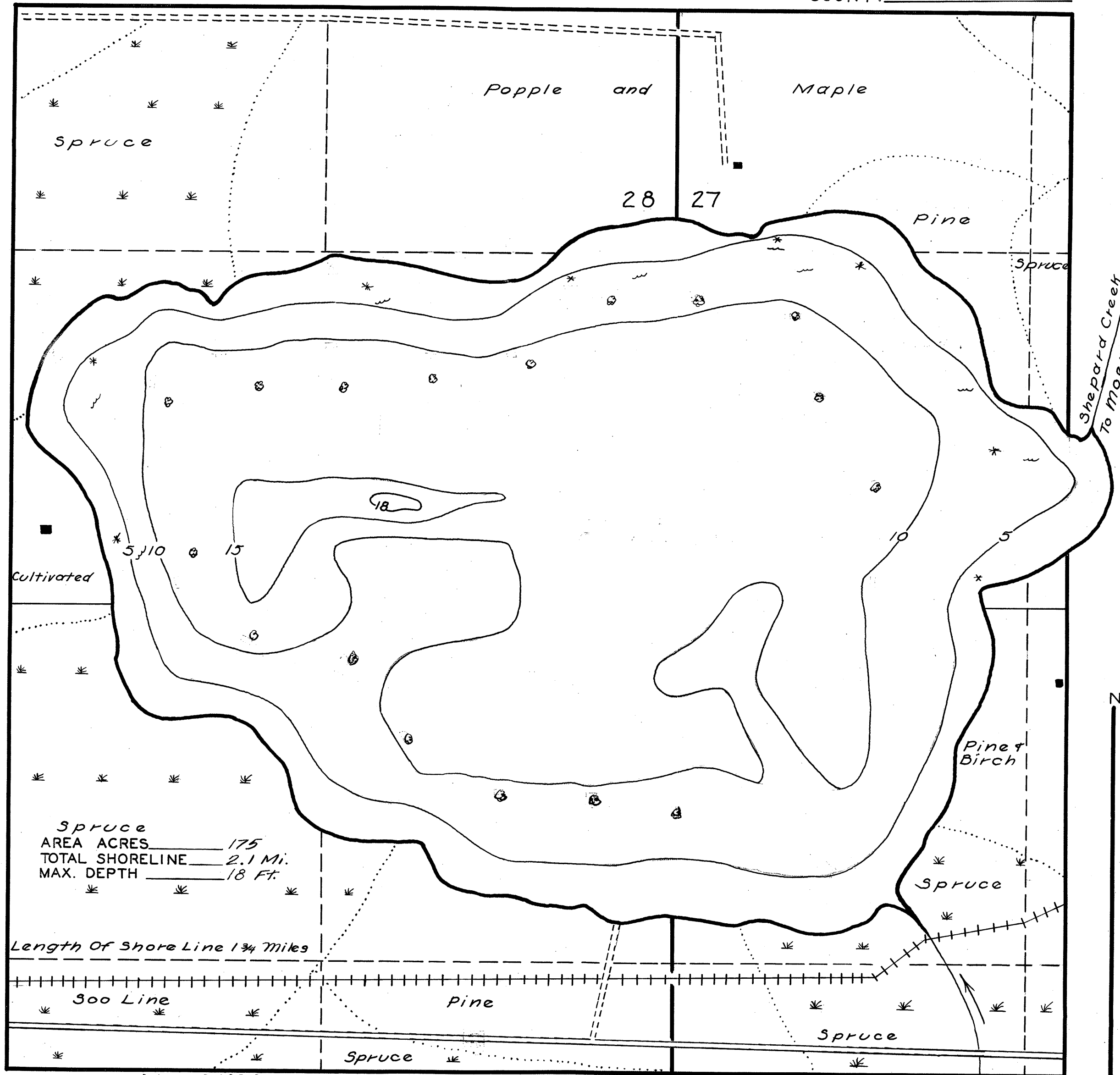

Spruce
AREA ACRES 175
TOTAL SHORELINE 2.1 Mi.
MAX. DEPTH 18 Ft.

DATE May 18, 1939
COMPILED BY R. F.
TRACED BY W. P. S.
SOURCE OF INFORMATION
W.P.A. Lake Survey Project

SOUNDINGS Intervals 330 Ft.
W.P.A. Lake Survey Project

DATES OF MAP REVISION _____

WORK AGENCY W.P.A.

LAKE IMPROVEMENT RECORD

TYPE	DATE <u>4/25/39</u>			
⊙ BRUSH REFUGES	<u>19</u>			
- SAPLING TANGLES	<u>105</u>			
□ SPAWNING BOXES				
* MINNOW SPAWNERS	<u>222</u>			
TOTAL <u>446</u>				

SCALE 1 inch = 330 feet

- LEGEND
- ⊙ WEED BEDS
 - ⊙ ROCKY SHOALS
 - Sd SAND
 - Cl CLAY
 - Gt GRAVEL
 - Mt MUCK
 - DWELLING
 - ABANDONED DWELLING
 - ▣ RESORT

Source: Wisconsin Department of Natural Resources 608-266-2621
Shepard Lake – Oneida County, Wisconsin DNR Lake Map
Date – May 1939 - Historical Lake Map - Not for Navigation
A Public Document - Please Identify the Source when using it.