

LAKE SURVEY MAP

WISCONSIN CONSERVATION DEPARTMENT
BIOLOGY DIVISION
LAKE AND STREAM IMPROVEMENT SECTION

LAKE TAMARACK
SECTION 26-27
TOWNSHIP 38 N
RANGE 9 E
TOWN OF SUGARCAMP
COUNTY ONEIDA

FORM FI-117

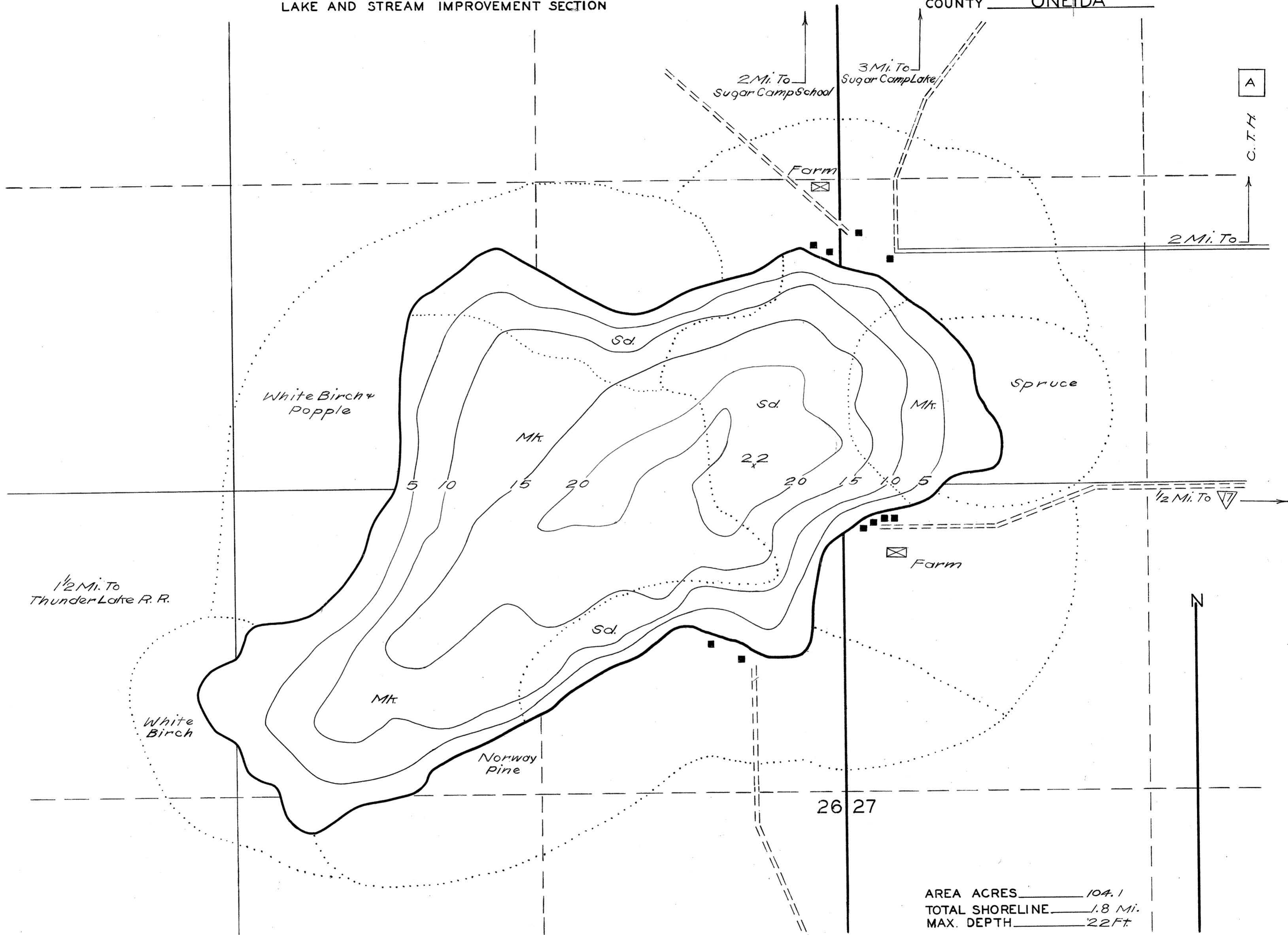

AREA ACRES 104.1
TOTAL SHORELINE 1.8 Mi.
MAX. DEPTH 22 Ft.

DATE May 9, 1941
COMPILED BY _____
TRACED BY W.T.Z. (WPA)
SOURCE OF INFORMATION _____
WPA Lake Survey Project
SOUNDINGS 165 Ft. intervals
DATES OF MAP REVISION _____
WORK AGENCY W. P. A.

LAKE IMPROVEMENT RECORD

TYPE	DATE			
⊙ BRUSH REFUGES	_____	_____	_____	_____
⊘ SAPLING TANGLES	_____	_____	_____	_____
□ SPAWNING BOXES	_____	_____	_____	_____
* MINNOW SPAWNERS	_____	_____	_____	_____
TOTAL	_____	_____	_____	_____

SCALE 1 inch Equals 330 Ft.

LEGEND

- ⊙ WEED BEDS
- ⊘ ROCKY SHOALS
- Sd. SAND
- Cl. CLAY
- Gr. GRAVEL
- Mk. MUCK
- DWELLING
- ABANDONED DWELLING
- RESORT

Source: Wisconsin Department of Natural Resources 608-266-2621
Tamarack Lake – Oneida County, Wisconsin DNR Lake Map
Date – May 1941 - Historical Lake Map - Not for Navigation
A Public Document - Please Identify the Source when using it.