

LAKE SURVEY MAP

LAKE HASBROOK FORM FI-117
 SECTION 25 26 27 35 34
 TOWNSHIP 39 N
 RANGE 7 E
 TOWN OF MINOCQUA
 COUNTY ONEIDA

WISCONSIN CONSERVATION DEPARTMENT
 BIOLOGY DIVISION
 LAKE AND STREAM IMPROVEMENT SECTION

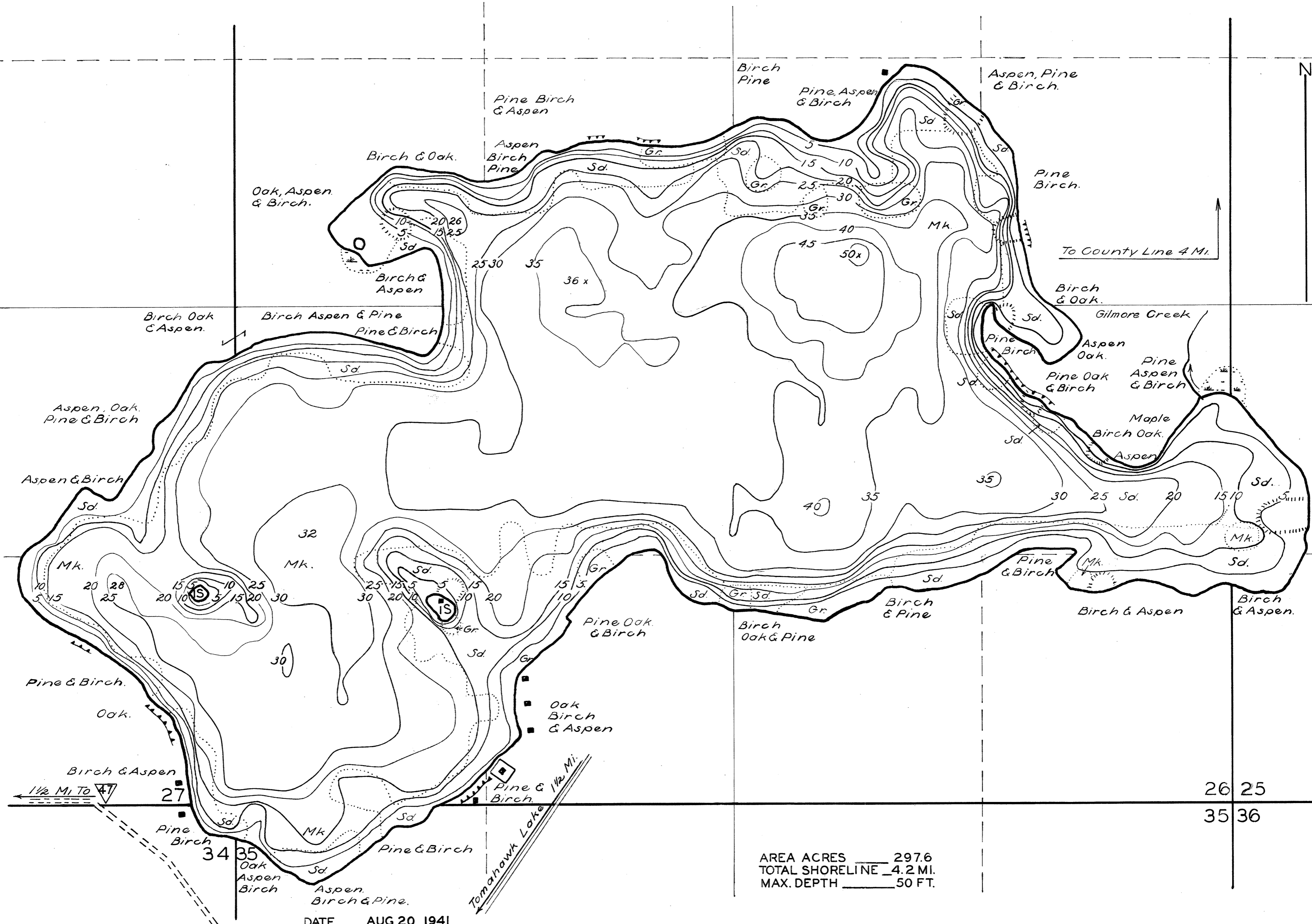

AREA ACRES 297.6
 TOTAL SHORELINE 4.2 MI.
 MAX. DEPTH 50 FT.

SCALE 1 INCH EQUALS 400 FT.
 0 100 200 300 400 500 600 700 800 900 1000

DATE AUG 20 1941
 COMPILED BY _____
 TRACED BY N.L.M. (W.P.A.)
 SOURCE OF INFORMATION _____
CAMP BLUE LAKE CCC. 57-S MAR 1941

 SOUNDINGS AT 150 OR LESS INTERVALS _____

 DATES OF MAP REVISION _____

 WORK AGENCY C.C.C.

LAKE IMPROVEMENT RECORD	
TYPE	DATE
⊗ BRUSH REFUGES	_____
~ SAPLING TANGLES	_____
□ SPAWNING BOXES	_____
* MINNOW SPAWNERS	_____
TOTAL	_____

LEGEND	
⊗	WEED BEDS
~	ROCKY SHOALS
Sd	SAND
Cl	CLAY
Gr	GRAVEL
Mk	MUCK
■	DWELLING
□	ABANDONED DWELLING
▣	RESORT
▲	STEEP SLOPE

Source: Wisconsin Department of Natural Resources 608-266-2621
Hasbrook Lake – Oneida County, Wisconsin DNR Lake Map
Date – Aug 1941 - Historical Lake Map - Not for Navigation
A Public Document - Please Identify the Source when using it.