

LAKE SURVEY MAP

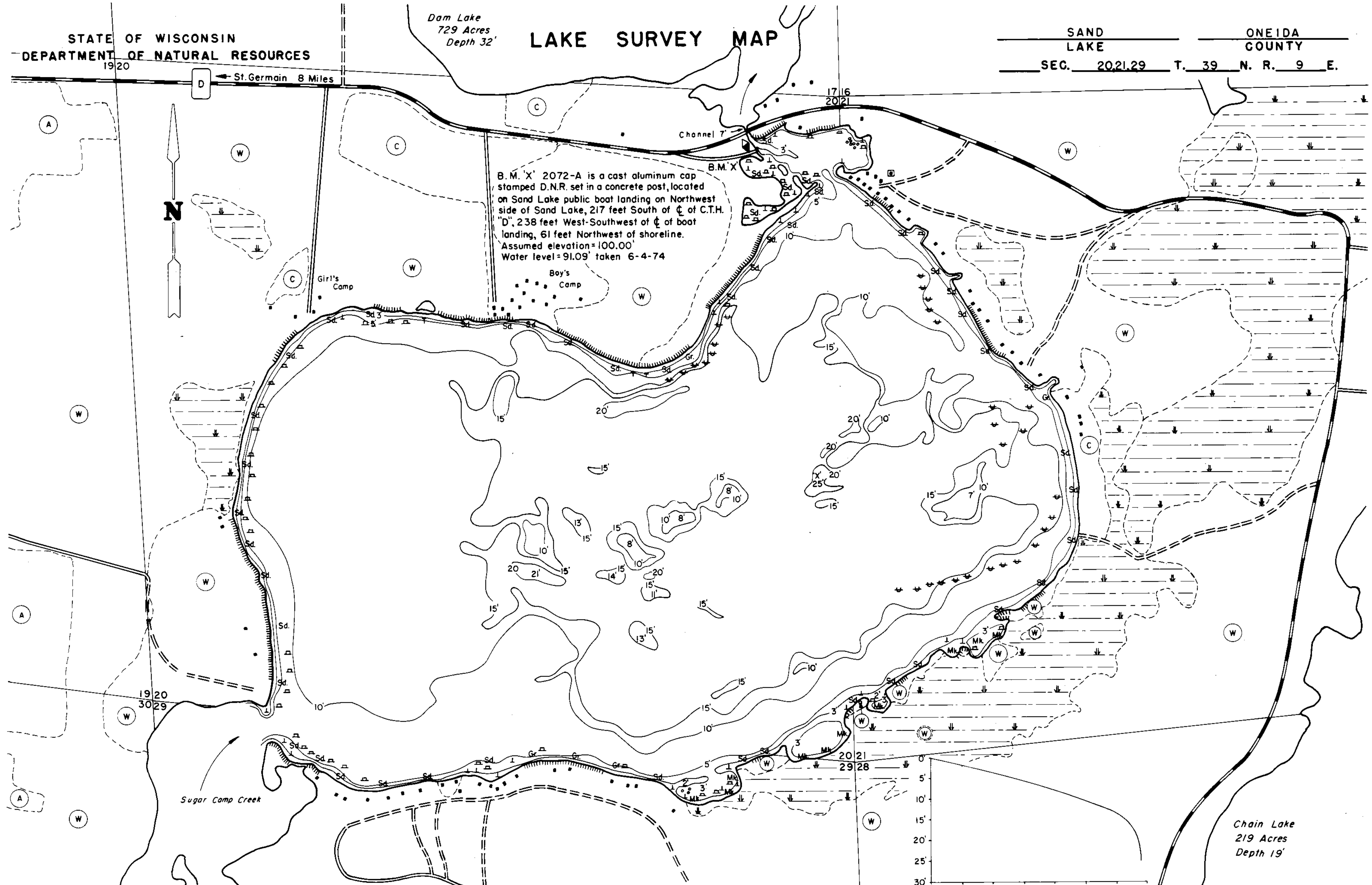

EQUIPMENT RECORDING SONAR MAPPED		AUG. 1974	
		MONTH	YEAR
TOPOGRAPHIC SYMBOLS			
(B) Brush	Steep slope	P. Peat	B Boulders
(PW) Partially wooded	- - - Indefinite shoreline	Mk. Muck	⊙ Stumps & Snags
(W) Wooded	Marsh	C. Clay	⊙ Rock danger to navigation
(C) Cleared	Spring	M. Marl	T Submergent vegetation
(P) Pastured	Intermittent stream	Sd. Sand	⊥ Emergent vegetation
(A) Agricultural	Permanent inlet	St. Silt	⊥ Floating vegetation
B.M. Bench Mark	Permanent outlet	Gr. Gravel	⊕ Brush shelters
■ Dwelling	Dam	R. Rubble	
▣ Resort	D.N.R. State owned land	Bc. Bedrock	
▣ Camp			

500' 0' 500' 1000' 1500' 2000'

SCALE

◆ Access ◀ Access with Parking ◆ Boat Livery

Drawn by: G. Thuesen
Field work by: J. Smith, R. Jones, K. Kaplan

SPECIES OF FISH	ABUNDANCE	
	Abundant	Common Present
Muskie		X
N. Pike	X	X
Walleye	X	X
L.M. Bass	X	X
S.M. Bass	X	X
Panfish	X	X
Trout		
Cisco		X

WATER AREA 539.83 ACRES
 UNDER 3 FT. 4.55 %
 OVER 20 FT. 0.64 %
 MAX. DEPTH 25 FEET.
 TOTAL ALK. 22 P.P.M.
 VOLUME 6751.81 ACRE FT.
 MAIN SHORELINE 4.85 MI.
 ISLAND SHORELINE .09 MI.

Source: Wisconsin Department of Natural Resources 608-266-2621
Sand Lake – Oneida/Vilas Counties, Wisconsin - DNR Lake Map
Date – Aug 1974 - Historical Lake Map - Not for Navigation
A Public Document - Please Identify the Source when using it.