

# LAKE SURVEY MAP

WISCONSIN CONSERVATION DEPARTMENT  
BIOLOGY DIVISION  
LAKE AND STREAM IMPROVEMENT SECTION

LAKE INDIAN  
SECTION 36-31-1-6  
TOWNSHIP 38-39 N  
RANGE 9-10 E  
TOWN OF SUGAR CAMP  
COUNTY ONIEDA

FORM FI-117

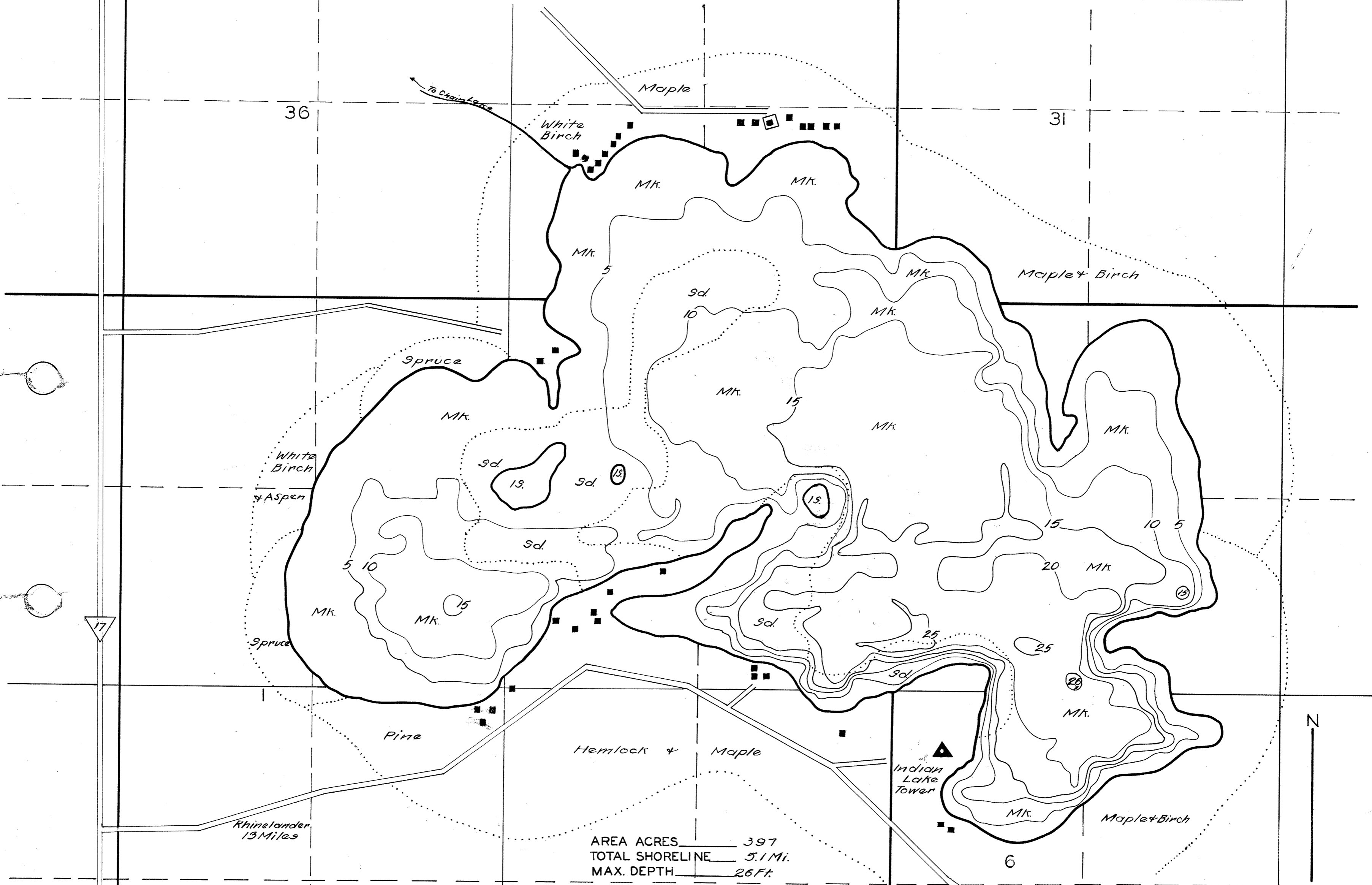

AREA ACRES 397  
TOTAL SHORELINE 5.1 Mi.  
MAX. DEPTH 26 Ft.

DATE July 7 1941  
COMPILED BY \_\_\_\_\_  
TRACED BY W. T. Z. (W.P.A.)  
SOURCE OF INFORMATION \_\_\_\_\_  
W.P.A. Lake Survey Project  
SOUNDINGS 12.5 Ft. intervals  
DATES OF MAP REVISION \_\_\_\_\_  
WORK AGENCY W. P. A.

### LAKE IMPROVEMENT RECORD

TYPE	DATE			
BRUSH REFUGES				
SAPLING TANGLES				
SPAWNING BOXES				
* MINNOW SPAWNERS				
TOTAL				

SCALE 1 inch Equals 500 Ft.  
0 250 500 750 1000 1250 1500

- LEGEND**
- WEED BEDS
  - ROCKY SHOALS
  - Sd. SAND
  - Cl. CLAY
  - Gr. GRAVEL
  - Mk. MUCK
  - DWELLING
  - ABANDONED DWELLING
  - RESORT

Source: Wisconsin Department of Natural Resources 608-266-2621  
Indian Lake – Oneida County, Wisconsin DNR Lake Map  
Date – Jul 1941 - Historical Lake Map - Not for Navigation  
A Public Document - Please Identify the Source when using it.