

LAKE SURVEY MAP

SILVER LAKE
VILAS COUNTY
SEC. 27, 28 T. -40- N. R. -10- E.

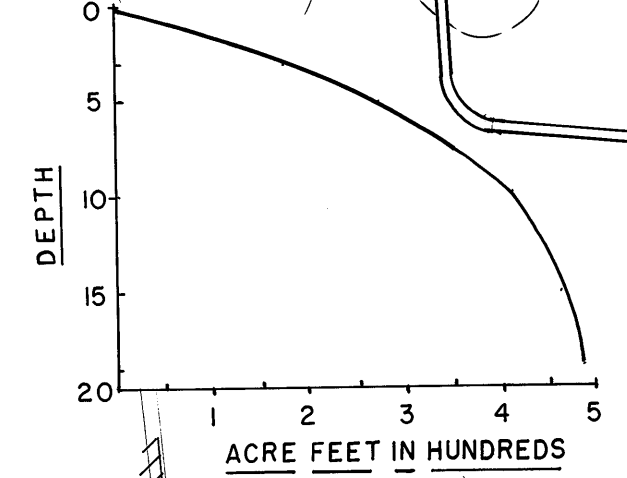
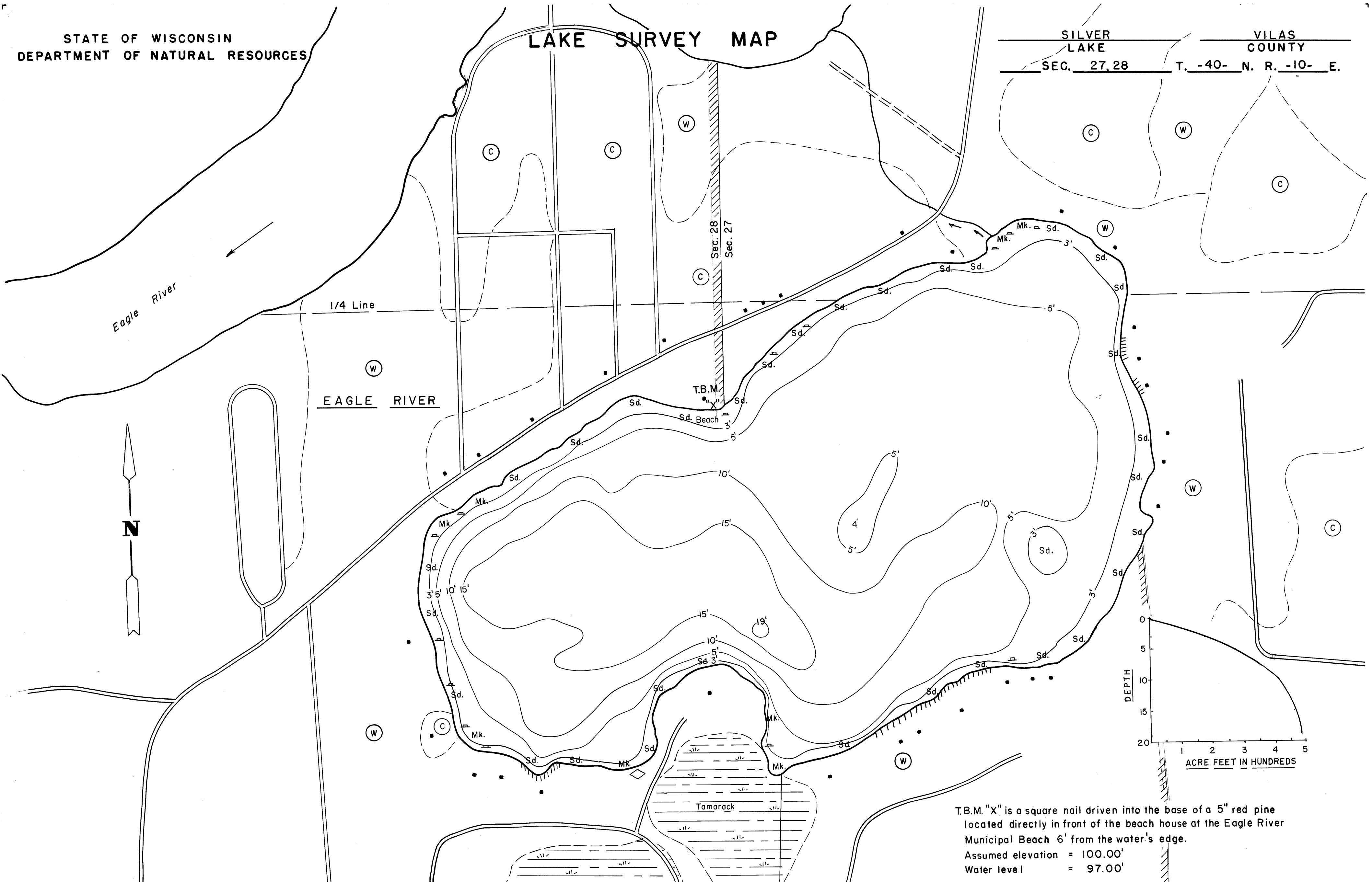

T.B.M. "X" is a square nail driven into the base of a 5" red pine located directly in front of the beach house at the Eagle River Municipal Beach 6' from the water's edge.
Assumed elevation = 100.00'
Water level = 97.00'

EQUIPMENT RECORDING SONAR MAPPED AUGUST 1978

- | TOPOGRAPHIC SYMBOLS | | LAKE BOTTOM SYMBOLS | |
|---------------------|------------------|---------------------|---------------------------|
| MONTH | YEAR | | |
| (B) | Brush | | Steep slope |
| (PW) | Partially wooded | - - - - - | Indefinite shoreline |
| (W) | Wooded | | Marsh |
| (C) | Cleared | o | Spring |
| (P) | Pastured | - - - - - | Intermittent stream |
| (A) | Agricultural | ==== | Permanent inlet |
| B.M. | Bench Mark | ==== | Permanent outlet |
| ■ | Dwelling | ∩ | Dam |
| □ | Resort | ∩ | D.N.R. State owned land |
| □ | Camp | P. | Peat |
| | | Mk. | Muck |
| | | C. | Clay |
| | | M. | Marl |
| | | Sd. | Sand |
| | | St. | Silt |
| | | Gr. | Gravel |
| | | R. | Rubble |
| | | Br. | Bedrock |
| | | B | Boulders |
| | | o | Stumps & Snags |
| | | ⊗ | Rock danger to navigation |
| | | T | Submergent vegetation |
| | | ∩ | Emergent vegetation |
| | | ∩ | Floating vegetation |
| | | + | Brush shelters |

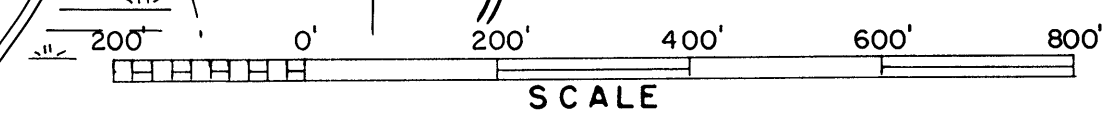

◆ Access ◆ Access with Parking ◆ Boat Livery

Drawn by: R. Williams
Field work by: J. Smith, K. Arnold, J. Clark

SPECIES OF FISH	Abundance		
	Abundant	Common	Present
Muskie			X
N. Pike			
Walleye			
L.M. Bass			X
S.M. Bass			
Panfish	X		
Trout			

WATER AREA 60.9 ACRES
UNDER 3 FT. 10 %
OVER 20 FT. 0 %
MAX. DEPTH 19 FEET.
TOTAL ALK. 11 P.P.M.
VOLUME 483.82 ACRE FT.
MAIN SHORELINE 1.37 MI.
ISLAND SHORELINE 0 MI.

Source: Wisconsin Department of Natural Resources 608-266-2621
Silver Lake – Vilas County, Wisconsin DNR Lake Map
Date – Aug 1978 - Historical Lake Map - Not for Navigation
A Public Document - Please Identify the Source when using it.