

# LAKE SURVEY MAP

MAPLE LAKE ONEIDA COUNTY  
SEC. 6 T. 38 N. R. 11 E.

B.M. 'X' N.W. corner of 4' x 4' x 3' cement support for control structure on outlet at N. side of lake  
Assumed elevation 100.00'  
Water level 95.83' (July 1969)

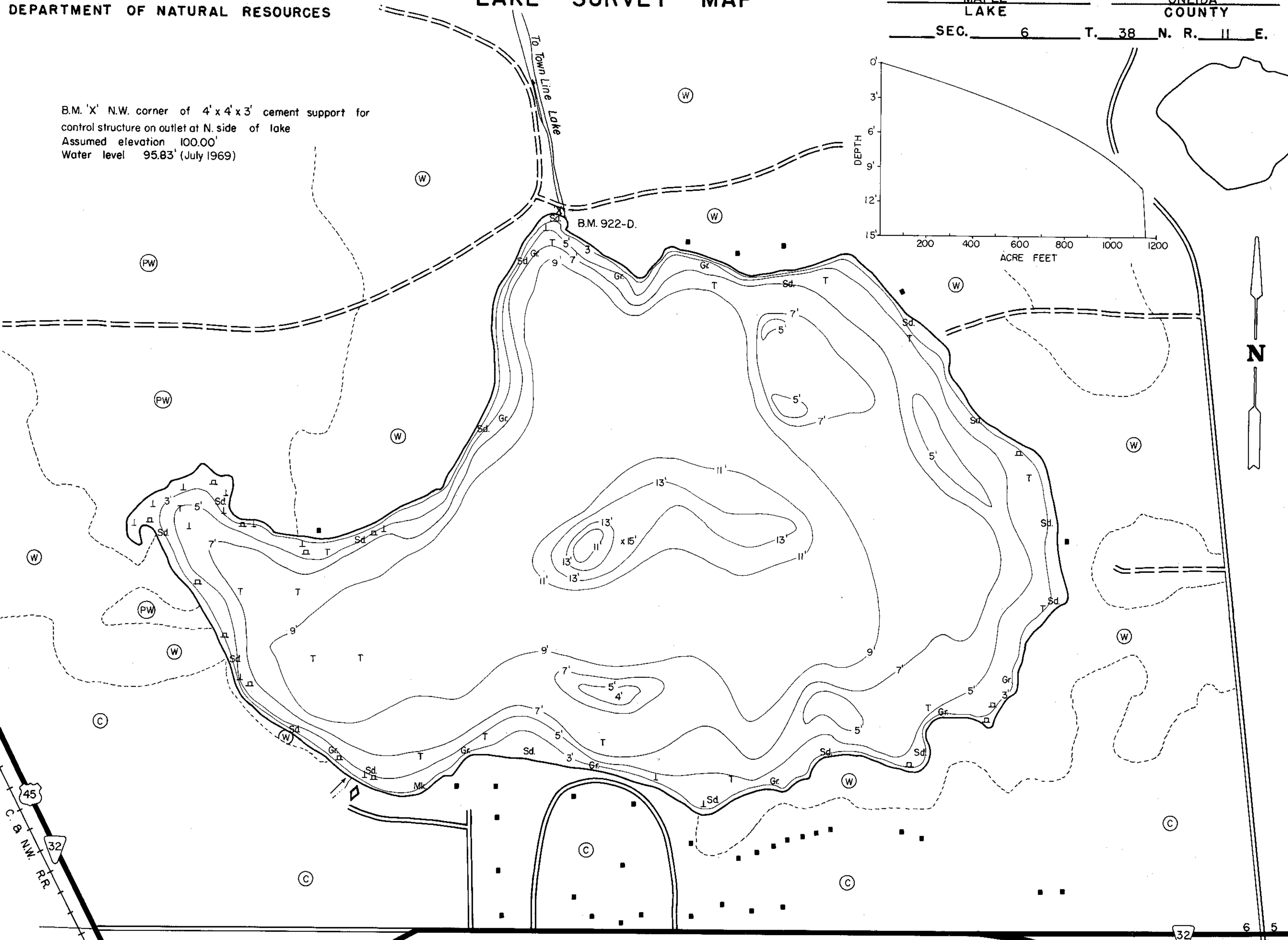
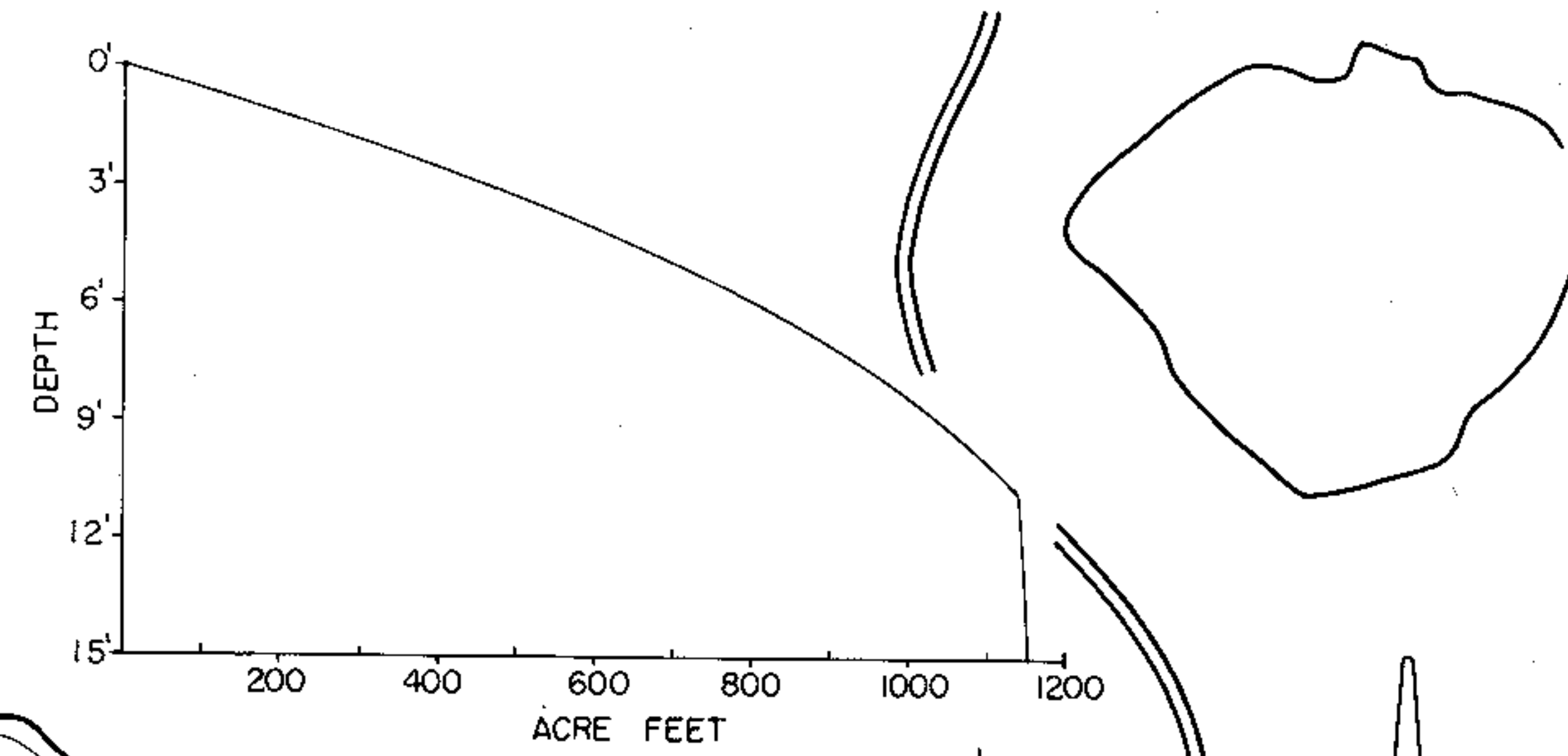

EQUIPMENT RECORDING SONAR MAPPED JULY 1969  
MONTH YEAR

- | TOPOGRAPHIC SYMBOLS   |                            | LAKE BOTTOM SYMBOLS |                             |
|-----------------------|----------------------------|---------------------|-----------------------------|
| (B) Brush             | Steep slope                | P. Peat             | B Boulders                  |
| (PW) Partially wooded | - - - Indefinite shoreline | Mk. Muck            | o Stumps & Snags            |
| (W) Wooded            | Marsh                      | C. Clay             | ⊛ Rock danger to navigation |
| (C) Cleared           | o Spring                   | M. Marl             | T Submergent vegetation     |
| (P) Pastured          | - - - Intermittent stream  | Sd. Sand            | ⊥ Emergent vegetation       |
| (A) Agricultural      | ==== Permanent inlet       | St. Silt            | ⊏ Floating vegetation       |
| B.M. Bench Mark       | ==== Permanent outlet      | Gr. Gravel          | ⊕ Brush shelters            |
| ■ Dwelling            | ⊥ Dam                      | R. Rubble           |                             |
| □ Resort              | D.N.R. State owned land    | Bc. Bedrock         |                             |
| □ Camp                |                            |                     |                             |

### THREE LAKES



Access Access with Parking Boat Livery  
 Drawn by: C. Holt  
 Field work by: J. Smith

SPECIES OF FISH	Abundance		
	Abundant	Common	Present
Muskie			X
N. Pike		X	X
Walleye		X	X
L.M. Bass	X		
S.M. Bass	X		
Panfish	X		
Trout			

WATER AREA 143.5 ACRES  
 UNDER 3 FT. 5.1 %  
 OVER 20 FT. 0 %  
 MAX. DEPTH 15 FEET.  
 TOTAL ALK. 36 P.P.M.  
 VOLUME 1149.1 ACRE FT.  
 SHORELINE 2.28 MILES

Source: Wisconsin Department of Natural Resources 608-266-2621  
Maple Lake – Oneida County, Wisconsin - DNR Lake Map  
Date – Jul 1969 - Historical Lake Map - Not for Navigation  
A Public Document - Please Identify the Source when using it.