

LAKE SURVEY MAP

BIG FORK LAKE ONEIDA COUNTY
SEC. 27 T. 39 N. R. 11 E.

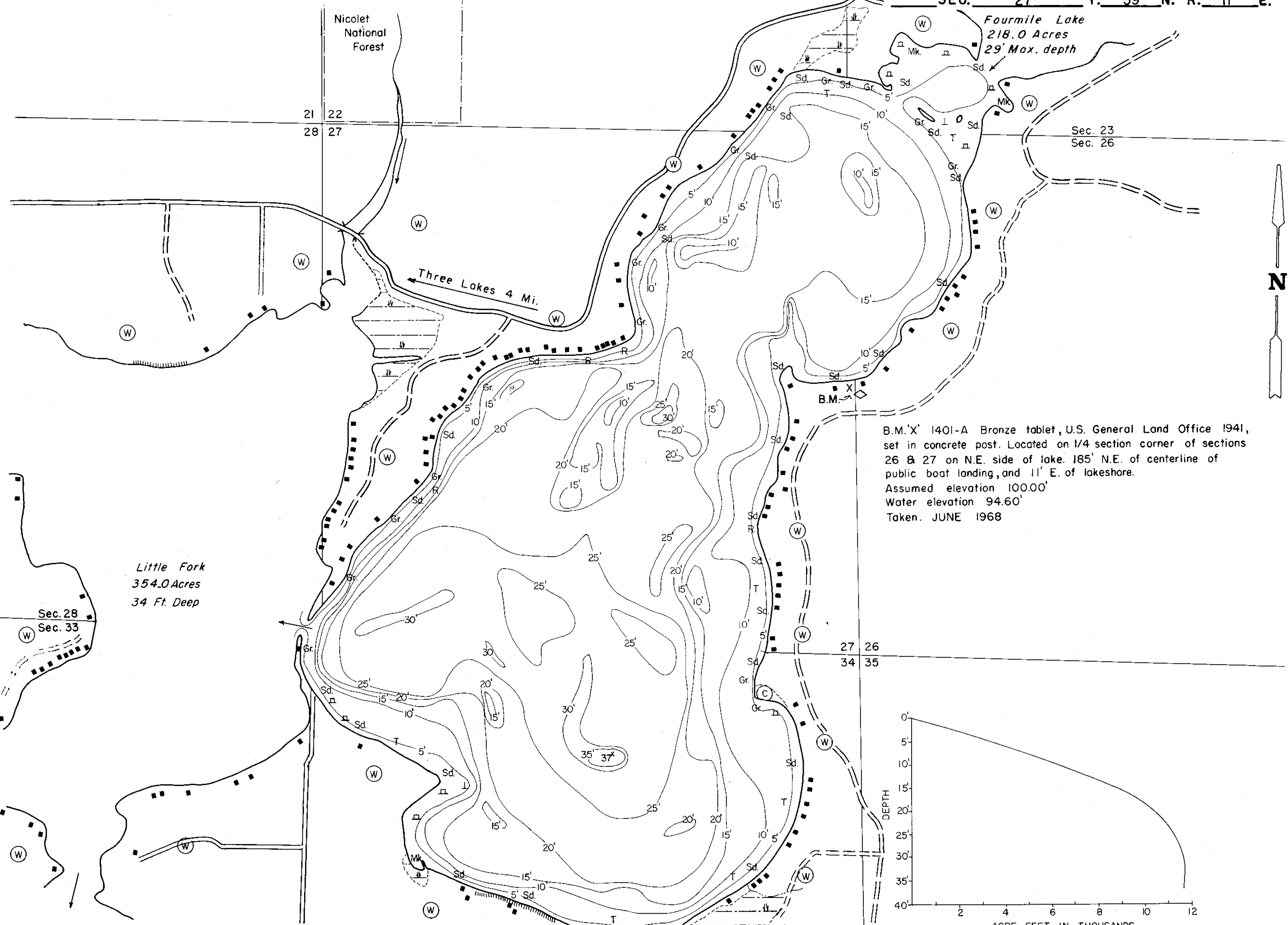

B.M. 'X' 1401-A Bronze tablet, U.S. General Land Office 1941, set in concrete post. Located on 1/4 section corner of sections 26 & 27 on N.E. side of lake. 185' N.E. of centerline of public boat landing, and 11' E. of lakeshore. Assumed elevation 100.00' Water elevation 94.60' Taken. JUNE 1968

Little Fork
354.0 Acres
34 Ft. Deep

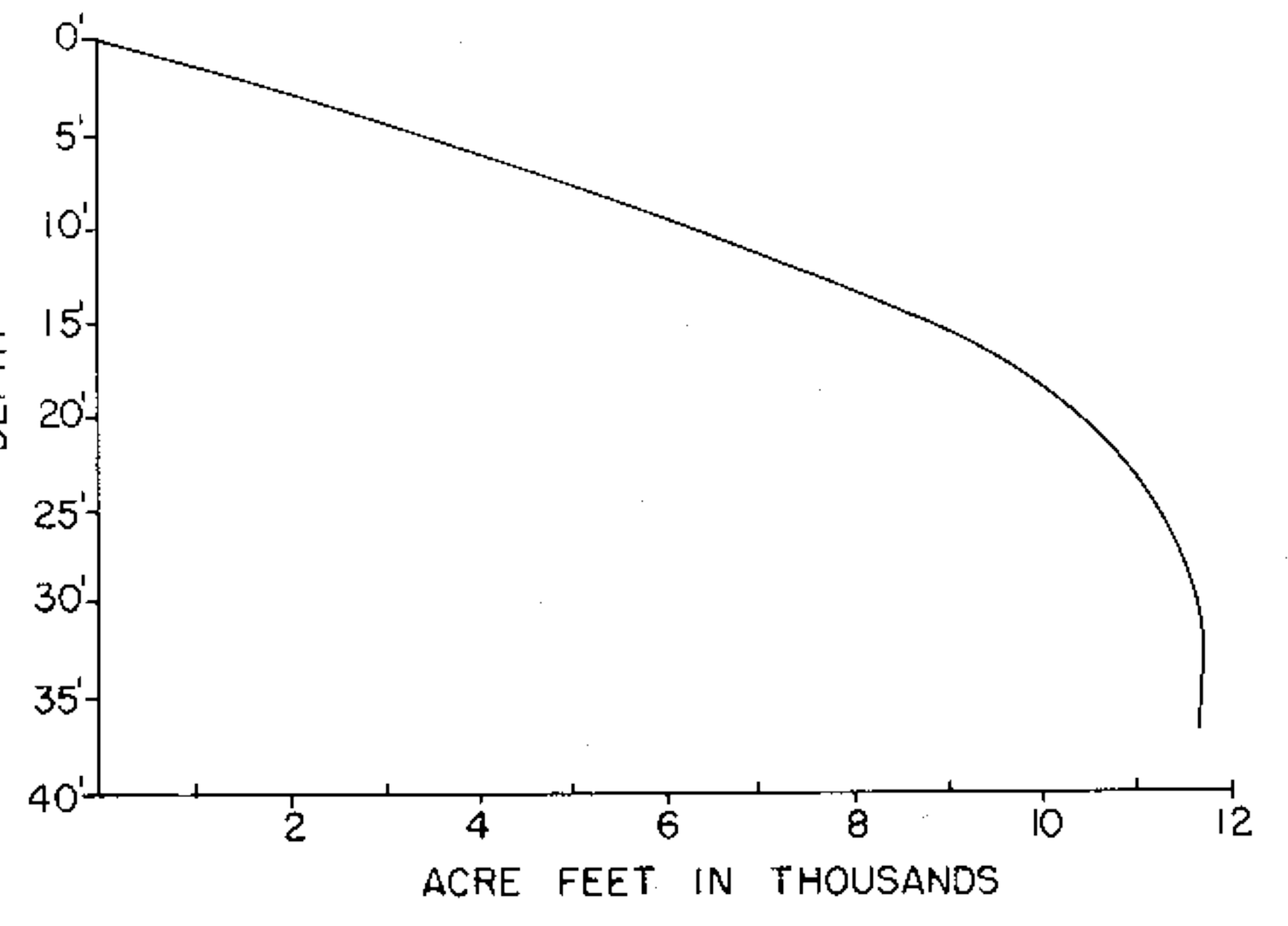

EQUIPMENT RECORDING SONAR MAPPED JULY 1968
MONTH YEAR

- TOPOGRAPHIC SYMBOLS**
- (B) Brush
 - (FW) Partially wooded
 - (W) Wooded
 - (C) Cleared
 - (P) Pastured
 - (A) Agricultural
 - B.M. Bench Mark
 - Dwelling
 - Resort
 - ⊠ Camp
 - ||||| Steep slope
 - Indefinite shoreline
 - Marsh
 - Spring
 - Intermittent stream
 - Permanent inlet
 - Permanent outlet
 - Dam
 - D.N.R. State owned land

- LAKE BOTTOM SYMBOLS**
- P. Peat
 - Mk. Muck
 - C. Clay
 - M. Marl
 - Sd. Sand
 - St. Silt
 - Gr. Gravel
 - R. Rubble
 - Bc. Bedrock
 - B Boulders
 - ° Stumps & Snags
 - Rock danger to navigation
 - T Submergent vegetation
 - Emergent vegetation
 - Floating vegetation
 - Brush shelters

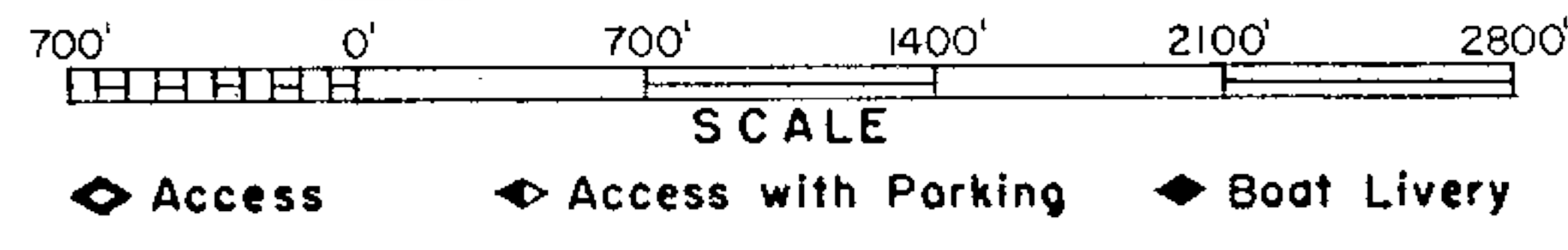

◆ Access ◆ Access with Parking ◆ Boat Livery
Drawn by: C. Holt
Field work by: P. Michelson, J. Smith

SPECIES OF FISH	Abundance		
	Abundant	Common	Present
Muskie		X	X
N. Pike		X	X
Walleye		X	X
L.M. Bass		X	X
S.M. Bass		X	X
Panfish	X		
Trout			

WATER AREA 690.0 ACRES
UNDER 3 FT. 5.6 %
OVER 20 FT. 42.5 %
MAX. DEPTH 37 FEET.
TOTAL ALK. 22 P.P.M.
VOLUME 11,689.8 ACRE FT.
SHORELINE 5.4 MILES

Source: Wisconsin Department of Natural Resources 608-266-2621
Big Fork Lake – Oneida County, Wisconsin - DNR Lake Map
Date – Jul 1968 - Historical Lake Map - Not for Navigation
A Public Document - Please Identify the Source when using it.