

LAKE SURVEY MAP

WISCONSIN CONSERVATION DEPARTMENT
BIOLOGY DIVISION
LAKE AND STREAM IMPROVEMENT SECTION

LAKE KILDARE
SECTION 17-18-19
TOWNSHIP 42 N
RANGE 11 E
TOWN OF PHELPS
COUNTY VILAS

FORM FI-117

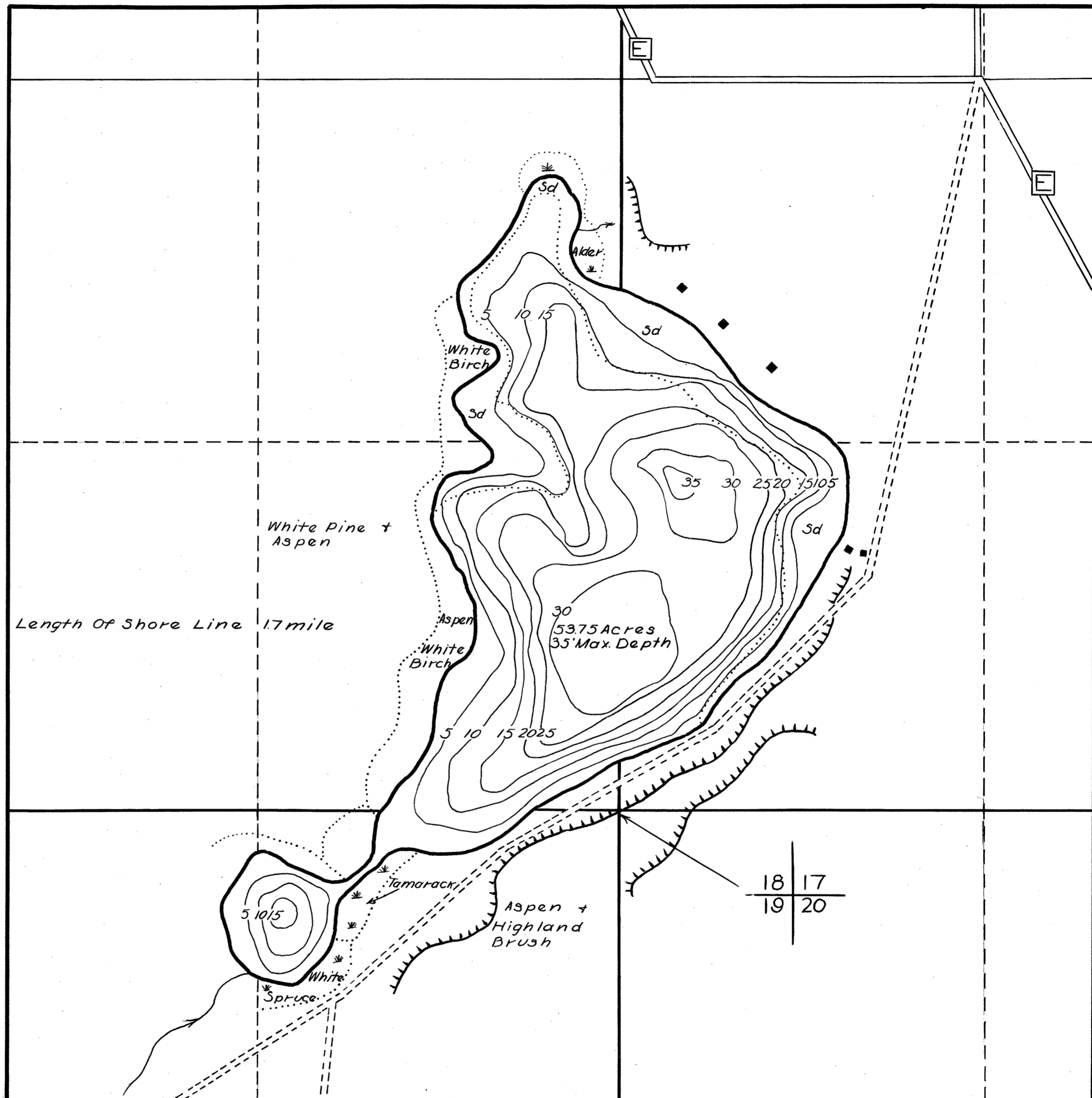

DATE April 6, 1939
COMPILED BY _____
TRACED BY W.P.S
SOURCE OF INFORMATION
U.S. Lake Improvement
U.S. Forest Service Map
SOUNDINGS Intervals = 5'
U.S. Forest Service
DATES OF MAP REVISION _____
WORK AGENCY _____

SCALE 1 inch = 330 feet

LAKE IMPROVEMENT RECORD

TYPE	DATE	_____	_____	_____	_____
BRUSH REFUGES	_____	_____	_____	_____	_____
SAPLING TANGLES	_____	_____	_____	_____	_____
SPAWNING BOXES	_____	_____	_____	_____	_____
MINNOW SPAWNERS	_____	_____	_____	_____	_____
TOTAL	_____	_____	_____	_____	_____

LEGEND

	WEED BEDS
	ROCKY SHOALS
<u>Sd</u>	SAND
<u>Cl</u>	CLAY
<u>Gt</u>	GRAVEL
<u>Mk</u>	MUCK
■	DWELLING
□	ABANDONED DWELLING
■	RESORT
	Steep Slope

Source: Wisconsin Department of Natural Resources 608-266-2621
Kildare Lake (Pine Lake) – Vilas County, Wisconsin DNR Lake Map
Date – Apr 1939 - Historical Lake Map - Not for Navigation .
A Public Document - Please Identify the Source when using it.