

BM "X" - Top of concrete walk
 on dam at south end.
 Assumed elev. 100'
 Water elev. 91.3'

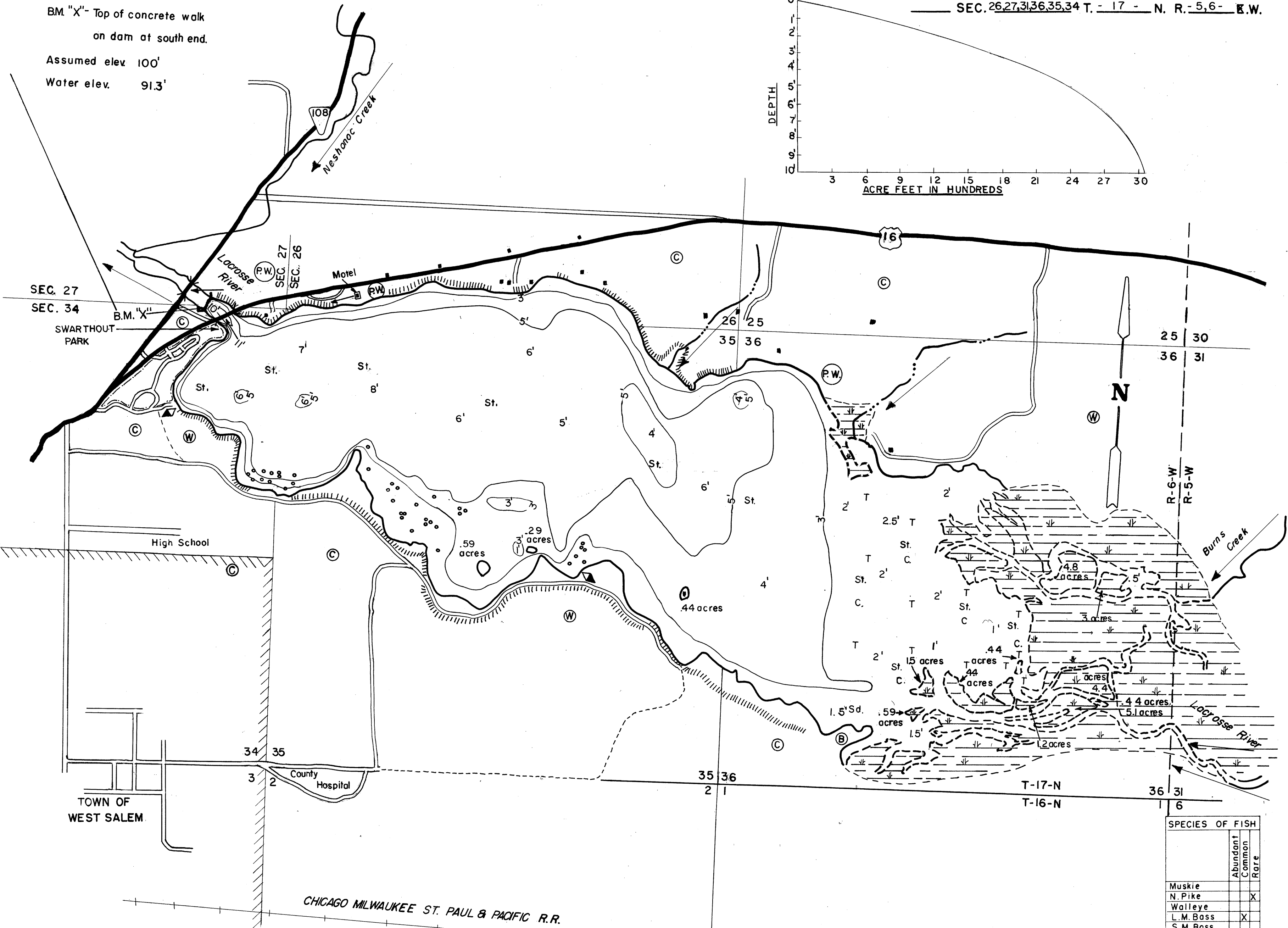
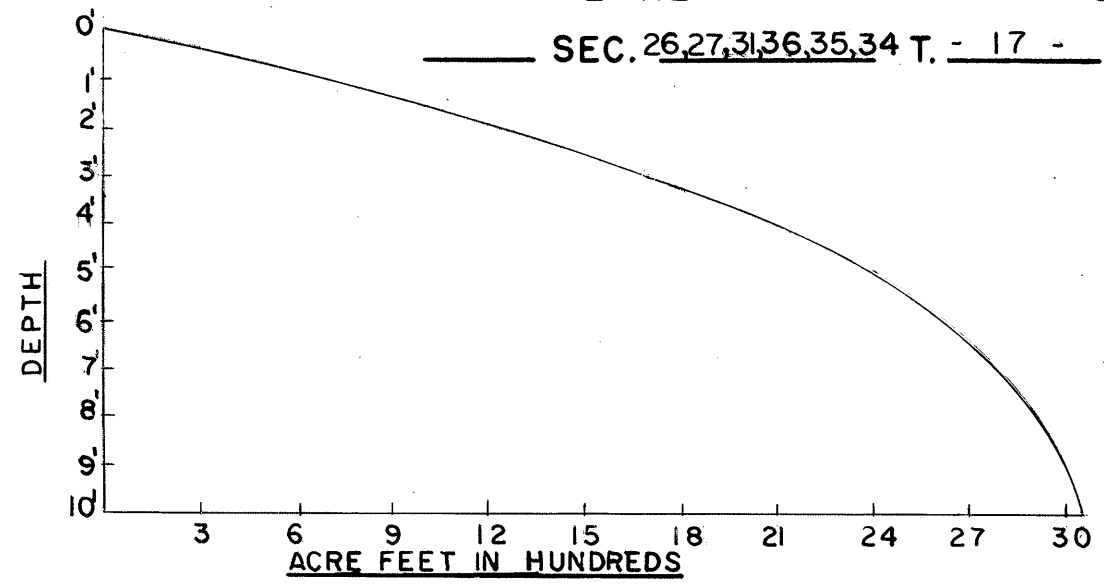

RECORDING ECHO SOUNDER
 EQUIPMENT AND POLE SOUNDINGS MAPPED JUNE 1966
 MO. YR.

WATER ELEV. 91.3 FT.

- TOPOGRAPHIC SYMBOLS
- (B) Brush
 - (PW) Partially wooded
 - (W) Wooded
 - (C) Cleared
 - (P) Pastured
 - (A) Agricultural
 - B.M. Bench Mark
 - Dwelling
 - Resort
 - ||||| Steep slope
 - - - Indefinite shoreline
 - Marsh
 - Spring
 - Intermittent stream
 - Permanent inlet
 - Permanent outlet
 - Dam

- LAKE BOTTOM SYMBOLS
- P. Peat
 - Mk. Muck
 - C. Clay
 - M. Marl
 - Sd. Sand
 - St. Silt
 - Gr. Gravel
 - R. Rubble
 - Br. Bedrock
 - T Submergent vegetation
 - ↓ Emergent vegetation
 - ▬ Floating vegetation
 - Stumps & Snags

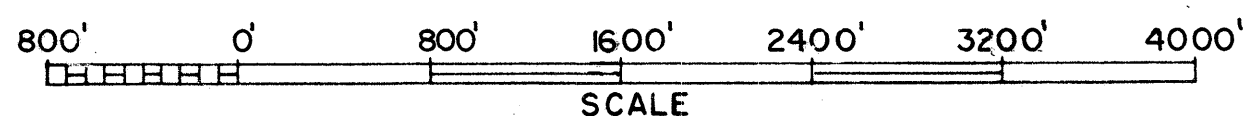

◇ Access ◀ Access with Parking ◆ Boat Livery
 Field work by: R. CHAP Drawn by: D. LAIHO

SPECIES OF FISH		
	Abundant	Rare
Muskie		
N. Pike		X
Walleye		
L. M. Bass	X	
S. M. Bass		
Panfish	X	
Trout		

AREA WITHOUT IS. 6872 ACRES
 TOTAL AREA 7374 ACRES
 UNDER 3 FT. 36.3 %
 OVER 20 FT. 0 %
 VOLUME 3,104.5 ACRE FT.
 TOTAL ALK. 92 P.P.M.
 SHORELINE 12.3 MILES
 MAX. DEPTH 11 FEET

Source: Wisconsin Department of Natural Resources 608-266-2621
Neshonoc Lake - LaCrosse County, Wisconsin DNR Lake Map
June, 1966 Historical Lake Map Not for Navigation
A Public Document - Please Identify the Source when using it.