

LAKE SURVEY MAP

MARINUKA LAKE TREMPLEAU COUNTY
SEC. 28, 29, 32, 33 T. 19 N. R. 8 W.

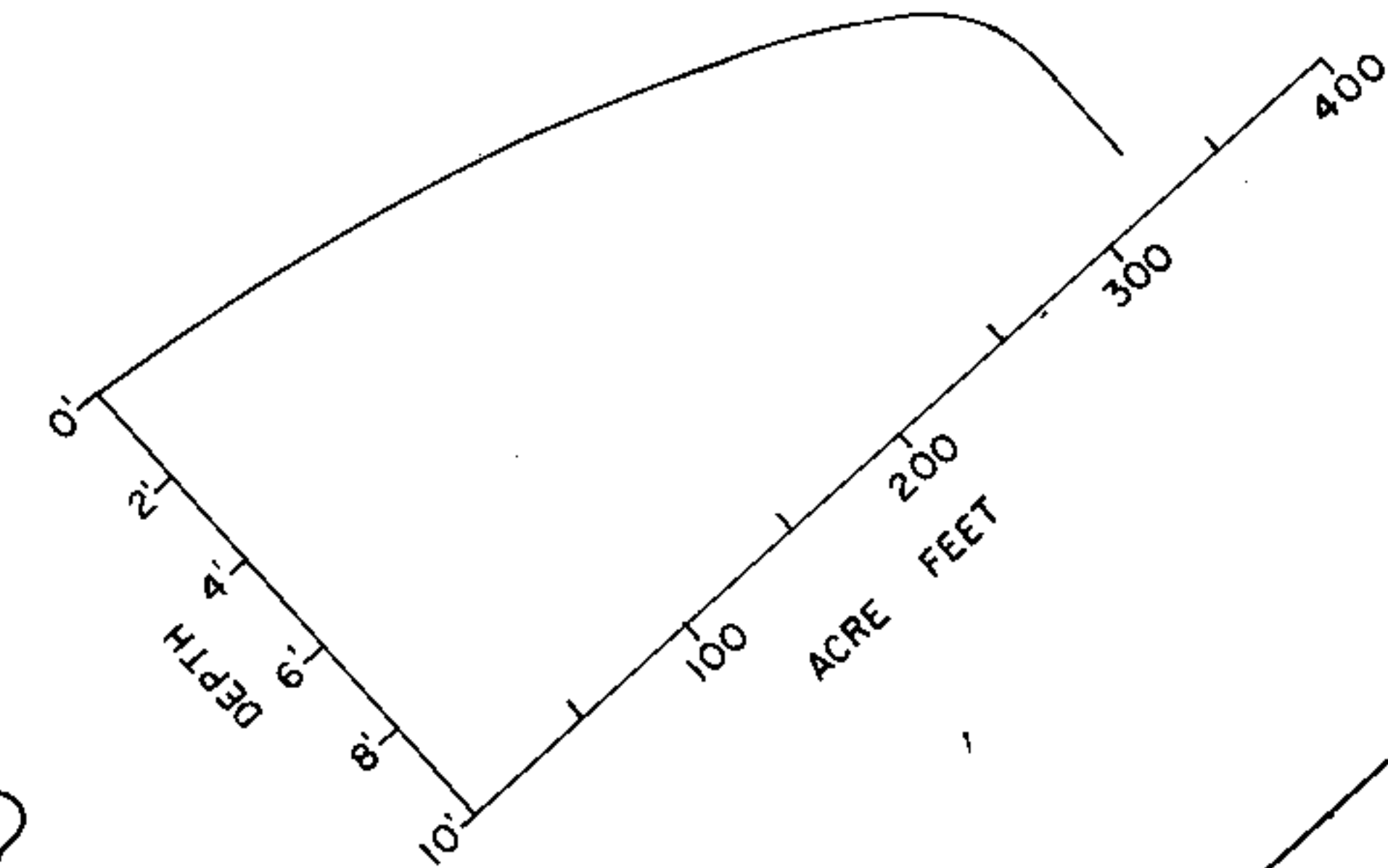
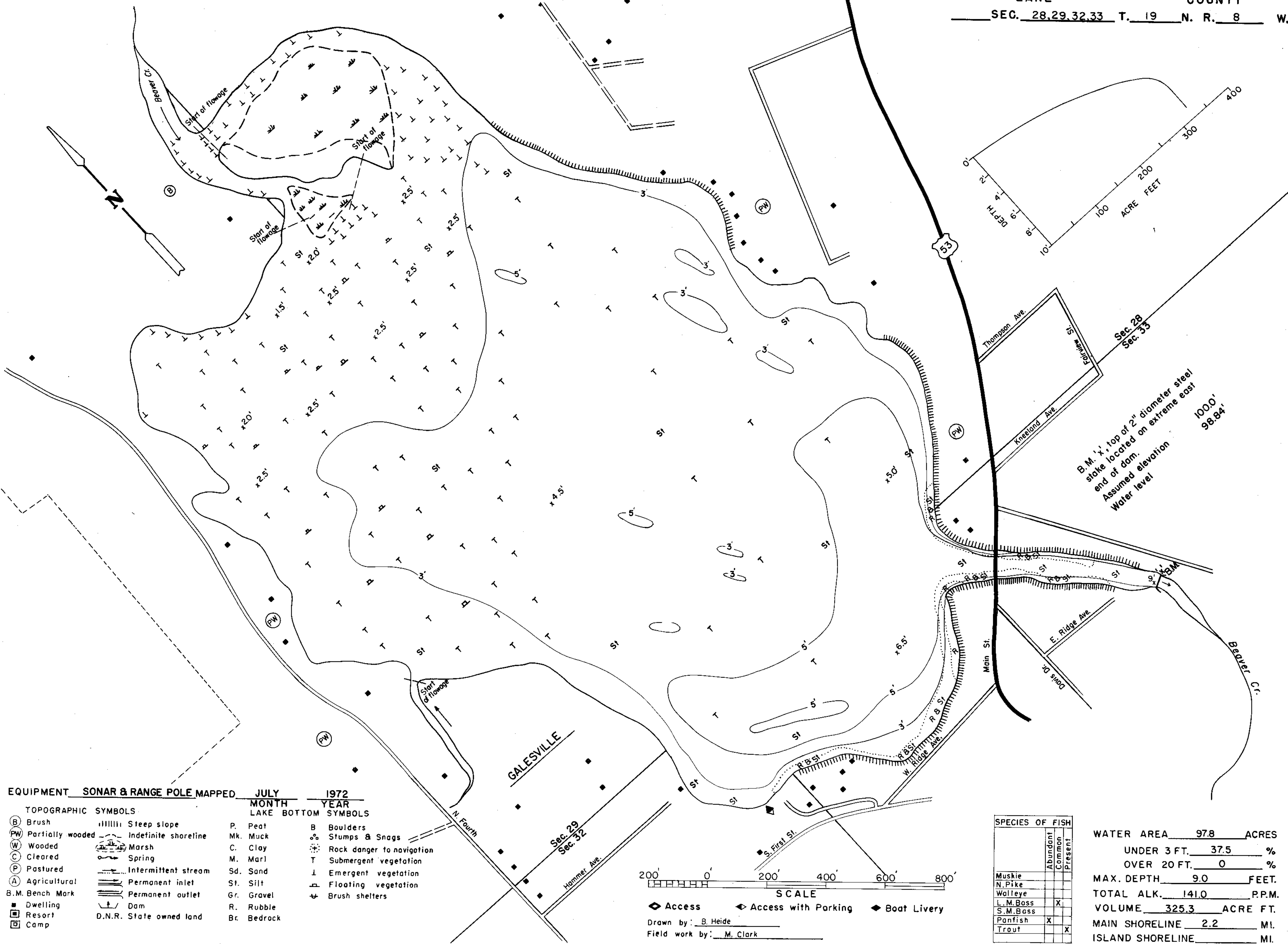

B.M. 'x', top of 2" diameter steel stake located on extreme east end of dam.
Assumed elevation 1000'
Water level 98.84'

EQUIPMENT SONAR & RANGE POLE MAPPED JULY 1972
MONTH YEAR

- TOPOGRAPHIC SYMBOLS
- (B) Brush
 - (PW) Partially wooded
 - (W) Wooded
 - (C) Cleared
 - (P) Pastured
 - (A) Agricultural
 - B.M. Bench Mark
 - Dwelling
 - Resort
 - ▣ Camp
 - ||||| Steep slope
 - - - Indefinite shoreline
 - ⊞ Marsh
 - Spring
 - Intermittent stream
 - Permanent inlet
 - Permanent outlet
 - Dam
 - D.N.R. State owned land
- LAKE BOTTOM SYMBOLS
- P. Peat
 - Mk. Muck
 - C. Clay
 - M. Marl
 - Sd. Sand
 - St. Silt
 - Gr. Gravel
 - R. Rubble
 - Bc. Bedrock
 - B Boulders
 - ° Stumps & Snags
 - ⊙ Rock danger to navigation
 - T Submergent vegetation
 - ⊥ Emergent vegetation
 - ⊞ Floating vegetation
 - ⊞ Brush shelters

SPECIES OF FISH	Abundance		
	Abundant	Common	Present
Muskie			
N. Pike			
Walleye			
L.M. Bass		X	
S.M. Bass			
Panfish	X		
Trout			X

WATER AREA 97.8 ACRES
 UNDER 3 FT. 37.5 %
 OVER 20 FT. 0 %
 MAX. DEPTH 9.0 FEET.
 TOTAL ALK. 141.0 P.P.M.
 VOLUME 325.3 ACRE FT.
 MAIN SHORELINE 2.2 MI.
 ISLAND SHORELINE MI.

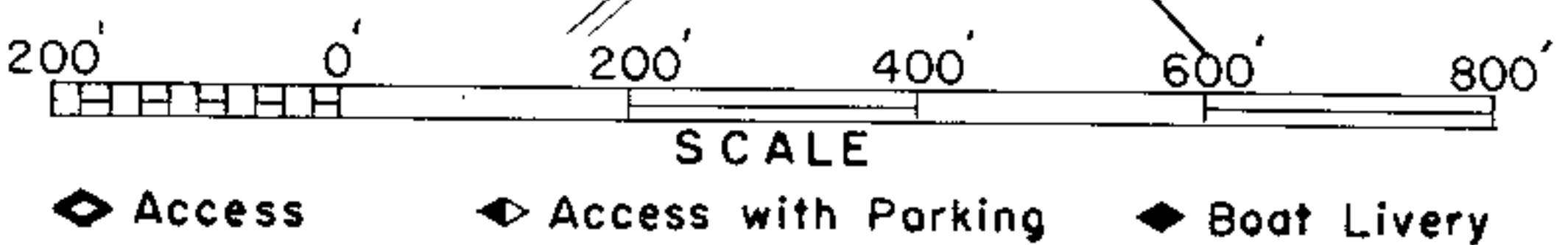

Drawn by: B. Heide
Field work by: M. Clark

Source: Wisconsin Department of Natural Resources 608-266-2621
Marinuka Lake – St. Croix County, Wisconsin DNR Lake Map
Date – Jul 1972 - Historical Lake Map - Not for Navigation
A Public Document - Please Identify the Source when using it.