

LAKE SURVEY MAP

LAKE BIG BEAVER
 SECTION 28
 TOWNSHIP 32 N
 RANGE 8 W
 TOWN OF SAMPSON
 COUNTY CHIPPEWA

FORM FI-117

WISCONSIN CONSERVATION DEPARTMENT
 BIOLOGY DIVISION
 LAKE AND STREAM IMPROVEMENT SECTION

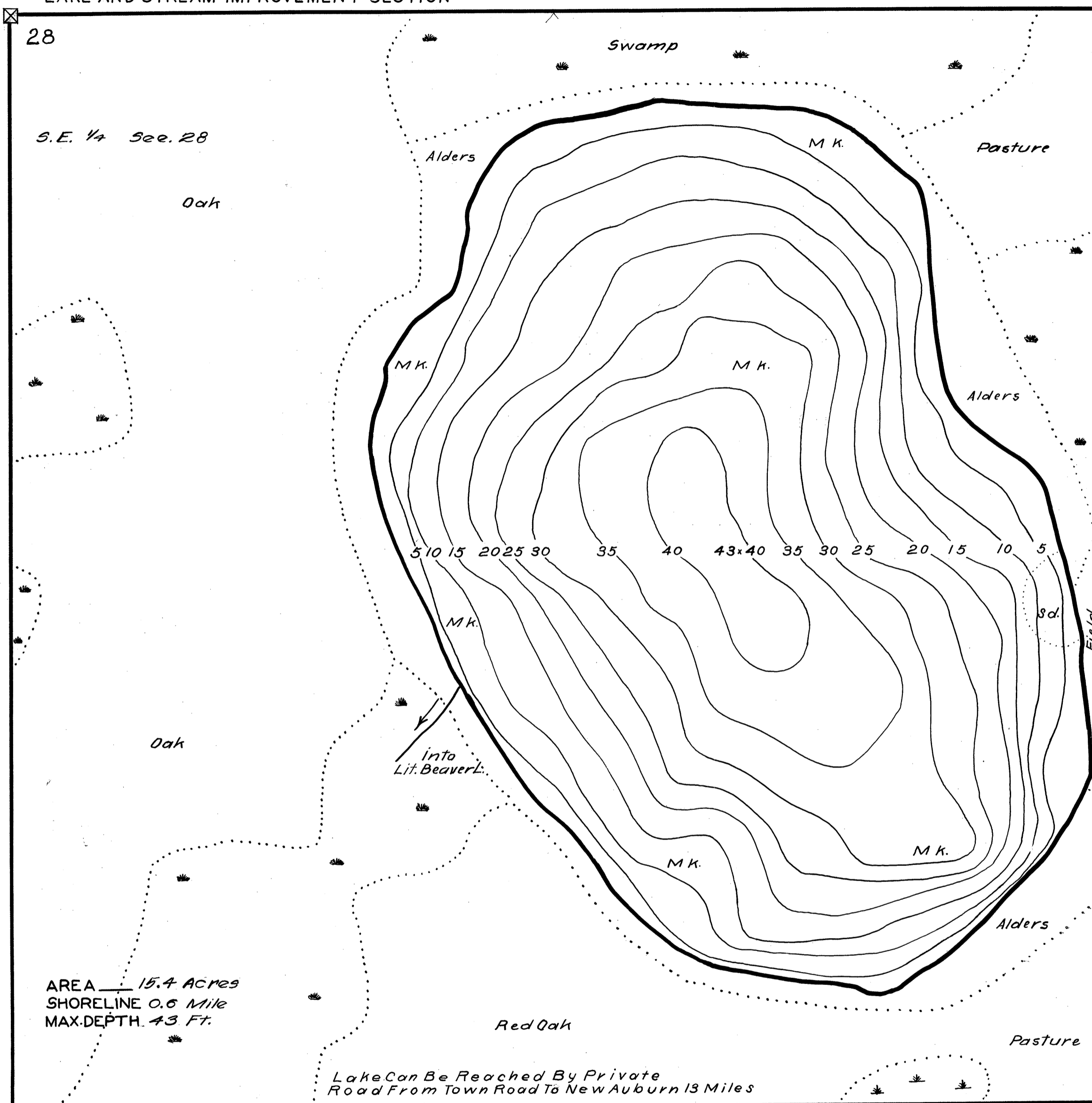

DATE February 13-1939
 COMPILED BY H.K. Jr.
 TRACED BY H.B.D.
 SOURCE OF INFORMATION
W.P.A. Lake Survey Project

 SOUNDINGS At 6 Rod Intervals

 DATES OF MAP REVISION _____
March 1940
 WORK AGENCY W.P.A.

LAKE IMPROVEMENT RECORD

TYPE	DATE	_____	_____	_____
⊙ BRUSH REFUGES	_____	_____	_____	_____
⊞ SAPLING TANGLES	_____	_____	_____	_____
□ SPAWNING BOXES	_____	_____	_____	_____
* MINNOW SPAWNERS	_____	_____	_____	_____
TOTAL	_____	_____	_____	_____

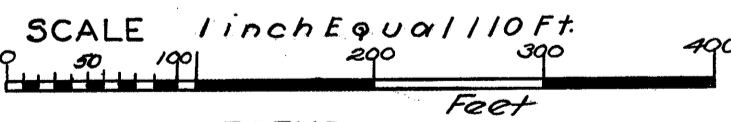

- LEGEND**
- ⊙ WEED BEDS
 - ⊞ ROCKY SHOALS
 - Sd SAND
 - Cl CLAY
 - Gr GRAVEL
 - Mk MUCK
 - DWELLING
 - ABANDONED DWELLING
 - ▣ RESORT

Source: Wisconsin Department of Natural Resources 608-266-2621
Big Beaver Lake - Chippewa County, Wisconsin DNR Lake Map
Date – Feb. 1939 - Historical Lake Map - Not for Navigation
A Public Document - Please Identify the Source when using it.