

LAKE SURVEY MAP

CAMMERER LAKE
ASHLAND COUNTY
SEC. 25.36 T. 43 N. R. 1 W.

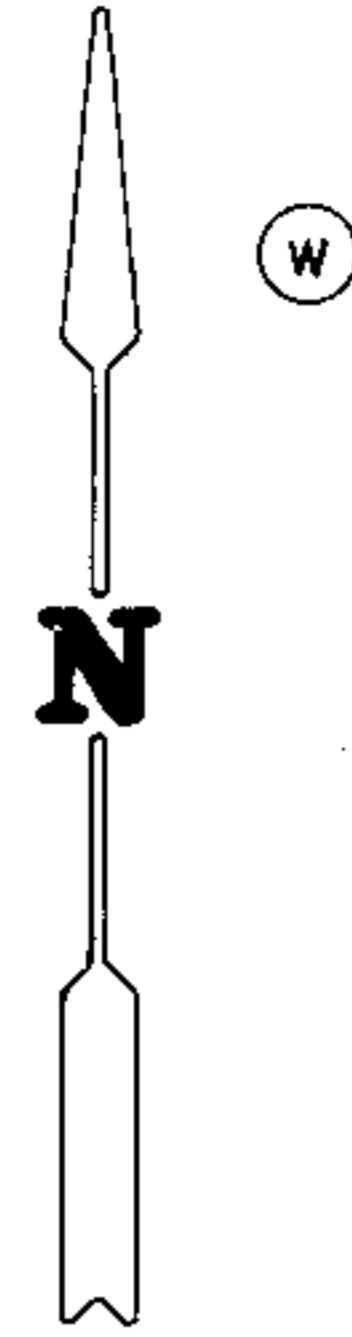

26 25
35 36

B.M. "X" is a Railroad spike in base of a 14" Hemlock tree, located 15 feet South of C of the West access 21 feet Southeast of lake and on the South side of lake. Assumed elevation = 100.00' Water level = 97.38'

Mixed Hardwood

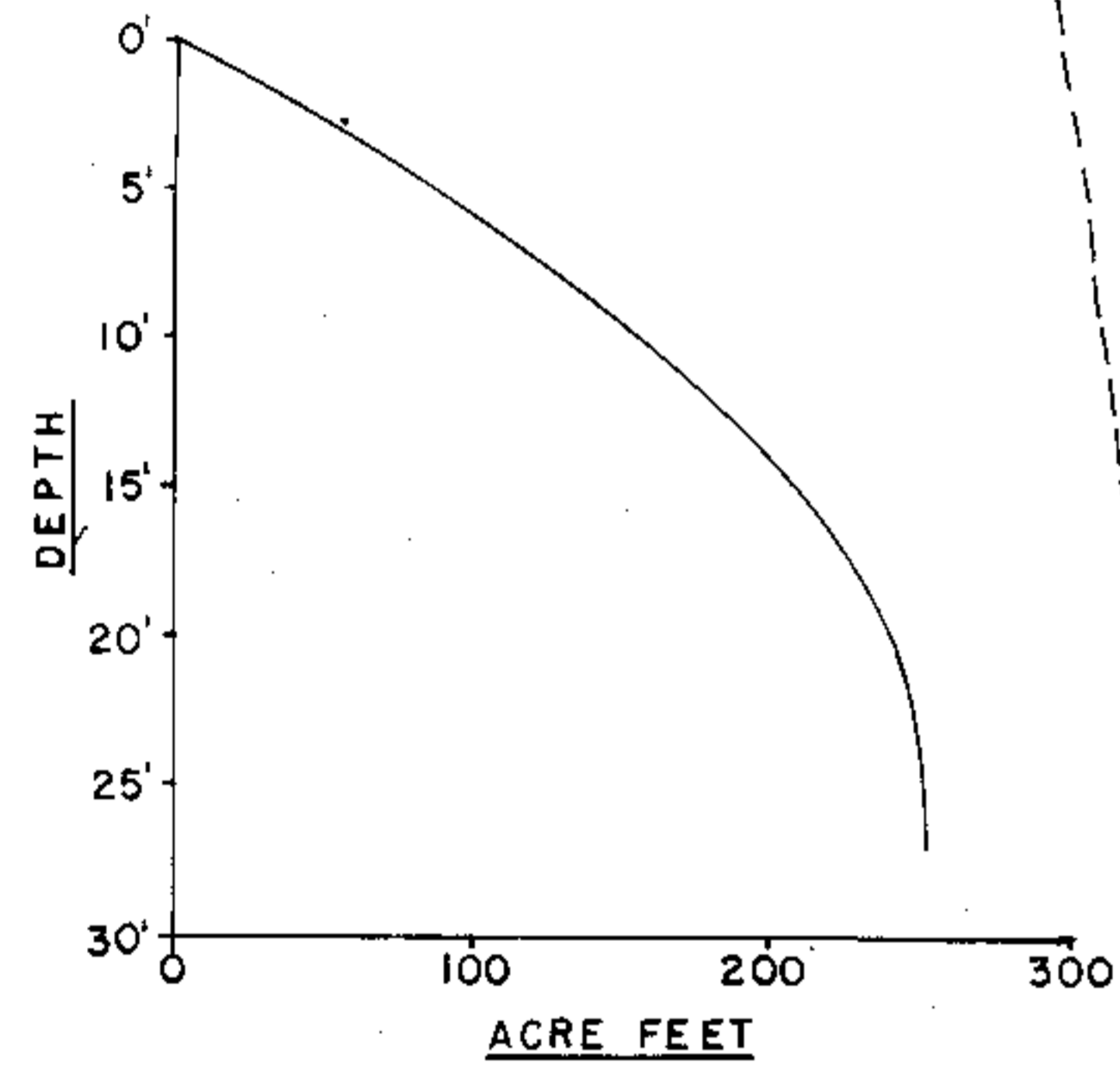

ASHLAND COUNTY FOREST

Mixed Hardwood & Pine

W

EQUIPMENT RECORDING SONAR MAPPED

MAY 1974

- TOPOGRAPHIC SYMBOLS
- (B) Brush
 - (PW) Partially wooded
 - (W) Wooded
 - (C) Cleared
 - (P) Pastured
 - (A) Agricultural
 - Dwelling
 - Resort
 - Camp

- LAKE BOTTOM SYMBOLS
- P. Peat
 - Mk. Muck
 - C. Clay
 - M. Marl
 - Sd. Sand
 - St. Silt
 - Gr. Gravel
 - R. Rubble
 - Br. Bedrock
 - Steep slope
 - Indefinite shoreline
 - Marsh
 - Spring
 - Intermittent stream
 - Permanent inlet
 - Permanent outlet
 - D.N.R. State owned land
 - B. Boulders
 - Stumps & Snags
 - Rock danger to navigation
 - Submergent vegetation
 - Emergent vegetation
 - Floating vegetation
 - Brush shelters

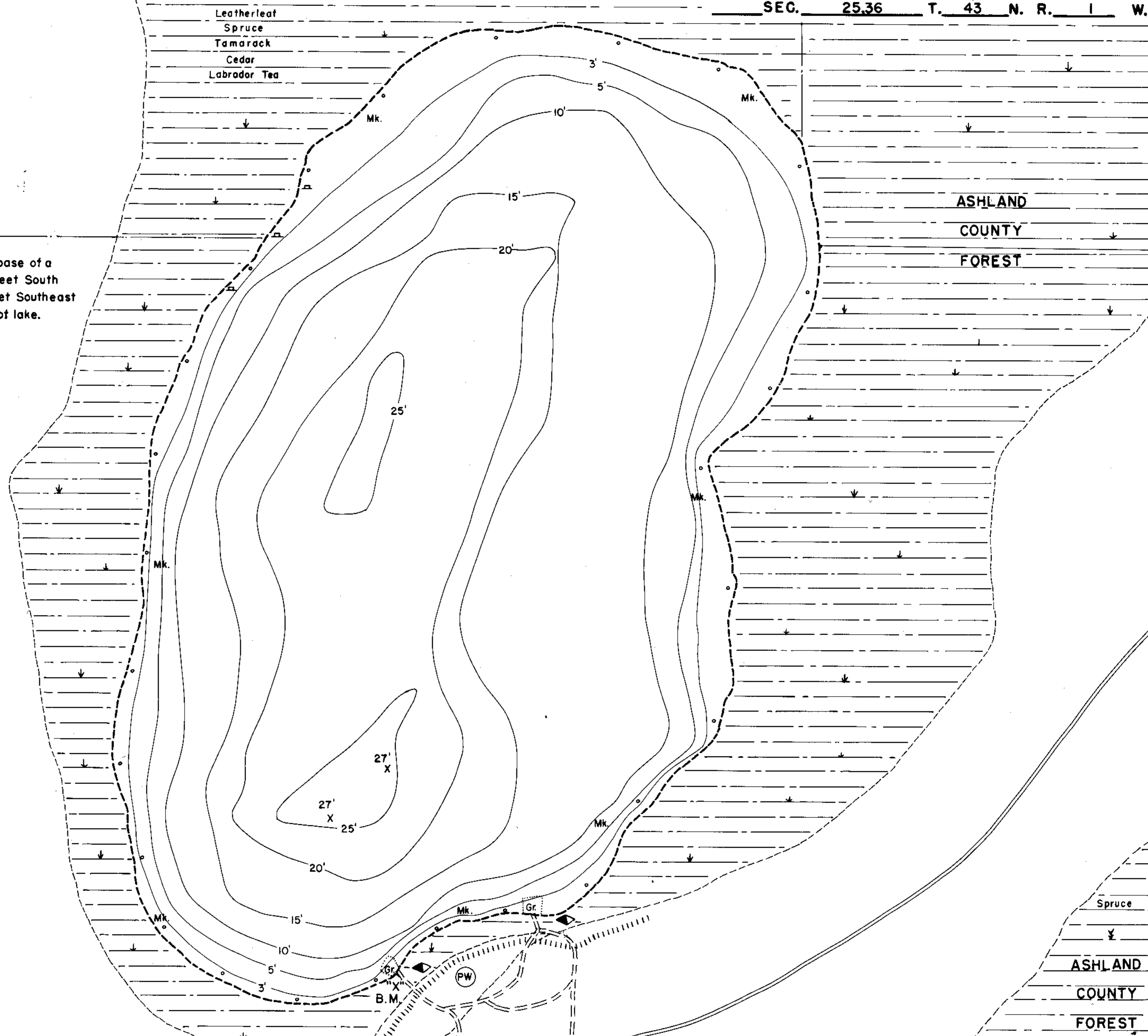

- Access
- Access with Parking
- Boat Livery



Drawn by: G. Thuesen
Field work by: C. Busch, K. Cable, L. Sather

SPECIES OF FISH	Abundance	
	Common	Present
Muskie		
N. Pike		
Walleye		
L.M. Bass		
S.M. Bass		
Panfish	X	
Trout	X	

WATER AREA 19.3 ACRES
 UNDER 3 FT. 10 %
 OVER 20 FT. 23 %
 MAX. DEPTH 27 FEET
 TOTAL ALK. 17 P.P.M.
 VOLUME 251 ACRE FT.
 MAIN SHORELINE .68 MI.
 ISLAND SHORELINE 0 MI.

Glidden 10 Miles

Source: Wisconsin Department of Natural Resources 608-266-2621
Cammerer Lake – Ashland County, Wisconsin DNR Lake Map
Date – May 1974 - Historical Lake Map - Not for Navigation
A Public Document - Please Identify the Source when using it.