

LAKE SURVEY MAP

CRYSTAL LAKE
VILAS COUNTY
SEC. 27, 28 T. 41 N. R. 7 E.

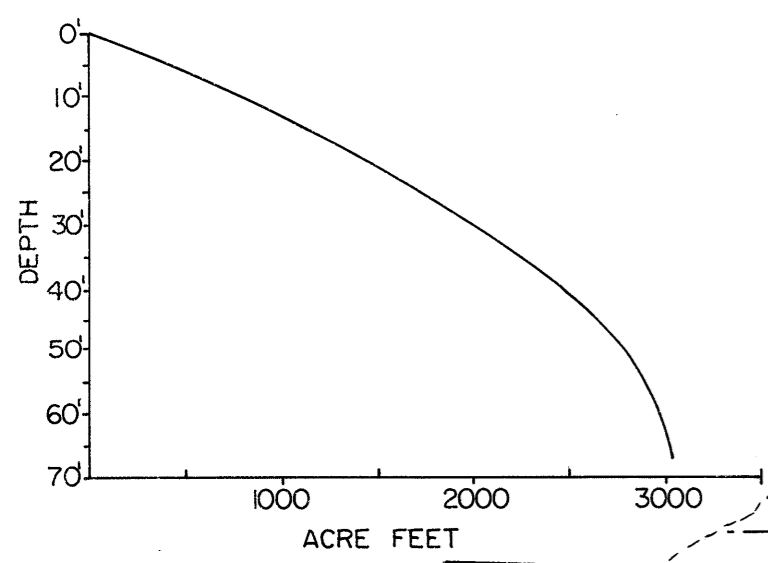
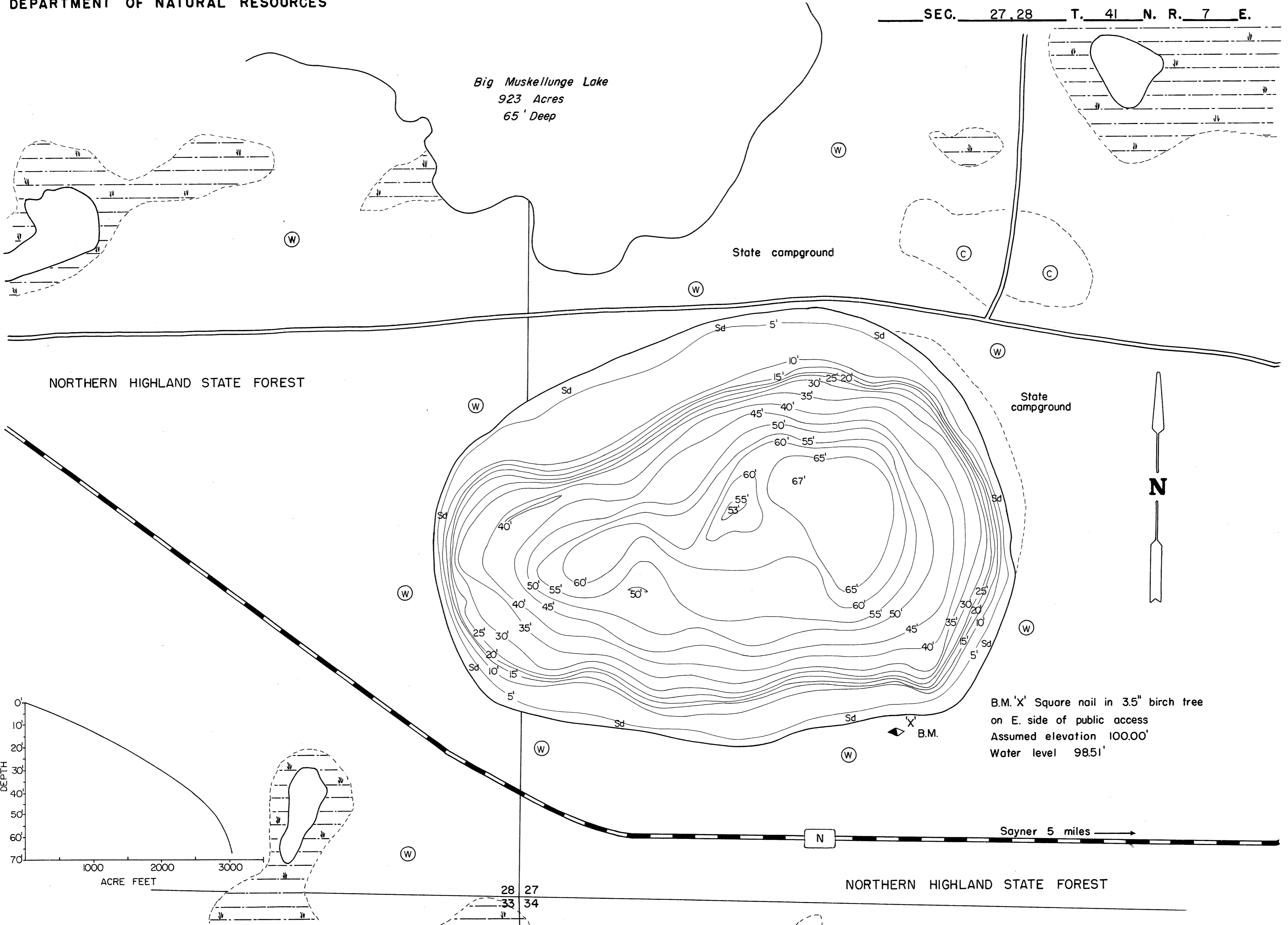

B.M. 'X' Square nail in 3.5" birch tree
on E. side of public access
Assumed elevation 100.00'
Water level 98.51'

EQUIPMENT RECORDING SONAR MAPPED OCT 1971

TOPOGRAPHIC SYMBOLS		LAKE BOTTOM SYMBOLS	
(B) Brush	Steep slope	P. Peat	B Boulders
(PW) Partially wooded	- - - Indefinite shoreline	Mk. Muck	o Stumps & Snags
(W) Wooded	Marsh	C. Clay	Rock danger to navigation
(C) Cleared	Spring	M. Marl	T Submergent vegetation
(P) Pastured	Intermittent stream	Sd. Sand	I Emergent vegetation
(A) Agricultural	Permanent inlet	St. Silt	F Floating vegetation
B.M. Bench Mark	Permanent outlet	Gr. Gravel	Brush shelters
■ Dwelling	Dam	R. Rubble	
□ Resort	D.N.R. State owned land	Br. Bedrock	
□ Camp			



◆ Access ◆ Access with Parking ◆ Boat Livery

Drawn by: C. Holt
Field work by: J. Smith

SPECIES OF FISH	Abundance		
	Abundant	Common	Present
Muskie			
N. Pike			X
Walleye			X
L.M. Bass			X
S.M. Bass		X	
Panfish	X		
Trout			X
Splake			X

WATER AREA 88.3 ACRES
UNDER 3 FT. 5 %
OVER 20 FT. 67 %
MAX. DEPTH 67 FEET.
TOTAL ALK. 2 P.P.M.
VOLUME 3,029 ACRE FT.
SHORELINE 1.36 MILES

Source: Wisconsin Department of Natural Resources 608-266-2621
Crystal Lake – Vilas County, Wisconsin DNR Lake Map
Date – Oct 1971 - Historical Lake Map - Not for Navigation .
A Public Document - Please Identify the Source when using it.