

WISCONSIN CONSERVATION DEPARTMENT
 BIOLOGY DIVISION
 LAKE AND STREAM IMPROVEMENT SECTION

LAKE SURVEY MAP

LAKE DIAMOND
 SECTION 10-11
 TOWNSHIP 41 N
 RANGE 6 E
 TOWN OF BOULDER JUNCTION
 COUNTY VILAS

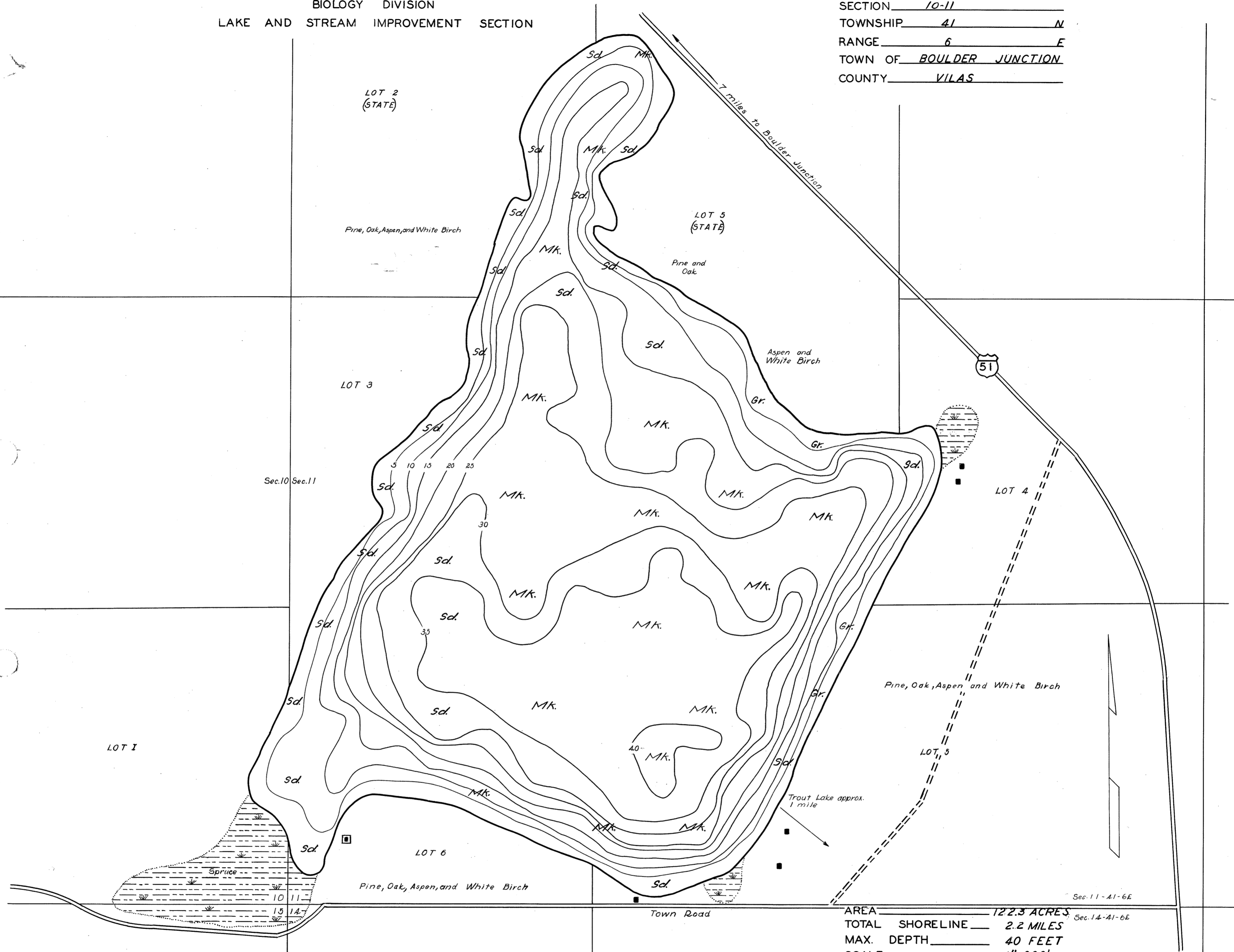

AREA 122.3 ACRES
 TOTAL SHORELINE 2.2 MILES
 MAX. DEPTH 40 FEET
 SCALE 1" = 300'

DATE MAY 1941
 COMPILED BY L.W.
 TRACED BY B.W. C.C.C.
 SOURCE OF INFORMATION CAMP CRYSTAL LAKE-LAKE SURVEY PROJECT AERIAL PHOTOGRAPH, FL.II, B-9-38
 SOUNDINGS 200' INTERVALS
 DATES OF MAP REVISION _____
 WORK AGENCY C.C.C.

LAKE IMPROVEMENT RECORD

TYPE	DATE			
⊕ BRUSH REFUGES				
w SAPLING TANGLES				
□ SPAWNING BOXES				
* MINNOW SPAWNERS				
TOTAL				

LEGEND

- ⊕ WEED BEDS
- ⊙ ROCKY SHOALS
- Sd SAND
- Cl CLAY
- Gr GRAVEL
- Mk MUCK
- DWELLING
- ABANDONED DWELLING
- ⊠ RESORT

Source: Wisconsin Department of Natural Resources 608-266-2621
Diamond Lake – Vilas County, Wisconsin DNR Lake Map
Date – May 1941 - Historical Lake Map - Not for Navigation .
A Public Document - Please Identify the Source when using it.