

LAKE SURVEY MAP

WISCONSIN CONSERVATION DEPARTMENT
BIOLOGY DIVISION
LAKE AND STREAM IMPROVEMENT SECTION

LAKE JEANSTOW
SECTION 25-36
TOWNSHIP 32 N
RANGE 9 W
TOWN OF SAMPSON
COUNTY CHIPPEWA

FORM FH-17

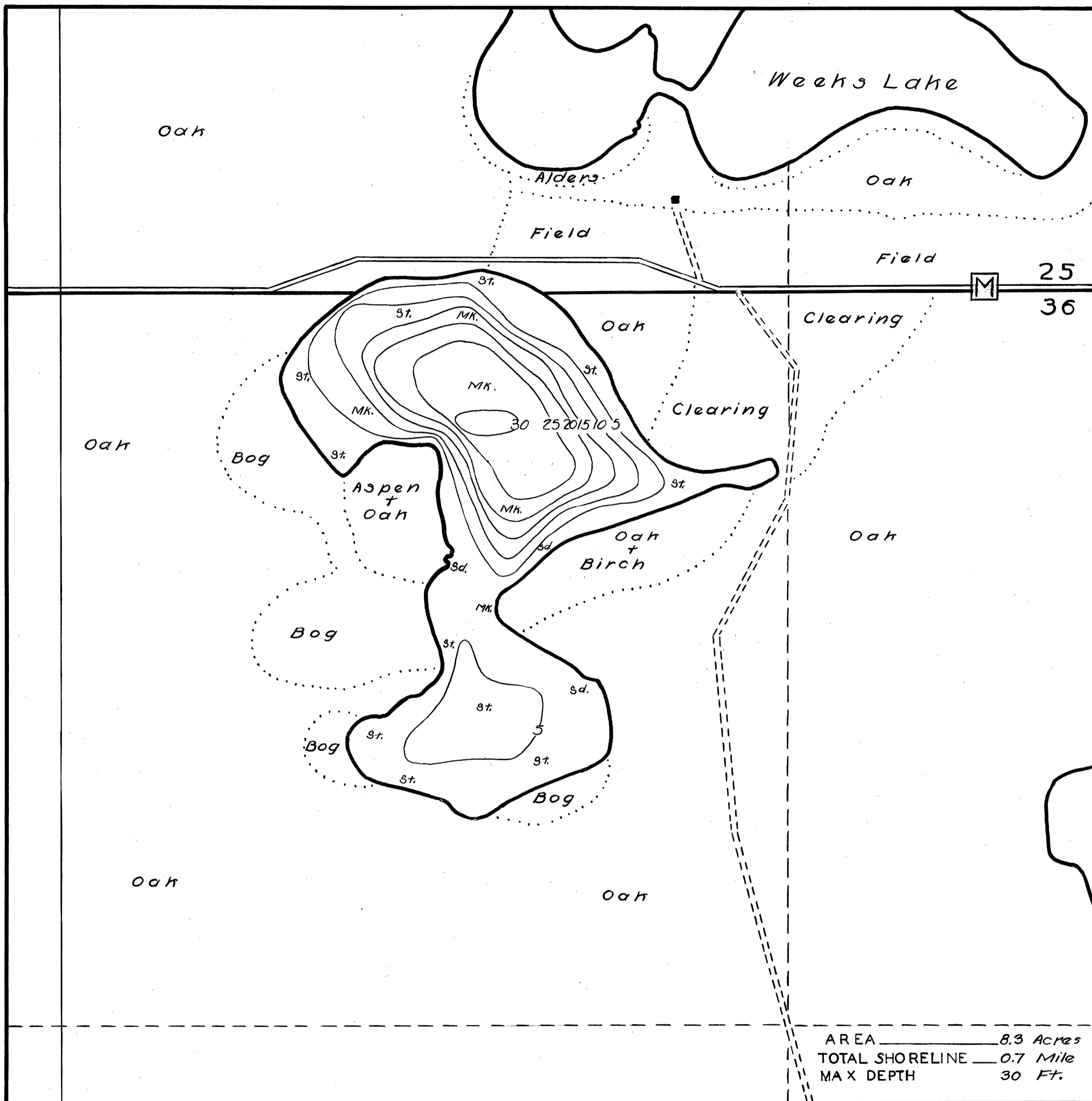

AREA 8.3 Acres
TOTAL SHORELINE 0.7 Mile
MAX DEPTH 30 Ft.

DATE Feb. 21, 1939
COMPILED BY W.P.S.
TRACED BY _____
SOURCE OF INFORMATION _____
W.P.A. Lake Survey Project
SOUNDINGS _____
W.P.A. Lake Survey Project
DATES OF MAP REVISION _____
WORK AGENCY W.P.A.
CHECKED BY W.P.S.
3-13-41

LAKE IMPROVEMENT RECORD

TYPE	DATE	DATE	DATE	DATE
BRUSH REFUGES	_____	_____	_____	_____
SAPLING TANGLES	_____	_____	_____	_____
SPAWNING BOXES	_____	_____	_____	_____
*MINNOW SPAWNERS	_____	_____	_____	_____
TOTAL	_____	_____	_____	_____

SCALE 1" = 165 Feet

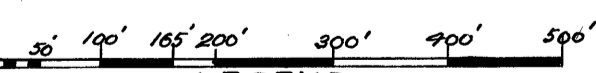

- LEGEND
- WEED BEDS
 - ROCKY SHOALS
 - Sd SAND
 - Cl CLAY
 - Gr GRAVEL
 - Mh MUCK
 - DWELLING
 - ABANDONED DWELLING
 - RESORT
 - St. SILT

Source: Wisconsin Department of Natural Resources 608-266-2621
Jeanstow Lake – Chippewa County, Wisconsin DNR Lake Map
Date – Feb 1939 - Historical Lake Map - Not for Navigation
A Public Document - Please Identify the Source when using it.