

# LAKE SURVEY MAP

WISCONSIN CONSERVATION DEPARTMENT  
BIOLOGY DIVISION  
LAKE AND STREAM IMPROVEMENT SECTION

LAKE KNICKERBOCKER  
SECTION 28-29  
TOWNSHIP 32 N  
RANGE 8 W  
TOWN OF SAMPSON  
COUNTY CHIPPEWA

FORM FI-117

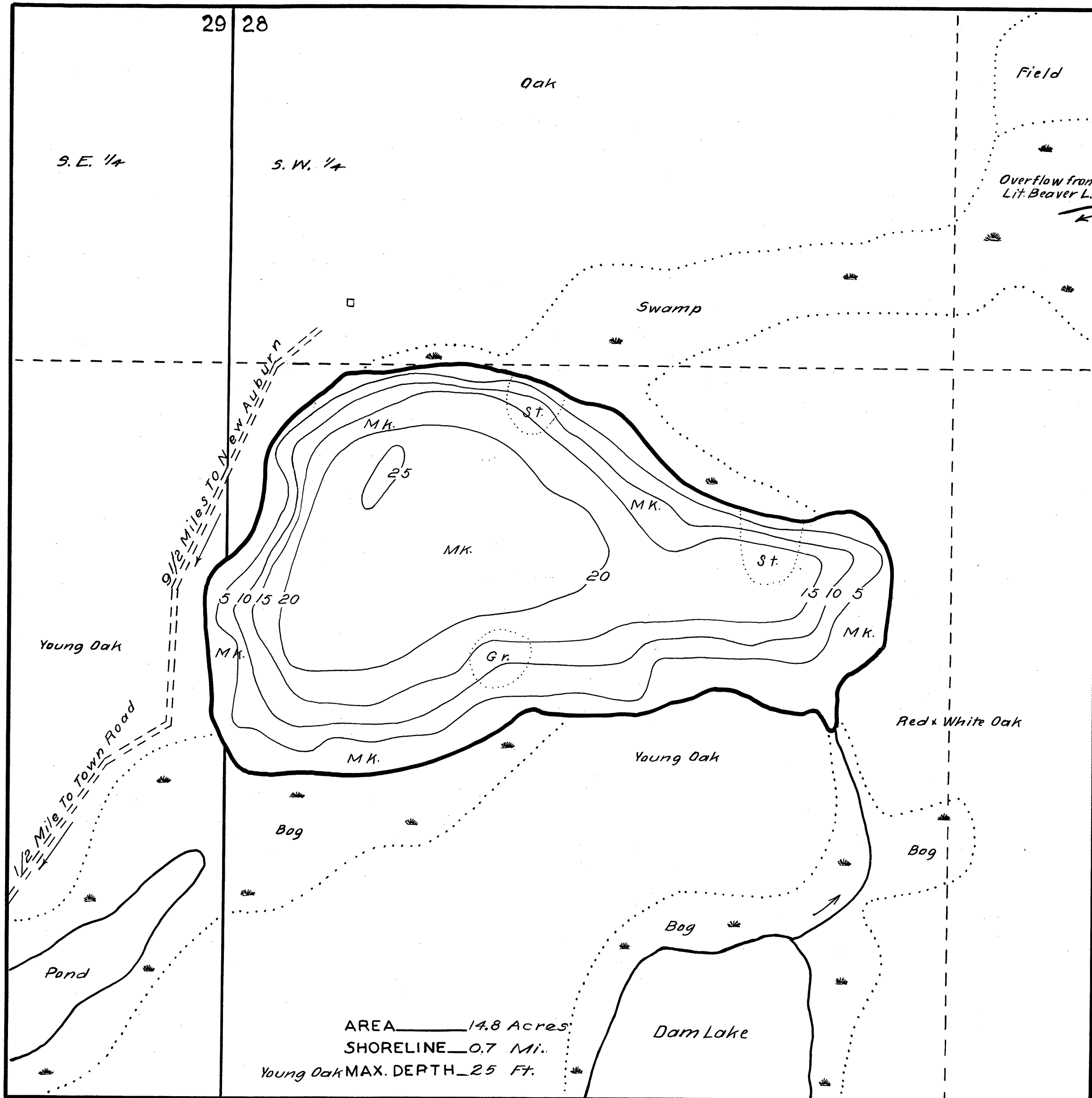

DATE February 14-1939  
 COMPILED BY H. K. Jr.  
 TRACED BY H. G. O.  
 SOURCE OF INFORMATION  
W.P.A. Lake Survey Project  
 SOUNDINGS At 99 Ft. Intervals  
 DATES OF MAP REVISION  
March 1940  
 WORK AGENCY W.P.A.  
 CHECKED BY W.P.S.  
3-5-41

### LAKE IMPROVEMENT RECORD

TYPE	DATE				
BRUSH REFUGES					
SAPLING TANGLES					
SPAWNING BOXES					
MINNOW SPAWNERS					
TOTAL					

SCALE 1 inch Equal 165 Ft.  
 0 50 100 150 200 300 400 500

### LEGEND

	WEED BEDS
	ROCKY SHOALS
	SAND
	CLAY
	GRAVEL
	MUCK
	DWELLING
	ABANDONED DWELLING
	RESORT
	Silt

Source: Wisconsin Department of Natural Resources 608-266-2621  
Knickerbocker Lake – Chippewa County, Wisconsin DNR Lake Map  
Date – Feb 1939 - Historical Lake Map - Not for Navigation  
A Public Document - Please Identify the Source when using it.