

B.M. 'X' W.C.D. SPIKE IN OAK TREE ON WEST SIDE OF PRIVATE ACCESS ON NORTH SIDE OF LAKE.
ASSUMED ELEVATION 100.00'
WATER ELEVATION 95.85'

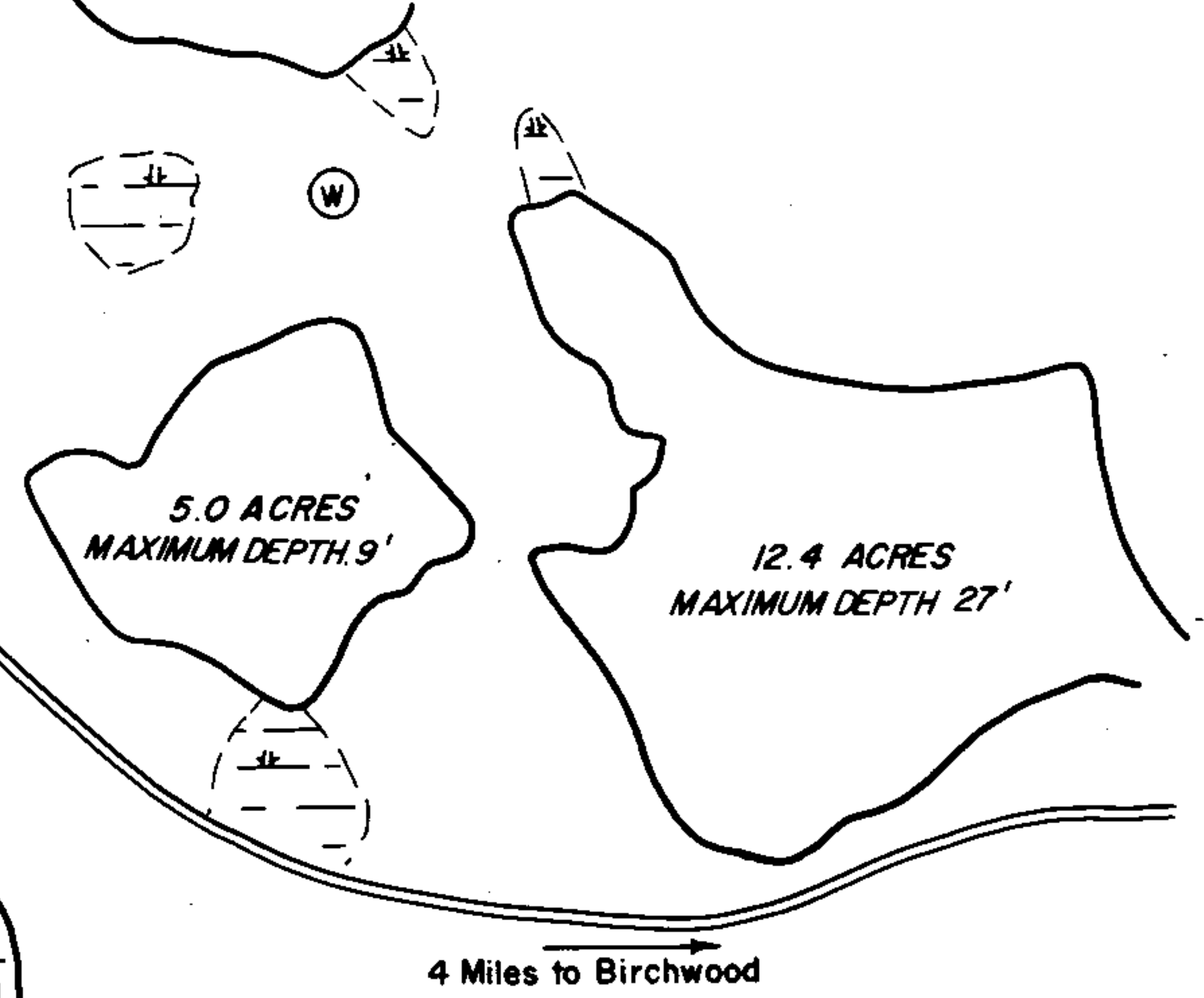
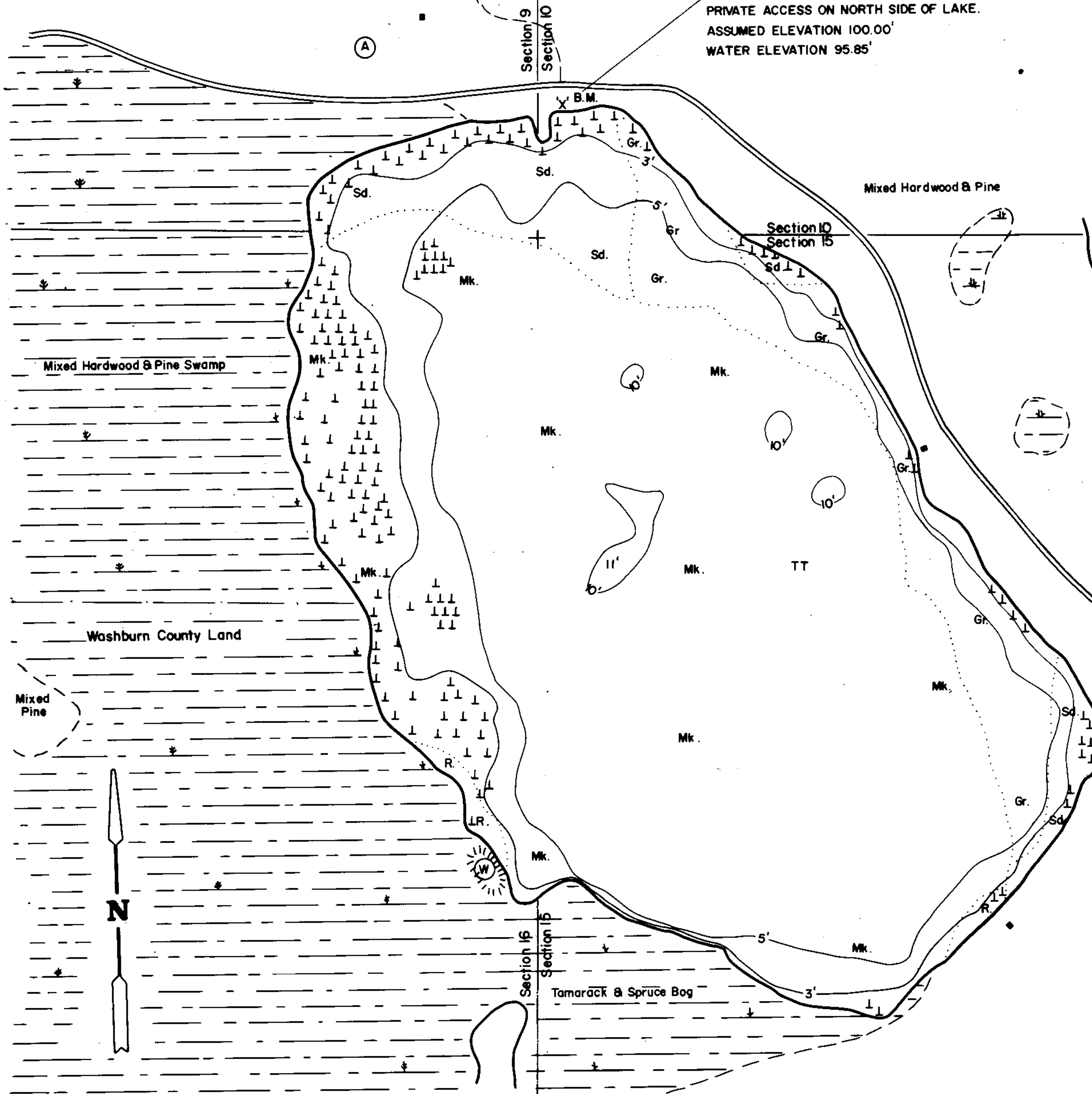
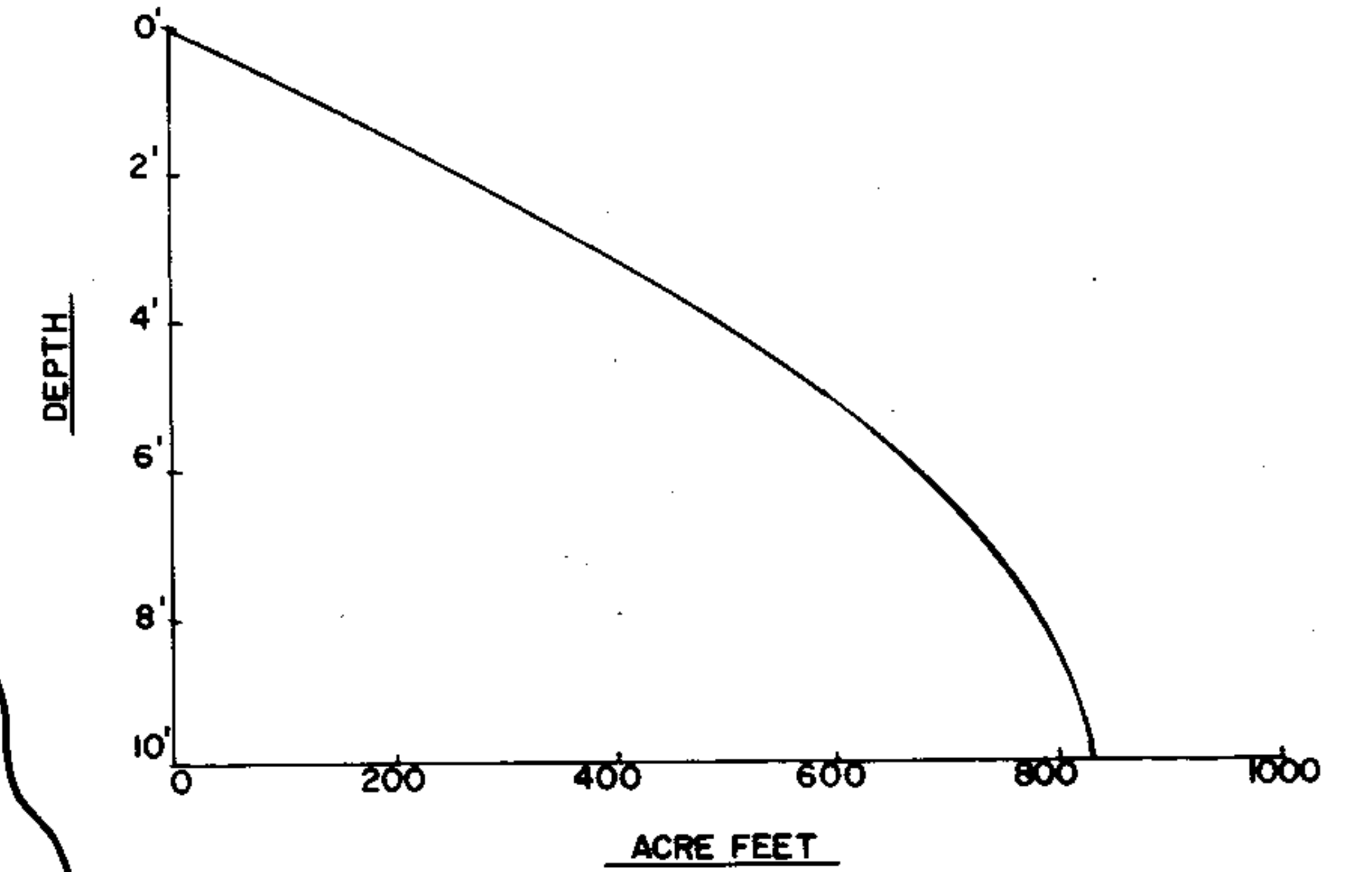

EQUIPMENT RECORDING SONAR MAPPED JULY 1966

- TOPOGRAPHIC SYMBOLS
- Brush
 - ⊙ Partly wooded
 - ⊙ Wooded
 - ⊙ Cleared
 - ⊙ Pastured
 - ⊙ Agricultural
 - B.M. Bench Mark
 - Dwelling
 - Resort
 - ⋯ Steep slope
 - ⋯ Indefinite shoreline
 - ⊙ Marsh
 - ⊙ Spring
 - ⊙ Intermittent stream
 - ⊙ Permanent inlet
 - ⊙ Permanent outlet
 - ⊙ Dam

WATER ELEV. 95.85'

- LAKE BOTTOM SYMBOLS
- P. Peat
 - Mk. Muck
 - C. Clay
 - M. Marl
 - Sd. Sand
 - St. Silt
 - ⊙ Stumps & Snags
 - R. Rubble
 - Br. Bedrock
 - T. Submergent vegetation
 - ⊙ Emergent vegetation
 - ⊙ Floating vegetation

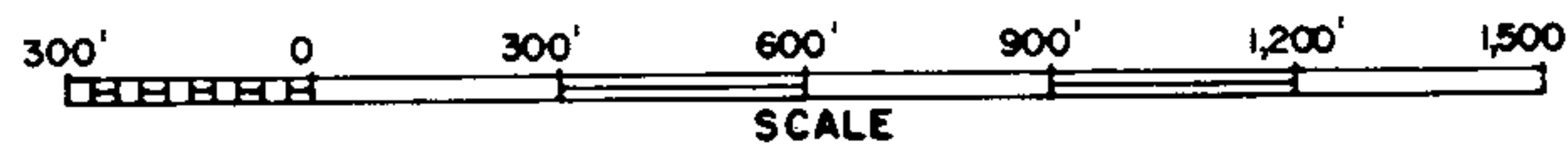

◇ Access ◇ Access with Parking ◇ Boat Livery
Field work by: C. Busch, G. Winter, L. Sather Drawn by: J. Roth

SPECIES OF FISH		
	Abundant	Common
Muskie		
N. Pike		
Walleye		
L. M. Bass		X
S. M. Bass		
Panfish		X
Trotl		

AREA 137.7 ACRES
UNDER 3FT. 15.7 %
OVER 20FT. 0.0 %
VOLUME 831.3 ACRE FT.
TOTAL ALK. 5 P.P.M.
SHORELINE 1.8 MILES
MAX. DEPTH 11 FEET

Source: Wisconsin Department of Natural Resources 608-266-2621
Nice Lake - Washburn County, Wisconsin DNR Lake Map
Date – Jul 1966 - Historical Lake Map - Not for Navigation
A Public Document - Please Identify the Source when using it.