

LAKE SURVEY MAP

RED LAKE WASHBURN COUNTY
SEC. 5, 8 T. 37 N. R. 10 W.

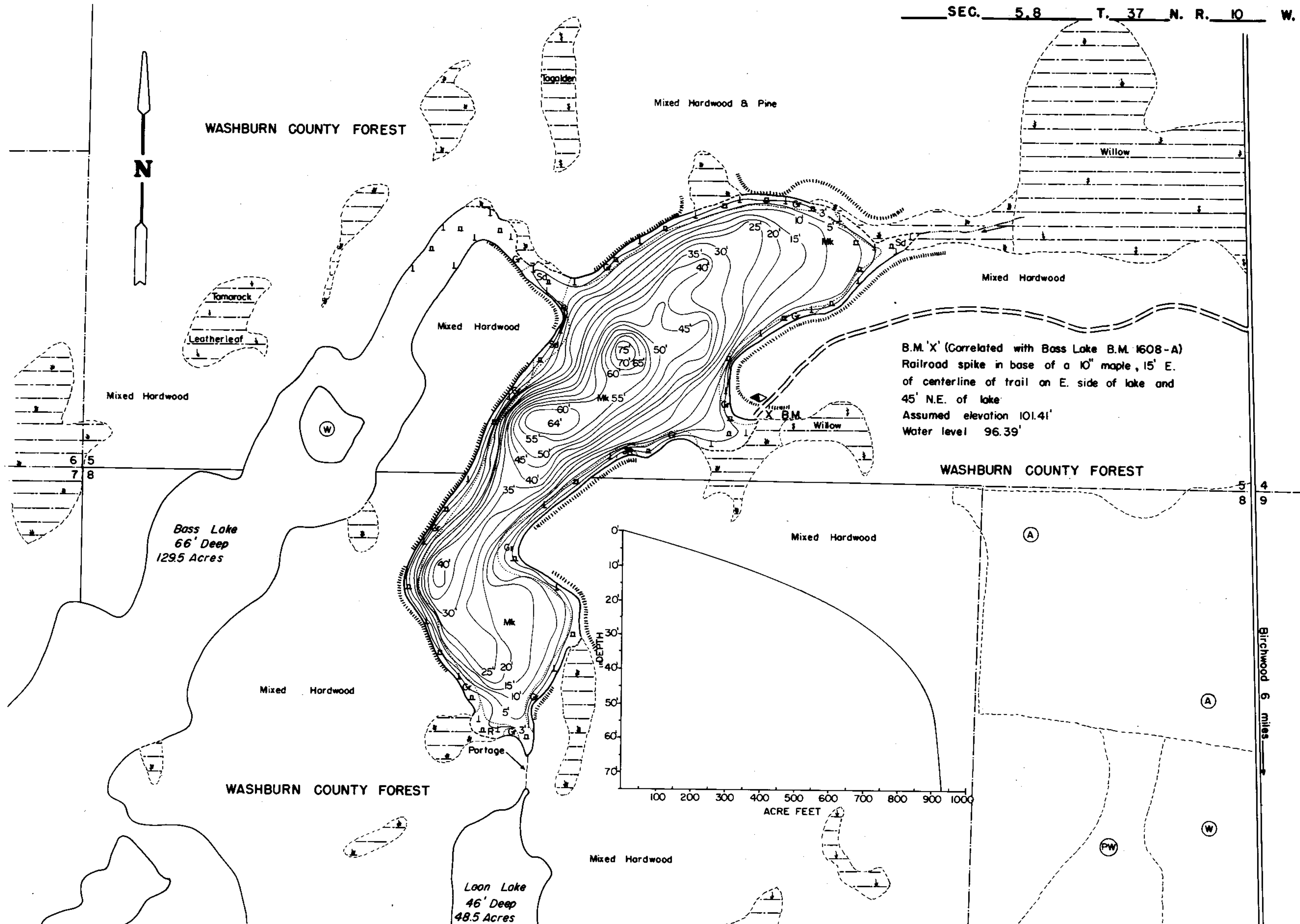

B.M. 'X' (Correlated with Bass Lake B.M. 1608-A)
Railroad spike in base of a 10" maple, 15' E.
of centerline of trail on E. side of lake and
45' N.E. of lake
Assumed elevation 101.41'
Water level 96.39'

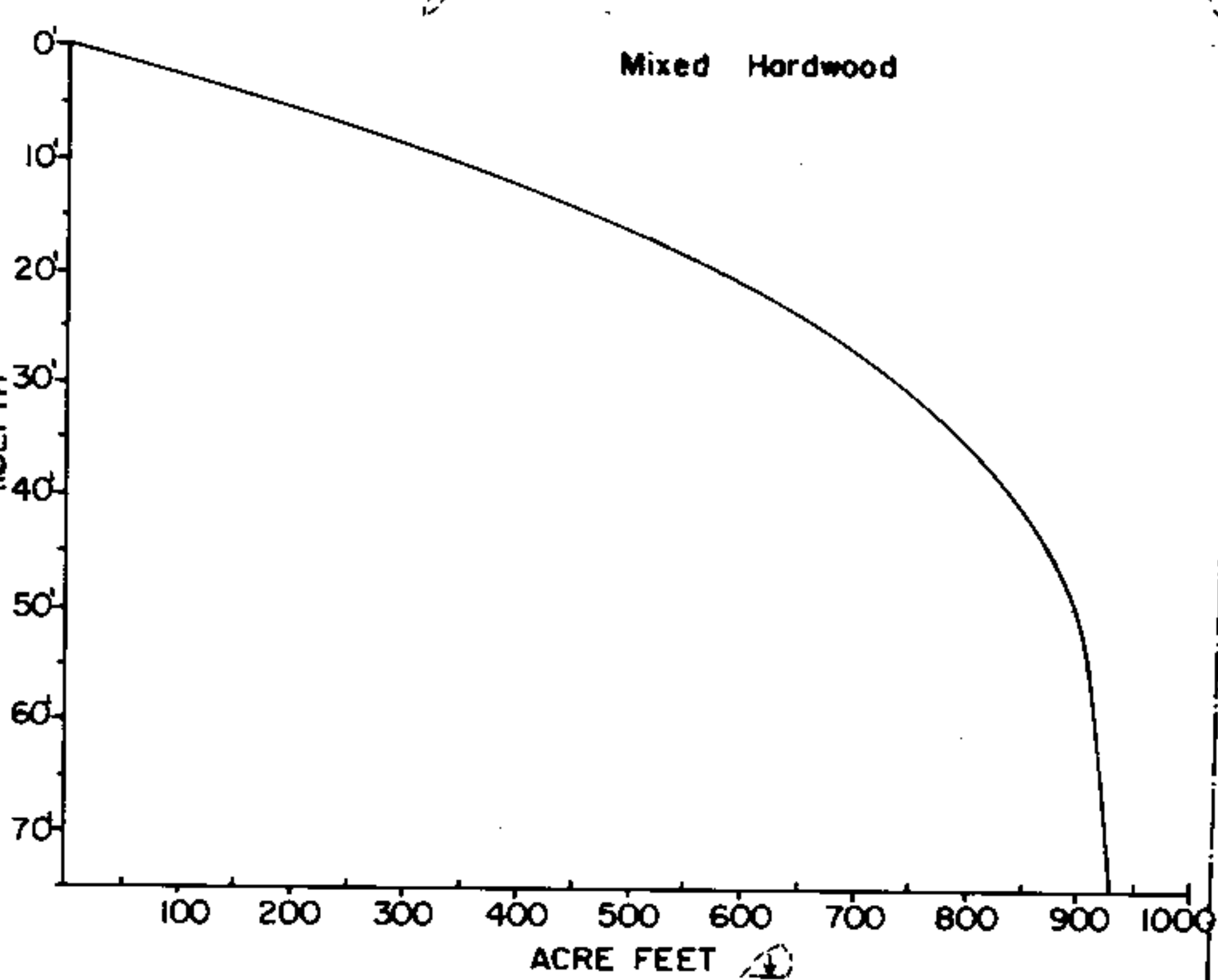

EQUIPMENT RECORDING SONAR MAPPED JUNE 1971

- | TOPOGRAPHIC SYMBOLS | | LAKE BOTTOM SYMBOLS | |
|-----------------------|----------------------------|---------------------|-----------------------------|
| (B) Brush | Steep slope | P. Peat | B Boulders |
| (PW) Partially wooded | ----- Indefinite shoreline | Mk. Muck | ⊙ Stumps & Snags |
| (W) Wooded | ----- Marsh | C. Clay | ⊙ Rock danger to navigation |
| (C) Cleared | ----- Spring | M. Marl | T Submergent vegetation |
| (P) Pastured | ----- Intermittent stream | Sd. Sand | ⊥ Emergent vegetation |
| (A) Agricultural | ----- Permanent inlet | St. Silt | ⊥ Floating vegetation |
| B.M. Bench Mark | ----- Permanent outlet | G. Gravel | ⊥ Brush shelters |
| ■ Dwelling | ⊥ Dam | R. Rubble | |
| ■ Resort | ⊥ D.N.R. State owned land | Bc Bedrock | |
| ■ Camp | | | |



◆ Access ◆ Access with Parking ◆ Boat Livery
Drawn by: C. Holt
Field work by: C. Busch, G. Lund, J. Sather

SPECIES OF FISH	Abundant	
	Common	Present
Muskie		
N. Pike		X
Walleye		X
L. M. Bass		X
S. M. Bass		X
Panfish	X	
Trout		

WATER AREA 41.3 ACRES
UNDER 3 FT. 11 %
OVER 20 FT. 48 %
MAX. DEPTH 75 FEET.
TOTAL ALK. 10 P.P.M.
VOLUME 923.8 ACRE FT.
SHORELINE 1.61 MILES

Birchwood 6 miles

Source: Wisconsin Department of Natural Resources 608-266-2621
Red Lake - Washburn County, Wisconsin DNR Lake Map
Date – Jun 1971 - Historical Lake Map - Not for Navigation
A Public Document - Please Identify the Source when using it.