

TWIN LAKES

LAKE SURVEY MAP

LAKE CHARLES
 SECTION 5-32
 TOWNSHIP 32-33 N
 RANGE 9 W
 TOWN OF RUSK SAMPSON
 COUNTY RUSK CHIPPEWA

WISCONSIN CONSERVATION DEPARTMENT
 BIOLOGY DIVISION
 LAKE AND STREAM IMPROVEMENT SECTION

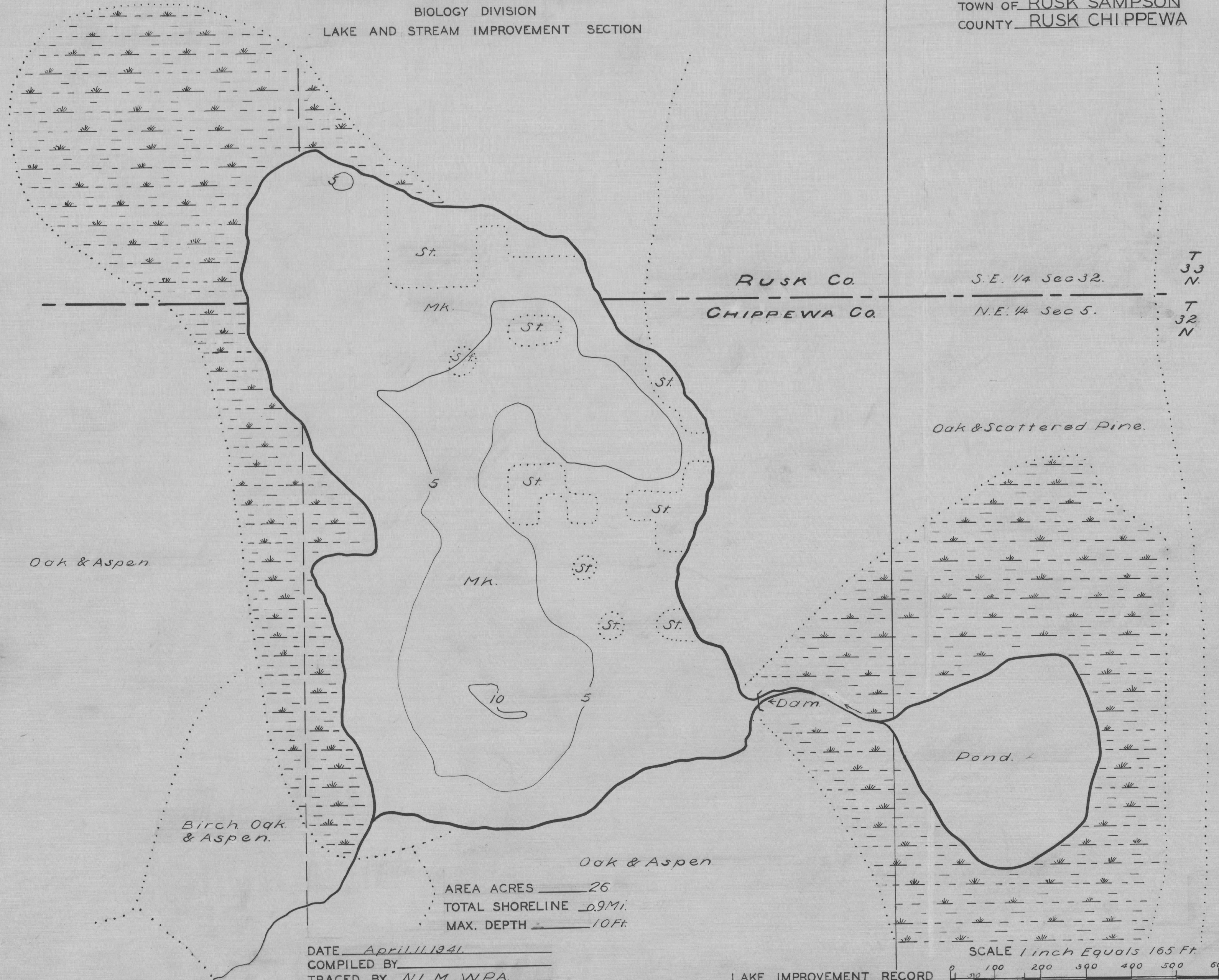

AREA ACRES 26
 TOTAL SHORELINE 0.9 Mi.
 MAX. DEPTH 10 Ft.

DATE April 11, 1941
 COMPILED BY _____
 TRACED BY N.L.M. W.P.A.
 SOURCE OF INFORMATION W.P.A. Lake Survey Project
 SOUNDINGS At 66 Ft. Intervals
 DATES OF MAP REVISION _____
 WORK AGENCY W. P. A.

CHECKED BY
W.P.S. - E.M.K.
6-11-41

LAKE IMPROVEMENT RECORD

TYPE	DATE				
⊕ BRUSH REFUGES					
~ SAPLING TANGLES					
□ SPAWNING BOXES					
* MINNOW SPAWNERS					
TOTAL					

SCALE 1 inch Equals 165 Ft.

LEGEND

- ⊕ WEED BEDS
- ~ ROCKY SHOALS
- Ss SAND
- Cl. CLAY
- Gr. GRAVEL
- Mk. MUCK
- DWELLING
- ABANDONED DWELLING
- ▣ RESORT
- St. Silt

LAKE SURVEY MAP

CONSERVATION DEPARTMENT
BIOLOGY DIVISION
STREAM IMPROVEMENT SECTION

LAKE CHARLES
SECTION 5-32
TOWNSHIP 32-33 N
RANGE 9 W
TOWN OF RUSK SAMPSON
COUNTY RUSK CHIPPEWA

FOR

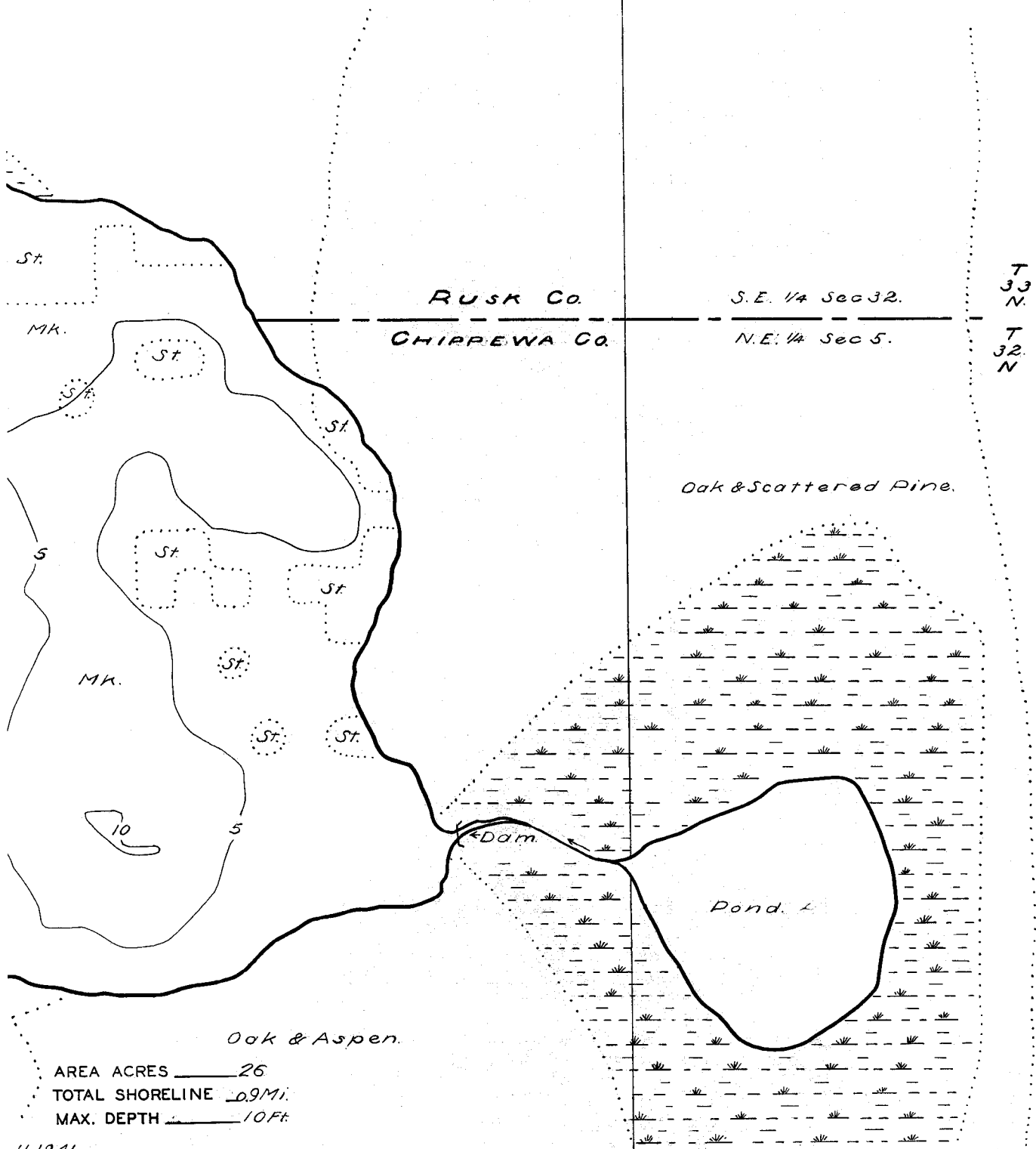

AREA ACRES 26
TOTAL SHORELINE 0.9 Mi.
MAX. DEPTH 10 Ft.

Oak & Aspen.

SCALE 1 inch Equals 165 Ft.
0 100 200 300 400 500 600

11.19.41.
LLM WPA
FORMATION
Survey Project
56 Ft. Intervals
P. REVISION
W. P. A.

LAKE IMPROVEMENT RECORD

TYPE	DATE			
◇ BRUSH REFUGES	_____	_____	_____	_____
~ SAPLING TANGLES	_____	_____	_____	_____
□ SPAWNING BOXES	_____	_____	_____	_____
* MINNOW SPAWNERS	_____	_____	_____	_____
TOTAL	_____	_____	_____	_____

LEGEND

- ⊙ WEED BEDS
- ⊘ ROCKY SHOALS
- S SAND
- Cl. CLAY
- Gr. GRAVEL
- MK. MUCK
- DWELLING
- ABANDONED DWELLING
- ▣ RESORT
- St. Silt.

LAKE SURVEY MAP

WISCONSIN CONSERVATION DEPARTMENT
 BIOLOGY DIVISION
 LAKE AND STREAM IMPROVEMENT SECTION

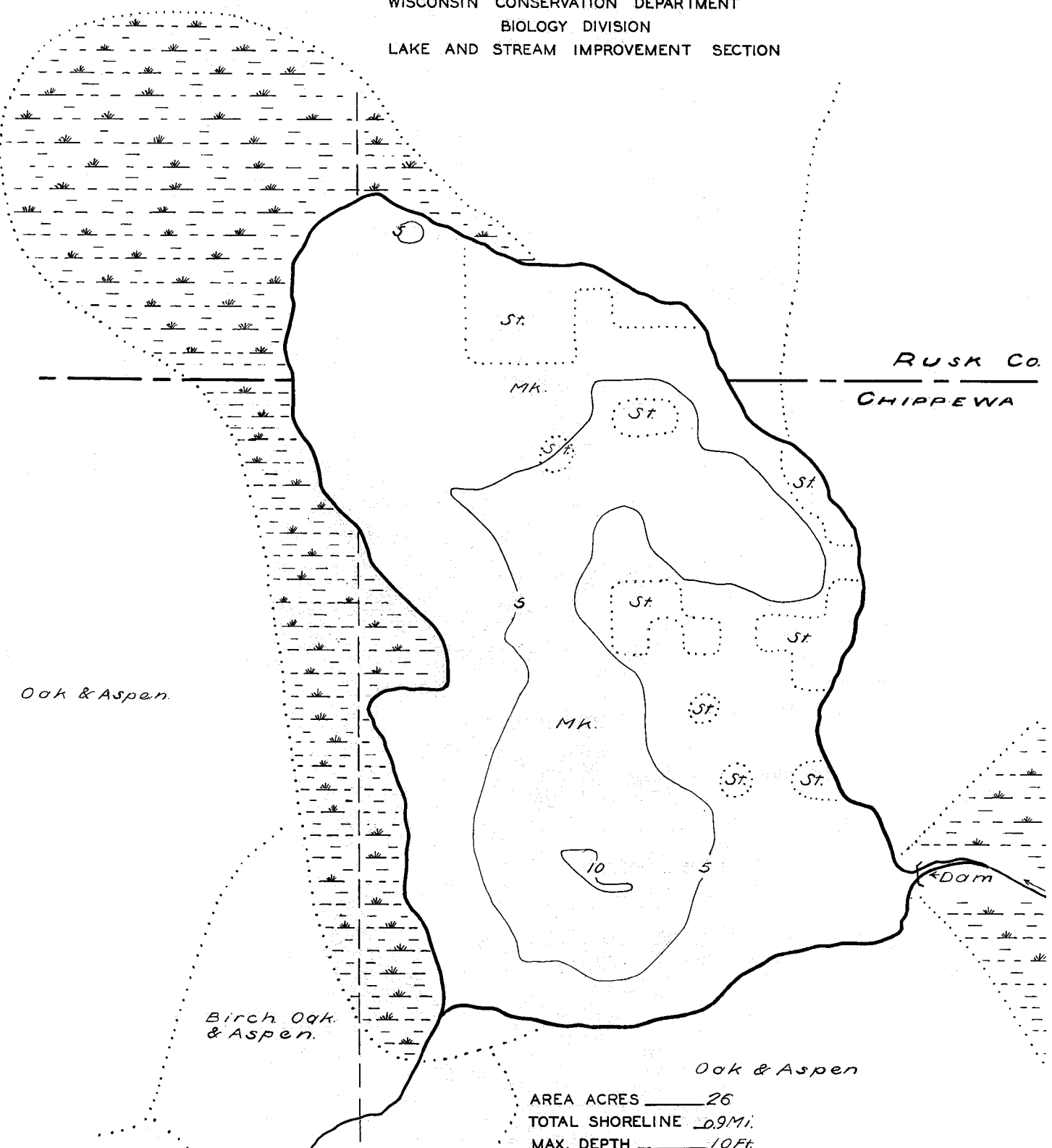

AREA ACRES 26
 TOTAL SHORELINE 0.9 Mi.
 MAX. DEPTH 10 Ft.

DATE April 11, 1941
 COMPILED BY _____
 TRACED BY W. L. M. WPA
 SOURCE OF INFORMATION _____
WPA Lake Survey Project
 SOUNDINGS At 66 Ft. Intervals
 DATES OF MAP REVISION _____
 WORK AGENCY W. P. A.

CHECKED BY
 W. D. S. - E. M. K.
 6-11-41

LAKE IMPROVEMENT	
TYPE	DATE
◇ BRUSH REFUGES	_____
~ SAPLING TANGLES	_____
□ SPAWNING BOXES	_____
* MINNOW SPAWNERS	_____
TOTAL	_____

Source: Wisconsin Department of Natural Resources 608-266-2621
East Twin Lake (Charles Lake) - Chippewa County, Wisconsin DNR Lake Map
Date – Apr. 1941 - Historical Lake Map - Not for Navigation
A Public Document - Please Identify the Source when using it.