

LAKE POKEGAMA  
 SECTIONS 17, 20  
 TOWNSHIP T-33-N  
 RANGE R-10-W  
 TOWN CHETEK  
 COUNTY BARRON

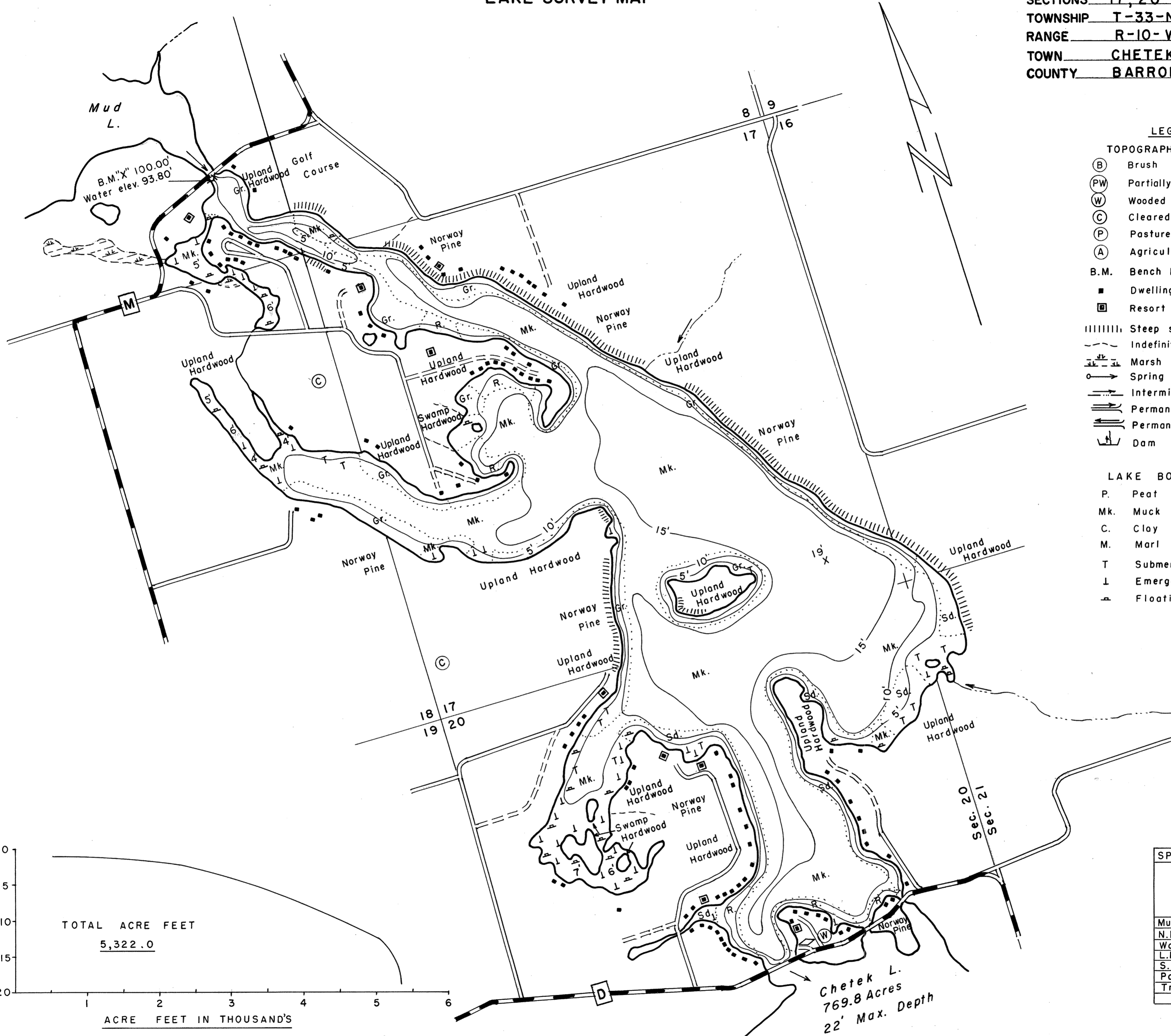

- LEGEND**
- TOPOGRAPHIC SYMBOLS**
- (B) Brush
  - (PW) Partially wooded
  - (W) Wooded
  - (C) Cleared
  - (P) Pastured
  - (A) Agricultural
  - B.M. Bench Mark
  - Dwelling
  - Resort
  - ||||| Steep slope
  - - - Indefinite shoreline
  - ~ Marsh
  - Spring
  - Intermittent stream
  - == Permanent inlet
  - == Permanent outlet
  - ⊥ Dam

- LAKE BOTTOM SYMBOLS**
- P. Peat
  - Mk. Muck
  - C. Clay
  - M. Marl
  - T Submergent vegetation
  - L Emergent vegetation
  - F Floating vegetation
  - Gr. Gravel
  - R. Rubble
  - Br. Bedrock
  - Sd. Sand

SPECIES OF FISH		
	Abundant	Rare
Muskie		
N. Pike	X	
Walleye	X	
L.M. Bass	X	
S.M. Bass		X
Panfish	X	
Trout		

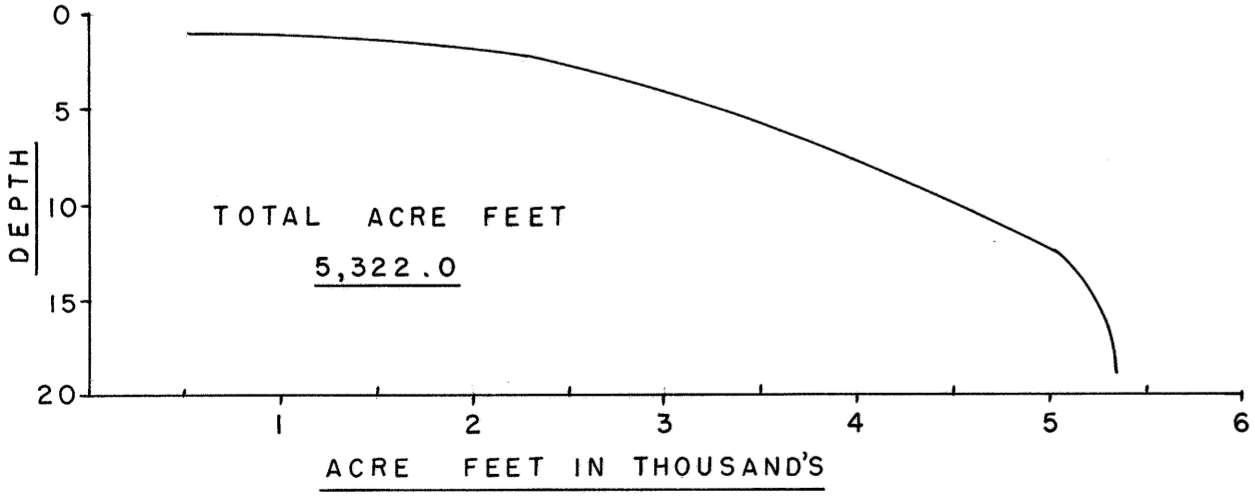

Chetek L.  
 769.8 Acres  
 22' Max. Depth

CITY OF  
 CHETEK

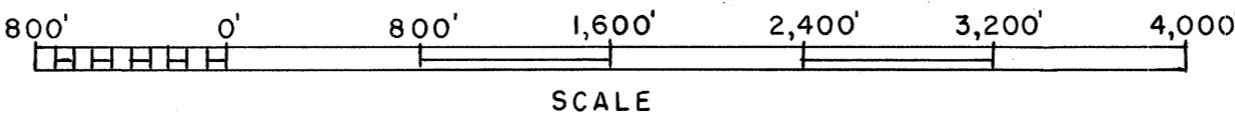

- ◇ ACCESS
- ◊ ACCESS WITH PARKING
- ◆ BOAT LIVERY

Field work by: R. Hopke E. Nelson  
 Drawn by: E. Eaton  
 LAKE MAPPED AUGUST 1963  
 SOURCE OF INFORMATION W.C.D  
 SOUNDINGS RECORDING SONAR  
 TOTAL ALK. 25-45 P.P.M.

515.8 ACRES WITH ISLANDS  
 AREA 505.8 ACRES WITHOUT ISLANDS  
 TOTAL SHORELINE 11.3 MILES  
 MAX. DEPTH 19 FEET

Source: Wisconsin Department of Natural Resources 608-266-2621  
Pokegama Lake – Barron County, Wisconsin DNR Lake Map  
Date – Aug 1963 - Historical Lake Map - Not for Navigation  
A Public Document - Please Identify the Source when using it.