

# LAKE SURVEY MAP

UPPER VERMILLION LAKE  
BARRON COUNTY  
SEC. 10,11,14,15 T. 35 N. R. 13 W.

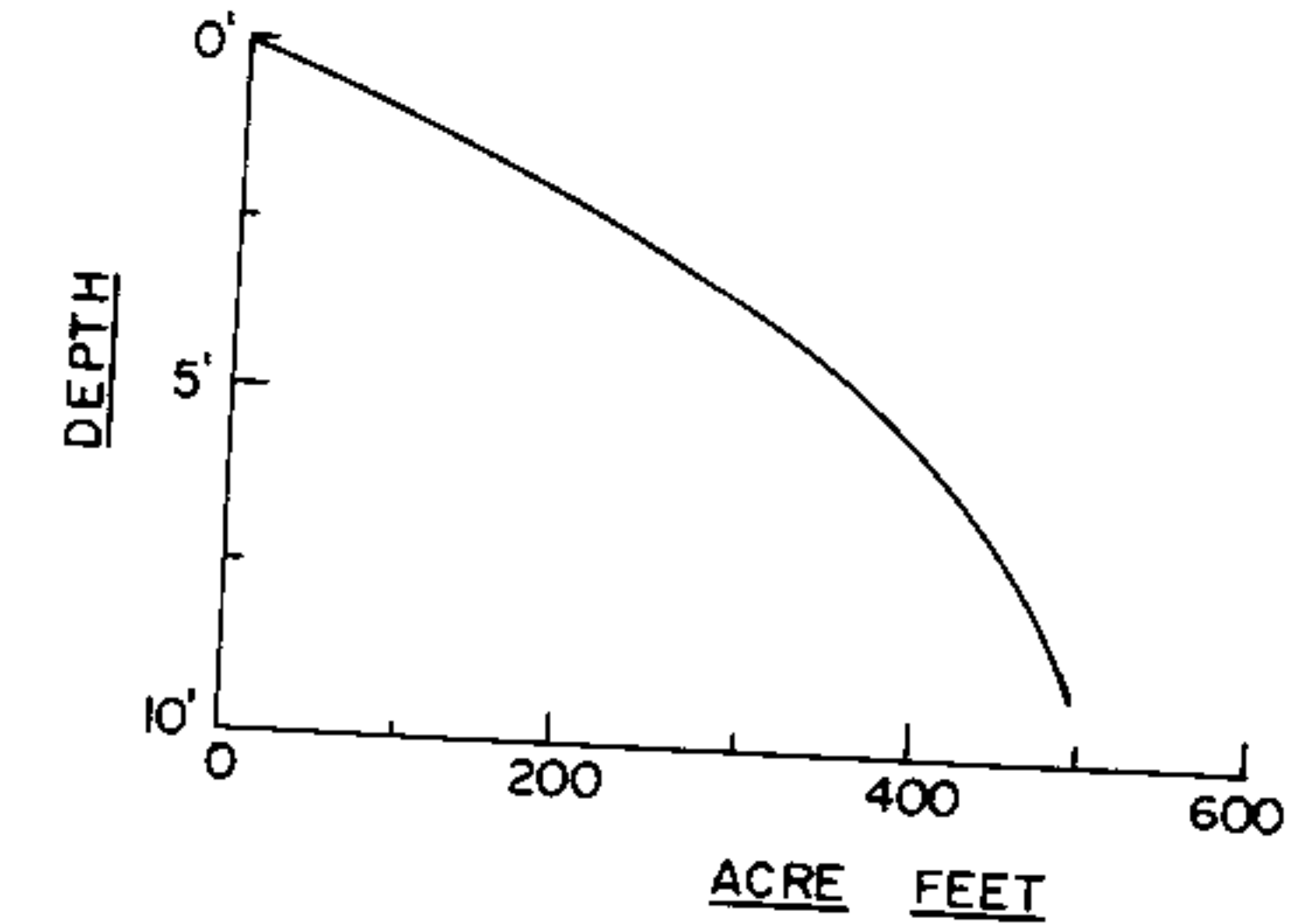
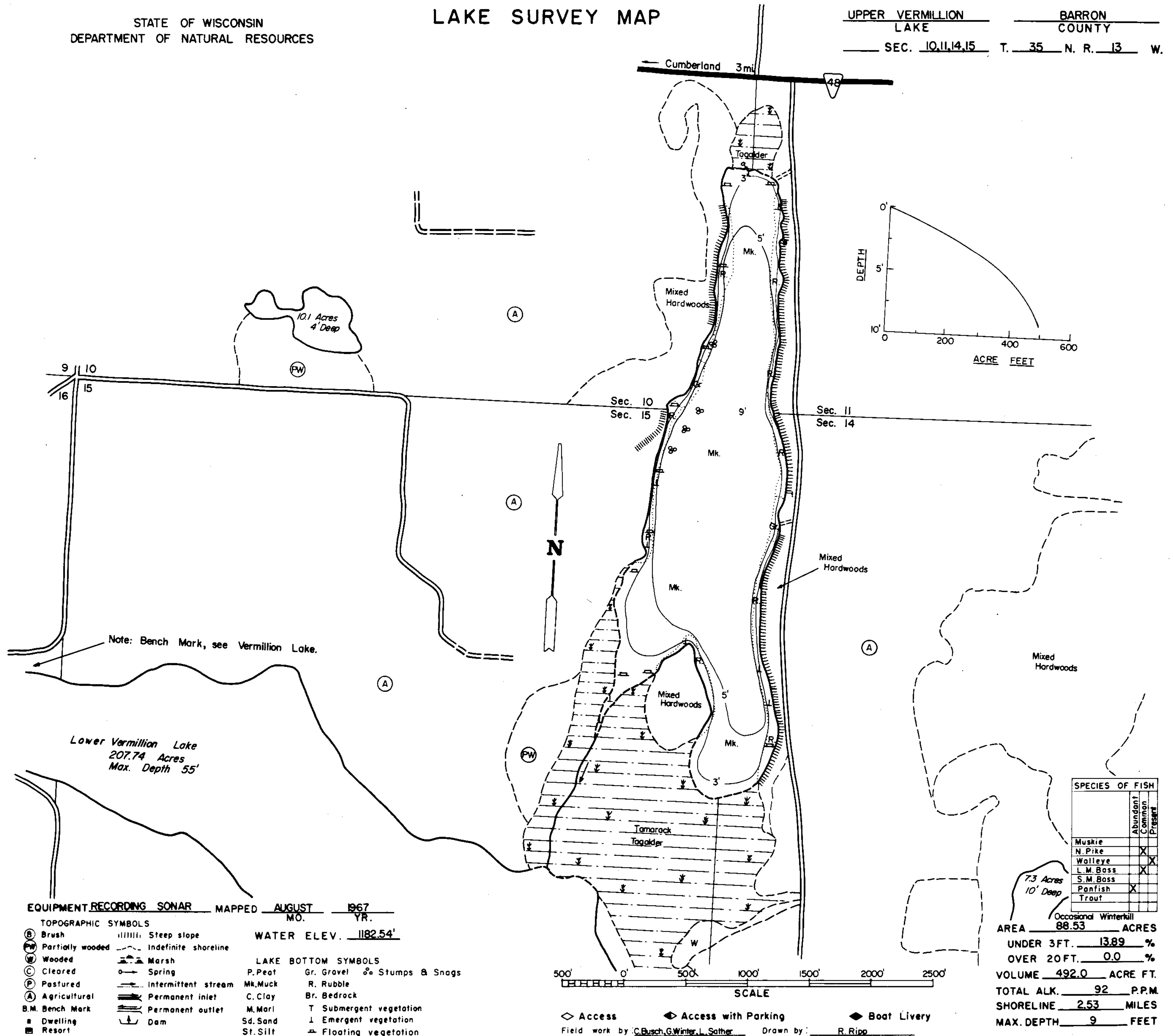

Note: Bench Mark, see Vermillion Lake.

Lower Vermillion Lake  
207.74 Acres  
Max. Depth 55'

SPECIES OF FISH		
	Abundant	Present
Muskie		
N. Pike	X	
Walleye		X
L.M. Bass	X	
S.M. Bass	X	
Panfish	X	
Trout		

7.3 Acres  
10' Deep  
Occasional Winterkill  
AREA 86.53 ACRES  
UNDER 3FT. 13.89 %  
OVER 20FT. 0.0 %  
VOLUME 492.0 ACRE FT.  
TOTAL ALK. 92 P.P.M.  
SHORELINE 2.53 MILES  
MAX. DEPTH 9 FEET

EQUIPMENT RECORDING SONAR MAPPED AUGUST 1967  
MO. YR.

- TOPOGRAPHIC SYMBOLS
- (B) Brush
  - (PW) Partially wooded
  - (W) Wooded
  - (C) Cleared
  - (P) Pastured
  - (A) Agricultural
  - B.M. Bench Mark
  - Dwelling
  - Resort
- LAKE BOTTOM SYMBOLS
- P. Peat
  - Mk. Muck
  - C. Clay
  - M. Marl
  - Sd. Sand
  - St. Silt
  - Gr. Gravel
  - R. Rubble
  - Br. Bedrock
  - T. Submergent vegetation
  - ↓ Emergent vegetation
  - ≡ Floating vegetation
  - Stumps & Snags



◇ Access      ◇ Access with Parking      ◆ Boat Livery  
Field work by C. Busch, G. Winter, L. Sather      Drawn by: R. Ripp

Source: Wisconsin Department of Natural Resources 608-266-2621  
Upper Vermillion Lake – Barron County, Wisconsin DNR Lake Map  
Date – Aug 1967 - Historical Lake Map - Not for Navigation  
A Public Document - Please Identify the Source when using it.