

LAKE SURVEY MAP

THIRTY LAKE
BARRON COUNTY
SEC. 19, 30 T. 36 N. R. 12 W.



24 19
25 30

Cumberland 6 miles

R-13-W
R-12-W

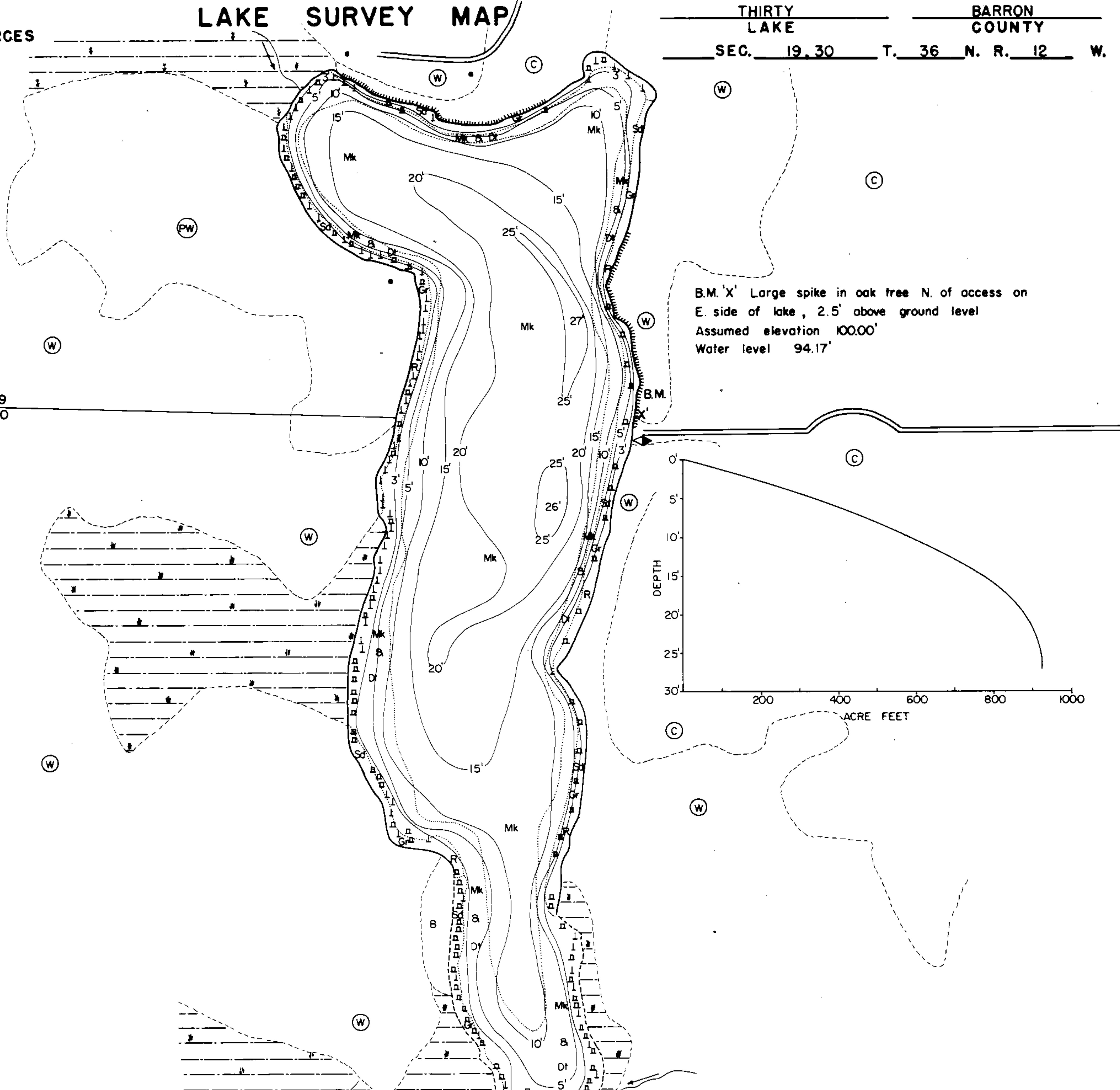

B.M. 'X' Large spike in oak tree N. of access on E. side of lake, 2.5' above ground level
Assumed elevation 100.00'
Water level 94.17'

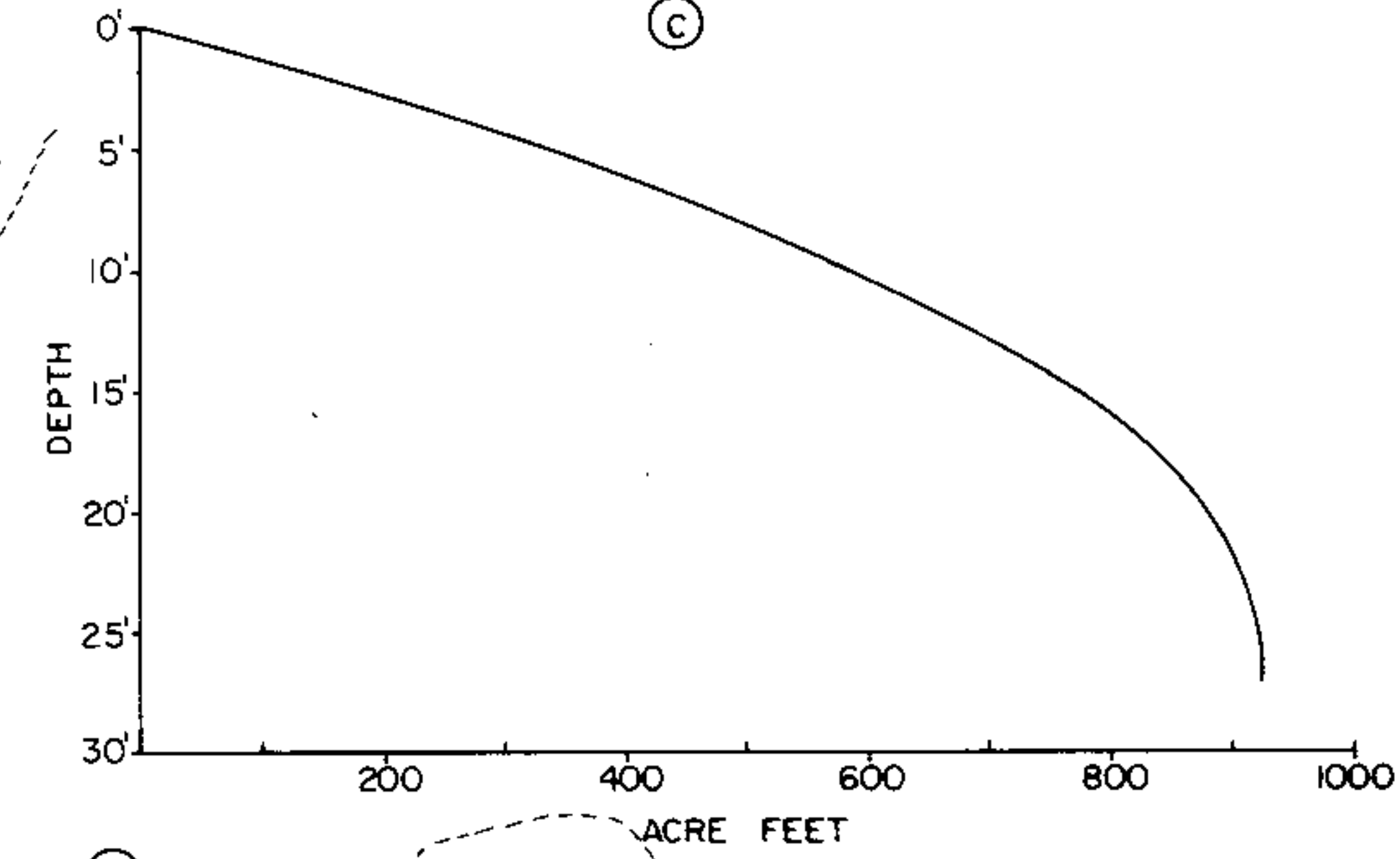

EQUIPMENT	SONAR & POLE	MAPPED	MONTH	YEAR
			JULY	1972
TOPOGRAPHIC SYMBOLS				
(B) Brush	Steep slope	P. Peat	LAKE BOTTOM SYMBOLS	
(PW) Partially wooded	- - - Indefinite shoreline	Mk. Muck	B Boulders	
(W) Wooded	Marsh	C. Clay	Stumps & Snags	
(C) Cleared	Spring	M. Marl	Rock danger to navigation	
(P) Pastured	Intermittent stream	Sd. Sand	T Submergent vegetation	
(A) Agricultural	Permanent inlet	St. Silt	L Emergent vegetation	
B.M. Bench Mark	Permanent outlet	Gr. Gravel	Floating vegetation	
■ Dwelling	Dam	R. Rubble	Brush shelters	
□ Resort	D.N.R. State owned land	Br. Bedrock		
□ Camp		Dt. Detritus		



◆ Access ◆ Access with Parking ◆ Boat Livery
Drawn by: C. Holt
Field work by: M. Clark

SPECIES OF FISH	ABUNDANCE		
	Abundant	Common	Present
Muskie			
N. Pike		X	
Walleye			
L.M. Bass			X
S.M. Bass			
Panfish	X		
Trout			

WATER AREA 73.5 ACRES
UNDER 3 FT. 13 %
OVER 20 FT. 18 %
MAX. DEPTH 27 FEET.
TOTAL ALK. 10 P.P.M.
VOLUME 924 ACRE FT.
SHORELINE 2.03 MILES

Source: Wisconsin Department of Natural Resources 608-266-2621
Thirty Lake – Barron County, Wisconsin DNR Lake Map
Date – Jul 1972 - Historical Lake Map - Not for Navigation
A Public Document - Please Identify the Source when using it.